

IF CONCRETE BARRIER IS USED FOR TEMPORARY TRAFFIC BARRIER, THEN THE FOLLOWING DETAIL AND NOTES WILL BE APPLICABLE.

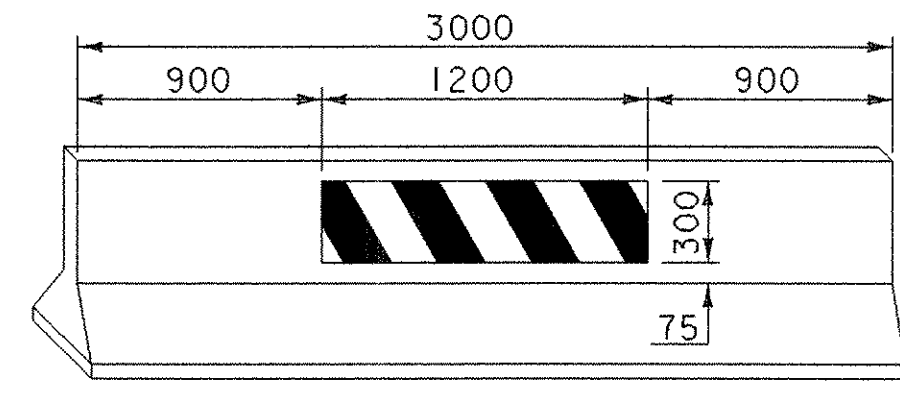

TEMPORARY TRAFFIC BARRIER NOTES

1. THE PANEL SHOWN IS ORIENTATED FOR TRAFFIC PASSING TO THE RIGHT.
2. THE PANEL SHALL BE ATTACHED TO THE CONCRETE MEDIAN BARRIER IN A SECURE FASHION.
3. ALL BARRIER PLACED IN TAPERS SHALL BE PROVIDED WITH A REFLECTORIZED PANEL AS SHOWN. THE PANEL SHALL BE ORIENTATED IN THE PROPER DIRECTION (RIGHT OR LEFT) BASED ON THE APPROACHING TRAFFIC.
4. BARRIER SECTIONS MAY BE MOVED DURING WORKING HOURS TO PROVIDE ACCESS TO THE WORKSITE. HOWEVER, THEY MUST BE REPLACED FOR NON- WORK PERIODS.

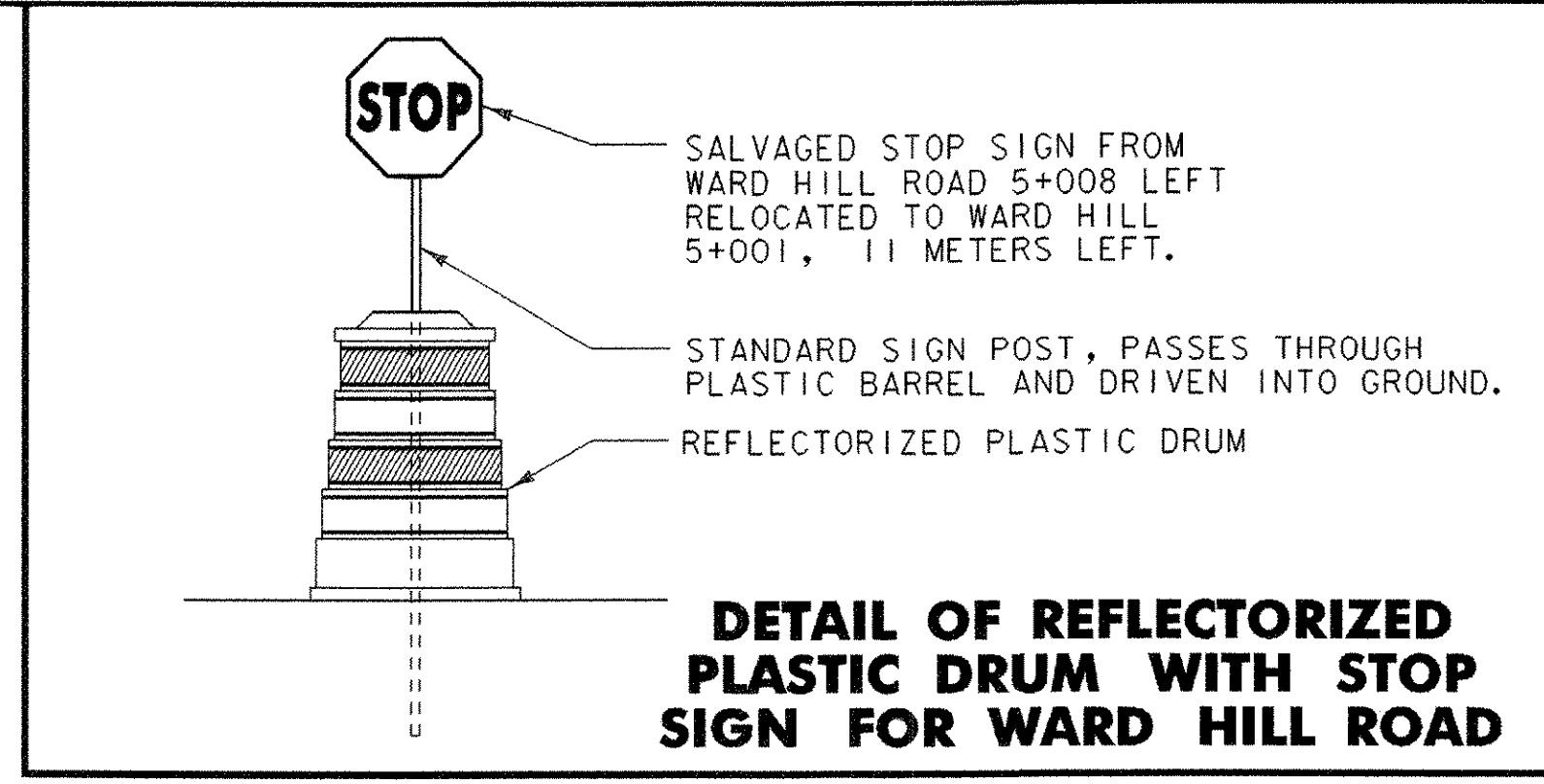

TEMPORARY 100 YELLOW LINE (DOUBLE)
 M 2+175.000 - M 2+215.000
 M 2+226.000 - M 2+335.000
 E 4+993.000 - E 5+004.000

TEMPORARY LETTERS OR SYMBOLS
 E 4+999 'STOP'

TEMPORARY 600 STOP BAR
 E 4+993.000

TEMPORARY 100 WHITE LINE
 M 2+175.000 RT. - M 2+335.000 RT.
 M 2+175.000 LT. - M 5+003.000 LT.
 E 5+004.000 RT. - M 2+335.000 LT.

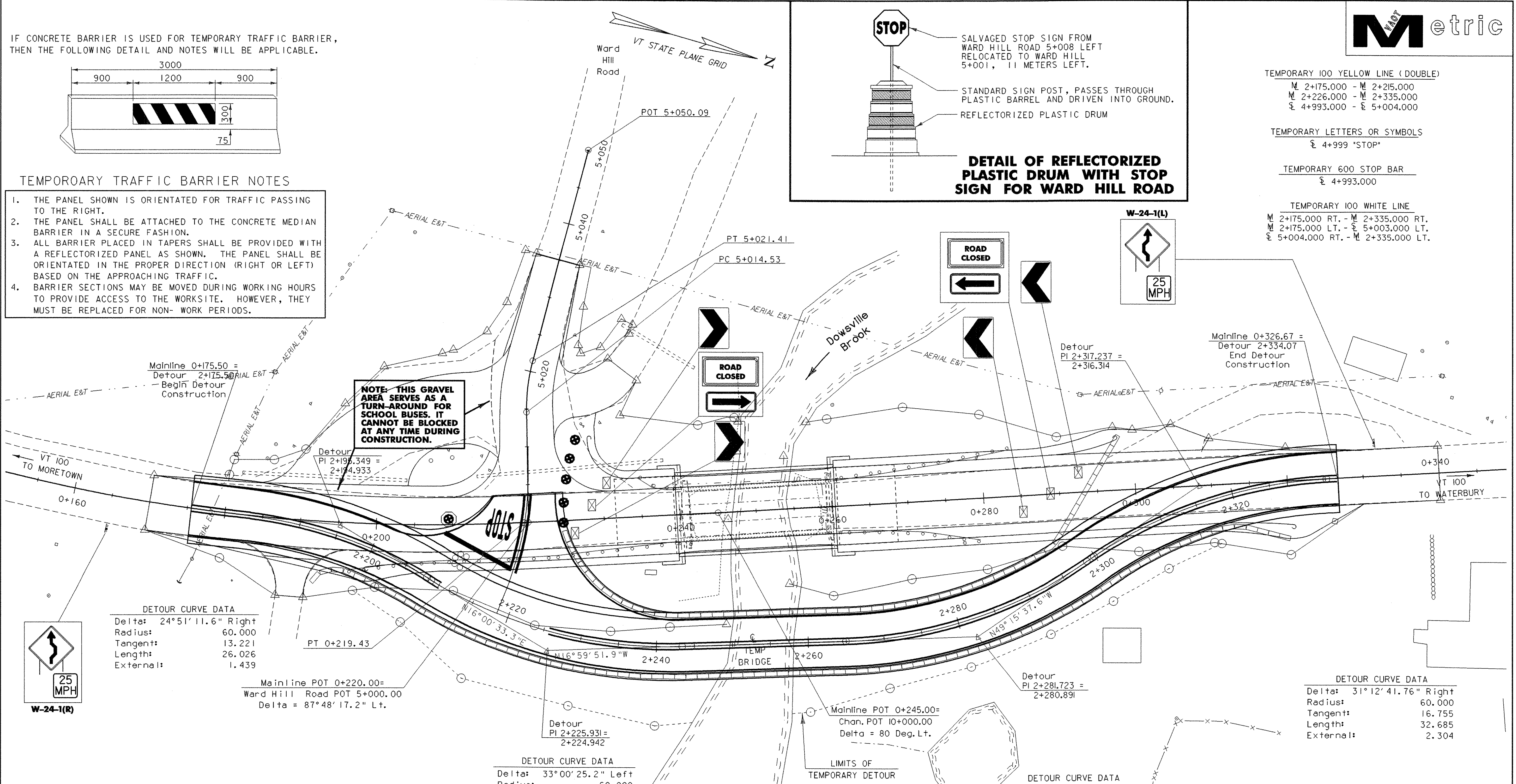

CONSTRUCTION APPROACH SIGNING

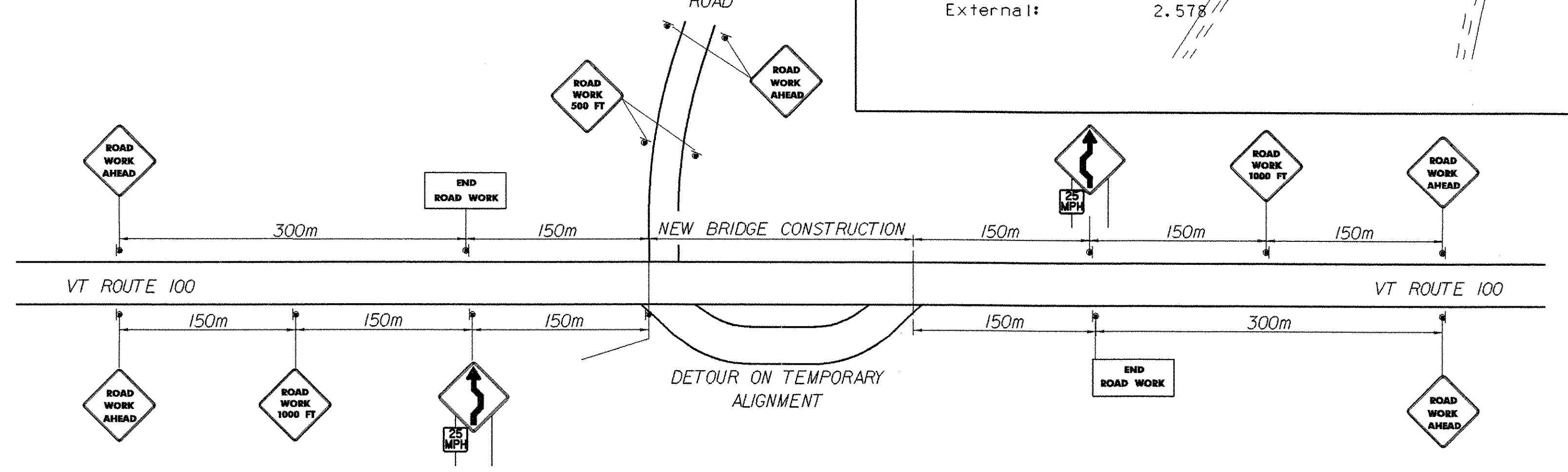

LEGEND

- ⊕ PLASTIC REFLECTORIZED BARRELS
- ⊕ BARREL WITH STOP SIGN SEE DETAIL THIS SHEET
- ▭ TEMPORARY TRAFFIC BARRIER
- ⊠ TYPE III BARRICADE (MOD.) SEE STD. E-107AM

STANDARDS REQUIRED

E-100	E-102A
E-101	E-107
E-102	E-107A

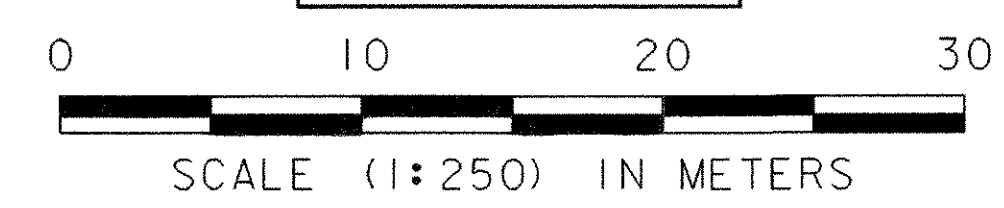

THIS TRAFFIC CONTROL SHEET REPRESENTS THE MINIMUM REQUIREMENTS WITHOUT TRAFFIC SIGNAL CONTROL. MODIFICATION OF OR ADDITIONS TO THE TRAFFIC CONTROL DEVICES SHOWN HERE MAY BE REQUIRED BY THE RESIDENT ENGINEER BASED ON FIELD CONDITIONS.

DETOUR PLAN AND TRAFFIC CONTROL SHEET

PROJECT NAME: DUXBURY
 PROJECT NUMBER: STP 013-4(24)
 FILE NAME: /str5/86e059/se059tcs.dgn
 PROJECT LEADER: C. KELLER
 DESIGNED BY: B. NYQUIST
 PLOT DATE: 20-OCT-2005
 DRAWN BY: J. GILMORE
 CHECKED BY: T. SUMNER
 SHEET 14 OF 62

(NOT TO SCALE)