

**DRIVE NO. 1 CURVE DATA**

Δ = 38°04' 44" LT  
 D = 114°35' 30"  
 R = 50.00'  
 T = 17.25'  
 L = 33.23'  
 E = 2.89'

**DRIVE NO. 1 PT**

STA 10+36.24  
 N = 488704.4220  
 E = 1618163.7429

**DRIVE NO. 1 POE**

STA 10+75.00  
 N = 488665.7003  
 E = 1618165.3611

**DRIVE NO. 1 PI**

STA 10+20.27 BK =  
 STA 10+18.99 AH  
 Δ = 38°04' 44" LT  
 N = 488721.6618  
 E = 1618163.0224

**VT 14 PI NO. 1**

STA 385+76.39 BK =  
 STA 385+49.27 AH  
 Δ = 39°06' 47" RT  
 N = 488764.9561  
 E = 1618047.0274

**DRIVE NO. 1 PC**

STA 10+03.01  
 N = 488735.6767  
 E = 1618173.0879

**VT 14 POB**

STA 382+23.00  
 N = 488628.2432  
 E = 1618372.8966

**VT 14 PC NO. 1**

STA 382+30.04  
 N = 488630.9657  
 E = 1618366.4072

**VT 14 STA 384+50.00 =**

DRIVE NO. 1 STA 10+00.00 POB  
 Δ = 90° LT FROM CURVE TANGENT  
 N = 488738.1251  
 E = 1618174.8463

**VT 14 CURVE NO. 1 DATA**

Δ = 39°06' 47" RT  
 D = 5°52' 35"  
 R = 975.00'  
 T = 346.35'  
 L = 665.58'  
 E = 59.69'

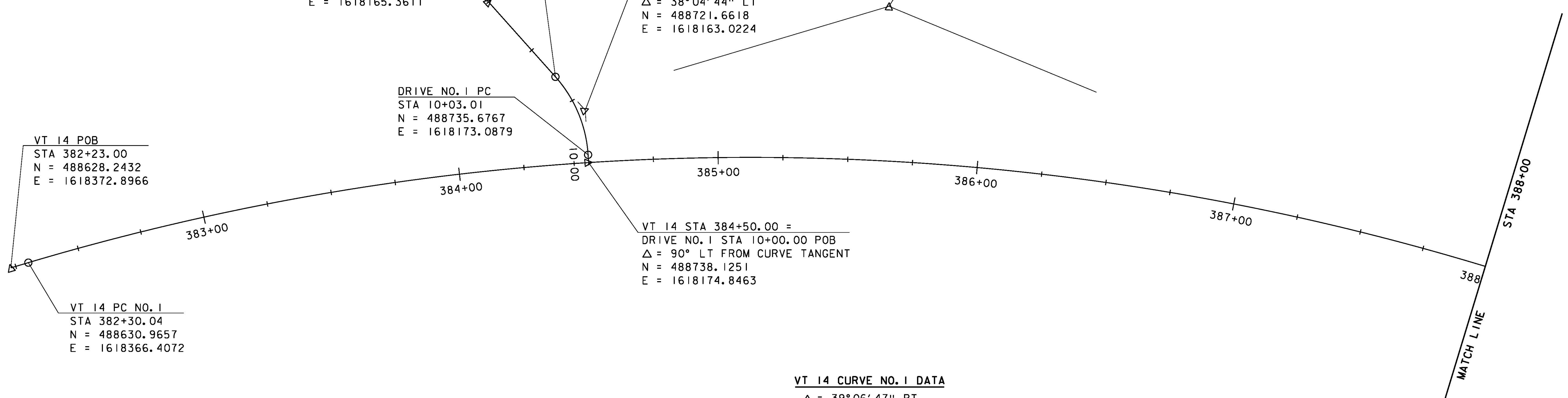

DATUM	
VERTICAL	NAVD 88
HORIZONTAL	NAD 83 (96)
ADJUSTMENT	Compass

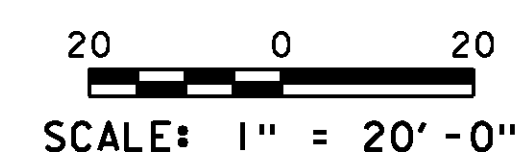

PROJECT NAME:	ROYALTON
PROJECT NUMBER:	BRS 0147(13)
FILE NAME:	\BR 27\s86e055alnbd_r.27.dgn
PROJECT LEADER:	C. CARLSON
DESIGNED BY:	D. PETERSON
BRIDGE 27 ALIGNMENT LAYOUT (1)	
PLOT DATE:	08-OCT-2013
DRAWN BY:	L. BULLOCK
CHECKED BY:	C. CARLSON
SHEET	18 OF 186