

S:\Engineering Services\Slaw\East Montpelier VT\Production Drawings\AutoCAD Files\M-1.dwg, 4/21/2011 4:31:02 PM

BAR LIST						
MARK #	BAR SIZE	QTY	LENGTH (METRIC)	LENGTH (FEET)	WT/PC (LBS)	REMARKS
501	#5/#16	63	1854mm	6'-1"	6.3	EPOXY COATED
502	#5/#16	500	2870mm	9'-5"	9.8	EPOXY COATED
503	#5/#16	56	1067mm	3'-6"	3.7	EPOXY COATED
504	#5/#16	56	965mm	3'-2"	3.3	EPOXY COATED
505	#5/#16	63	2921mm	9'-7"	10.0	EPOXY COATED
050802	#5/#16	500	2489mm	8'-2"	8.5	EPOXY COATED
056110	#5/#16	72	18847mm	61'-10"	64.5	EPOXY COATED
052209	#5/#16	12	6920mm	22'-9"	23.7	EPOXY COATED

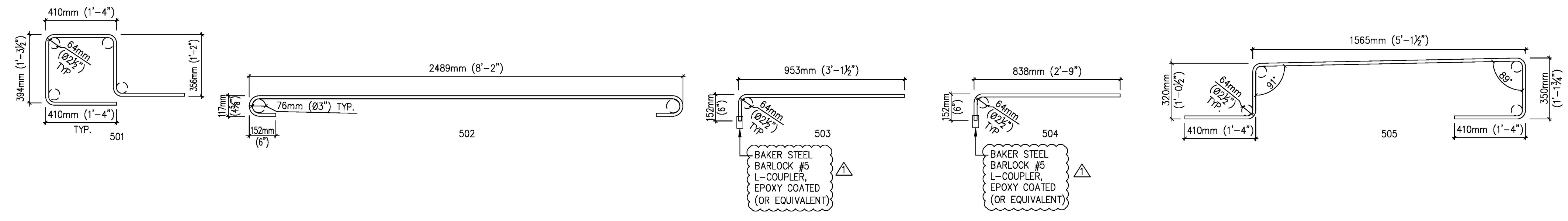

Received Date: 4/22/11
 Checked By: Hiram Salls
 Approval Type: Approved
 Approved By: Chris Williams
 Date: 4/26/11

REVISIONS	
△	PER REVISE & RESUBMIT DRAWINGS RECEIVED ON 04/14/11 & PER SLAW EMAIL ON 04/18/11

DRAWN	CHECKED	ENGINEERED	CHECKED	APPROVED
KLT 04/06/11	JJ 04/06/11	-- -/-	-- -/-	RL 04/06/11

Eriksson technologies
 813.989.3317
 TAMPA, FL LRFD.COM

J & R SLAW, INC.
 438 RIVERVIEW ROAD
 LEHIGHTON, PA. 18235
 (610)852-2020

STATE OF VERMONT
 AGENCY OF TRANSPORTATION
 SUPERSTRUCTURE REPLACEMENT
 EAST MONTPELIER

BRIDGE NO.: 71
 CONTRACT NO.: SLAW #773
 CONTRACTOR: AL ST. ONGE CONTRACTING
 FED. AID PROJECT NO.: BRF 037-2(8)