

100mm WHITE LINE
 STA. 1+065 RT - STA. 1+170 RT
 STA. 1+065 LT - STA. 1+078 LT
 STA. 1+084 LT - STA. 1+170 LT

100mm YELLOW LINE (DOUBLE)
 STA. 1+065 - STA. 1+074
 STA. 1+086 - STA. 1+170

REMOVING SIGNS
 STA. 1+089 LT
 STA. 1+108 RT
 STA. 1+130 LT

TRAFFIC SIGNS, TYPE A
 STA. 1+090 LT
 STA. 1+105 RT
 STA. 1+130 LT

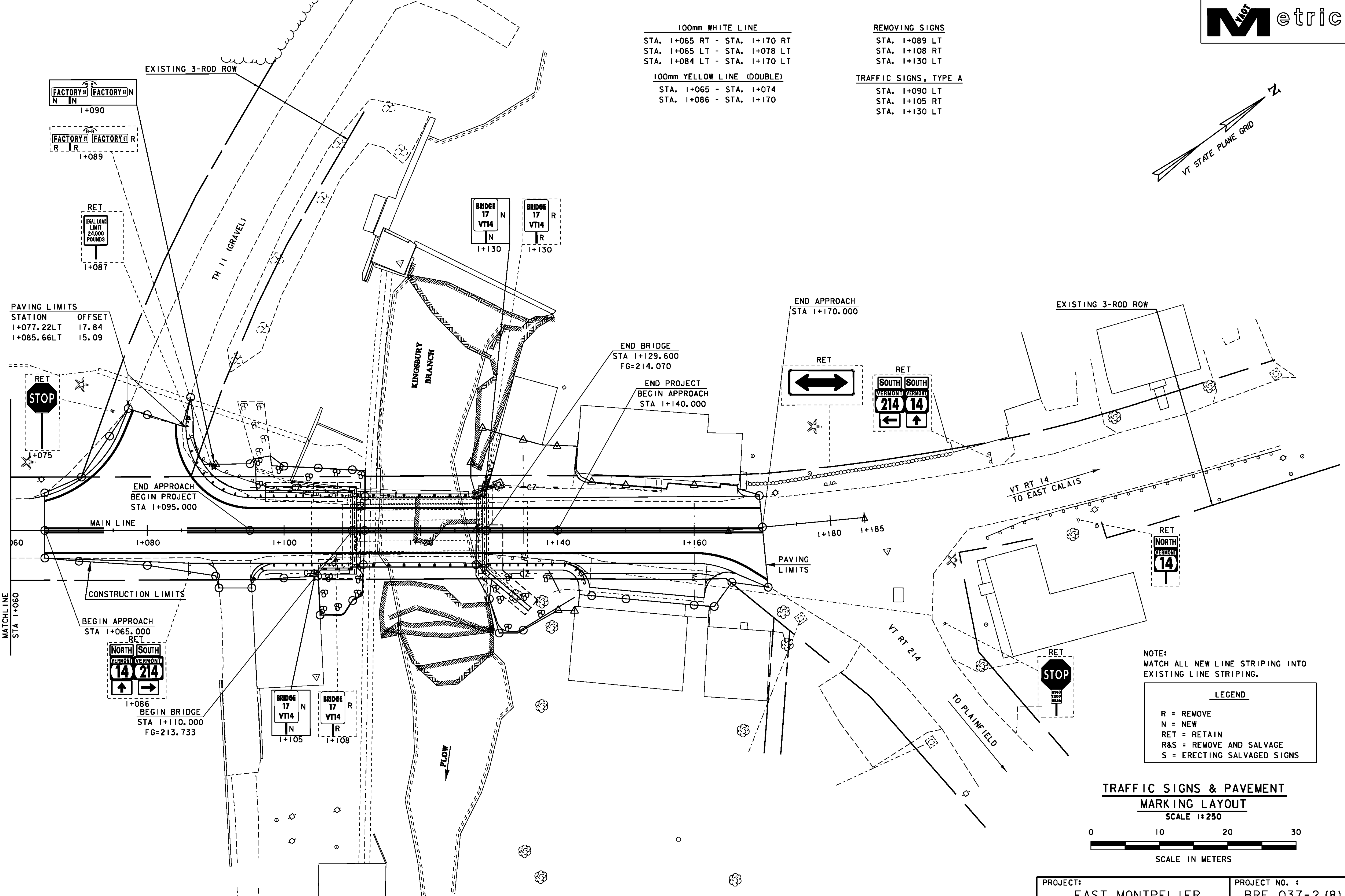
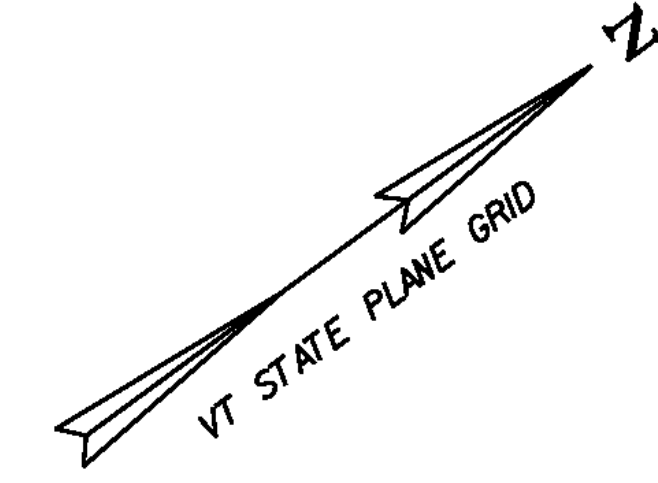

PAVING LIMITS

STATION	OFFSET
1+077.22LT	17.84
1+085.66LT	15.09

END APPROACH
 STA 1+170.000

END BRIDGE
 STA 1+129.600
 FG=214.070

END PROJECT
 BEGIN APPROACH
 STA 1+140.000

END APPROACH
 BEGIN PROJECT
 STA 1+095.000

CONSTRUCTION LIMITS

BEGIN APPROACH
 STA 1+065.000

BEGIN BRIDGE
 STA 1+110.000
 FG=213.733

NOTE:
 MATCH ALL NEW LINE STRIPING INTO
 EXISTING LINE STRIPING.

LEGEND

- R = REMOVE
- N = NEW
- RET = RETAIN
- R&S = REMOVE AND SALVAGE
- S = ERECTING SALVAGED SIGNS

**TRAFFIC SIGNS & PAVEMENT
 MARKING LAYOUT**
 SCALE 1:250

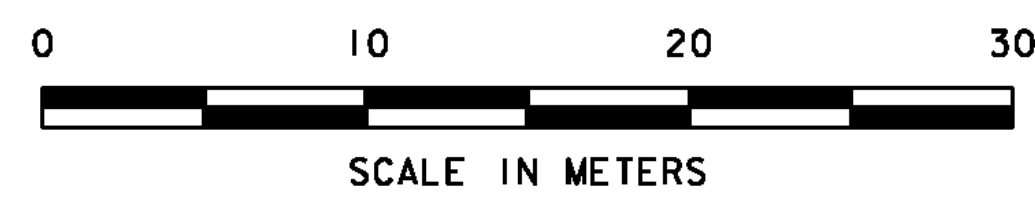

DATUM

VERTICAL	USGS
HORIZONTAL	ASSUMED

PROJECT: EAST MONTPELIER	PROJECT NO. : BRF 037-2 (8)
DESIGN FILE NAME: 86e054/structures/s86e054bdr.dgn	PLOT DATE: 18-AUG-2010
IPARM FILE NAME: se054signs.i	SURVEYED BY: R. MOREAU
SURVEYED BY: R. MOREAU	SURVEY DATE: 3/93
SQUAD LEADER: C.P. WILLIAMS	DRAWN BY: L.J. STONE
TRAFFIC SIGNS AND PAVEMENT MARKINGS	SHEET: 13 OF 63