

**From:** Cameron Abernathy  
**To:** Fowler, Chris (Precast)  
**Cc:** Jordan Koeppen; Bryce, Dave; 'pat@jpsicard.com'; Harris, Jason; Shippee, Nick  
**Subject:** RE: St. Johnsbury BF 7000 Wall Cap  
**Date:** Friday, March 31, 2017 3:07:33 PM  
**Attachments:** image001.png

If you look at our drawings we show the coping running past the end of the wall at WP4. Because the grade will be up to the bottom of the coping at this point, I so no issue with having a little coping overhanging the wall at this location. Thus you take what you have proposed and they install the cast in place portion per the contract plans then you can set each piece of coping going outward. What is left at each end can overhang as needed and it will not be an issue.

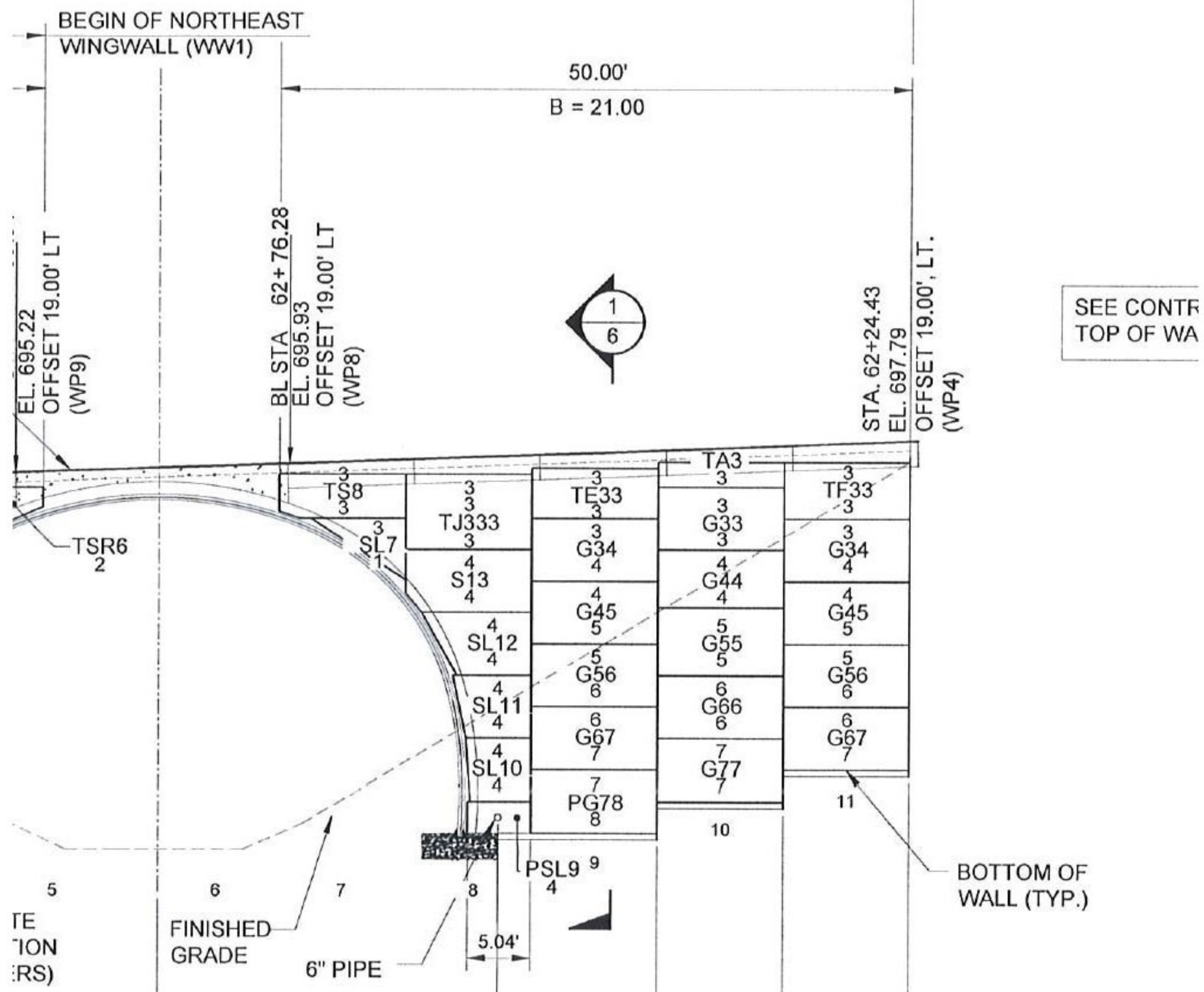

**Cameron Abernathy, PE**  
 Department Manager – Civil Products Engineering  
 Big R Bridge | [www.bigrbridge.com](http://www.bigrbridge.com)  
 Vist-A-Wall Systems | [vistawallsystems.com](http://vistawallsystems.com)  
 T 970-347-2216 | C 970-373-7197

**From:** Fowler, Chris (Precast) [mailto:Chris.Fowler@oldcastle.com]  
**Sent:** Friday, March 31, 2017 12:01 PM  
**To:** Cameron Abernathy <cabernathy@bigrbridge.com>  
**Cc:** Jordan Koeppen <jkoeppen@bigrbridge.com>; Bryce, Dave <Dave.Bryce@oldcastle.com>; 'pat@jpsicard.com' <pat@jpsicard.com>; Harris, Jason <Jason.Harris@oldcastle.com>; Shippee, Nick <Nick.Shippee@oldcastle.com>  
**Subject:** FW: St. Johnsbury BF 7000 Wall Cap

Cameron, Please see reviewer comment on layout. Do you agree with it and does it reconcile with your wall panel layout?

I trust that the coping layout should match the wall below?

Please advise.

Thanks, Chris