

REMOVAL AND DISPOSAL OF GUARDRAIL
 61+18 TO 62+25 RT
 61+67 TO 62+20 LT
 63+51 TO 65+04 RT
 63+56 TO 64+35 LT

GUARDRAIL APPROACH SECTION, GALVANIZED 2 RAIL BOX BEAM (COATED BLACK)
 62+18.7 TO 62+66.4 LT
 62+23.5 TO 62+67.9 RT
 63+06.5 TO 63+50.8 RT
 63+08 TO 63+55.7 LT

BOX BEAM GUARDRAIL (COATED BLACK)
 61+28 TO 62+23.5 RT
 61+71.9 TO 62+18.7 LT
 63+50.8 TO 64+92.8 RT
 63+55.7 TO 64+48 LT

MANUFACTURED TERMINAL SECTION, TANGENT (COATED BLACK)
 64+48 TO 64+62 LT
 64+92.8 TO 65+07 RT

DELINEATOR WITH STEEL POST
 61+28 RT
 61+71.9 LT
 64+62 LT
 65+07 RT

RELOCATE MAILBOX, MULTIPLE SUPPORT
 65+33 RT

CAST-IN-PLACE CONCRETE CURB, TYPE B
 63+08 TO 63+58 LT

EXTENSION SERVICE BOX AND CURB STOP
 64+92 RT

NOTE
 AN EXISTING 1 INCH WATER LINE IS LOCATED ALONG THE NORTH SIDE OF VT ROUTE 2B. CONTRACTOR SHALL INSTALL INCHES OF INSULATION BOARD FOR A 2 FEET WIDTH CENTERED OVER THE WATER LINE FROM APPROXIMATE STA 62+25 TO 63+50 LT. INSTALLATION WILL BE PAID FOR UNDER ITEM 622.10, INSULATION BOARD.

VT 2B CURVE (1)
 BRG BK = S35°12'45.77"E
 DELTA = 65°40'28" LT
 D = 15°04'40"
 R = 380.00'
 T = 245.24'
 E = 435.57'
 L = 72.27'
 BANK = 0.040

VT 2B STA 62+87.18 = RAIL TRAIL STA 79+60.89

VT 2B STA 62+00.00 END APPROACH BEGIN PROJECT

VT 2B STA 62+00.00 END APPROACH BEGIN PROJECT

VT 2B STA 62+00.00 END APPROACH BEGIN PROJECT

VT 2B STA 62+00.00 END APPROACH BEGIN PROJECT

VT 2B STA 62+00.00 END APPROACH BEGIN PROJECT

VT 2B STA 62+00.00 END APPROACH BEGIN PROJECT

VT 2B STA 62+00.00 END APPROACH BEGIN PROJECT

VT 2B STA 62+00.00 END APPROACH BEGIN PROJECT

VT 2B STA 62+00.00 END APPROACH BEGIN PROJECT

VT 2B STA 62+00.00 END APPROACH BEGIN PROJECT

VT 2B STA 62+00.00 END APPROACH BEGIN PROJECT

VT 2B STA 62+00.00 END APPROACH BEGIN PROJECT

VT 2B STA 62+00.00 END APPROACH BEGIN PROJECT

VT 2B STA 62+00.00 END APPROACH BEGIN PROJECT

VT 2B STA 62+00.00 END APPROACH BEGIN PROJECT

VT 2B STA 62+00.00 END APPROACH BEGIN PROJECT

VT 2B STA 62+00.00 END APPROACH BEGIN PROJECT

VT 2B STA 62+00.00 END APPROACH BEGIN PROJECT

VT 2B STA 62+00.00 END APPROACH BEGIN PROJECT

VT 2B STA 62+00.00 END APPROACH BEGIN PROJECT

VT 2B STA 62+00.00 END APPROACH BEGIN PROJECT

VT 2B STA 62+00.00 END APPROACH BEGIN PROJECT

VT 2B STA 62+00.00 END APPROACH BEGIN PROJECT

VT 2B STA 62+00.00 END APPROACH BEGIN PROJECT

VT 2B STA 62+00.00 END APPROACH BEGIN PROJECT

EXISTING DRAINAGE
 1 STA 62+12.5 LT TO 62+14.5 RT EXISTING 18" CGMP W/ DI REMOVE DI/ REMOVE 40" PIPE
 2 STA 62+43.9 LT TO 62+70.9 RT EXISTING 6" UNDERDRAIN REMOVE 45" PIPE
 3 STA 63+51.3 LT TO 63+66.0 LT EXISTING 18" CGMP W/ DI REMOVE DI/ REMOVE 20" PIPE CAP AND ABANDON REMAINING PIPE

PROPOSED DRAINAGE
 1 STA 63+51.0 LT NEW 18" X 15" CPEP(SL) NEW 4" DIA. PRCCB W/CI GRATE TYPE D AT 63+51.0
 2 STA 62+18.0 RT TO 62+72.0 LT NEW 6" X 9" UNDERDRAIN INV IN = 691.15 INV OUT = 690.24
 3 STA 63+03.0 TO 63+51.0 LT NEW 6" X 51" UNDERDRAIN INV IN = 690.26 INV OUT = 688.88 CONNECT TO NEW CB AT 63+51.0
 4 STA 63+38.0 LT TO 65+04.0 RT NEW 6" X 180" UNDERDRAIN INV IN = 686.34 INV OUT = 684.54

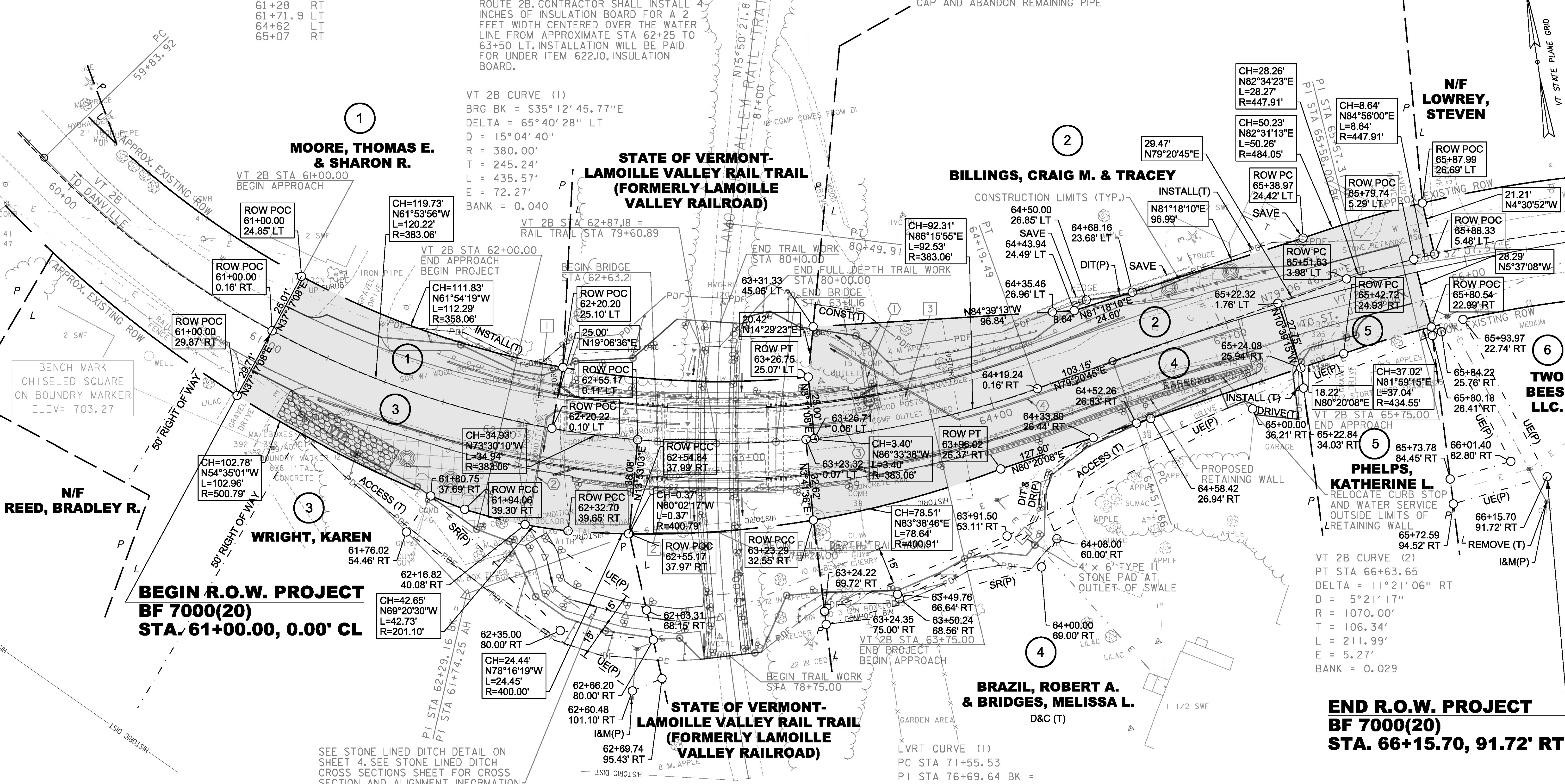

FOR ROW PURPOSES ONLY

LINES SHOWN ON THIS PLAN AS EXISTING PROPERTY LINES (P/L) ARE BELIEVED TO BE ACCURATE BUT SHOULD NOT BE RELIED UPON FOR PURPOSES UNRELATED TO THE STATE OF VERMONT ACQUISITION OF LAND AND RIGHTS FOR THIS PROJECT

CONSTRUCT DRIVES
 61+06 RT (24.0 FT WIDE, 4 FT PAVED APRON, RES.)
 61+30 LT (24.0 FT WIDE, 4 FT PAVED APRON, RES.)
 65+20 RT (13.5 FT WIDE, PAVED, RES.)
 65+45 RT (9.7 FT WIDE, 6.5 FT PAVED APRON, RES.)

EXISTING BRIDGE DATA
 THREE SPAN ROLLED BEAM, CONCRETE DECK BUILT 1936. 129' LENGTH, 42' MAX SPAN 26'-5" MIN UNDERCLEAR.

LVRT CURVE (1)
 PC STA 71+55.53
 PI STA 76+69.64 BK =
 PI STA 75+35.80 AHD
 BRG BK = N 54°50'34.00"W
 DELTA = 70°40'56" RT
 D = 7°54'10"
 R = 725.00'
 T = 514.11'
 L = 894.39'
 E = 163.78'

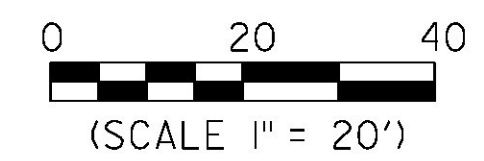

PROJECT NAME: ST. JOHNSBURY
PROJECT NUMBER: BF 7000(20)
FILE NAME: z86e048bdrrow.dgn
PROJECT LEADER: J.BYATT
DESIGNED BY: M.HALEY
ROW LAYOUT SHEET 1

PLOT DATE: 8/4/2016
DRAWN BY: S.GOODWIN
CHECKED BY: P.SHEDD
SHEET 70 OF 70

CLD 14-016