

DS 80
 STA 54+00 RT ~ 55+120 RT 18" x 108' CPER (SL)

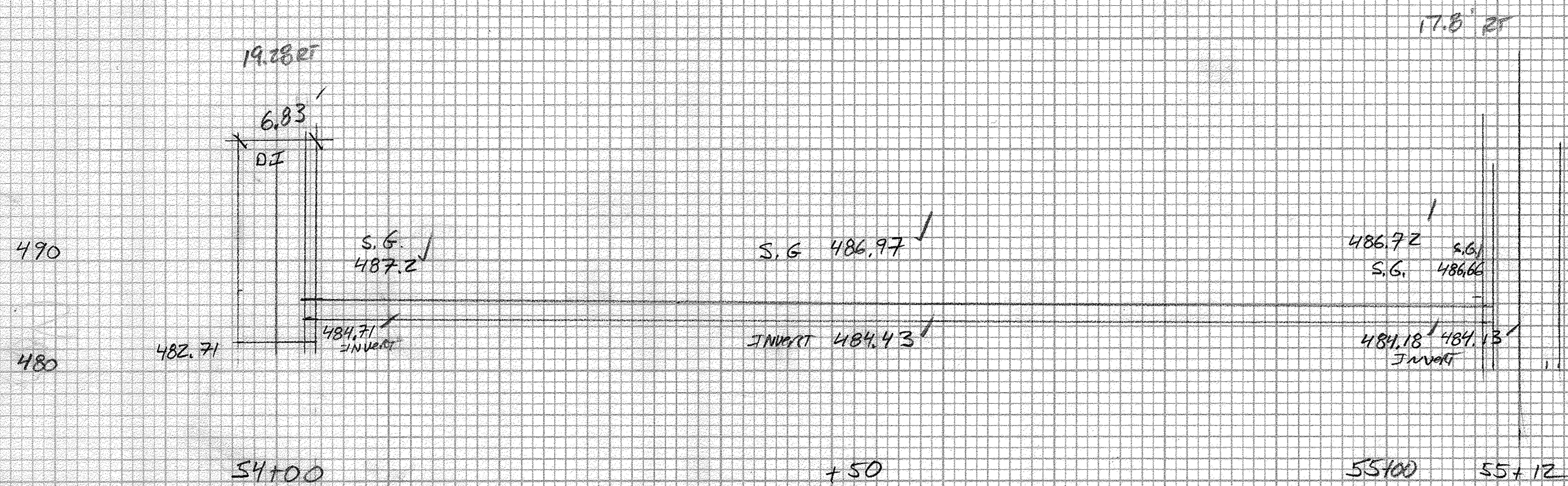

DS-82
 DEVIN ST
 STA 40+36.1 LT ~ 55+120 RT 18" x 20' CPER S.L.

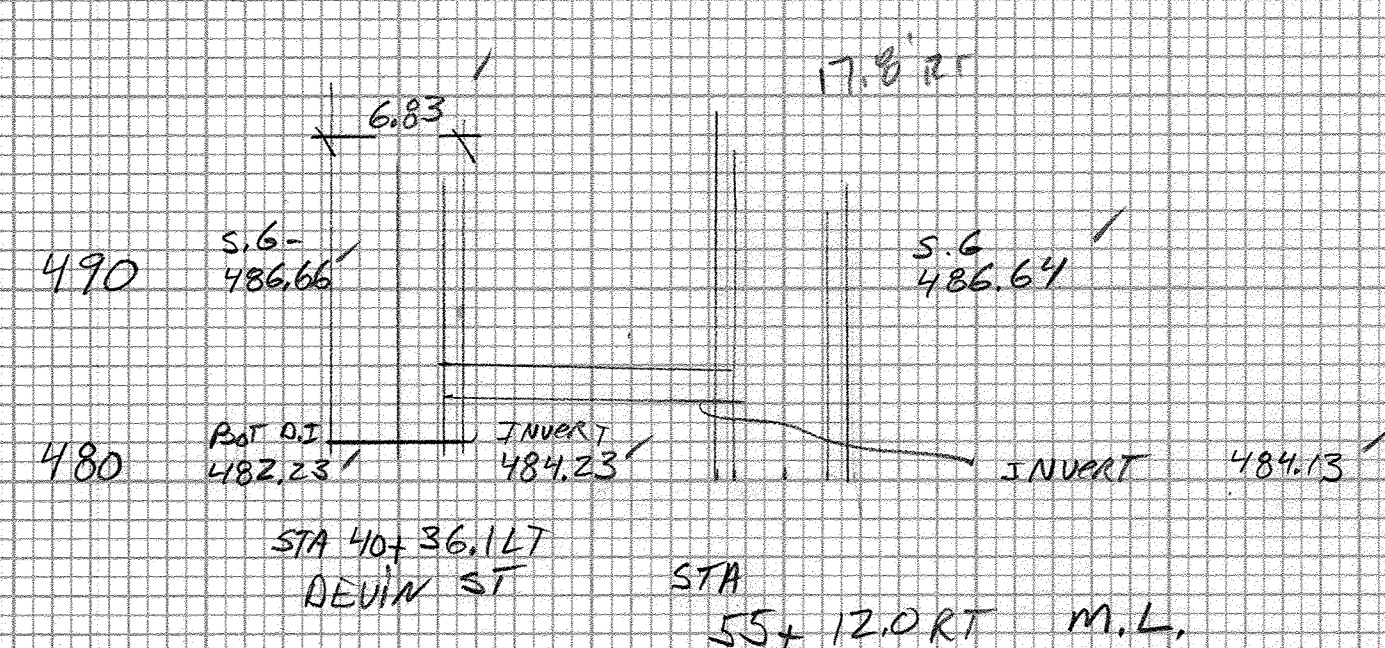

T.E. STRUCTURE $\frac{487.2 - 482.71}{4.49} \times \frac{(3.14 \times 3.42^2)}{27} = 6.11 \text{ cy}$

G.B. $107.3' \times 3.75' \times (.875) = \frac{352.06}{27} = 13.04 \text{ cy}$
 $- 107.3' \times \frac{(3.14 \times (.875)^2)}{2} = \frac{128.78}{27} = 4.78 \text{ cy}$
 $\underline{\underline{8.26 \text{ cy}}}$

T.E. STRUCTURE $\frac{486.66 - 482.23}{4.43} \times \frac{(3.14 \times (3.42)^2)}{27} = 6.02 \text{ cy}$

T.E. Pipe $13' \times \frac{(2.43 + 25)}{2} \times 3.75 = \frac{120.41}{27} = 4.46 \text{ cy}$

STA	DEPTH	AUG. DEPTH	WIDTH	VOLUME
54+3.42	2.49'	(X)	2.515' x 3.75'	439.30 FT ³
54+50	2.54'	(X)	2.54' x 3.75'	476.25 FT ³
55+00	2.54'	(X)	2.535' x 3.75'	81.56 FT ³
55+08.58	2.53'	(X)		
				$\frac{997.12}{27} = 36.93 \text{ cy}$

6/3 01/28/08

OPH 1/28/08

G.B. Pipe $15' \times .875 \times (3.75) = \frac{49.22}{27} = 1.82 \text{ cy}$

- Pipe $15' \times \frac{3.14 \times (.875)^2}{2} = \frac{18.03}{27} = .68 \text{ cy}$
 $\underline{\underline{1.14 \text{ cy}}}$

6/3 01/28/08

OPH 1/28/08

ORIGINAL SURVEY	DATE
NOTED	DATE
AMENDS	DATE
NO.	DATE

FINAL SURVEY	DATE
NOTED	DATE
AMENDS	DATE
NO.	DATE