

SUBBASE = 114.75 ✓
 COMMON = 157.35 ✓
 F.G. = 49.0 ✓
 01/25/11
 01/19/11

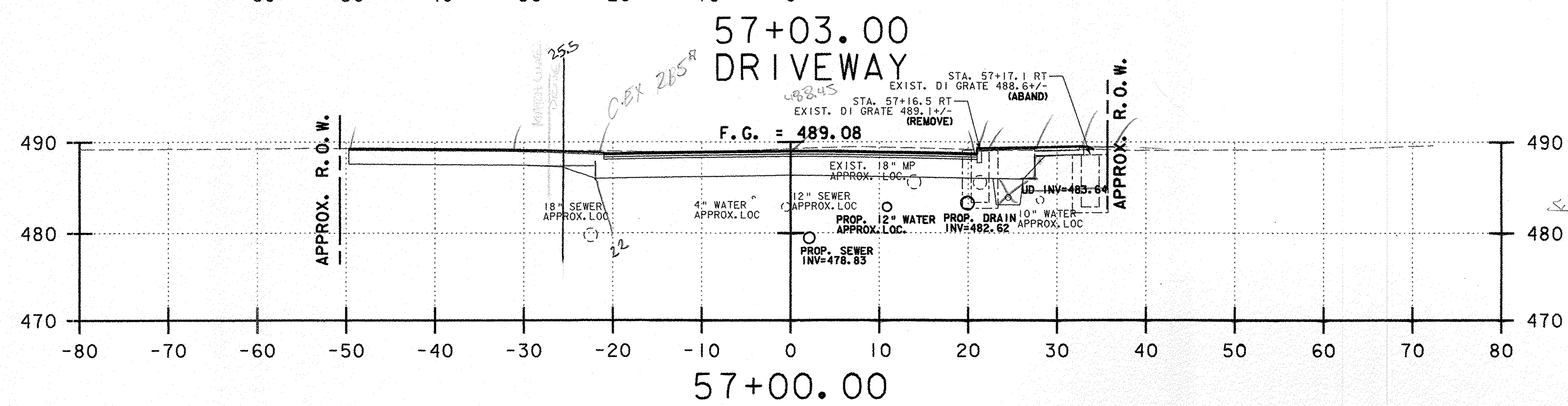
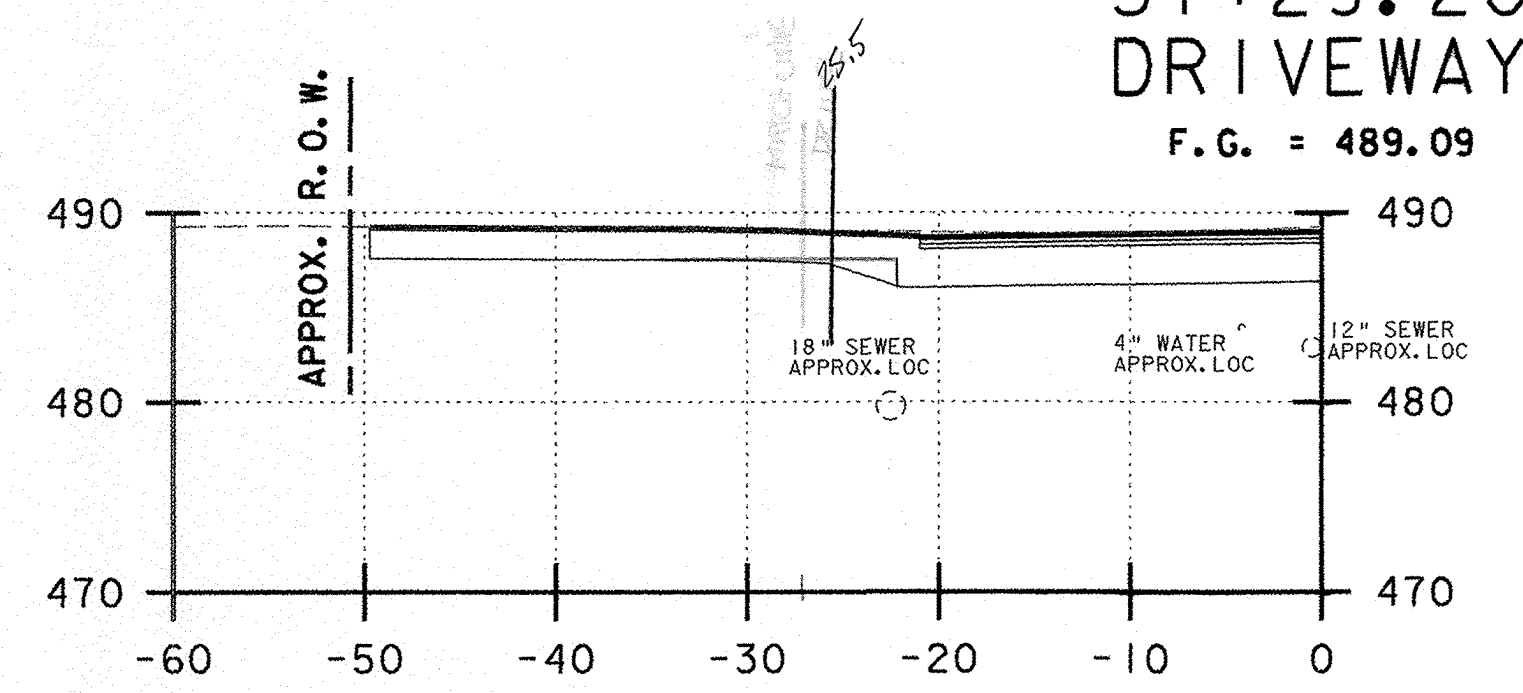
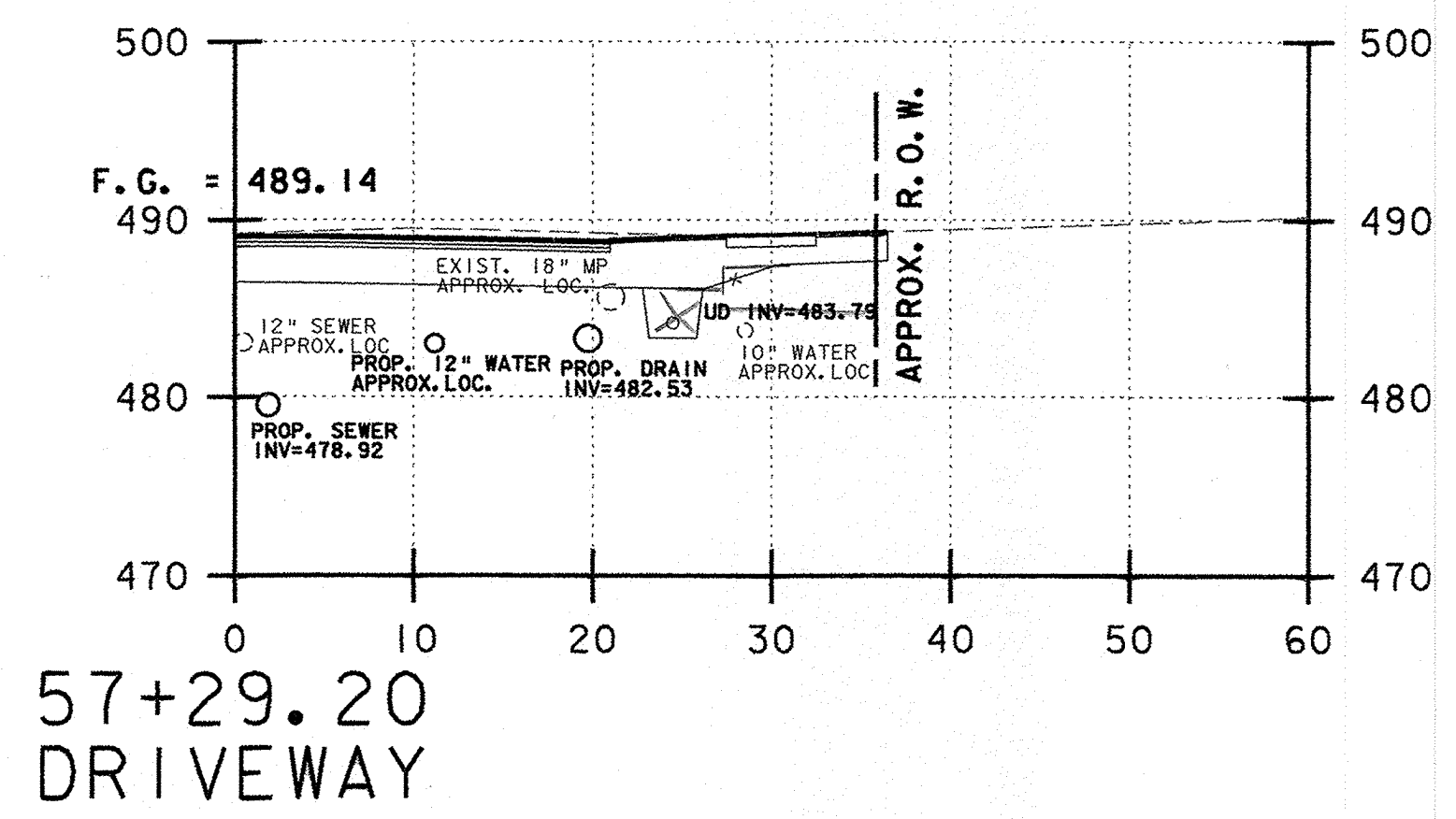

SUBBASE 116.06 ✓
 COMMON = 157.25 ✓
 F.G. = 49.0 ✓
 01/25/11
 01/19/11

NOTES:
 1) REFER TO ROADWAY LAYOUT AND UTILITY LAYOUT SHEETS FOR PROPOSED ABANDONMENT, REMOVAL, OR PROTECTION REQUIREMENTS OF EXISTING UTILITIES IN CONFLICT WITH PROPOSED WORK.

U.S. ROUTE 5 HARTFORD AVENUE

PROJECT NAME: HARTFORD	PLOT DATE: 1/11/2007
PROJECT NUMBER: RS 0113(40)	DRAWN BY: E. ATKINS
FILE NAME: z86c027xsl.dgn	CHECKED BY: K. ISHIKURA
PROJECT LEADER: KEN UPMAL	SHEET 222 OF 239
DESIGNED BY: K. ISHIKURA	
E. ATKINS	