

SUBBASE = 125.2 SF
 COMMON = 182.7 SF
 F.G. = 54.0 LF RCD 1/25/11
 BLD 3/23/10
 RCD 1/12/11
 CUB 01/19/11

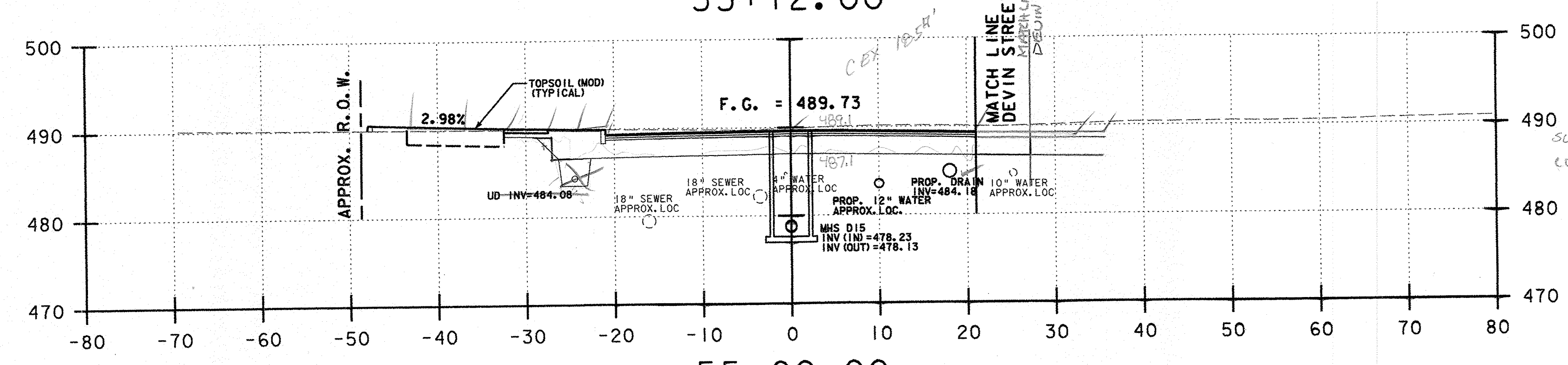

SUBBASE = 116.23 SF
 COMMON = 176.1 SF
 F.G. = 54.0 LF RCD 1/25/11
 BLD 3/23/10
 RCD 1/12/11
 CUB 01/19/11

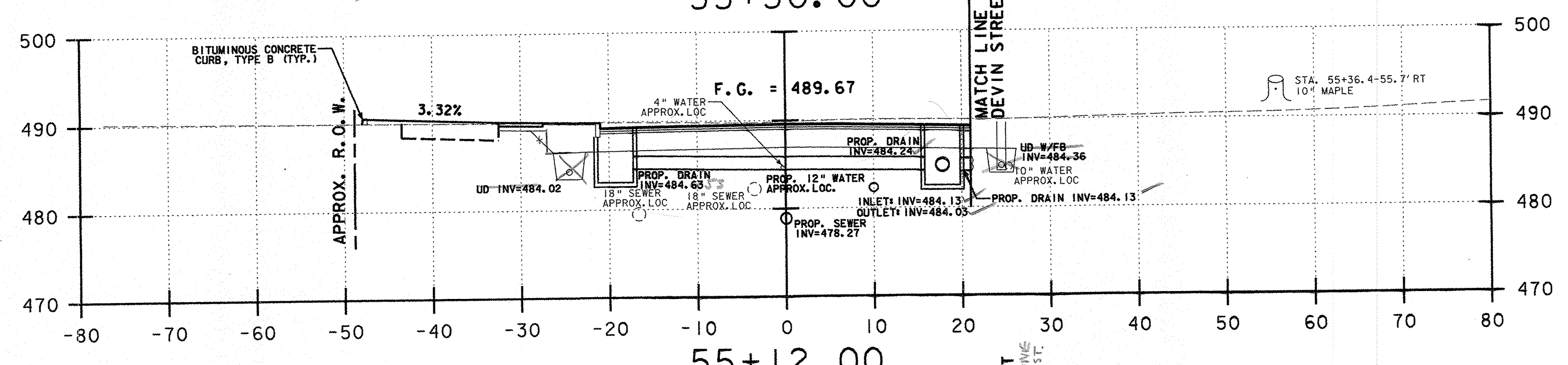
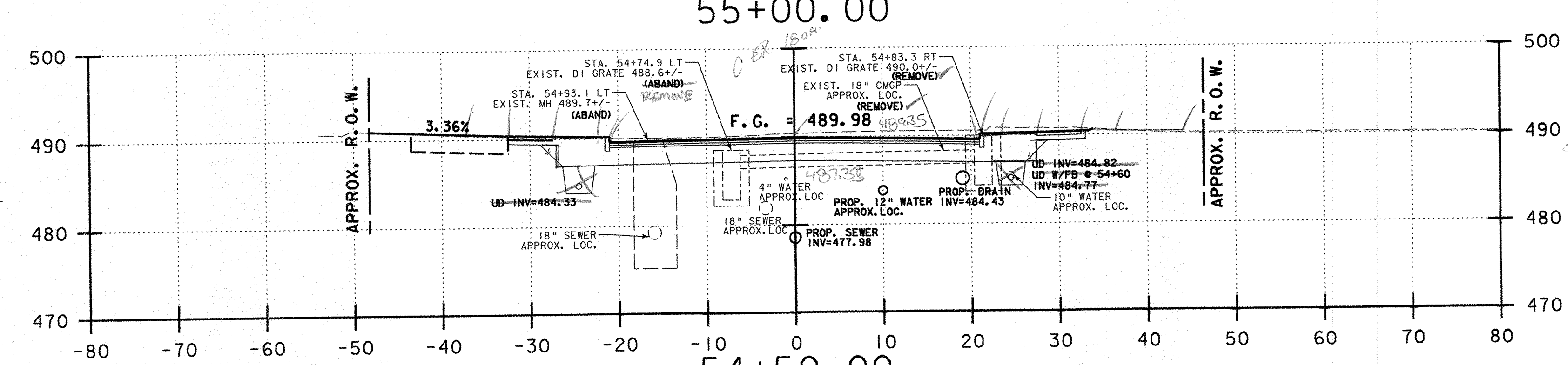

SUBBASE = 124.97 SF
 COMMON = 186.3 SF
 F.G. = 54.0 LF RCD 1/25/11
 BLD 3/23/10
 RCD 1/12/11
 CUB 01/19/11

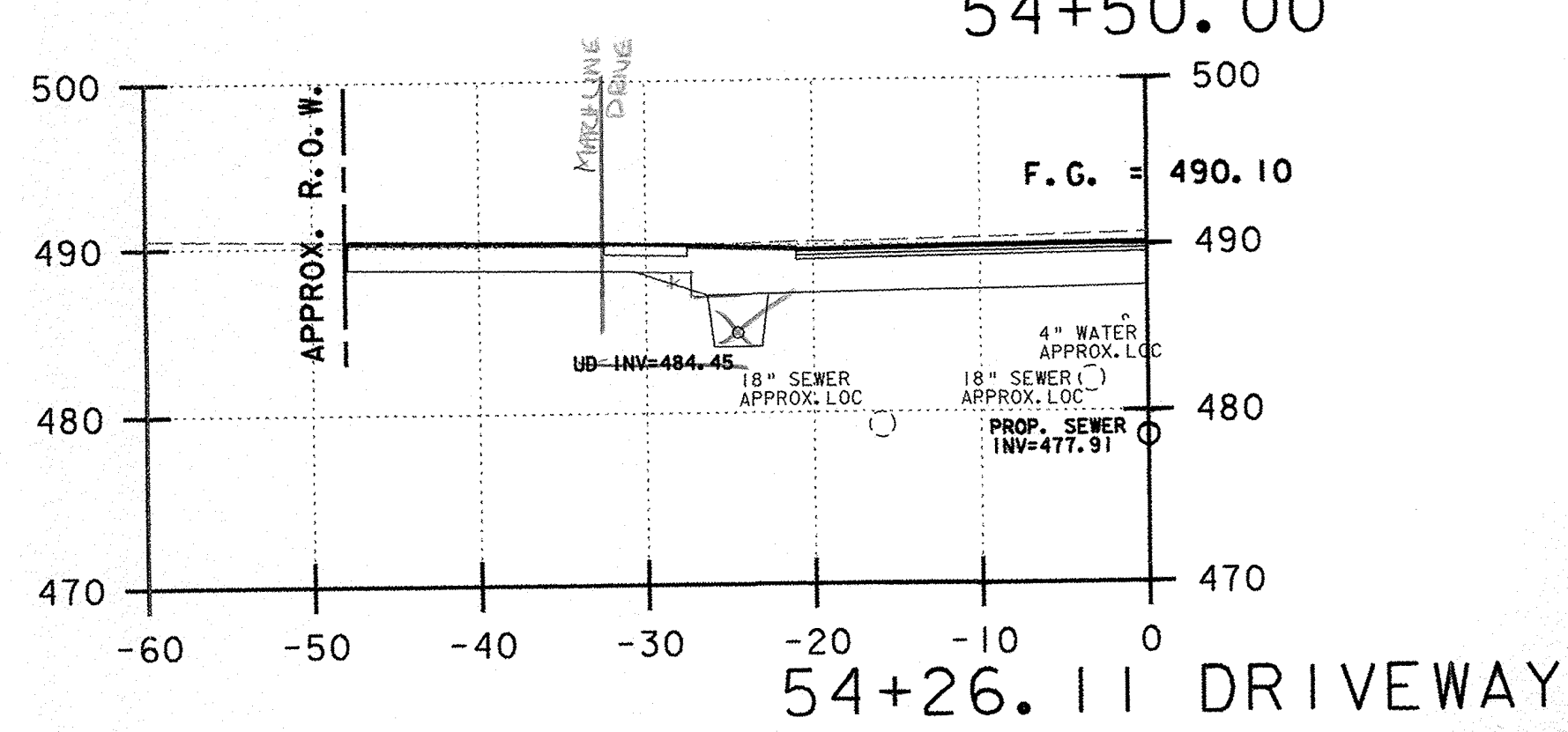

NOTES:
 1) REFER TO ROADWAY LAYOUT AND UTILITY LAYOUT SHEETS FOR PROPOSED ABANDONMENT, REMOVAL, OR PROTECTION REQUIREMENTS OF EXISTING UTILITIES IN CONFLICT WITH PROPOSED WORK.

U.S. ROUTE 5 HARTFORD AVENUE

PROJECT NAME: HARTFORD		PLOT DATE: 1/11/2007	
PROJECT NUMBER: RS 0113(40)		DRAWN BY: E. ATKINS	
FILE NAME: z86c027xsl.dgn	DESIGNED BY: K. ISHIKURA	CHECKED BY: K. ISHIKURA	SHEET 220 OF 239
		E. ATKINS	