

41+12.14 DRIVEWAY  
SKEWED 3°22'10.5" RT

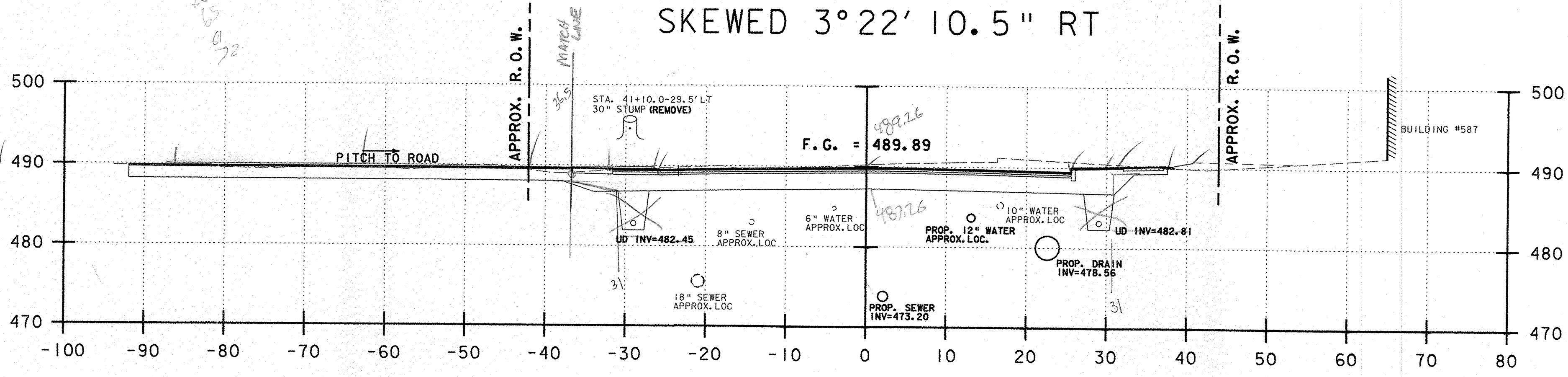

41+00.00

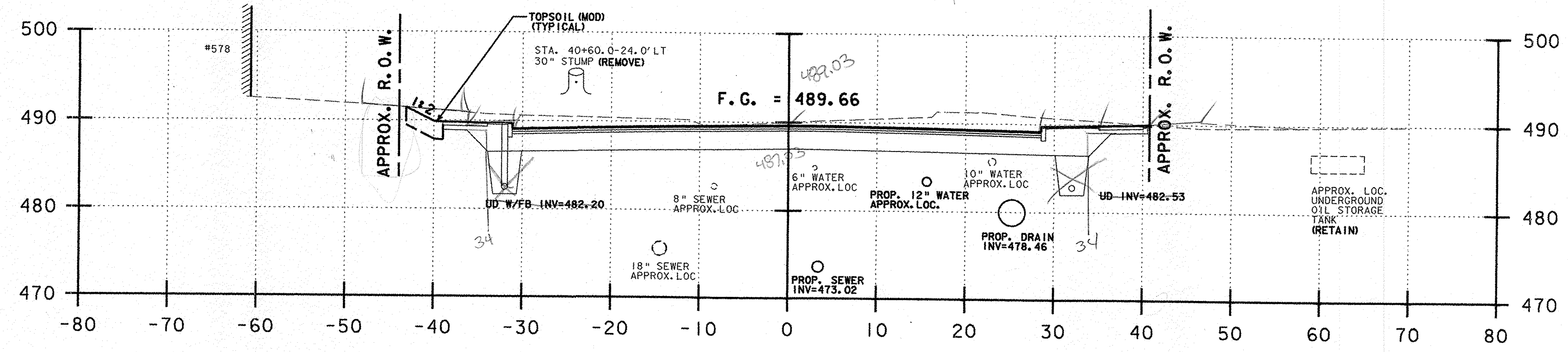

40+50.00

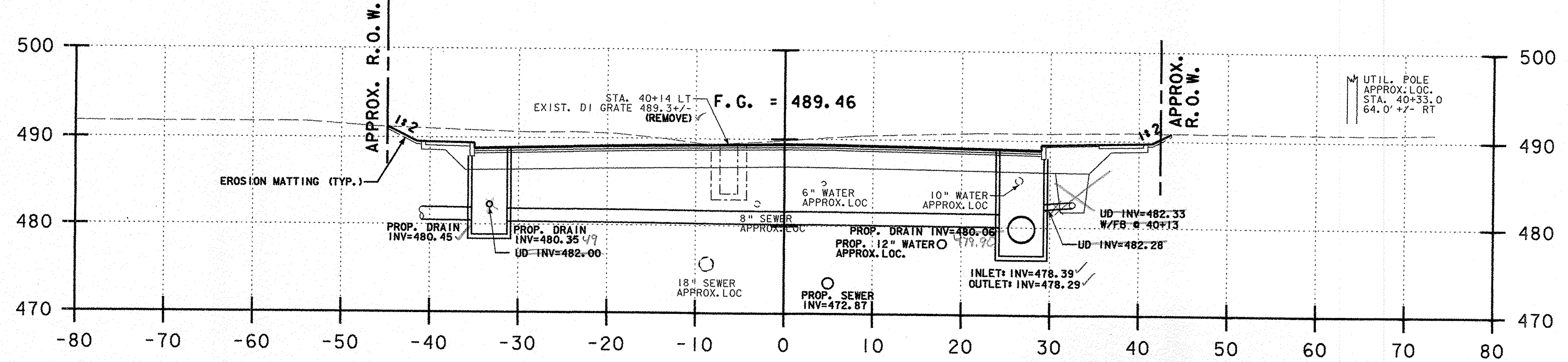

40+10.00

COMMON EXCAVATION ROADWAY = 137x155 = 2125 SF  
DRIVEWAY LEFT CH1.50 = 98 SF  
BL 3/19/10  
RED 1/11/11

SUBBASE = 142 SF  
BL 3/23/10  
RED 1/11/11

F.G. = 62.0 LF  
RED 1/24/11

SUBBASE = 148 SF  
BL 3/23/10  
RED 1/11/11

COMMON EXCAVATION ROADWAY = 180x155 = 2790 SF  
LANDSCAPE = 4.5x2 = 9 SF  
BL 3/23/10  
RED 1/11/11

F.G. = 68.0 LF  
RED 1/24/11

NOTES:  
1) REFER TO ROADWAY LAYOUT AND UTILITY LAYOUT SHEETS FOR PROPOSED ABANDONMENT, REMOVAL, OR PROTECTION REQUIREMENTS OF EXISTING UTILITIES IN CONFLICT WITH PROPOSED WORK.

## U.S. ROUTE 5 HARTFORD AVENUE

PROJECT NAME: HARTFORD	
PROJECT NUMBER: RS 0113(40)	
FILE NAME: z86c027xsl.dgn	PLOT DATE: 1/11/2007
PROJECT LEADER: KEN UPMAL	DRAWN BY: E. ATKINS
DESIGNED BY: K. ISHIKURA	CHECKED BY: K. ISHIKURA
E. ATKINS	SHEET 207 OF 239