

205  
192

SUBBASE 15B23 ✓ BL 3/23/10  
2377 RCD 1/11/11

COMMON EXCAVATION ROADWAY 20.5x1.55=3175.45 BL 3/23/10  
298.1 SF RCD 1/11/11

F.G.=73.0 LF RCD 1/24/11  
CUB 01/11/11

40+00.00

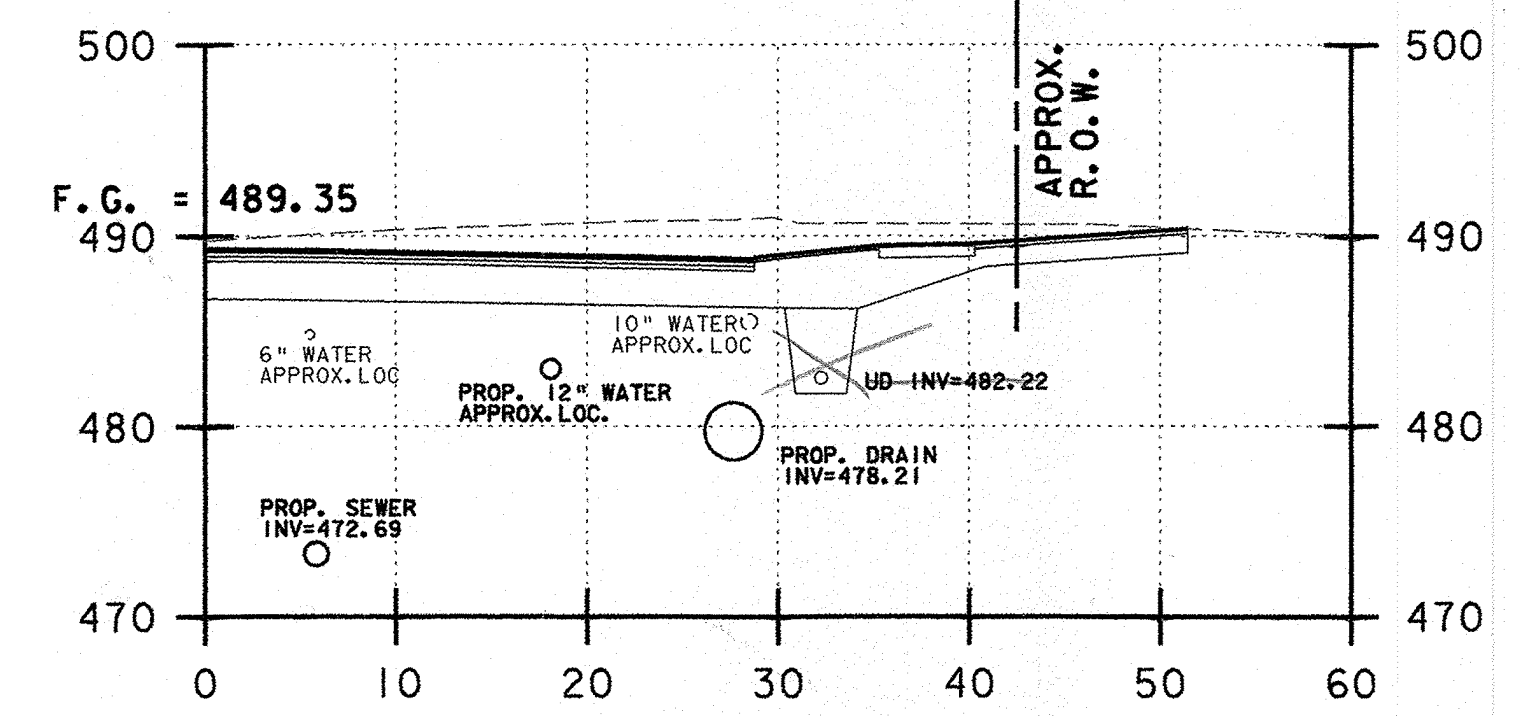

39+88.68 DRIVEWAY  
ASKEW 4° 34' 2.4" RT

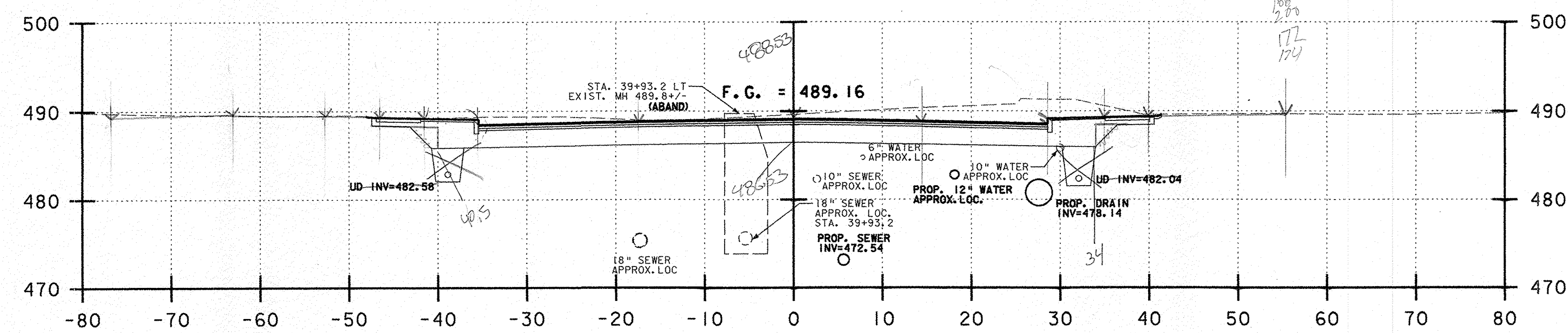

COMMON EXCAVATION ROADWAY 18.8x1.55=291.90 BL 3/23/10  
RCD 1/11/11

SUBBASE 16S129 ✓ BL 3/23/10  
RCD 1/11/11

F.G.=74.5 LF RCD 1/24/11  
CUB 01/24/11

39+50.00

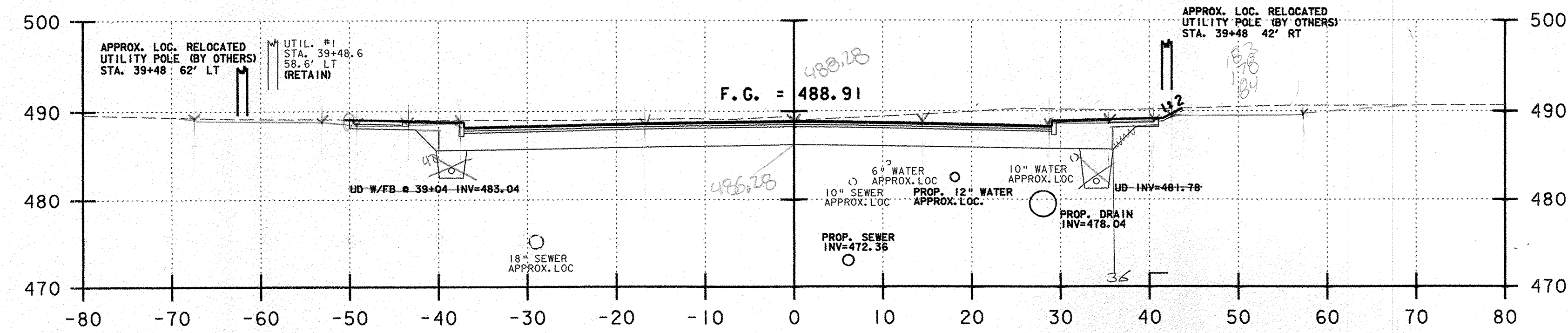

COMMON EXCAVATION ROADWAY 18.0x1.55=279.00 ✓ BL 3/23/10  
RCD 1/11/11

SUBBASE 16S158 ✓ BL 3/23/10  
RCD 1/11/11

F.G.=76.0 LF RCD 1/24/11  
CUB 01/24/11

39+00.00

NOTES:  
1) REFER TO ROADWAY LAYOUT AND UTILITY LAYOUT SHEETS FOR PROPOSED ABANDONMENT, REMOVAL, OR PROTECTION REQUIREMENTS OF EXISTING UTILITIES IN CONFLICT WITH PROPOSED WORK.

## U.S. ROUTE 5 HARTFORD AVENUE

PROJECT NAME:	HARTFORD	PLOT DATE:	1/11/2007
PROJECT NUMBER:	RS 0113(40)	DRAWN BY:	E. ATKINS
FILE NAME:	z86c027xsl.dgn	CHECKED BY:	K. ISHIKURA
PROJECT LEADER:	KEN UPMAL	SHEET	206 OF 239
DESIGNED BY:	K. ISHIKURA		
	E. ATKINS		