

COMMON EXCAVATION  
 STAN DITCH = 5.0 SF  
 ROADWAY LEFT (1.3/12) = 2.0 SF  
 ROADWAY RIGHT (1.2/12) = 6.0 SF  
 COMMON = 13 SF  
 (BACK) (AHEAD)  
 80.0 SF  
 3/23/10  
 SAND 84.75  
 SUBBASE 133.40  
 F.G. = 72.0 LF  
 REC 1/11/11  
 REC 1/24/11  
 1/25/11

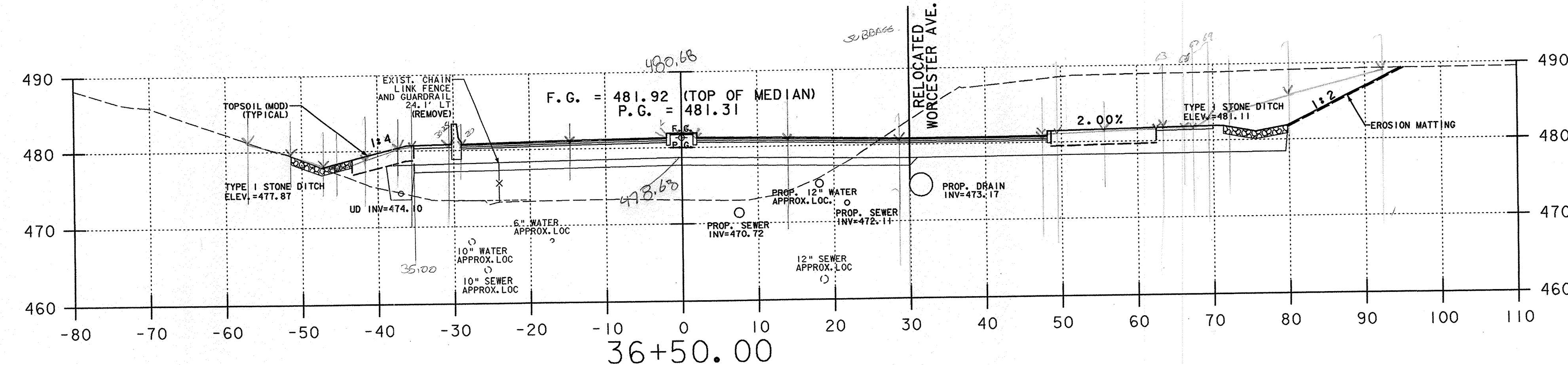

COMMON EXCAVATION  
 TYPE 1 DITCH LEFT = 5.25 SF  
 MAINLINE ROADWAY 2x6x12 = 27.5 SF  
 ? WORCESTER AVE.  
 COMMON = 32.75 SF  
 3/23/10  
 SAND 65  
 SUBBASE 130.63 SF  
 F.G. = 68.0 LF  
 REC 1/11/11  
 REC 1/24/11  
 1/25/11

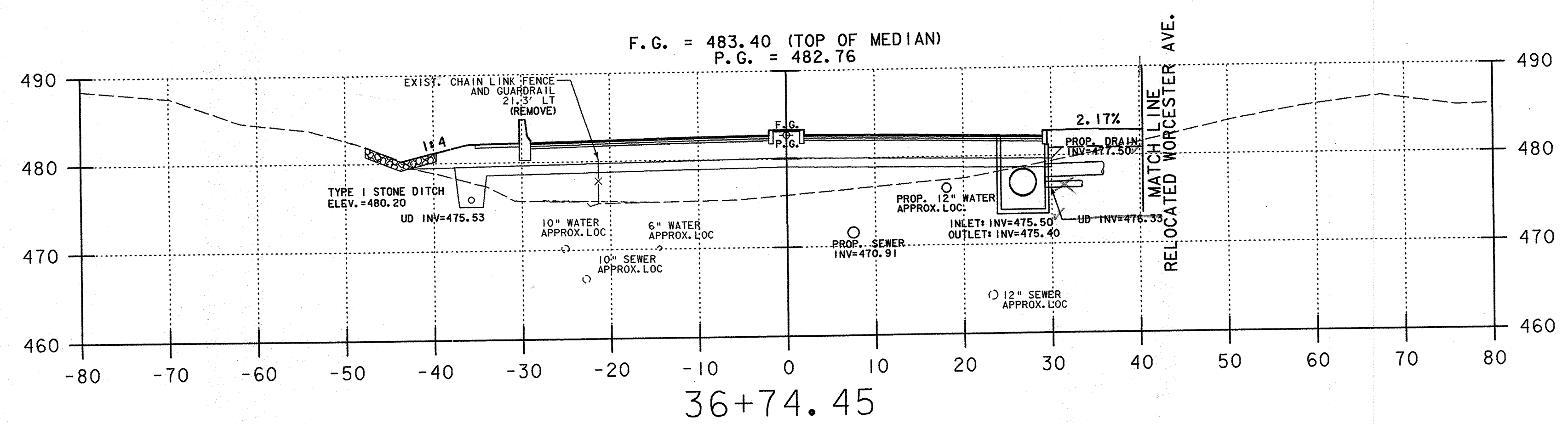
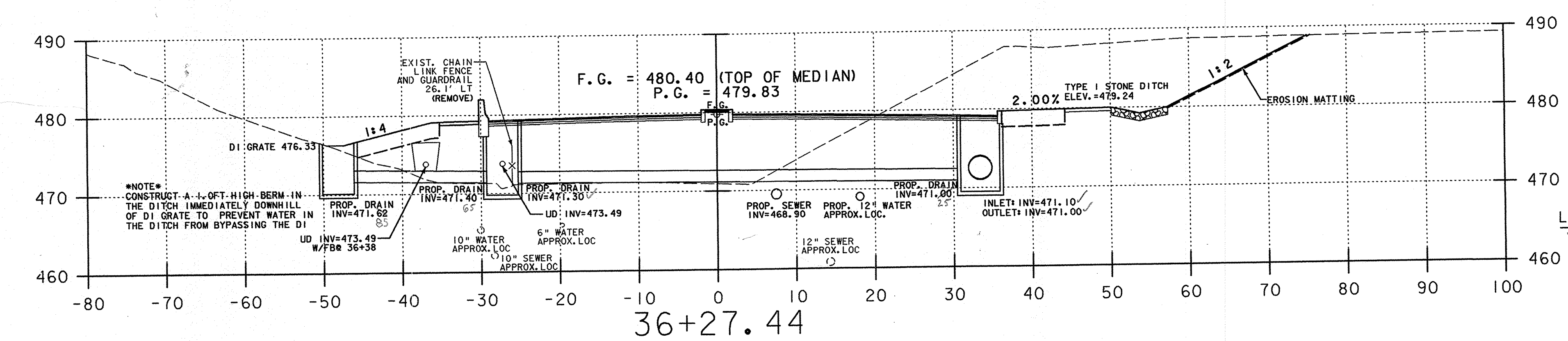

- NOTES:
- REFER TO ROADWAY LAYOUT AND UTILITY LAYOUT SHEETS FOR PROPOSED ABANDONMENT, REMOVAL, OR PROTECTION REQUIREMENTS OF EXISTING UTILITIES IN CONFLICT WITH PROPOSED WORK.
  - THE WALL SHOWN ON THE SECTIONS IS FOR PRESENTATION ONLY. SEE U.S. RTE. 5 SHEET PILE WALL PLAN AND PROFILE SHEETS AND DETAIL SHEETS FOR CONSTRUCTION REQUIREMENTS.

## U.S. ROUTE 5 HARTFORD AVENUE

LEGEND:  
 F.G. FINISHED GRADE  
 P.G. PROFILE GRADE

PROJECT NAME: HARTFORD	
PROJECT NUMBER: RS 0113(40)	
FILE NAME: ...z86c027xsl.DGN	PLOT DATE: 3/13/2008
PROJECT LEADER:	DRAWN BY: T. DUGUAY
DESIGNED BY: D. HOWEY	CHECKED BY: D. WOTRING
SHEET 10 OF 14	