

Common Excavation
 DITCH TYPE I LT = 5.5 SF
 ROADWAY 19.51155 = 202.25
 Common = 307.75 SF
 01/11/11

BL 3/23/10
 SAND 68.5
 SUBBASE 187.83
 164.4 SF
 F.G. = 84.0 LF
 RCD 1/24/11
 01/24/11

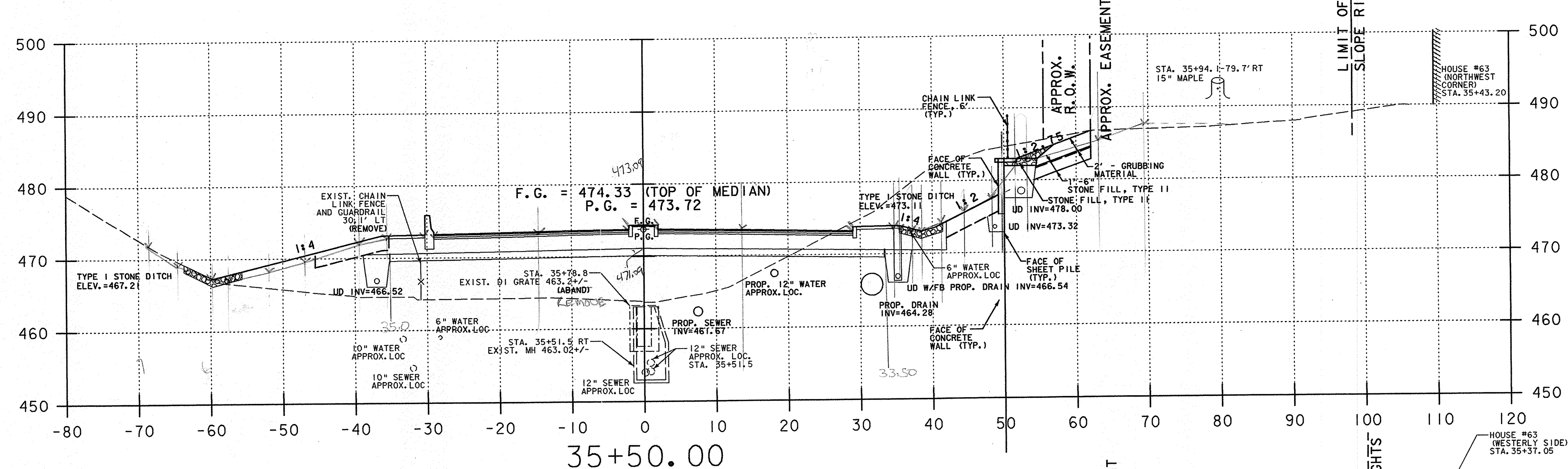

Common Excavation
 DITCH LEFT 9.5 SF
 ROADWAY 12.11155 = 142.55
 LANDSCAPE RT = 82.1605 SF
 LANDSCAPE LT = 0.5 SF
 Common = 184.22 SF
 188.75 - 0.5 = 188.25 SF
 01/11/11

BL 3/23/10
 SAND 68.5
 SUBBASE 167.98
 167.27
 F.G. = 80.0 LF
 RCD 1/24/11
 01/25/11

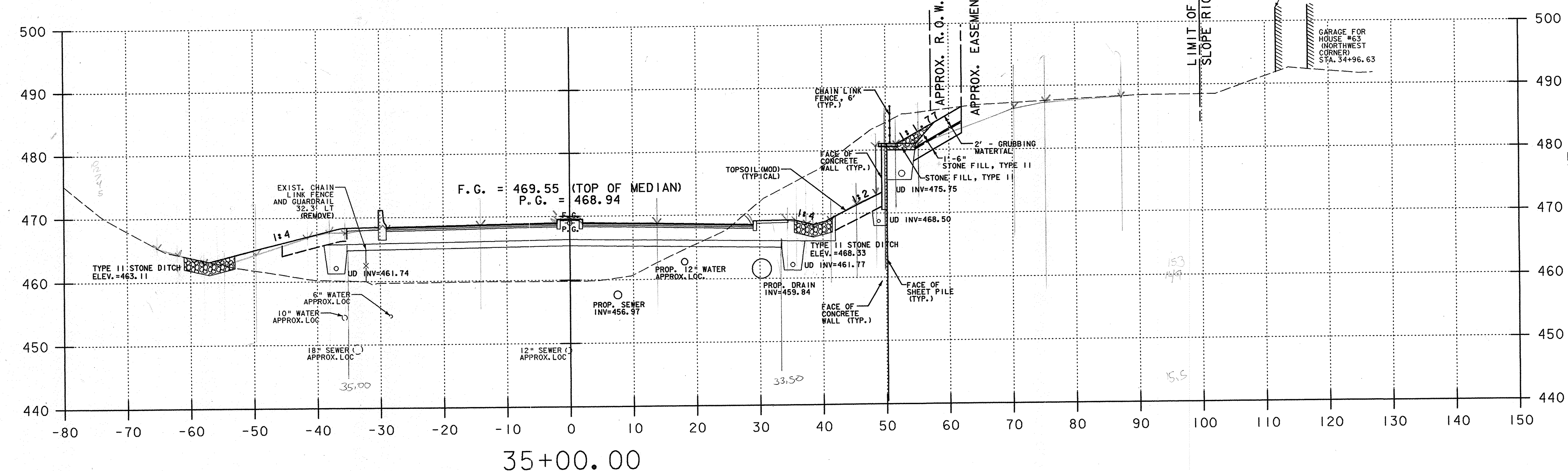

BL 3/23/10
 SAND 68.5
 SUBBASE 154.6 SF
 154.6 SF
 Common Excavation 11.5 SF
 DITCH LEFT 11.5 SF
 ROADWAY = 15.11155 = 239.05
 LANDSCAPE RT = 82.1605 SF
 LANDSCAPE LT = 0.5 SF
 Common = 245.55 SF
 F.G. = 80.0 LF
 RCD 1/24/11
 01/25/11

LEGEND:
 F.G. FINISHED GRADE
 P.G. PROFILE GRADE

NOTES:
 1) REFER TO ROADWAY LAYOUT AND UTILITY LAYOUT SHEETS FOR PROPOSED ABANDONMENT, REMOVAL, OR PROTECTION REQUIREMENTS OF EXISTING UTILITIES IN CONFLICT WITH PROPOSED WORK.
 2) THE WALL SHOWN ON THE SECTIONS IS FOR PRESENTATION ONLY. SEE U.S. RTE. 5 SHEET PILE WALL PLAN AND PROFILE SHEETS AND DETAIL SHEETS FOR CONSTRUCTION REQUIREMENTS.

U.S. ROUTE 5 HARTFORD AVENUE

PROJECT NAME:	HARTFORD	PLOT DATE:	3/13/2008
PROJECT NUMBER:	RS 0113(40)	DRAWN BY:	T. DUGUAY
FILE NAME:	...z86c027xsl.DGN	CHECKED BY:	D. WOTRING
PROJECT LEADER:		SHEET	9 OF 14
DESIGNED BY:	D. HOWEY		