

158/137

STRUCTURE EXCAVATION  
 $4.5' \times (4.0' + 6.0') = 22.5 SF$   
 $+ 1.5' \times (3.0' + 3.5') = 4.88 SF$   
 $- 6.0 SF$  LANDSCAPE  
 $21.38 SF$  RCD 2/11/11

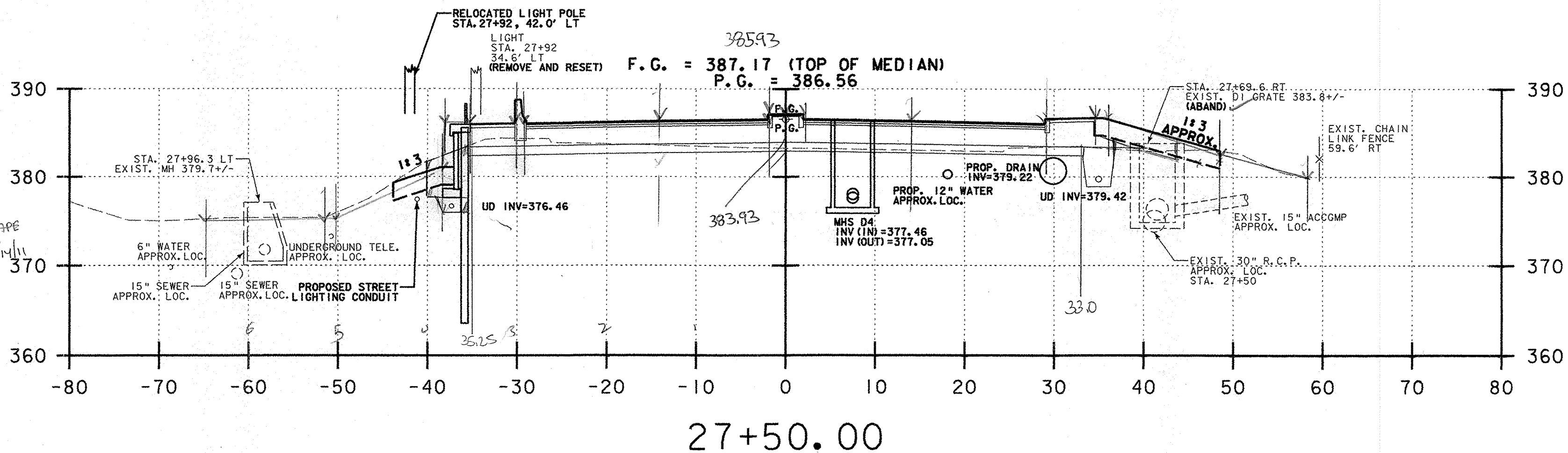

COMMON EXCAVATION ROADWAY 32/35/31 34155 = 530 } BL 3/23/10  
LANDSCAPE LEFT 12x105 = 186 SF } RCD 1/10/11  
LANDSCAPE RIGHT 2x155 = 310 SF }

SAND 68.25 } BL 3/23/10  
SUBBASE 145.61 } RCD 1/10/11  
F.L. = 72' CUB 01/24/11  
RCD 1/25/11

STRUCTURE EXCAVATION  
 $4.5' \times (5.25' + 7.0') = 27.56 SF$   
 $1.5' \times (3.0' + 3.5') = 4.88 SF$   
 $- 6.0 SF$  LANDSCAPE  
 $26.44 SF$  RCD 2/11/11  
DIGITAL PLANIMETER = 26.33 RCD 2/11/11

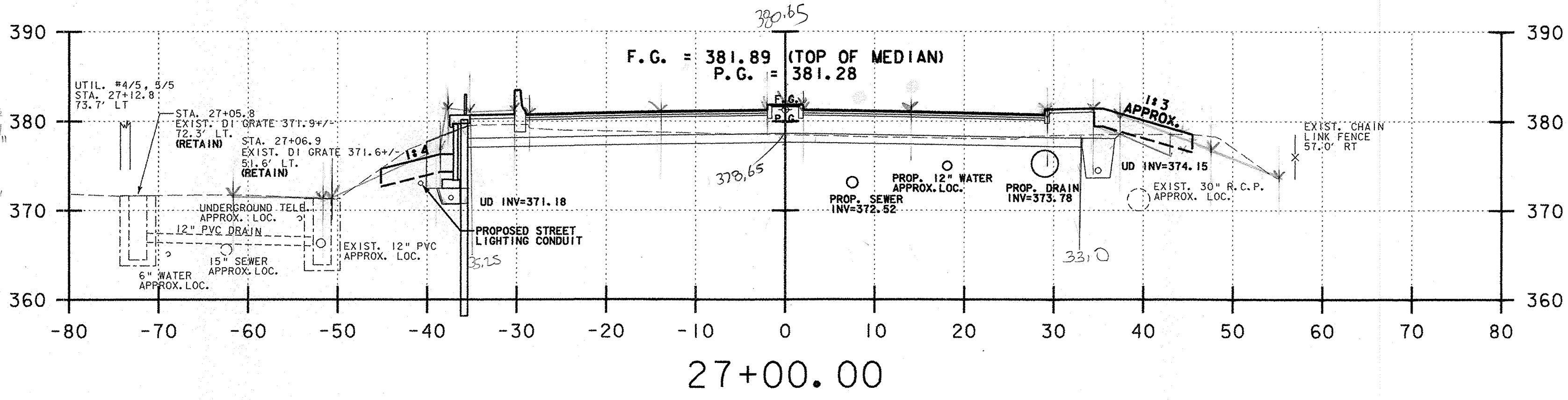

COMMON EXCAVATION ROADWAY 55/57/59 = 56x155 = 87 SF } BL 3/23/10  
LANDSCAPE LEFT 10x115 = 27.5 SF } RCD 1/10/11  
LANDSCAPE RIGHT 2x155 = 310 SF }

SAND 68.25 } BL 3/23/10  
SUBBASE 144.29 } RCD 1/10/11  
F.L. = 72' CUB 01/24/11  
RCD 1/25/11

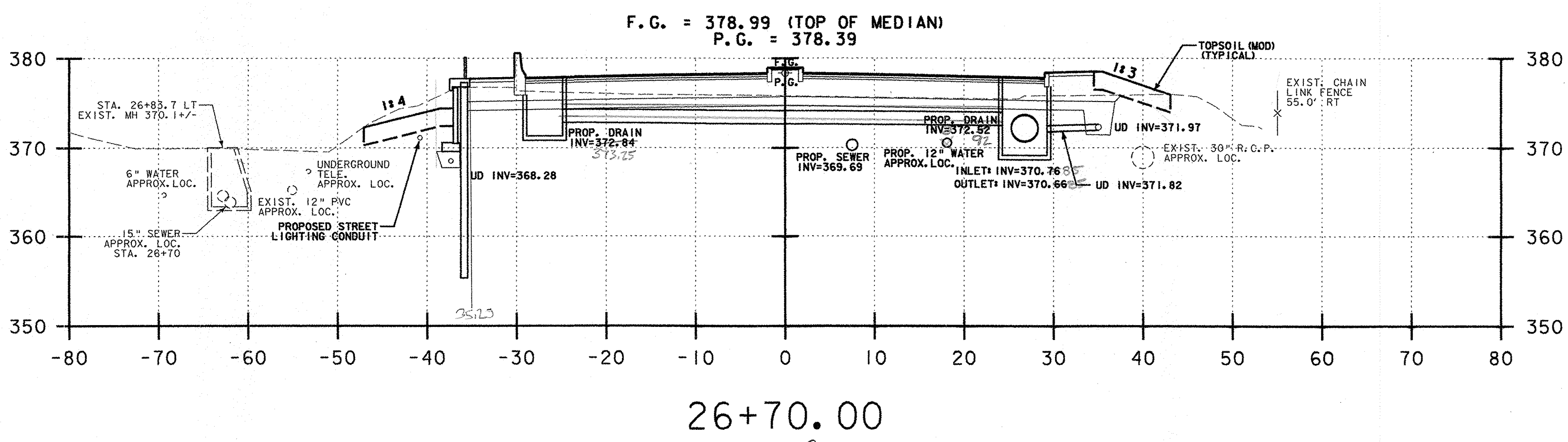

SAND 68.25

STRUCTURE EXCAVATION  
 $4.5' \times (5.25' + 7.0') = 27.56 SF$   
 $1.5' \times (3.0' + 3.5') = 4.88 SF$   
 $- 3.0 SF$  LANDSCAPE  
 $29.44 SF$  RCD 2/11/11

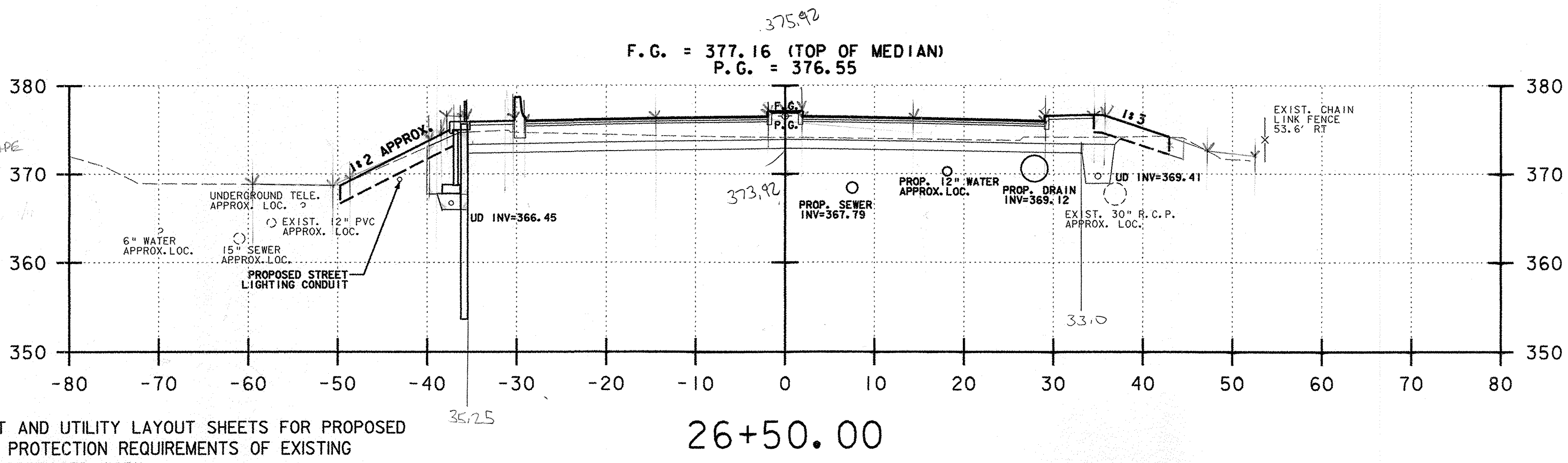

LEGEND:

- F.G. FINISHED GRADE
- P.G. PROFILE GRADE

COMMON EXCAVATION ROADWAY 77/73/76 = 75 = 116 SF } BL 3/23/10  
LANDSCAPE LEFT = 18/17/17 = 26.35 SF } RCD 1/10/11  
LANDSCAPE RIGHT = 4x155 = 62 SF }

SAND 68.25 } BL 3/23/10  
SUBBASE 147.53 SF } RCD 1/10/11  
F.L. = 72' CUB 01/24/11  
RCD 1/25/11

# U.S. ROUTE 5 HARTFORD AVENUE

NOTES:  
1) REFER TO ROADWAY LAYOUT AND UTILITY LAYOUT SHEETS FOR PROPOSED ABANDONMENT, REMOVAL, OR PROTECTION REQUIREMENTS OF EXISTING UTILITIES IN CONFLICT WITH PROPOSED WORK.

PROJECT NAME:	HARTFORD	PLOT DATE:	1/11/2007
PROJECT NUMBER:	RS 0113(40)	DRAWN BY:	E. ATKINS
FILE NAME:	z86c027xsl.dgn	CHECKED BY:	K. ISHIKURA
PROJECT LEADER:	KEN UPMAL	SHEET	195 OF 239
DESIGNED BY:	K. ISHIKURA		