

26+00.00

common EXCAVATION ROADWAY 7.6 x 1.5' = 11.4 SF } BL 3/23/10
 LANDSCAPING 5.1 x 1.5' = 7.7 SF }
 SAND 67.00 SF }
 SUBBASE 154.03 SF }
 BACK = 148.7 SF @ 15% }
 AHEAD = 159.7 SF }
 F.L. = 79' }
 REC 1/25/11

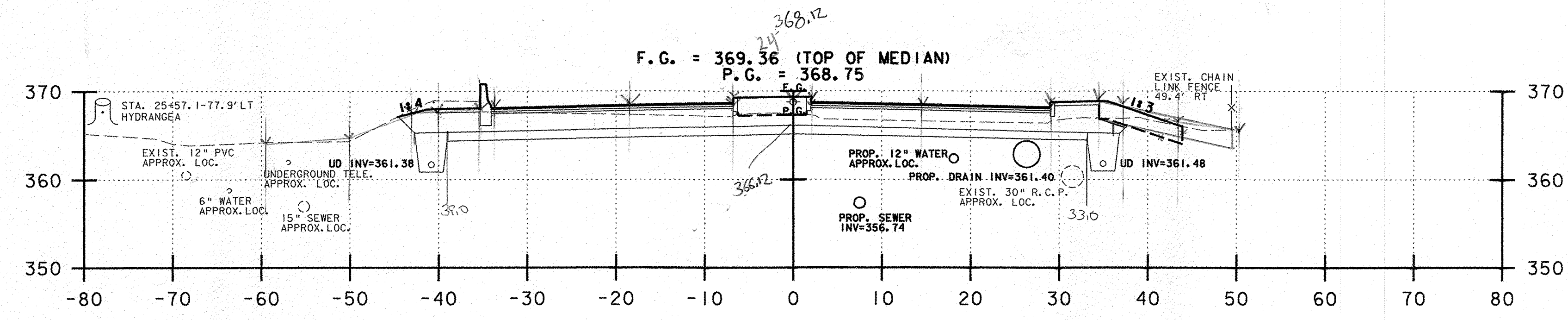

25+50.00

common EXCAVATION ROADWAY 12.2 / 12.2 / 20 = 121.45 SF } BL 3/23/10
 LANDSCAPING 4 x 1.5' = 6.2 SF }
 SAND 72.06 SF }
 SUBBASE 165.56 SF }
 F.L. = 79' }
 REC 1/25/11

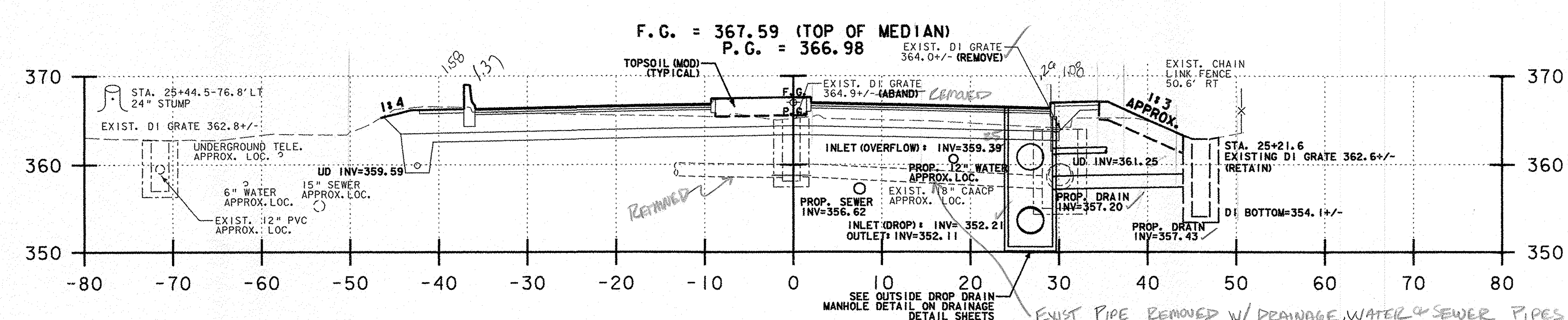

25+22.18

LEGEND:
 F.G. FINISHED GRADE
 P.G. PROFILE GRADE

U.S. ROUTE 5 HARTFORD AVENUE

NOTES:
 1) REFER TO ROADWAY LAYOUT AND UTILITY LAYOUT SHEETS FOR PROPOSED ABANDONMENT, REMOVAL, OR PROTECTION REQUIREMENTS OF EXISTING UTILITIES IN CONFLICT WITH PROPOSED WORK.

PROJECT NAME: HARTFORD	
PROJECT NUMBER: RS 0113(40)	
FILE NAME: z86c027xsl.dgn	PLOT DATE: 1/31/2007
PROJECT LEADER: KEN UPMAL	DRAWN BY: E. ATKINS
DESIGNED BY: K. ISHIKURA	CHECKED BY: K. ISHIKURA
E. ATKINS	SHEET 194 OF 239