

45 29+00 TOPSOIL (MOD.) 275'  
 26+50 ~ 28+90 LT (245' LENGTH x 12' WIDE x 2' DEEP)  
 26+90 ~ 29+25 LT (135' LENGTH x 15' WIDE(TYP.) x 2' DEEP)  
 28+96 25+00 ~ 29+20 RT (420' LENGTH x VARIABLE WIDTH x 2' DEEP)  
 25+00 ~ 25+90 (MEDIAN ISLAND - 90' LENGTH x VARIABLE WIDTH x 2' DEEP)  
 29+54 ~ 29+74 RT (20' LENGTH x 10' WIDE x 2' DEEP)

BOTANICAL NAME	COMMON NAME	SIZE	QUANTITY	SPECIFICATIONS
ACER X FREEMANII 'AUTUMN BLAZE'	'ARMSTRONG' FREEMAN MAPLE	2.5'-3' CAL.	4	B&B
CELTIS OCCIDENTALIS	COMMON HACKBERRY	2.5'-3' CAL.	4	B&B
PHYSOCARPUS OPULIFOLIUS 'NUGGET'	NINEBARK 'NUGGET'	30-36" HT	135	CONTAINER 3' O.C.
PICEA GLAUCA	WHITE SPRUCE	5'-6" HT	1 26+55	B&B
RHUS AROMATICA 'GROW LOW'	'GROW LOW' SUMAC	18-24" WIDTH	85	B&B HEAVY 3' O.C.
ULMUS AMERICANA 'VALLEY FORGE'	'VALLEY FORGE' AMERICAN ELM	2.5'-3' CAL.	6	B&B BRANCH HEIGHT TO 5'
VIBURNUM LENTAGO	'NANNYBERRY' VIBURNUM	4-5' HT	10	CONTAINER 3' O.C.
ZELKOVA SERRATA 'GREEN VASE'	'GREEN VASE' ZELKOVA	2.5'-3' CAL.	4	B&B

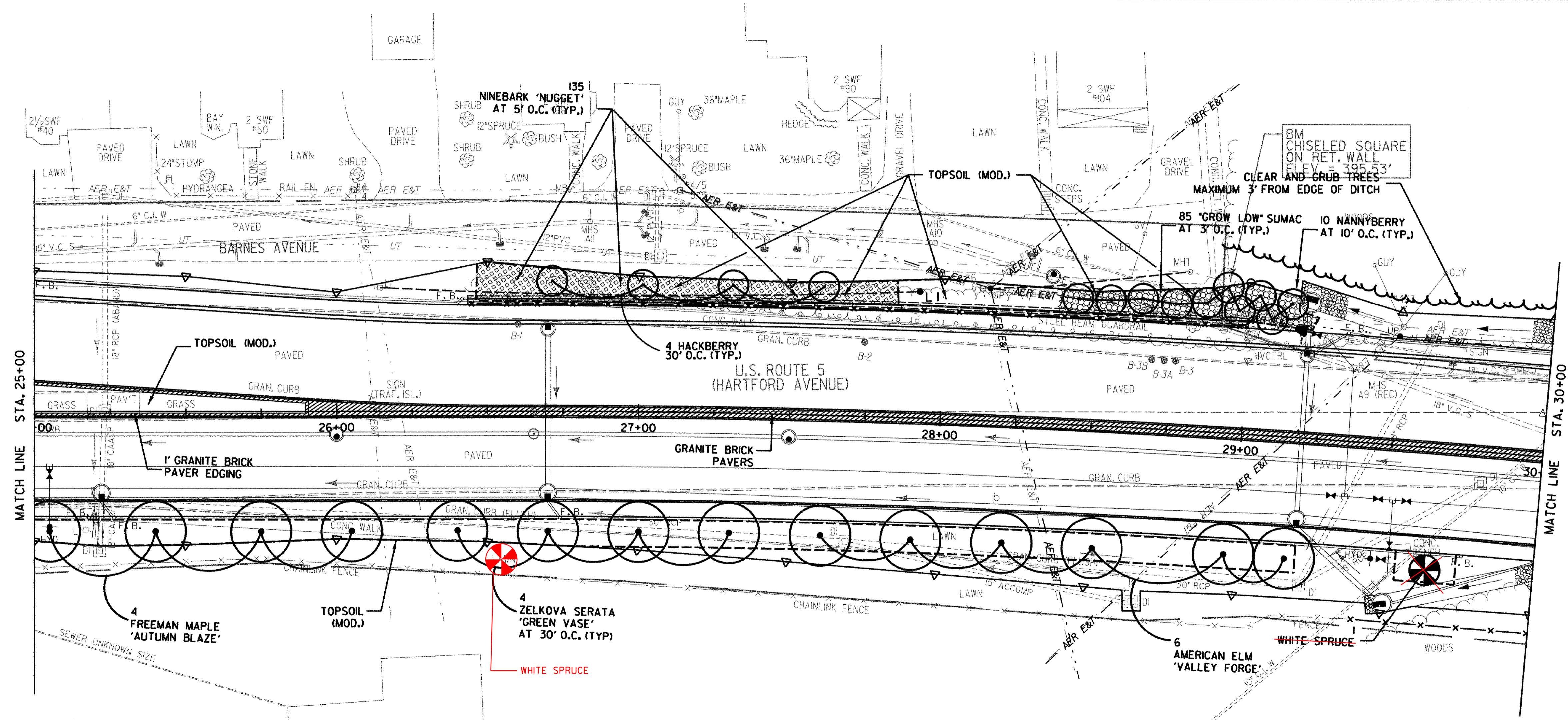

LANDSCAPING LAYOUT SHEET 2

LANDSCAPE LEGEND

	PROPOSED CONIFEROUS TREE/SHRUB		WINTERBERRY
	PROPOSED DECIDUOUS TREE/SHRUB		'HYPERION' DAYLILY
	BRICK PAVING		NANNYBERRY
	TOPSOIL (MOD.)		BOSTON IVY
	LILAC		ARBORVITAE
	'GROW LOW' SUMAC		EXISTING EVERGREEN TREE/SHRUB
	NINEBARK 'DIABLO'		EXISTING DECIDUOUS TREE/SHRUB
	COMPACT PFITZER JUNIPER		PROJECT DEMARCATION FENCE
			SNOW FENCE (MOD. - ARCH)

DATUM  
 VERTICAL NGVD 1929  
 HORIZONTAL N/A

NOTES: REFER TO TYPICAL ROADWAY SECTION SHEETS FOR SEEDING FORMULAS AND LANDSCAPING DETAIL SHEETS FOR PLANTING DETAILS.



PROJECT: HARTFORD	PROJECT NO.: RS 0113(40)
DESIGN FILE NAME: z027bdr.dgn	PLOT DATE: 2/27/2007
IPARM FILE NAME:	SURVEY DATE: 1/87
SURVEYED BY: FANTONI	DRAWN BY: E. ATKINS
SQUAD LEADER: KEN UPMAL	SHEET: 183 OF 239