

**EROSION CONTROL LEGEND**

- INLET PROTECTION (SEE DETAIL SHEETS FOR APPROPRIATE METHOD)
- TEMPORARY STONE CHECK DAM
- STONE DITCH
- STABILIZED CONST. ENTRANCE
- SILT FENCE
- PROJECT DEMARCATION FENCING (LIMIT OF DISTURBANCE)
- FILTER CURTAIN

- STONE FILL, TYPE I (MOD. - CHECK DAM)**  
35+50 RT (TEMPORARY)  
36+00 RT (TEMPORARY)
- STONE FILL, TYPE I (MOD. - CONSTRUCTION ENTRANCE)**  
10+90 RT (HIGHLAND AVE) (STABILIZED CONSTRUCTION ENTRANCE)  
5+75 RT (WORCESTER AVE) (STABILIZED CONSTRUCTION ENTRANCE)
- STONE FILL, TYPE I (MOD. - INLET PROTECTION)**  
PROP. CB @ 36+27.0 LT
- SNOW FENCE (MOD. - PDF)**  
35+00 LT (HARTFORD AVE) ~ 14+00, LT (HIGHLAND AVE)  
15+95 RT (SCHOOL DRIVEWAY) ~ 21+40 LT (HEBARDAVE)  
1+65 ~ 2+43 RT (RELOCATED WORCESTER AVE)
- GEOTEXTILE FOR SILT FENCE**  
37+10 LT (HARTFORD AVE) ~ 14+00 LT (HIGHLAND AVE)

- SEED**  
35+00 ~ 40+00 RT  
35+00 ~ 40+00 LT
- SEED ~ WINTER RYE**  
35+00 ~ 40+00 RT  
35+00 ~ 40+00 LT
- HAY MULCH**  
35+00 ~ 40+00 RT  
35+00 ~ 40+00 LT
- EROSION MATTING**  
35+00 ~ 36+27 RT  
39+00 ~ 40+00 RT  
37+00 ~ 37+86 LT  
11+00 ~ 12+00 RT (HIGHLAND AVE)  
13+25 ~ 13+75 LT (HIGHLAND AVE)  
0+75 ~ 1+30 RT (WORCESTER AVE)

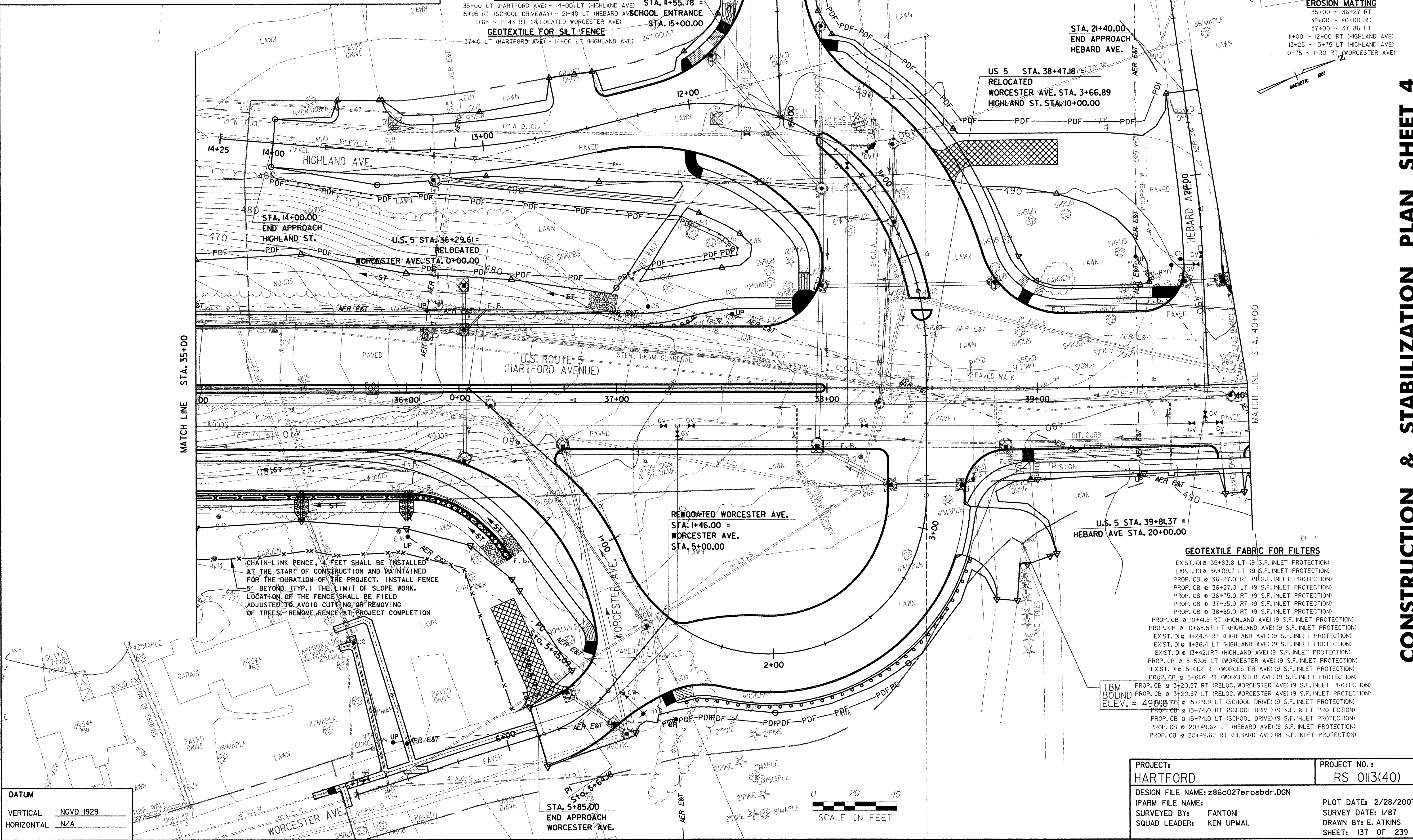

MATCH LINE STA. 35+00

MATCH LINE STA. 40+00

DATUM  
VERTICAL NGVD 1929  
HORIZONTAL N/A

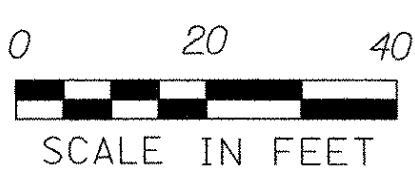

CHAIN-LINK FENCE, 4 FEET SHALL BE INSTALLED AT THE START OF CONSTRUCTION AND MAINTAINED FOR THE DURATION OF THE PROJECT. INSTALL FENCE 5' BEYOND (TYP.) THE LIMIT OF SLOPE WORK. LOCATION OF THE FENCE SHALL BE FIELD ADJUSTED TO AVOID CUTTING OR REMOVING OF TREES. REMOVE FENCE AT PROJECT COMPLETION

- GEOTEXTILE FABRIC FOR FILTERS**
- EXIST. DI @ 35+83.8 LT (9 S.F. INLET PROTECTION)
  - EXIST. DI @ 36+09.7 LT (9 S.F. INLET PROTECTION)
  - PROP. CB @ 36+27.0 RT (9 S.F. INLET PROTECTION)
  - PROP. CB @ 36+27.0 LT (9 S.F. INLET PROTECTION)
  - PROP. CB @ 36+75.0 RT (9 S.F. INLET PROTECTION)
  - PROP. CB @ 37+95.0 RT (9 S.F. INLET PROTECTION)
  - PROP. CB @ 38+85.0 RT (9 S.F. INLET PROTECTION)
  - PROP. CB @ 10+41.9 RT (HIGHLAND AVE) (9 S.F. INLET PROTECTION)
  - PROP. CB @ 10+65.57 LT (HIGHLAND AVE) (9 S.F. INLET PROTECTION)
  - EXIST. DI @ 11+24.3 RT (HIGHLAND AVE) (9 S.F. INLET PROTECTION)
  - EXIST. DI @ 11+86.4 LT (HIGHLAND AVE) (9 S.F. INLET PROTECTION)
  - EXIST. DI @ 13+42.1 RT (HIGHLAND AVE) (9 S.F. INLET PROTECTION)
  - PROP. CB @ 5+53.6 LT (WORCESTER AVE) (9 S.F. INLET PROTECTION)
  - EXIST. DI @ 5+61.2 RT (WORCESTER AVE) (9 S.F. INLET PROTECTION)
  - PROP. CB @ 5+61.6 RT (WORCESTER AVE) (9 S.F. INLET PROTECTION)
  - PROP. CB @ 31+20.57 RT (RELOC. WORCESTER AVE) (9 S.F. INLET PROTECTION)
  - PROP. CB @ 31+20.57 LT (RELOC. WORCESTER AVE) (9 S.F. INLET PROTECTION)
  - PROP. CB @ 15+29.9 LT (SCHOOL DRIVE) (9 S.F. INLET PROTECTION)
  - PROP. CB @ 15+74.0 RT (SCHOOL DRIVE) (9 S.F. INLET PROTECTION)
  - PROP. CB @ 15+74.0 LT (SCHOOL DRIVE) (9 S.F. INLET PROTECTION)
  - PROP. CB @ 20+49.62 LT (HEBARDAVE) (9 S.F. INLET PROTECTION)
  - PROP. CB @ 20+49.62 RT (HEBARDAVE) (8 S.F. INLET PROTECTION)

PROJECT: <b>HARTFORD</b>	PROJECT NO. : <b>RS 0113(40)</b>
DESIGN FILE NAME: z86c027erosbdr.DGN	PLOT DATE: 2/28/2007
IPARM FILE NAME:	SURVEY DATE: 1/87
SURVEYED BY: FANTONI	DRAWN BY: E. ATKINS
SQUAD LEADER: KEN UPMAL	SHEET: 137 OF 239