

**SANITARY SEWER PROFILE SHEET 1**

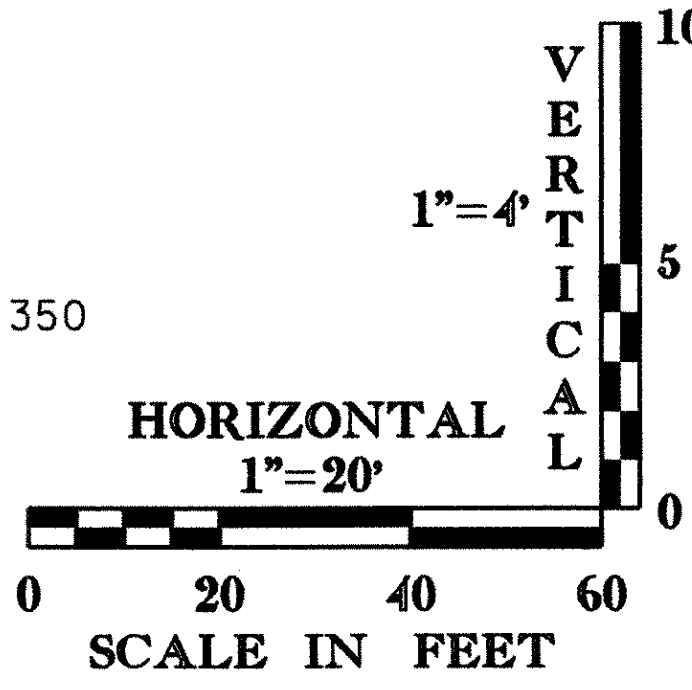
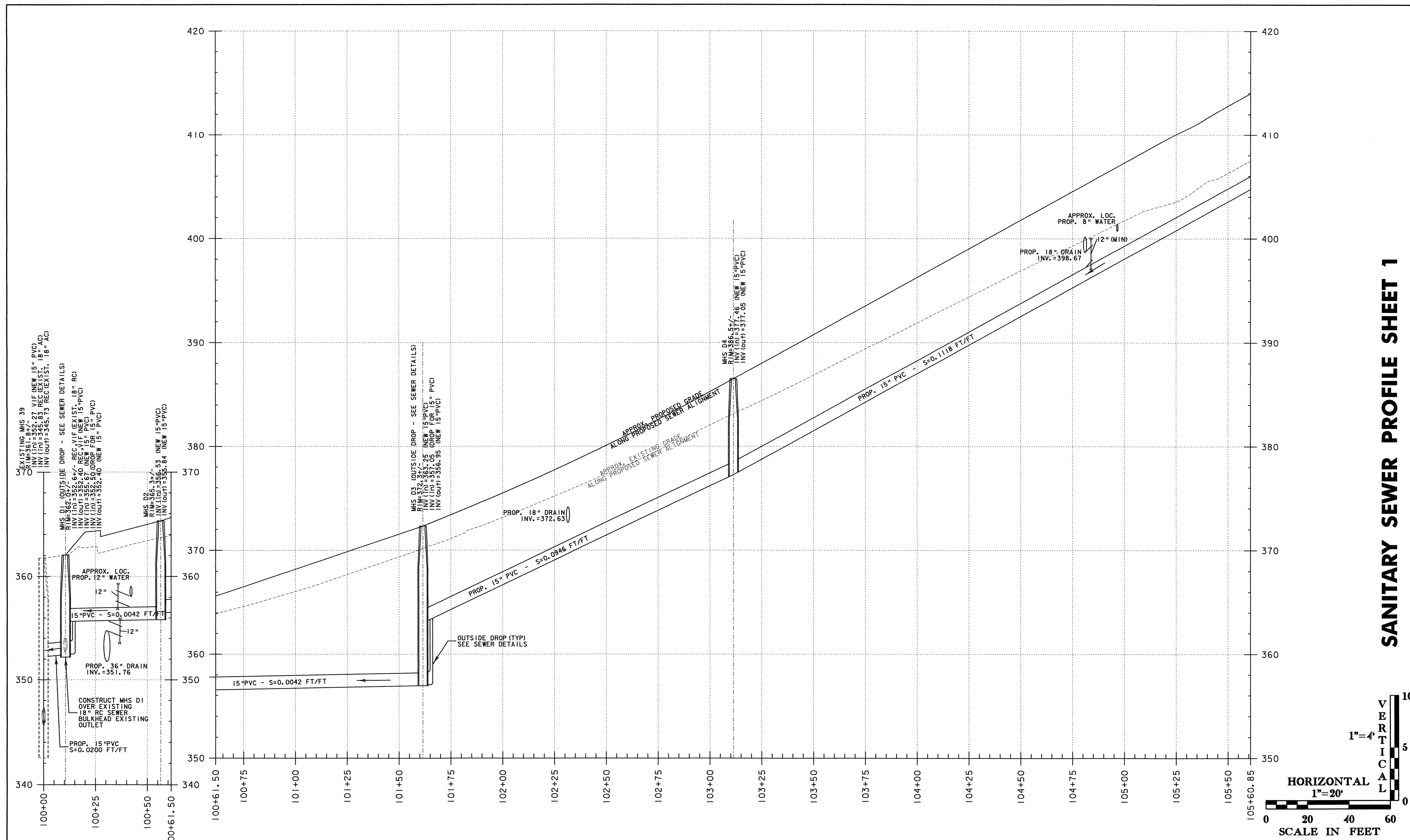

**DATUM**

VERTICAL	NGVD 1929
HORIZONTAL	N/A

- NOTES:**
- 1) ALL RIM ELEVATIONS GIVEN ARE APPROXIMATE AND SHALL BE FIELD ADJUSTED TO MATCH FINAL GRADES.
  - 2) EXISTING INVERTS ARE BASED ON THE BEST AVAILABLE INFORMATION OF RECORD OR TOPOGRAPHIC SURVEY AND SHALL BE FIELD VERIFIED WHERE PROPOSED INVERTS WOULD BE AFFECTED.

**US RTE 5 TRUNKLINE PROFILE  
MHS 39 TO US RTE 5 STA. 30+00**

PROJECT: <b>HARTFORD</b>	PROJECT NO.: <b>RS 0113(40)</b>
DESIGN FILE NAME: z86c027sew_prof.DGN	PLOT DATE: 1/6/2007
IPARM FILE NAME:	SURVEY DATE: 1/87
SURVEYED BY: FANTONI	DRAWN BY: E. ATKINS
SQUAD LEADER: KEN UPMAL	SHEET: 110 OF 239