

SANITARY SEWER MANHOLE

MHS D4 - 27+50.0, 7.5' RT

SANITARY SEWER MANHOLE (MOD. - OUTSIDE DROP)

MHS D3 - 26+00.0, 7.5' RT

PVC SEWER PIPE (15')

③ 26+00.0 RT - 24+95.0 RT - 106'

④ 27+50.0 RT - 26+00.0 RT - 150'

⑤ 30+30.0 RT - 27+50.0 RT - 280'

CHANGING ELEVATION OF SEWER MANHOLE

29+46 LT

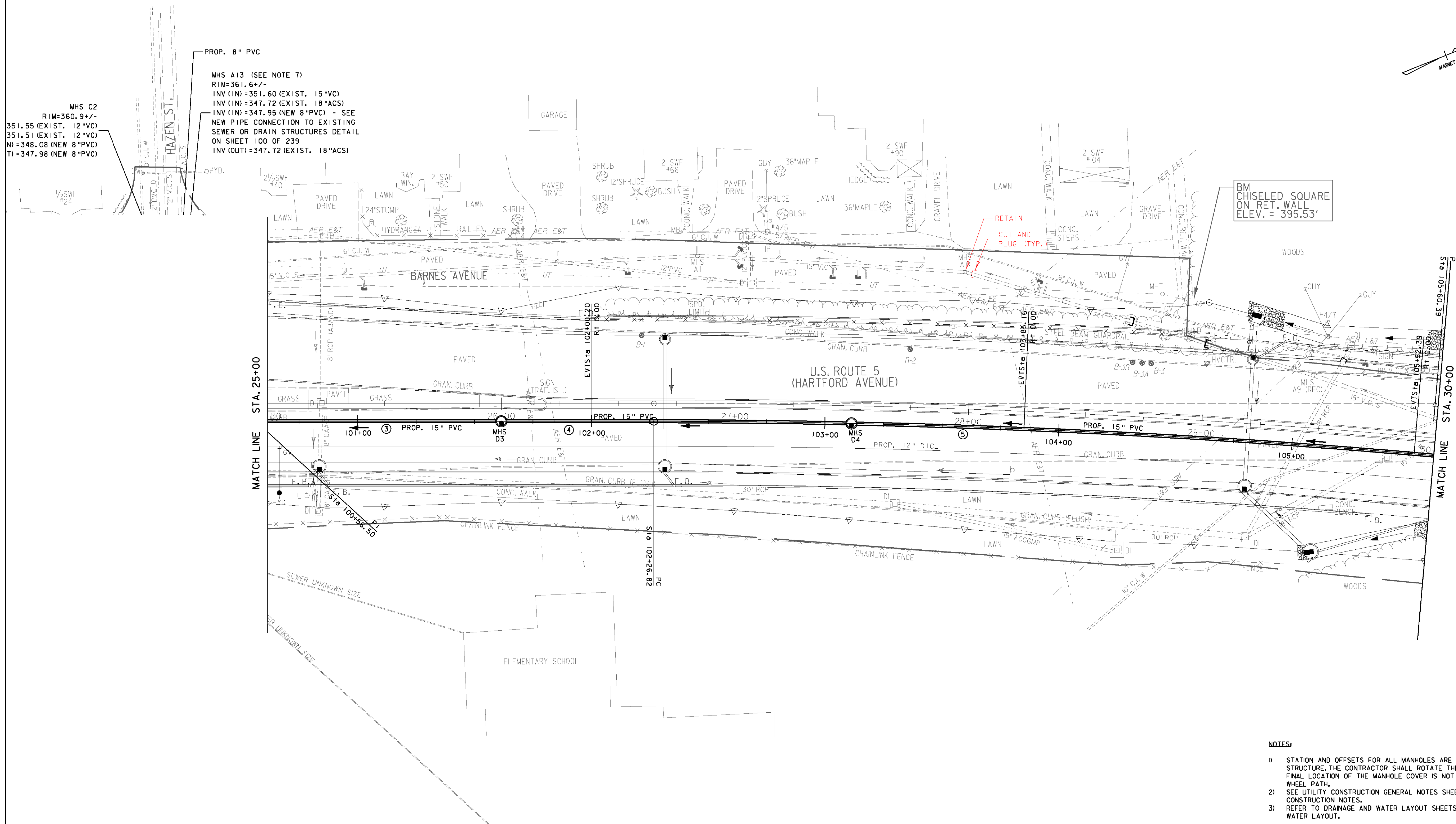

MHS C2
RIM=360.9 +/-
351.55 (EXIST. 12"VC)
351.51 (EXIST. 12"VC)
N)=348.08 (NEW 8" PVC)
T)=347.98 (NEW 8" PVC)

PROP. 8" PVC
MHS A13 (SEE NOTE 7)
RIM=361.6 +/-
INV (IN)=351.60 (EXIST. 15"VC)
INV (IN)=347.72 (EXIST. 18"ACS)
INV (IN)=347.95 (NEW 8" PVC) - SEE
NEW PIPE CONNECTION TO EXISTING
SEWER OR DRAIN STRUCTURES DETAIL
ON SHEET 100 OF 239
INV (OUT)=347.72 (EXIST. 18"ACS)

BM CHISELED SQUARE
ON RET. WALL
ELEV. = 395.53'

SANITARY SEWER LAYOUT SHEET 2

DATUM	
VERTICAL	NGVD 1929
HORIZONTAL	N/A



NOTES:

- 1) STATION AND OFFSETS FOR ALL MANHOLES ARE GIVEN TO THE CENTER OF THE STRUCTURE. THE CONTRACTOR SHALL ROTATE THE TOP SECTIONS SUCH THAT THE FINAL LOCATION OF THE MANHOLE COVER IS NOT WITHIN THE PREDOMINANT VEHICLE WHEEL PATH.
- 2) SEE UTILITY CONSTRUCTION GENERAL NOTES SHEET FOR PROPOSED SEWER CONSTRUCTION NOTES.
- 3) REFER TO DRAINAGE AND WATER LAYOUT SHEETS FOR PROPOSED DRAINAGE AND WATER LAYOUT.

PROJECT: HARTFORD	PROJECT NO. : RS 0113(40)
DESIGN FILE NAME: z86c027sewldr.DGN	PLOT DATE: 4/11/2012
IPARM FILE NAME:	SURVEY DATE: 1/87
SURVEYED BY: FANTONI	DRAWN BY: E. ATKINS
SQUAD LEADER: KEN UPMAL	SHEET: 102 OF 239