

WATER LAYOUT SHEET 6

- SEAMLESS COPPER WATER TUBE (3/4")**
 45+19 RT ~ 45+09 RT - 30'
 W/ ONE CORPORATION STOP,
 ONE EXTENSION SERVICE BOX AND CURB STOP
 46+56 RT ~ 46+56 RT - 24'
 W/ ONE CORPORATION STOP,
 ONE EXTENSION SERVICE BOX AND CURB STOP
 46+85 RT ~ 46+86 LT - 50'
 W/ ONE CORPORATION STOP,
 RETAIN EXISTING CURB STOP
 47+15 RT ~ 47+06 LT - 54'
 W/ ONE CORPORATION STOP,
 RETAIN EXISTING CURB STOP
 47+85 RT ~ 47+85 LT - 46'
 W/ ONE CORPORATION STOP,
 ONE EXTENSION SERVICE BOX AND CURB STOP
 47+93 RT ~ 47+93 RT - 24'
 W/ ONE CORPORATION STOP,
 ONE EXTENSION SERVICE BOX AND CURB STOP
 48+41 RT ~ 48+41 LT - 52'
 W/ ONE CORPORATION STOP,
 RETAIN EXISTING CURB STOP
 48+89 RT ~ 48+89 RT - 26'
 W/ ONE CORPORATION STOP,
 ONE EXTENSION SERVICE BOX AND CURB STOP
 49+68 RT ~ 49+68 LT - 46'
 W/ ONE CORPORATION STOP,
 ONE EXTENSION SERVICE BOX AND CURB STOP
- DUCTILE IRON PIPE, CEMENT-LINED (6")**
 30+29 LT (PIERCE ST) ~ 48+87 LT (HARTFORD AVE) - 18'
- DUCTILE IRON PIPE, CEMENT-LINED (8")**
 49+03 RT (HARTFORD AVE) ~ 30+39 LT (PIERCE ST) - 58'
 W/ ONE 8X6X8 TEE, ONE 1/32 BEND, ONE CAP
- DUCTILE IRON PIPE, CEMENT-LINED (12")**
 45+00 RT ~ 50+00 RT - 500'
 W/ ONE 12X8X12 TEE
- GATE VALVE WITH VALVE BOX**
 30+29 LT (PIERCE ST) - 6" VALVE
 30+34 LT (PIERCE ST) - 8" VALVE
 45+04 RT - 12" VALVE
 48+96 RT - 12" VALVE
 49+09 RT - 12" VALVE
- HYDRANT**
 48+87, 34.0' LT - 1EACH
- HYDRANT, REMOVE**
 47+10 RT - 1EACH

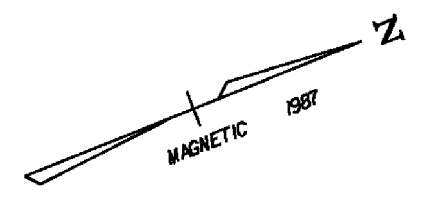

DATUM	
VERTICAL	NGVD 1929
HORIZONTAL	N/A

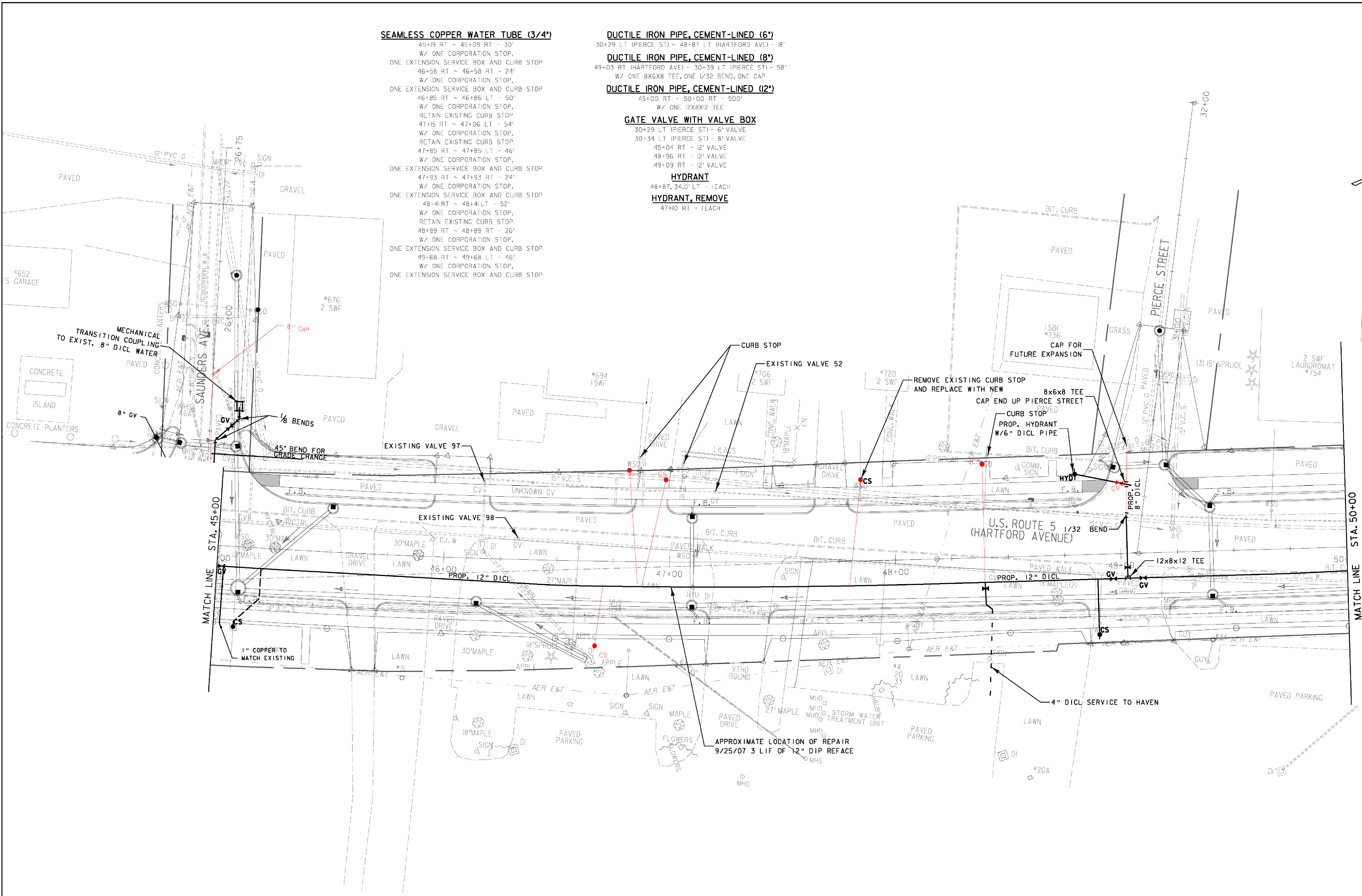

- NOTES:**
- SEE UTILITY CONSTRUCTION GENERAL NOTES SHEET FOR PROPOSED WATER CONSTRUCTION NOTES AND LEGEND.
 - REFER TO DRAINAGE AND SANITARY SEWER LAYOUT SHEETS FOR REFERRED DRAINAGE AND SEWER LAYOUT.

PROJECT: HARTFORD	PROJECT NO.: RS 0113(40)
DESIGN FILE NAME: z86c027watbdr.DGN	PLOT DATE: 4/11/2012
IPARM FILE NAME:	SURVEY DATE: 1/87
SURVEYED BY: FANTONI	DRAWN BY: E. ATKINS
SQUAD LEADER: KEN UPMAL	SHEET: 96 OF 239