

CLEARING AND GRUBBING
 (INCLUDING INDIVIDUAL TREES AND STUMPS)
 60+80 LT ~ 61+00 LT

COLD PLANING-BIT PAVEMENT
 60+00 ~ 61+00 61+28 ~ 61+56

REMOVE EXISTING SIDEWALK (COMMON EXCAVATION)
 60+00 ~ 61+00 RT

SOLID ROCK EXCAVATION
 (REMOVAL OF EXISTING CONCRETE ROADWAY)
 60+00 ~ 61+00 7' X 22' WIDE
 (EST. FROM 1931 REC. PLANS)

STONE FILL, TYPE II
 61+03 ~ 4' WIDE X 14' LONG = 26.6 CY

PORTLAND CEMENT CONCRETE SIDEWALK, 5 INCH (MOD.)
 60+00 ~ 61+00 RT

REMOVE & RESET CURB
 60+00 ~ 61+05 RT

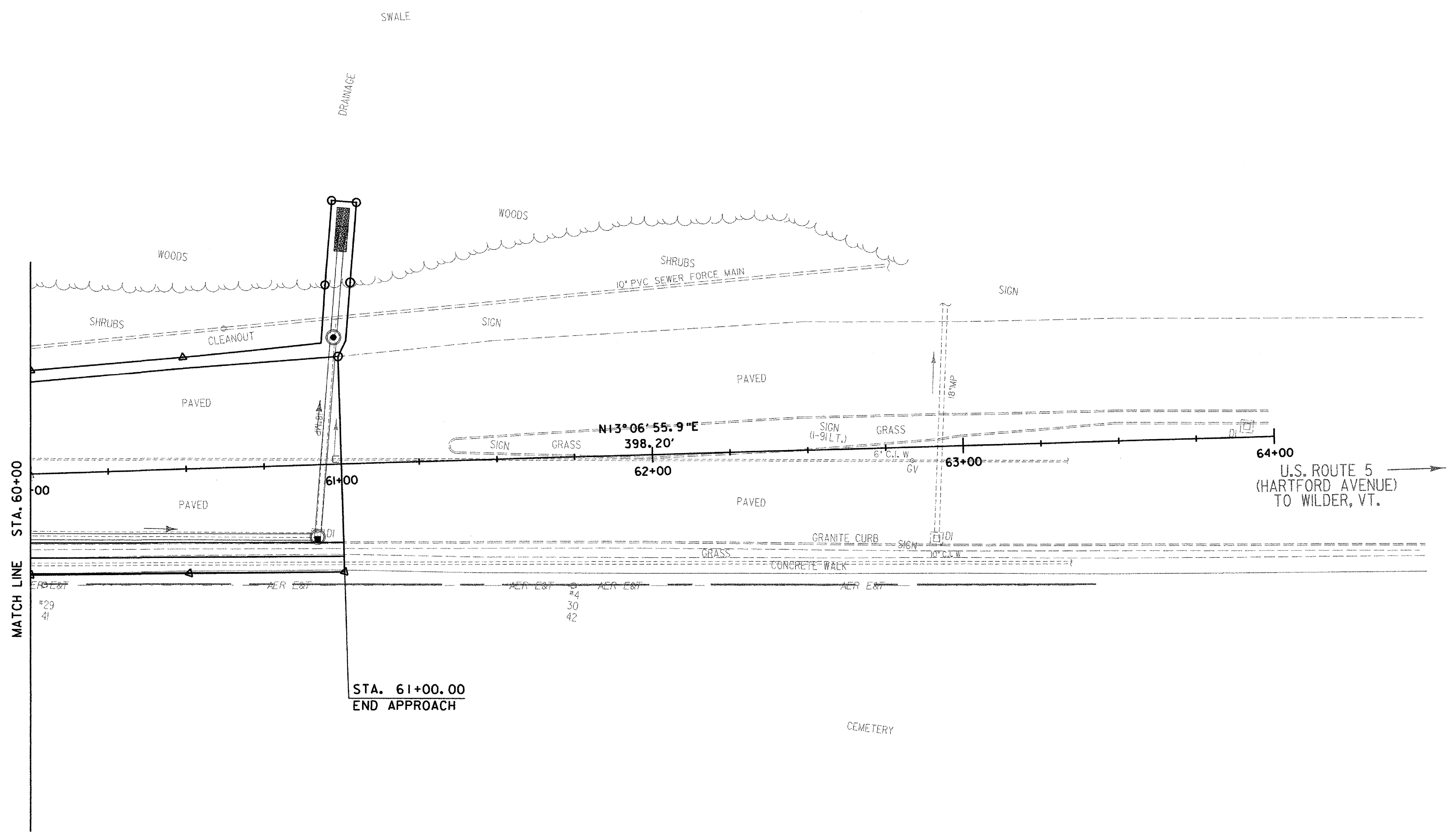
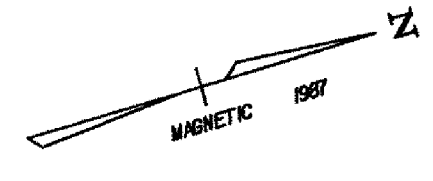

ROADWAY LAYOUT SHEET 9

DATUM

VERTICAL NGVD 1929

HORIZONTAL N/A



NOTES:

- REFER TO CURB LAYOUT SHEETS FOR CURBING LAYOUT AND DIMENSIONS.
- REFER TO DRAIN, SEWER, AND WATER LAYOUT SHEETS FOR UTILITY LAYOUT.

PROJECT: HARTFORD	PROJECT NO.: RS 0113(40)
DESIGN FILE NAME: z027bdr.dgn	PLOT DATE: 1/11/2007
SURVEYED BY: FANTONI	SURVEY DATE: 1/87
SQUAD LEADER: KEN UPMAL	DRAWN BY: E. ATKINS
	SHEET: 52 OF 239