

CLEARING AND GRUBBING
(INCLUDING INDIVIDUAL TREES AND STUMPS)

35+00 ~ 36+75 RT
35+00 ~ 36+85 LT
1+55 ~ 1+75 RT (WORCESTER AVE)
37+73 LT (S)
37+83 LT (S)
37+90 LT (M)
1+26 RT (M) (WORCESTER AVE)
2+85 LT (S) (WORCESTER AVE)
3+46 RT (S) (WORCESTER AVE)
10+89 LT (S) (HIGHLAND AVE)

COLD PLANING-BIT PAVEMENT

13+75 ~ 44+98 (HIGHLAND AVE) 13+78

EXCAVATION OF SURFACES AND PAVEMENTS

36+97 ~ 37+44 LT (COMMON EXC. (MOD))

REMOVE EXISTING SIDEWALK (COMMON EXCAVATION)

35+00 ~ 37+00 LT

35+00 ~ 39+20 LT

36+91 LT ~ 12+00 LT (HIGHLAND AVE)

11+82 LT ~ 11+85 RT (HIGHLAND AVE)

SOLID ROCK EXCAVATION

(REMOVAL OF EXISTING CONCRETE ROADWAY)

35+00 ~ 40+00 ~ 7' X 22' WIDE 18"

U.S. RTE. 5 VE WALL

GROUND-ANCHORED SOLDIER PILE WALL

35+00 ~ 36+50 RT 35+00 ~ 35+51 RT

STONE FILL, TYPE I

35+25 ~ 37+00 LT

35+25 ~ 0+76 RT (WORCESTER AVE)

35+00 RT ~ 0+74 RT (ABOVE WALL)

STONE FILL, TYPE II

35+00 ~ 35+25 LT

VERTICAL GRANITE CURB

35+00 ~ 1+33 RT (WORCESTER AVE)

5+36 ~ 5+75 RT (WORCESTER AVE)

5+75 LT ~ 5+31 LT (WORCESTER AVE)

1+63 RT ~ 2+93 RT (WORCESTER AVE)

3+42 RT (WORCESTER AVE) ~ 38+93 RT

38+98 ~ 39+85 RT

39+97 ~ 40+00 RT

36+72 ~ 38+28 RT

0+57 ~ 3+16 LT (WORCESTER AVE)

35+00 ~ 37+99 RT (MEDIAN)

35+00 ~ 37+99 LT (MEDIAN)

37+08 ~ 37+86 LT

10+62 ~ 11+99 LT (HIGHLAND AVE)

12+05 ~ 12+48 LT (HIGHLAND AVE)

10+32 ~ 10+38 LT (MEDIAN HIGHLAND AVE)

10+32 ~ 10+36 RT (MEDIAN HIGHLAND AVE)

10+44 ~ 11+36 LT (MEDIAN HIGHLAND AVE)

10+41 ~ 11+36 RT (MEDIAN HIGHLAND AVE)

15+83 ~ 15+44 LT (SCHOOL DR)

11+85 ~ 11+97 RT (HIGHLAND AVE)

12+02 ~ 12+41 RT (HIGHLAND AVE)

15+37 ~ 15+83 RT (SCHOOL DR)

10+35 ~ 11+49 RT (HIGHLAND AVE)

39+66 ~ 38+95 LT

20+47 ~ 20+56 LT (HEBAR AVE)

20+47 ~ 20+56 RT (HEBAR AVE)

PORTLAND CEMENT CONCRETE SIDEWALK, 5 INCH (MOD.)

35+00 ~ 1+33 RT (WORCESTER AVE)

1+60 ~ 2+88 RT (WORCESTER AVE)

3+16 RT (WORCESTER AVE) ~ 39+80 RT

35+00 ~ 12+00 LT (HIGHLAND AVE)

11+51 LT (HIGHLAND AVE) ~ 39+69 LT

39+91 ~ 40+00 LT

PORTLAND CEMENT CONCRETE SIDEWALK, 8 INCH (MOD.)

39+80 ~ 40+00 RT

2+88 ~ 3+16 RT (WORCESTER AVE)

BRICK PAVING

35+00 ~ 37+98.7 MEDIAN ISLAND 99.4 5' X

CONSTRUCT CONCRETE SIDEWALK RAMP W/ DETECTABLE WARNING SURFACE

38+96 RT TYPE 2

38+94 LT TYPE 2

5+33 RT TYPE 6 (WORCESTER AVE)

5+28 LT TYPE 6 (WORCESTER AVE)

10+40 LT TYPE 6 (HIGHLAND AVE)

11+50 RT TYPE 6 (HIGHLAND AVE)

11+83 RT TYPE 6 (HIGHLAND AVE)

12+00 RT TYPE 6 (HIGHLAND AVE)

12+00 LT TYPE 1 (HIGHLAND AVE)

20+44 RT TYPE 6 (HEBAR AVE)

20+44 LT TYPE 1 (HEBAR AVE)

CONSTRUCT BITUMINOUS CONCRETE DRIVES

39+85 ~ 39+97 RT 40+04 ~ 40+16

2+93 ~ 3+12 RT (WORCESTER AVE)

12+41 ~ 12+62 RT (HIGHLAND AVE)

13+47 ~ 13+70 RT (HIGHLAND AVE)

REMOVING AND RESETTING PROPERTY MARKERS

0+69 RT (WORCESTER AVE)

MISCELLANEOUS FENCE (WOOD POST AND RAIL)

1+67 ~ 2+93 RT (WORCESTER AVE) - 492 FT 149.3 LF

CHAIN-LINK FENCE, 4 FEET

35+00 RT ~ 5+93 RT (WORCESTER AVE)

- CHAIN-LINK FENCE, 6 FEET**
35+00 ~ 36+50 RT - 159 FT
- REMOVAL OF EXISTING FENCE**
35+00 ~ 38+48 LT
35+00 RT ~ 5+93 RT (WORCESTER AVE)
(REMOVAL OF CHAIN-LINK FENCE, 4 FEET AT PROJECT COMPLETION)
- CONCRETE MEDIAN BARRIER (MOD.)**
35+00 ~ 37+08 LT
- STEEL BEAM GUARD RAIL (GALVANIZED)**
37+08 ~ 37+26.8 LT
- MANUFACTURED TERMINAL SECTION**
37+26.8 LT - TEACH
- TERMINAL CONNECTOR FOR STEEL BEAM GUARDRAIL**
37+08 LT - TEACH
- REMOVAL AND DISPOSAL OF EXISTING GUARDRAIL**
35+00 ~ 39+11 LT

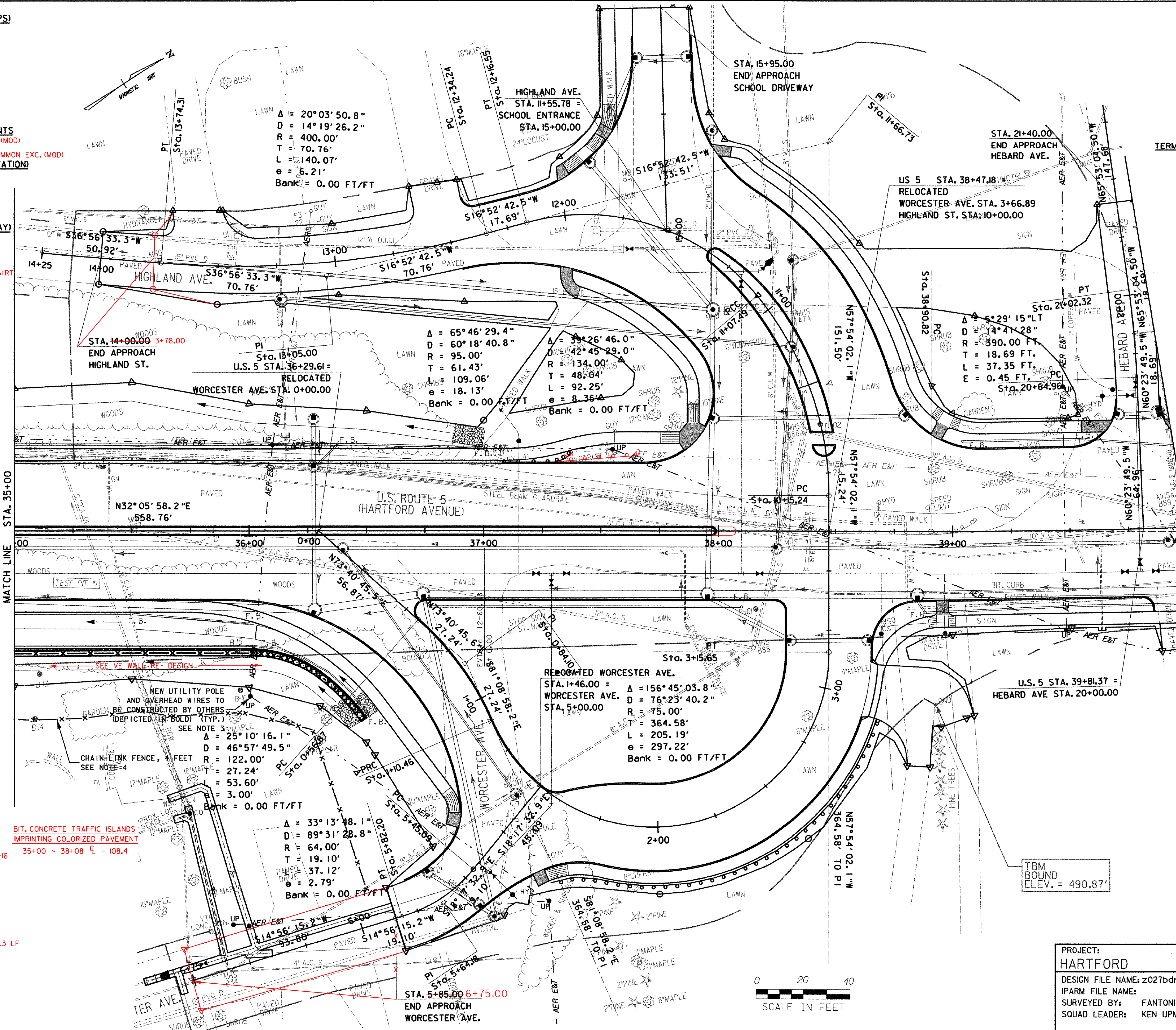

MATCH LINE STA. 35+00

MATCH LINE STA. 40+00

DATUM
VERTICAL NGVD 1929
HORIZONTAL N/A

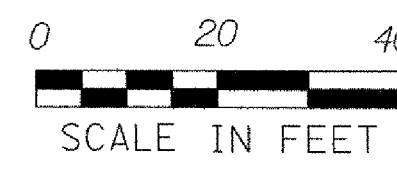

| | |
|-------------------------------|-------------------------------------|
| PROJECT: HARTFORD | PROJECT NO. : RS 0113(40) |
| DESIGN FILE NAME: z027bdr.dgn | PLOT DATE: 2/28/2007 |
| SURVEYED BY: FANTONI | SURVEY DATE: 1/87 |
| SQUAD LEADER: KEN UPMAL | DRAWN BY: E. ATKINS |
| | SHEET: 47 OF 239 |

ROADWAY LAYOUT SHEET 4