

COLD PLACING - BCP

60+75 ~ 61+25

PORTLAND CEMENT CONCRETE SIDEWALK, 5 INCH

60+00 ~ 61+25 RT

REMOVE EXISTING SIDEWALK (COMMON EXCAVATION)

60+00 ~ 61+25 RT

EXISTING DRAINAGE

58+40 RT ~ 60+92 RT

EXISTING PIPE & DI - REMOVE

60+92 RT ~ 61+00 LT

EXISTING PIPE & DI - REMOVE

NEW DRAINAGE

58+40 RT ~ 60+91.7 RT

NEW 24"x25" RCP/CPEP (SL)

W/D @ 60+91.7 RT

60+91.7 RT ~ 60+97.4 LT

NEW 24"x63" CPEP (SL)/CAAP/PCCSP (PI)/CPEP

60+97.4 LT ~ 61+02 LT

NEW 24"x32" CPEP (SL)/CAAP/PCCSP (PI)/CPEP

W/JB @ 60+97.4 LT W/END SECTION @ OUTLET

8" UNDERDRAIN

58+43 RT ~ 60+25 RT

NEW 8"x18" UNDERDRAIN

W/F.B. @ 60+25 RT

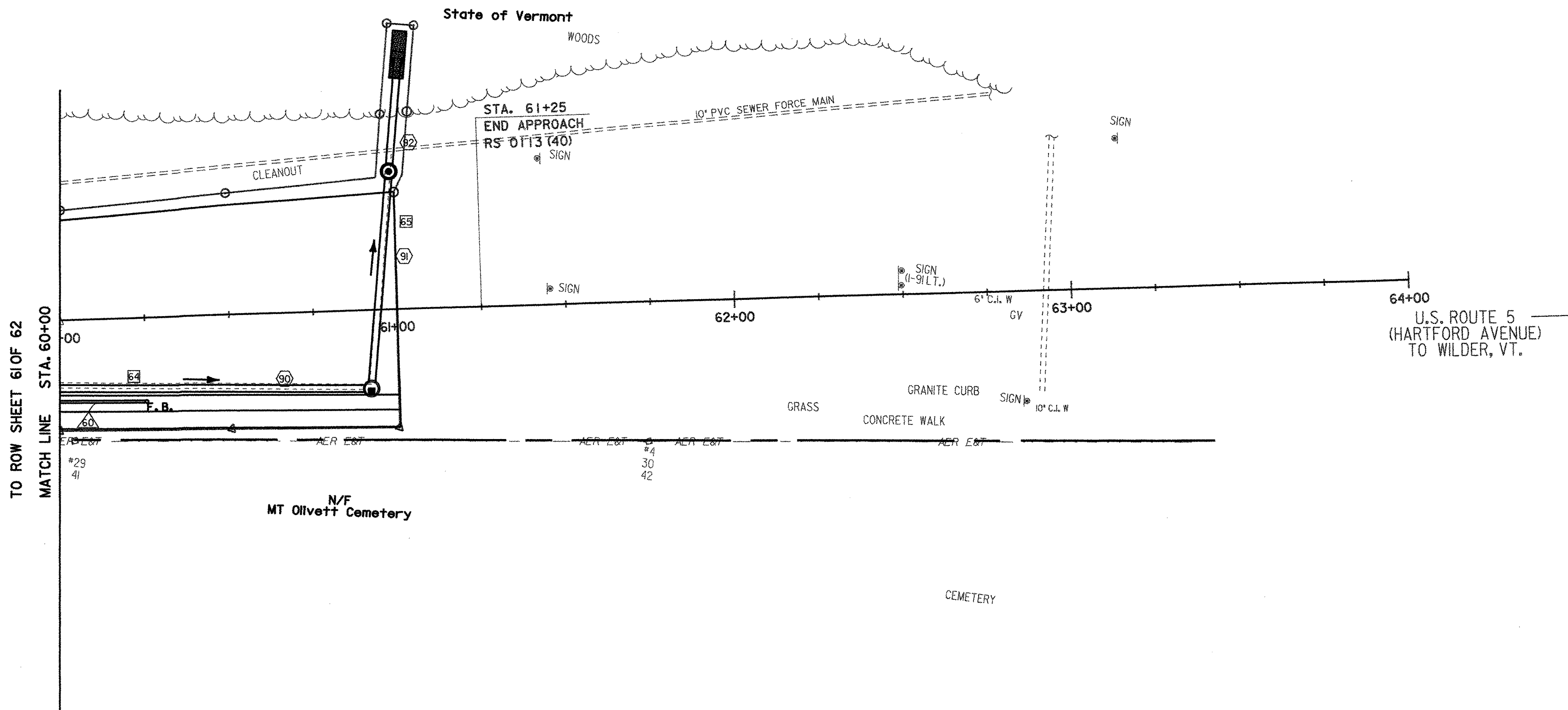
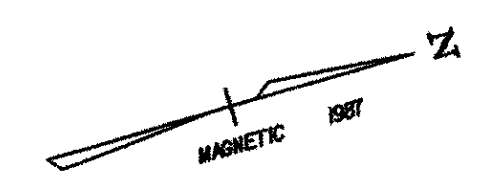

ROADWAY LAYOUT SHEET 9

FOR LANDSCAPE DETAIL
SEE ROW SHEET 44 OF 62

FOR EROSION CONTROL DETAIL
SEE ROW SHEET 35 OF 62

RIGHT-OF-WAY AGENT OF
PROJECT: FRANK J. MALNATI JR.

LINES SHOWN ON THIS PLAN AS EXISTING
PROPERTY LINES P/L ARE BELIEVED TO
BE ACCURATE BUT SHOULD NOT BE RELIED
UPON FOR PURPOSES UNRELATED TO THE
STATE OF VERMONT'S ACQUISITION OF LAND
AND RIGHTS FOR THIS PROJECT.

DATUM	
VERTICAL	NGVD 1929
HORIZONTAL	N/A

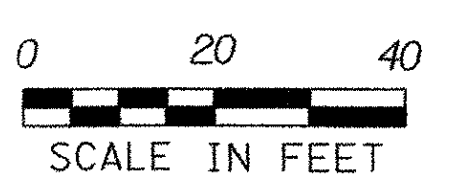

PROJECT: HARTFORD	PROJECT NO.: RS 0113(40)
DESIGN FILE NAME: z027bdr.dgn	PLOT DATE: 04-DEC-2006
IPARM FILE NAME:	SURVEY DATE: 1/87
SURVEYED BY: FANTONI	DRAWN BY: E. ATKINS
SQUAD LEADER: KEN UPMAL	SHEET 43 OF 239
ROW SHEET 62 OF 62	