

**REMOVE EXISTING SIDEWALK (COMMON EXCAVATION)**

55+02 ~ 57+13 RT  
57+49 ~ 57+99 RT  
58+24 ~ 60+00 RT

**EXISTING DRAINAGE**

59 56+61 LT ~ 57+16 RT  
EXISTING DI - REMOVE  
EXISTING PIPE - PLUG  
60 57+17 LT  
EXISTING PIPE & DI - REMOVE  
61 57+16 RT ~ 58+40 RT  
EXISTING PIPE & DI - REMOVE  
62 58+40 RT ~ 60+92 RT  
EXISTING PIPE & DI - REMOVE  
63 45+79 LT ~ 45+95 RT (HEWITT ST)  
EXISTING PIPE - RETAIN

**NEW DRAINAGE**

60 40+36.06 LT (DEVIN ST) ~ 55+12 RT  
NEW 18"x20" RCP/CPEP (SL)  
W/DI @ 40+36.06 LT  
61 55+12 LT ~ 55+12 RT  
NEW 18"x35" RCP/CPEP (SL)  
W/DI @ 55+12 LT  
62 55+12 RT ~ 56+00 RT  
NEW 18"x86" RCP/CPEP (SL)  
W/DI @ 56+00 RT  
63 56+00 RT ~ 56+77.66 RT  
NEW 18"x76" RCP/CPEP (SL)  
W/DI @ 56+77.66 RT  
64 56+00 LT ~ 56+77.66 LT  
NEW 18"x76" RCP/CPEP (SL)  
W/DI @ 56+00 LT

**NEW DRAINAGE (CONT.)**

65 56+77.66 LT ~ 56+77.66 RT  
NEW 18"x38" RCP/CPEP (SL)  
W/DI @ 56+77.66 LT  
66 56+77.66 RT ~ 58+40 RT  
NEW 18"x160" RCP/CPEP (SL)  
W/DI @ 58+40 RT  
67 45+34.83 RT ~ 45+37.25 LT (ADVENT LN)  
NEW 18"x16" RCP/CPEP (SL)  
W/DI @ 45+34.83 RT  
68 45+37.25 LT (ADVENT LN) ~ 58+40 RT  
NEW 18"x20" RCP/CPEP (SL)  
W/DI @ 45+37.25 LT  
69 58+45 LT ~ 58+40 RT  
NEW 18"x47" RCP/CPEP (SL)  
W/DI @ 58+45 LT  
70 58+40 RT ~ 60+91.7 RT  
NEW 24"x25" RCP/CPEP (SL)  
W/DI @ 60+91.7 RT

**8" UNDERDRAIN**

54+00 LT ~ 58+10 LT  
NEW 8"x40" UNDERDRAIN  
W/F.B. @ 58+10 LT  
55+12 RT ~ 56+77.66 RT  
NEW 8"x166" UNDERDRAIN  
W/F.B. @ 55+12 RT  
56+77.66 ~ 57+89 RT  
NEW 8"x182" UNDERDRAIN  
W/F.B. @ 56+77.66 RT  
58+43 RT ~ 60+25 RT  
NEW 8"x182" UNDERDRAIN  
W/F.B. @ 60+25 RT

**8" UNDERDRAIN CARRIER PIPE**

56+77.66 RT ~ 56+77.66 RT  
NEW 8"x4" UNDERDRAIN CARRIER PIPE  
W/F.B. @ 56+77.66 RT  
58+40 RT ~ 58+43 RT  
NEW 8"x4" UNDERDRAIN CARRIER PIPE  
58+10 LT ~ 58+65 LT  
NEW 8"x55" UNDERDRAIN CARRIER PIPE

**CHANGING ELEVATION OF SEWER MANHOLE**

59+30 RT  
50+24 RT (HEWITT ST)

END R.O.W. PROJECT RS 0113(40)

STA. 58+54.29' 62.26' LT.

END MAINTENANCE AGREEMENT  
ZONE NO. 10

HEWITT ST. 50+60.20 CL. LENGTH 38.95'

M.T. Associates

U.S. 5 STA. 58+10.51 =  
ADVENT LN. STA. 45+00.00

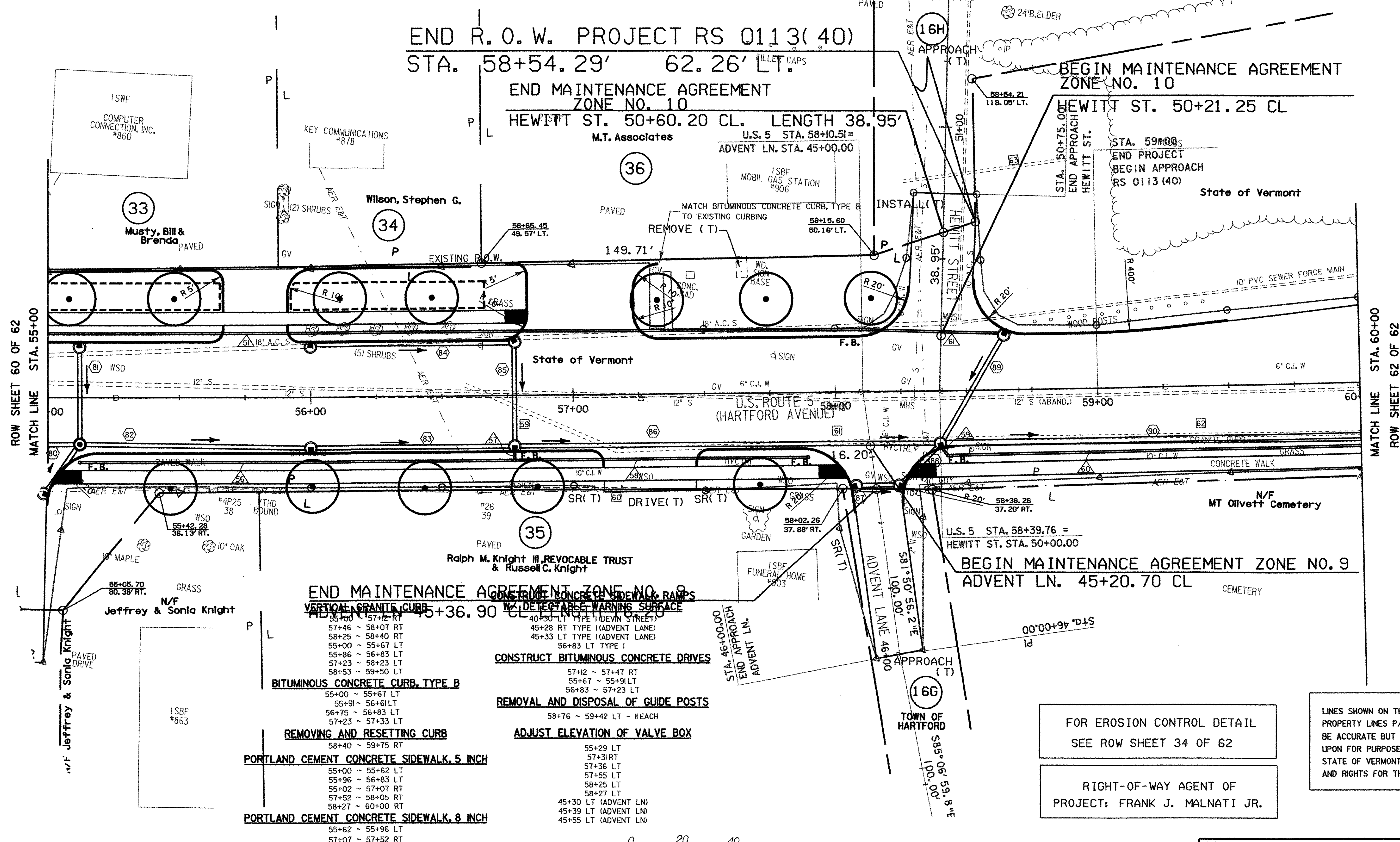

ROW SHEET 60 OF 62  
MATCH LINE STA. 55+00

MATCH LINE STA. 60+00  
ROW SHEET 62 OF 62

END MAINTENANCE AGREEMENT ZONE NO. 8  
ADVENT LN. STA. 45+36.90 CL. LENGTH 19.25'

BITUMINOUS CONCRETE CURB, TYPE B  
55+00 ~ 55+67 LT  
55+91 ~ 56+61 LT  
56+75 ~ 56+83 LT  
57+23 ~ 57+33 LT

REMOVING AND RESETTNG CURB  
58+40 ~ 59+75 RT

PORTLAND CEMENT SIDEWALK, 5 INCH  
55+00 ~ 55+62 LT  
55+96 ~ 56+83 LT  
55+02 ~ 57+07 RT  
57+52 ~ 58+05 RT  
58+27 ~ 60+00 RT

PORTLAND CEMENT SIDEWALK, 8 INCH  
55+62 ~ 55+96 LT  
57+07 ~ 57+52 RT

CONSTRUCT BITUMINOUS CONCRETE DRIVES  
57+42 ~ 57+47 RT  
55+67 ~ 55+91 LT  
56+83 ~ 57+23 LT

REMOVAL AND DISPOSAL OF GUIDE POSTS  
58+76 ~ 59+42 LT - II EACH

ADJUST ELEVATION OF VALVE BOX  
55+29 LT  
57+31 RT  
57+36 LT  
57+55 LT  
58+25 LT  
58+27 LT  
45+30 LT (ADVENT LN)  
45+39 LT (ADVENT LN)  
45+55 LT (ADVENT LN)

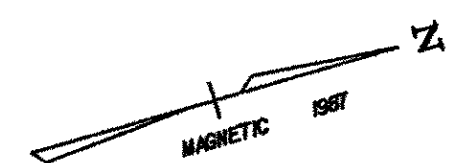
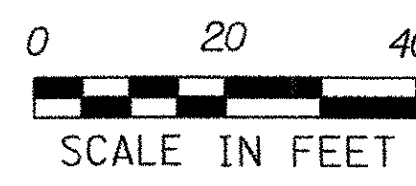

FOR EROSION CONTROL DETAIL  
SEE ROW SHEET 34 OF 62

RIGHT-OF-WAY AGENT OF  
PROJECT: FRANK J. MALNATI JR.

LINES SHOWN ON THIS PLAN AS EXISTING  
PROPERTY LINES P/L ARE BELIEVED TO  
BE ACCURATE BUT SHOULD NOT BE RELIED  
UPON FOR PURPOSES UNRELATED TO THE  
STATE OF VERMONT'S ACQUISITION OF LAND  
AND RIGHTS FOR THIS PROJECT.

**DATUM**

VERTICAL	NGVD 1929
HORIZONTAL	N/A

FOR LANDSCAPE DETAIL  
SEE ROW SHEET 43 OF 62

PROJECT: <b>HARTFORD</b>	PROJECT NO. : <b>RS 0113(40)</b>
DESIGN FILE NAME: z027bdr.dgn	PLOT DATE: 04-DEC-2006
IPARM FILE NAME:	SURVEY DATE: 1/87
SURVEYED BY: FANTONI	DRAWN BY: E. ATKINS
SQUAD LEADER: KEN UPMAL	SHEET 42 OF 239
ROW SHEET 61 OF 62	

**ROADWAY LAYOUT SHEET 8**