

TYPICAL SECTIONS US ROUTE 5

| MATERIAL ITEM | THICKNESS TOLERANCE |
|-----------------------------------|------------------------|
| PAVEMENT (TOTAL DEPTH ALL LAYERS) | +/- 1/4" |
| SUBBASE | +/- 1" |
| GRANULAR BORROW | +/- 1" |
| SAND BORROW | +/- 1" |

1 3/4" BITUMINOUS CONCRETE PAVEMENT IN ONE LIFT (TYPE IIS PG58-34)
 2 3/4" BITUMINOUS CONCRETE PAVEMENT IN ONE LIFT (TYPE IIS PG58-34)
 3" BITUMINOUS CONCRETE PAVEMENT IN ONE LIFT (TYPE IS PG58-34)
 24" SUBBASE OF DENSE GRADED CRUSHED STONE
 12" SAND BORROW (STA. 21+45 - 38+50)

SEEDING FORMULA LOW GROW / FINE FESCUE SEEDING MIX

| % WT. | LBS./A. | NAME | PUR % | GERM % |
|--------|---------|---------------------|-------|--------|
| 38.0 | 45.6 | CREEPING RED FESCUE | 98 | 85 |
| 29.0 | 34.8 | SPARTEN HARD FESCUE | 95 | 90 |
| 15.0 | 18.0 | AZAY SHEEPS FESCUE | 85 | 90 |
| 15.0 | 18.0 | ANNUAL RYE GRASS | 95 | 85 |
| 3.0 | 3.6 | INERTS | | |
| 100.00 | 120.0 | | | |

GENERAL NOTES

SEED MIXTURE: SHALL BE APPLIED AT A RATE OF 120 LB/ACRE AND SHALL NOT HAVE A WEED CONTENT EXCEEDING 0.40% BY WEIGHT AND SHALL BE FREE OF ALL NOXIOUS SEED.

SEED: PERCENT OF SEED, CROP, WEED OR INERT MAY VARY +/- 2%. VARIETIES OF GRASSES MAY BE SUBSTITUTED ONLY WITH APPROVAL FROM RESIDENT ENGINEER.

FERTILIZER: FORMULA 10-20-10, TO BE USED WITH SEED, APPLIED AT THE RATE OF 500 LBS./ACRE. (HYDRO SEEDERS MAY USE 19-19-19 FORMULA).

AGRICULTURAL LIMESTONE: TO BE APPLIED AT THE RATE OF 2 TONS/ACRE, OR AS DIRECTED BY THE ENGINEER.

HAY MULCH: TO BE PLACED ON EARTH SLOPES AT THE RATE OF 2 TONS/ACRE, OR AS DIRECTED BY THE ENGINEER.

MOWING: RECOMMENDED EARLY MOWING ONCE OR TWICE WHEN GRASS REACHES 6" HEIGHT MAXIMUM TO PREVENT BROADLEAF WEED COMPETITION DURING ESTABLISHMENT PERIOD.

TOPSOIL: TO BE USED WITH SEED AS INDICATED ON THE PLANS, OR AS DIRECTED BY THE ENGINEER.

MARKER POSTS: TO BE PLACED AS INDICATED OR AS DIRECTED BY THE ENGINEER.

SLOPE ROUNDING: ALL CUT SLOPES TO BE ROUNDED IN ACCORDANCE WITH STANDARD SHEET B - 5.

TACK COAT: EMULSIFIED ASPHALT IS TO BE APPLIED AT THE RATE OF 0.015 GAL/SY BETWEEN SUCCESSIVE COURSES OF PAVEMENT AS DIRECTED BY THE ENGINEER.

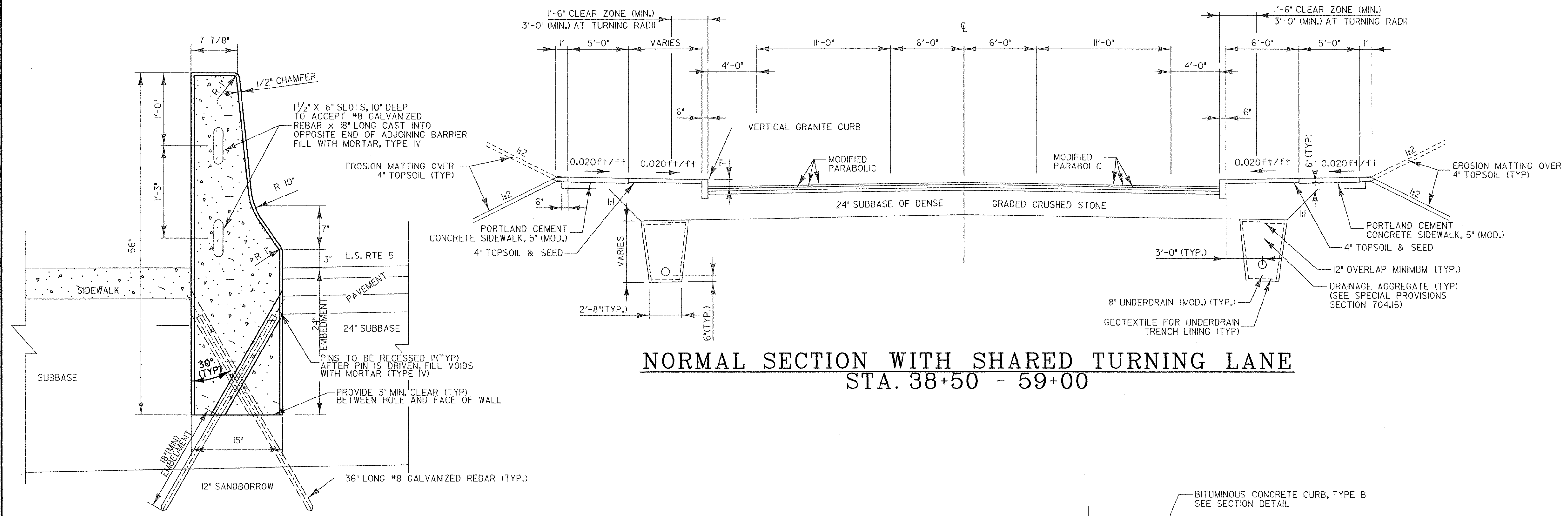

**NORMAL SECTION WITH SHARED TURNING LANE
STA. 38+50 - 59+00**

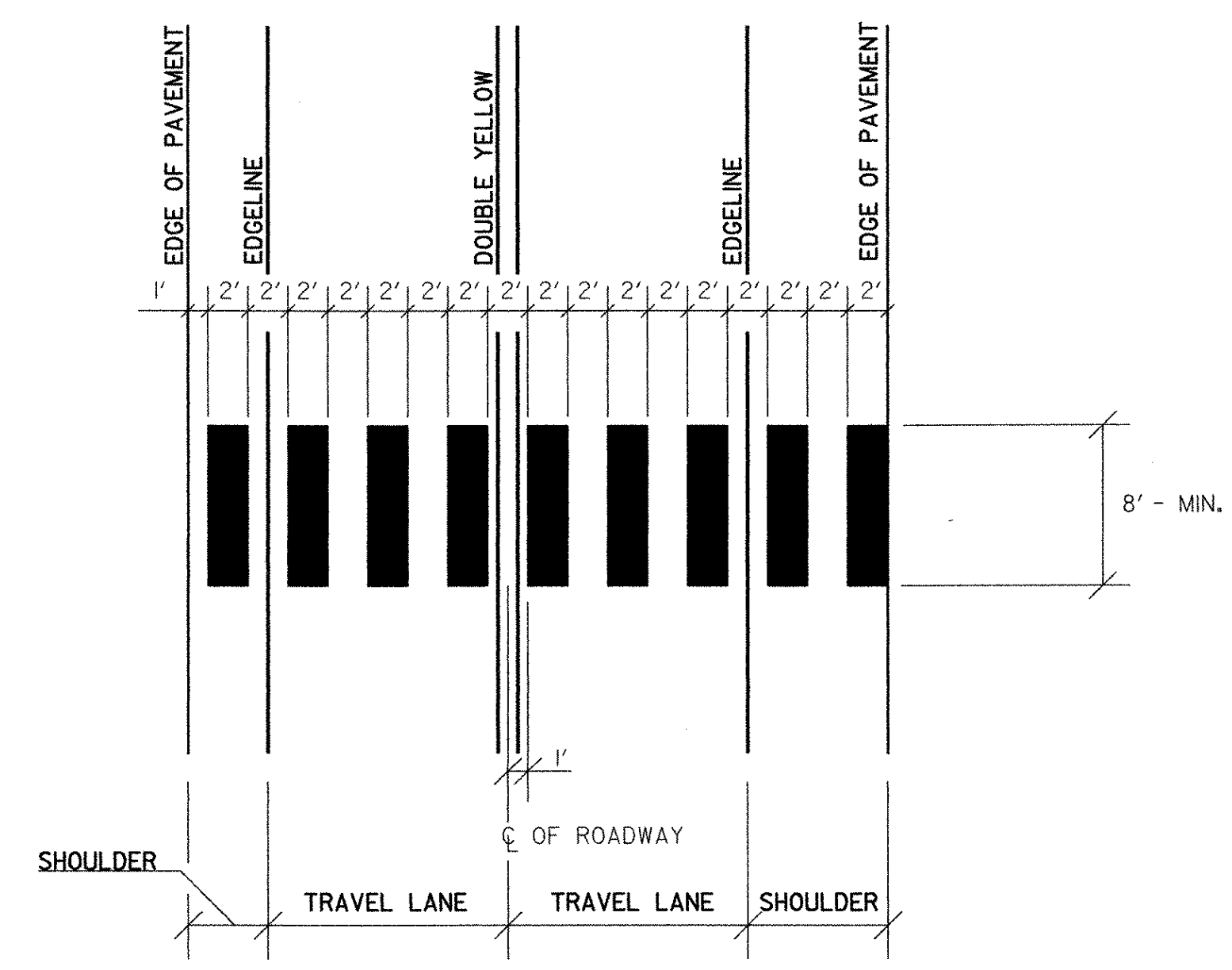

**BLOCK TYPE CROSSWALK DETAIL
(NOT TO SCALE)**

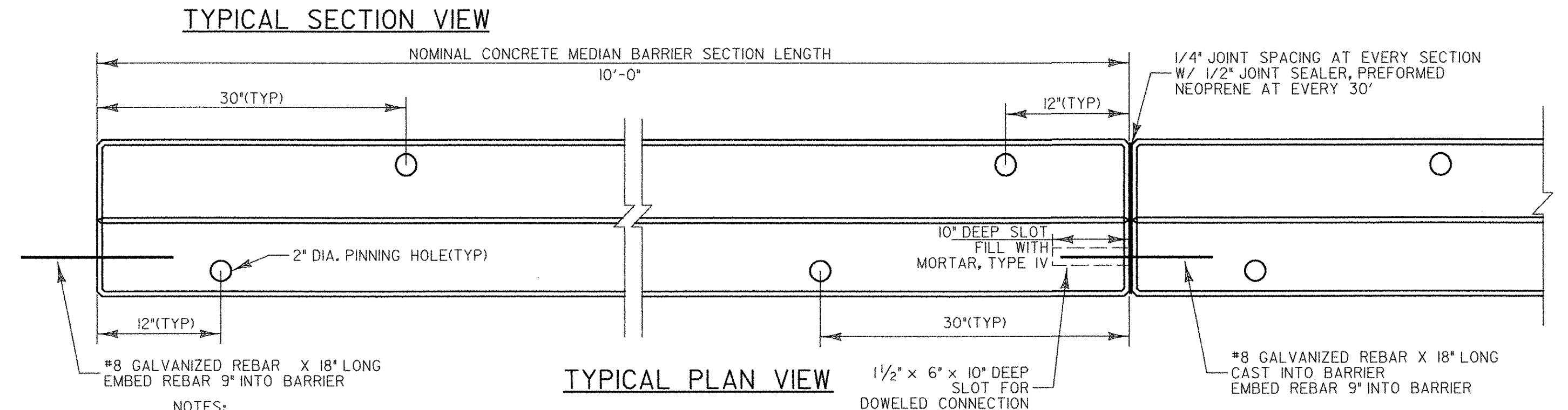

**TYPICAL PLAN AND SECTION
CONCRETE MEDIAN BARRIER (MOD.)
NOT TO SCALE**

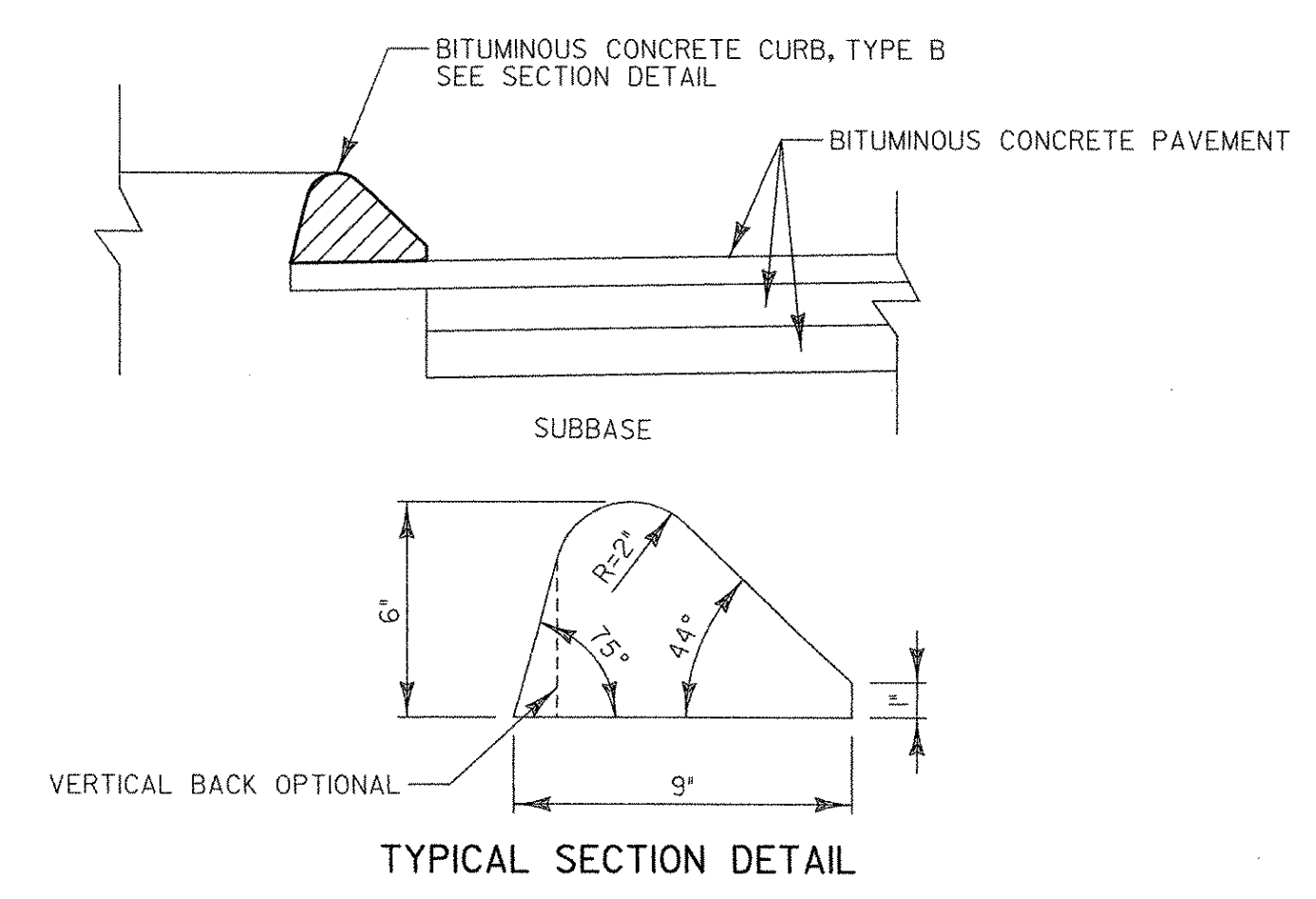

**TYPICAL BITUMINOUS CONCRETE
CURB, TYPE B SECTION
NOT TO SCALE**

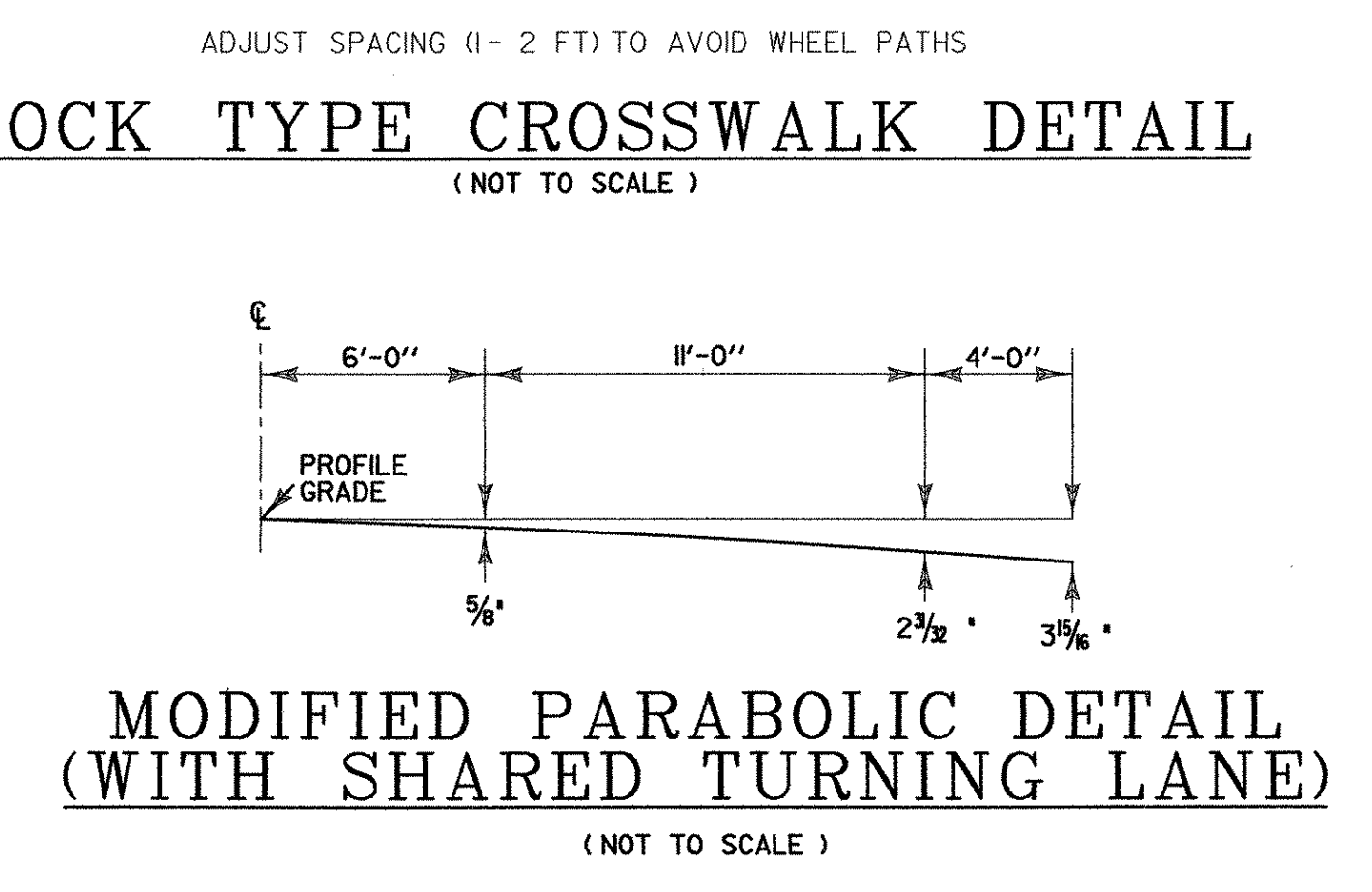

**MODIFIED PARABOLIC DETAIL
(WITH SHARED TURNING LANE)
(NOT TO SCALE)**

- NOTES:**
- FACE OF CONCRETE MEDIAN BARRIER SHALL HAVE THE SAME EXPOSED AGGREGATE TEXTURED FINISH AS THE RETAINING WALL PANELS. REFER TO SPECIFICATIONS FOR COLOR AND AGGREGATE REQUIREMENTS.
 - CONCRETE MEDIAN BARRIERS SHALL BE PRECAST UNLESS OTHERWISE SPECIFIED OR WHEN DIRECTED BY THE ENGINEER, CONCRETE MEDIAN BARRIER SECTION NOMINAL LENGTH SHALL NOT EXCEED 10'-0".
 - THE SPACING BETWEEN ADJACENT SECTIONS OF CONCRETE MEDIAN BARRIER SHALL BE 1/4" TO ALLOW FOR EXPANSION AND CONTRACTION. A 1/2" JOINT SEALER, PREFORMED NEOPRENE SHALL BE PLACED AT 30' JOINT INTERVALS OF THE CONCRETE MEDIAN BARRIER.
 - PRECAST CONCRETE SHALL BE 4000 PSI @ 28 DAYS.
 - THE CONTRACTOR SHALL PROVIDE REINFORCING DESIGN DETAIL FOR APPROVAL. ALL REINFORCING SHALL BE GRADE 60, EPOXY COATED.
 - PAYMENT FOR GALVANIZED REBAR, MORTAR (TYPE IV), AND JOINT SEALER, PREFORMED NEOPRENE SHALL BE INCIDENTAL TO THE CONCRETE MEDIAN BARRIER (MOD.) ITEM.

DATUM

| | |
|------------|-----------|
| VERTICAL | NGVD 1929 |
| HORIZONTAL | N/A |

| | |
|-------------------------------------|-----------------------------|
| PROJECT: HARTFORD | PROJECT NO.: RS 0113(40) |
| DESIGN FILE NAME: z86c027+ypdet.DGN | PLOT DATE: 2/28/2007 |
| IPARM FILE NAME: | SURVEY DATE: 1/87 |
| SURVEYED BY: FANTONI | DRAWN BY: E. ATKINS |
| SQUAD LEADER: KEN UPMAL | SHEET: 4 OF 239 |