

### TYPICAL DUCT 14

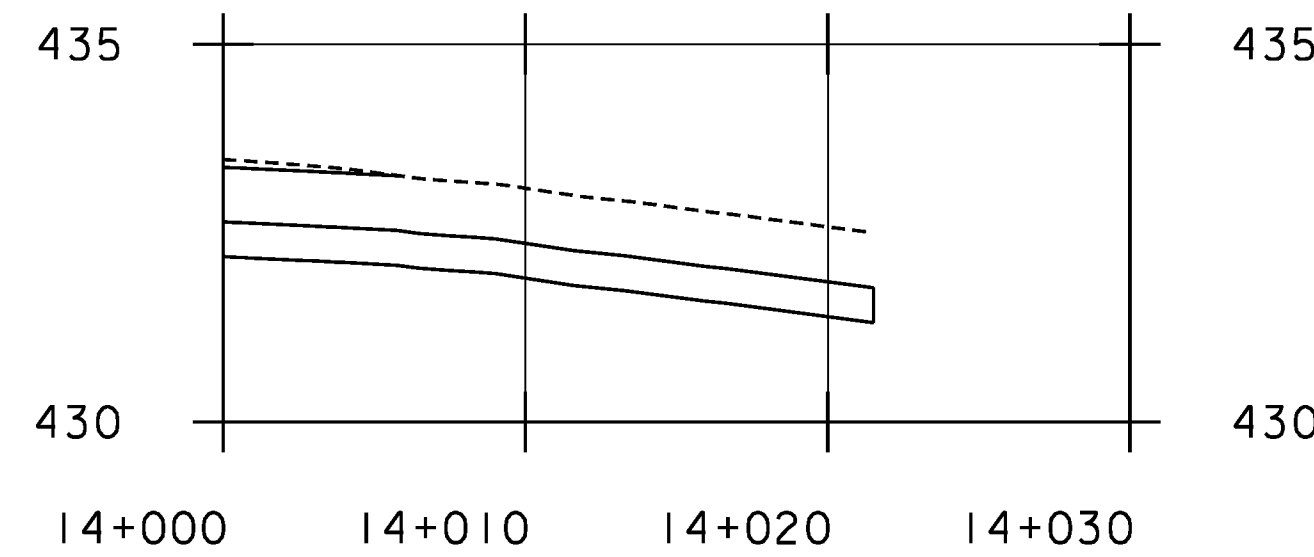

### TYPICAL DUCT 15

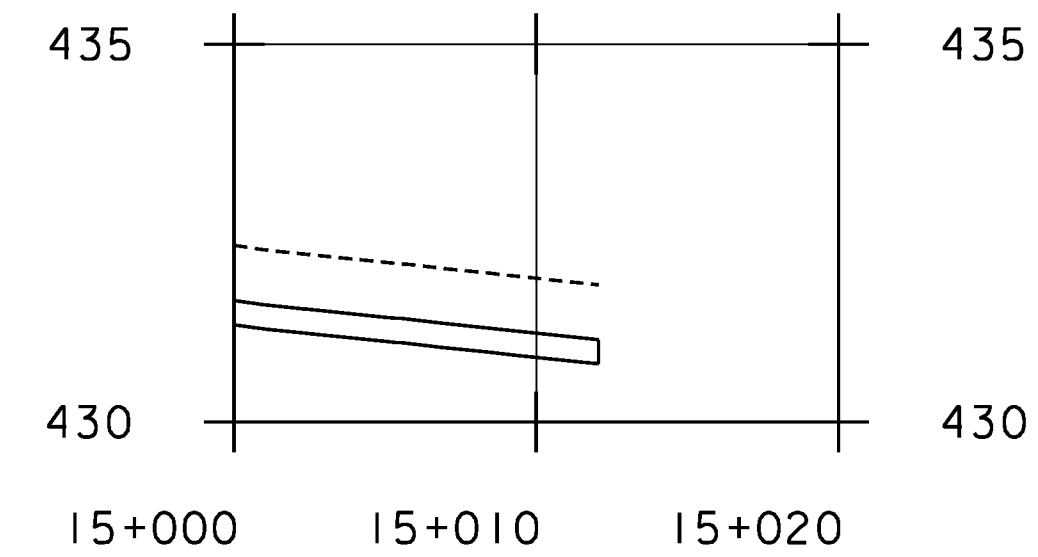

### TYPICAL DUCT 16

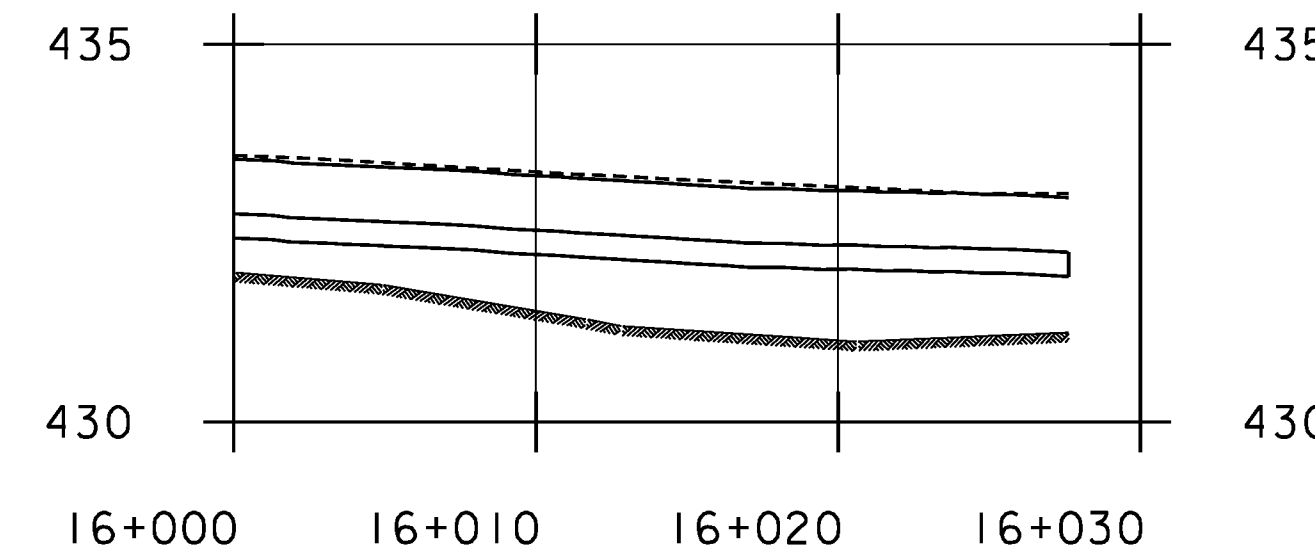

### TYPICAL DUCT 17

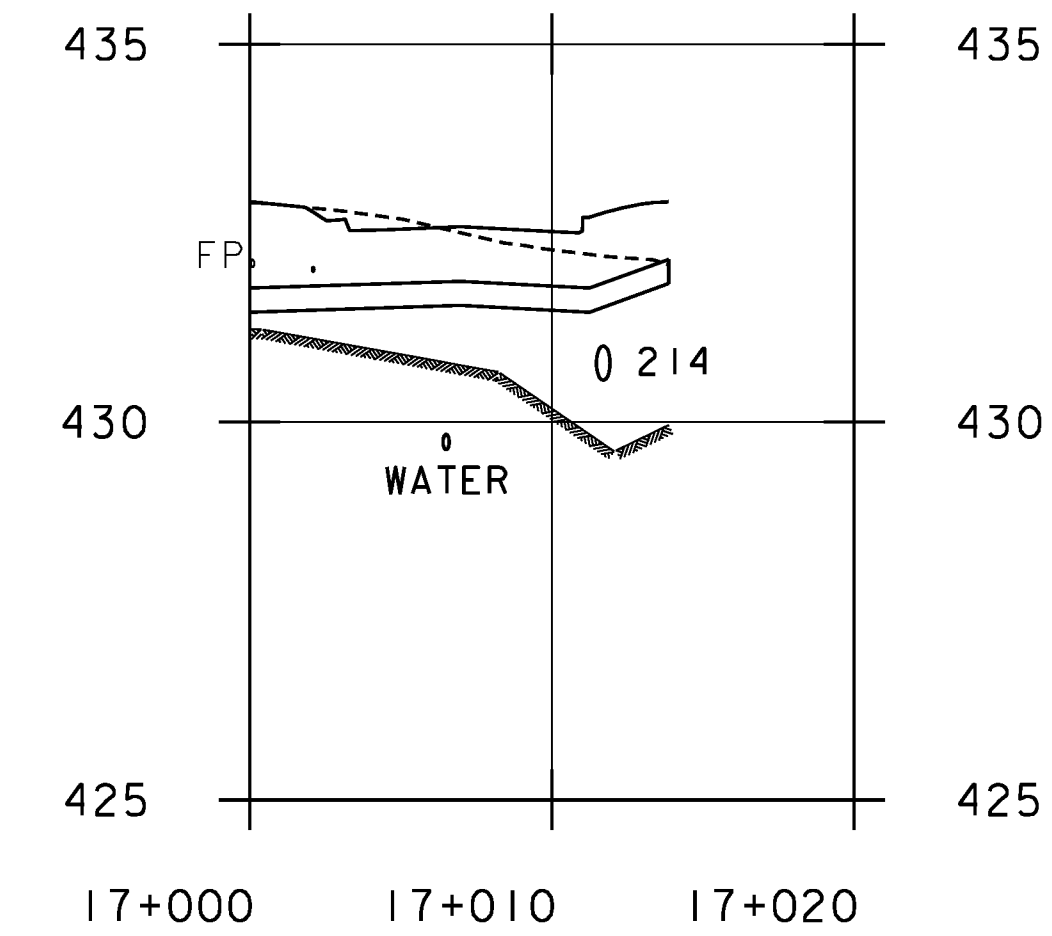

### TYPICAL DUCT 18

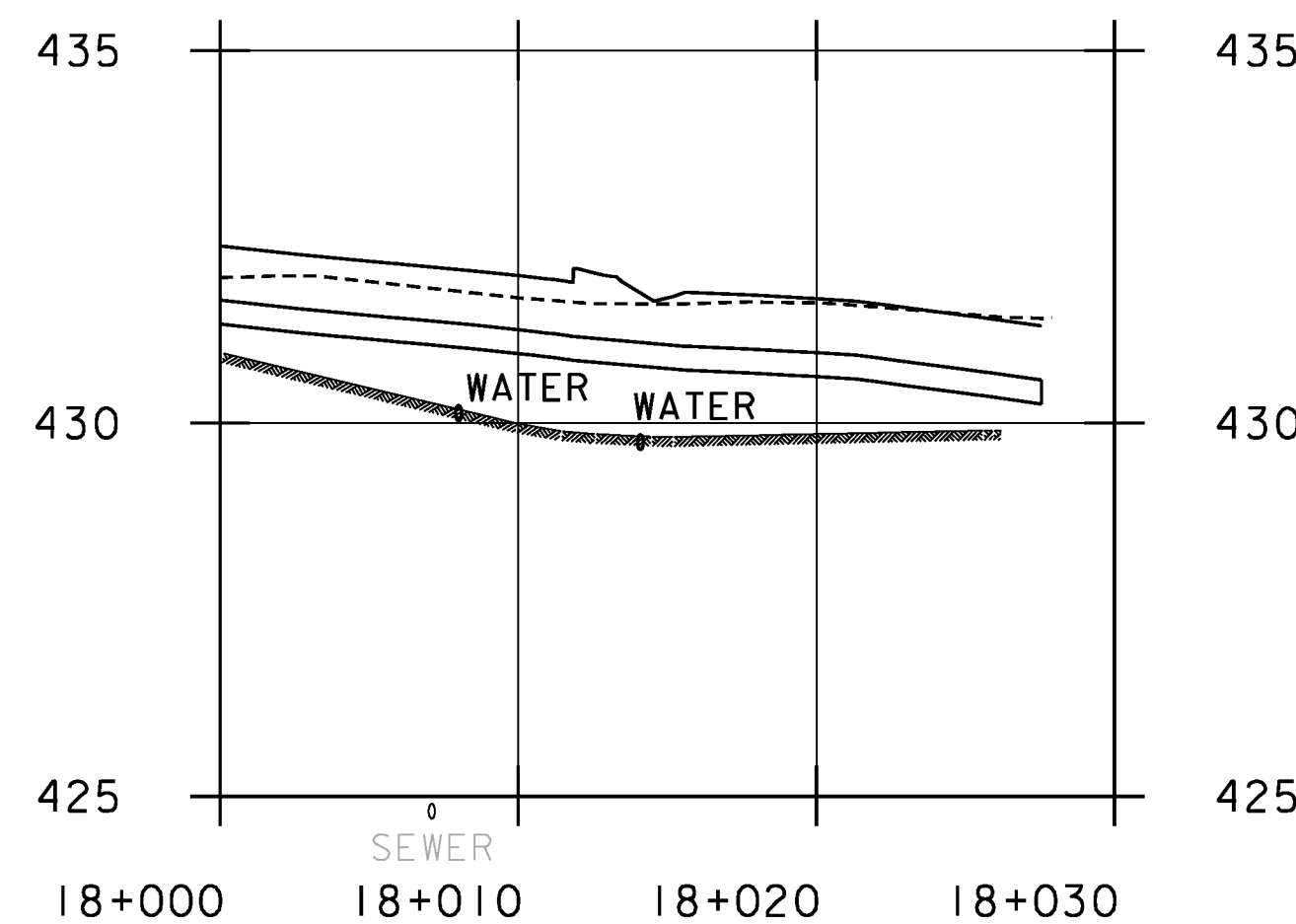

### TYPICAL DUCT 19

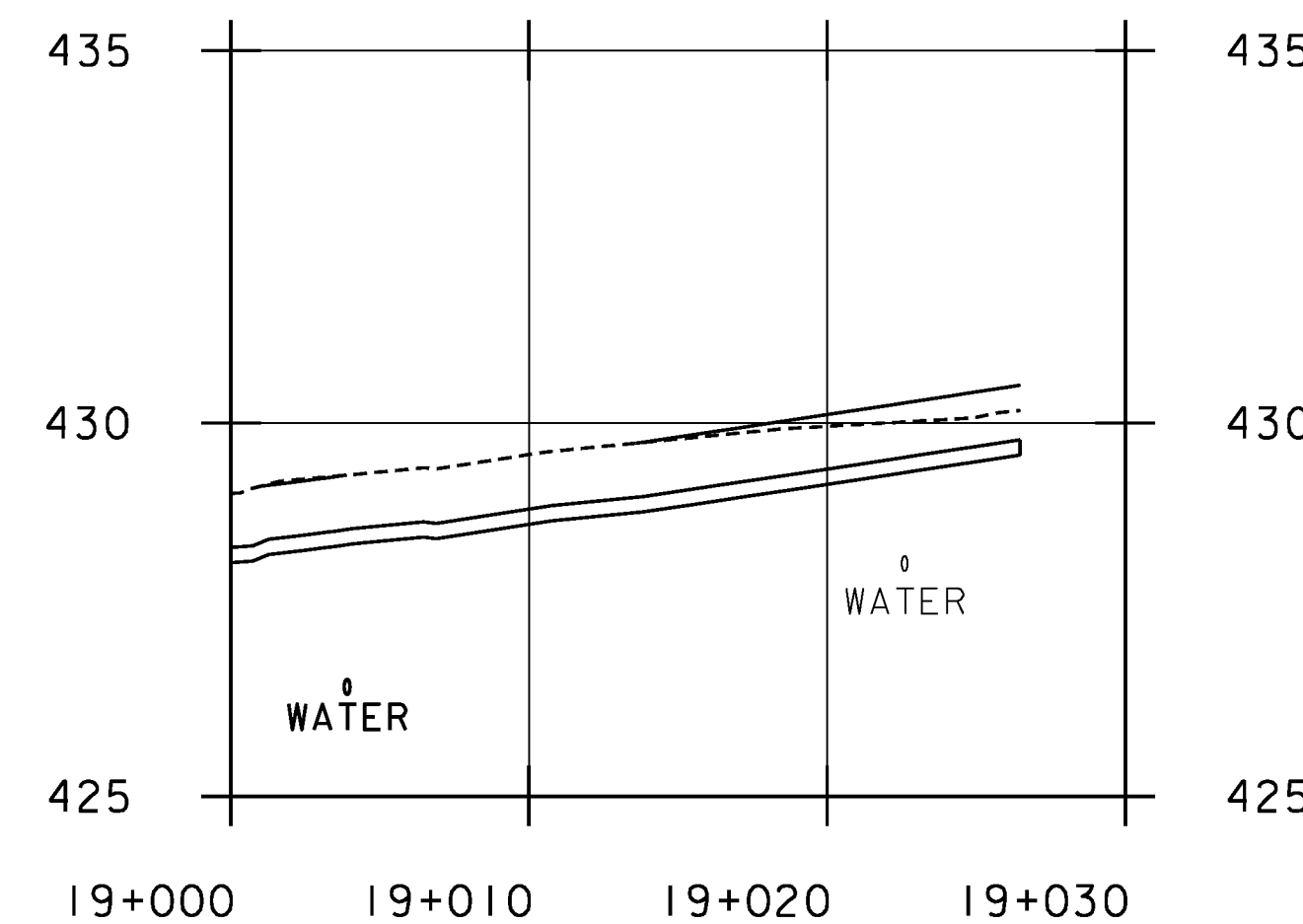

### TYPICAL DUCT 20

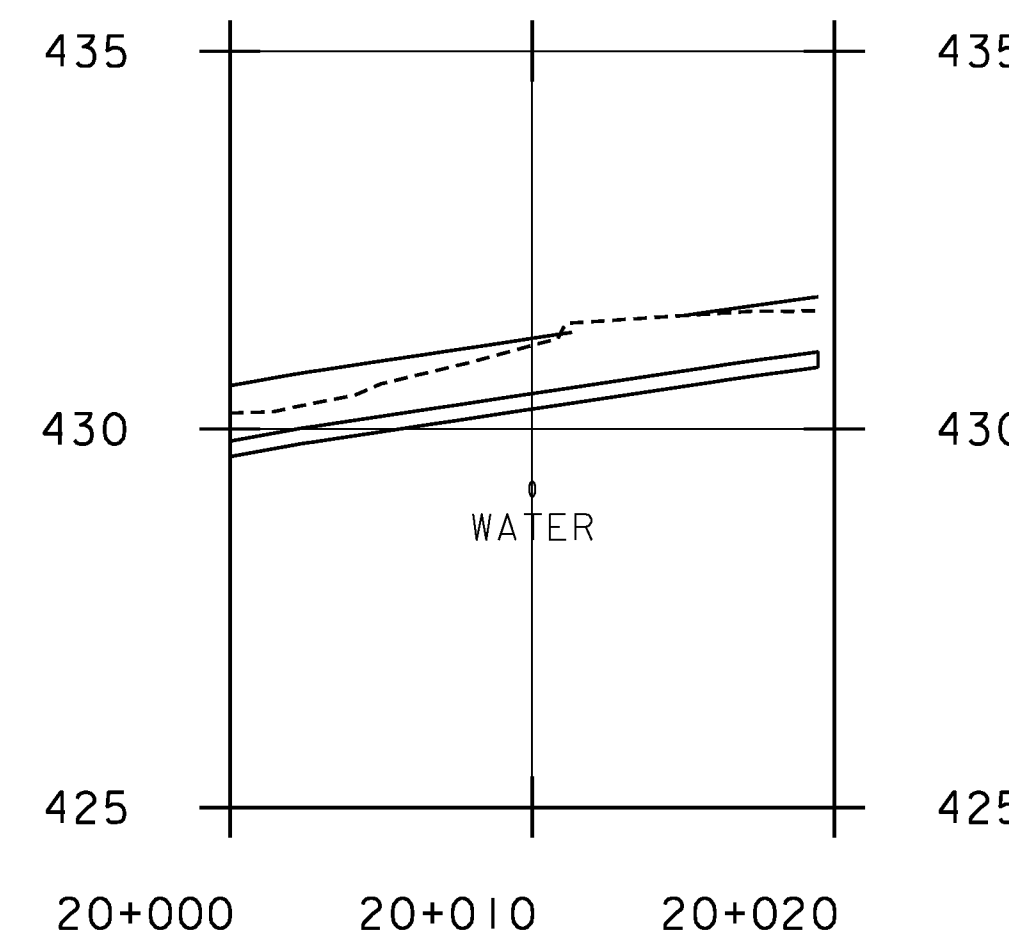

### TYPICAL DUCT 21

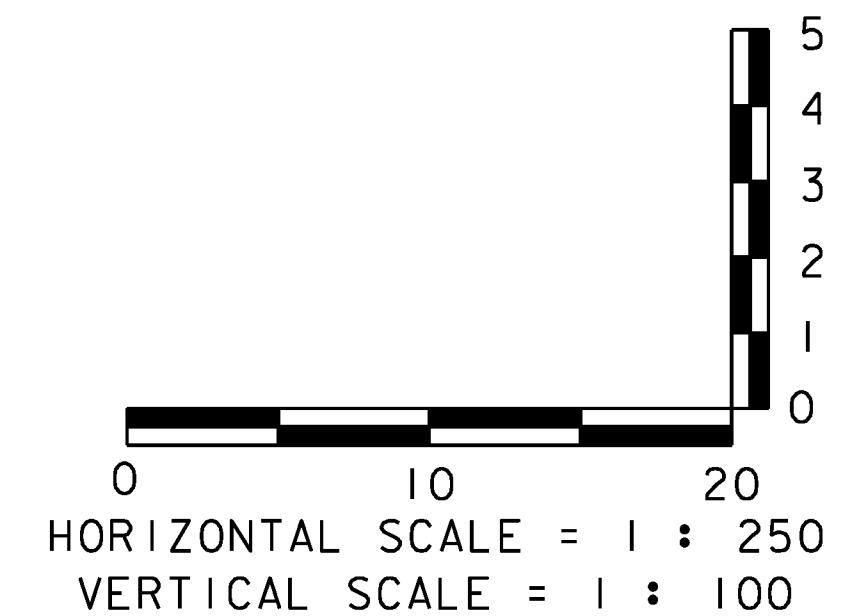
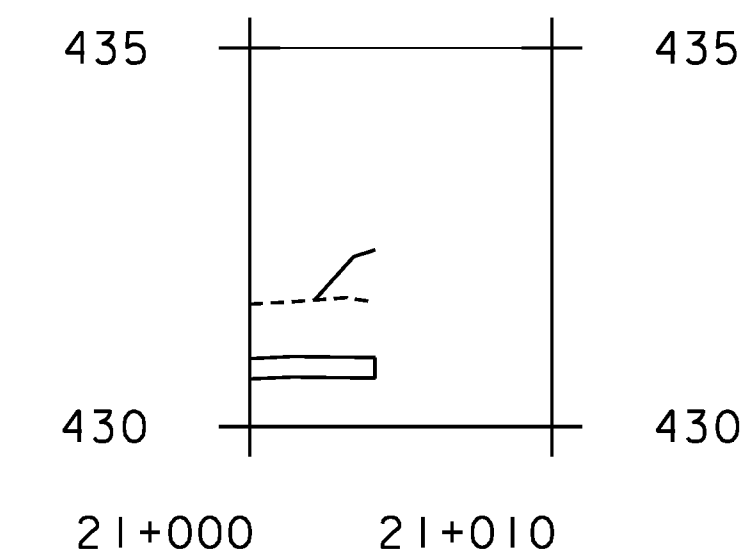

- EXISTING GRADE
- \_\_\_\_\_ FINISH GRADE
- (T) CVPS 3-PHASE
- (S) CVPS SINGLE PHASE

NOTE:  
BEGIN AND END OF DUCT SHALL CORRESPOND  
TO DIRECTION OF ARROWHEAD ON UTILITY  
PLANS.

**REPLACEMENT SHEETS  
ISSUED 02/24/2012**



PROJECT NAME: DANVILLE  
PROJECT NUMBER: F EGC 028-3(32)

FILE NAME: ...\\100 det\_profiles.prf  
DESIGN SUPERVISOR: GARY SANTY  
DESIGNED BY: STANTEC  
DUCT BANK PROFILES DTP-03

PLOT DATE: 2/24/2012  
DRAWN BY: STANTEC  
CHECKED BY: STANTEC  
SHEET 215B OF 306