

LANDSCAPE AND LIGHTING LEGEND

	PROPOSED CONIFEROUS	SHOWN AT APPROXIMATE 20-YEAR GROWTH SPREAD
	PROPOSED DECIDUOUS	
	EXISTING TREES	
	LIGHTING LOCATIONS (ARROW SHOWS DISTRIBUTION DIRECTION)	
	GRANITE POST LOCATIONS	
	HANDHOLE	
	ROUTE 2 LIGHTING METER PEDESTAL SEE DETAIL ON LIGHTING DETAILS SHEET LTD-6	
	DANVILLE GREEN METER PEDESTAL SEE DETAIL ON LIGHTING DETAILS SHEET LTD-6	
	LANDSCAPING DETAIL SHEET	
	LANDSCAPE BACKFILL	
	WIRED CONDUIT (PVC) (50mm)	
	ELECTRICAL CONDUIT SLEEVE (200mm) (PVC)	

679.45 - LIGHT POLE

POLE NO.	LOCATION	FIXTURE TYPE	WATTS	TYPE	MOUNTING HEIGHT
SL-57	19+262.50, 6.63M LT	B	175	III	5.48M
SL-59	19+281.50, 6.63M LT	B	175	III	5.48M
SL-61	19+326.00, 6.63M LT	B	175	III	5.48M
SL-63	19+353.50, 6.63M LT	B	175	III	5.48M
SL-65	19+383.00, 6.63M LT	B	175	III	5.48M
SL-67	19+411.00, 6.63M LT	B	175	III	5.48M
SL-69	19+427.00, 8.70M LT	B	175	III	5.48M
SL-70	19+441.50, 6.51M RT	B	175	III	5.48M

678.26 - JUNCTION BOX

HAND HOLE NO.	LOCATION
HH-9	19+312.00, 5.50M LT
HH-11	19+428.00, 8.71M LT
HH-13	19+442.00, 8.54M LT
HH-34	19+443.50, 6.40M RT

678.30 - ELECTRICAL CONDUIT SLEEVE (200mm)(PVC)

STA.	LOCATION
6+008.4, RT	6+008.9, LT
19+442.3, LT	19+443.2, RT

656.30 - DECIDUOUS TREES

STA.	NO.	LOCATION	DESCRIPTION
19+264.9	3-2	RT	AMERICAN HORNBEAM
19+279.4	1	LT	RED OAK
19+323.0	1	LT	SERVICEBERRY
19+340.5	2-3	LT	PRINCETON AMERICAN ELM
19+346.3	3	RT	SERVICEBERRY
19+414.4	1	LT	AUTUMN BLAZE MAPLE
19+295	1	LT	AUTUMN BLAZE MAPLE

656.35 - DECIDUOUS SHRUBS

STA.	NO.	LOCATION	DESCRIPTION
19+416.9	2	RT	WITCH HAZEL
19+417.1	5	RT	REDSTEM DOGWOOD
19+423.3	15	RT	DWARF WINTERBERRY

900.620 - SPECIAL PROVISION (GRANITE POST)

STA.	LOCATION	DESCRIPTION
19+426.4	LT	GRANITE POST #22

MATCH LINE - STA. 19+260 SEE SHEET LLP-5

MATCH LINE - STA. 19+450 SEE SHEET LLP-8

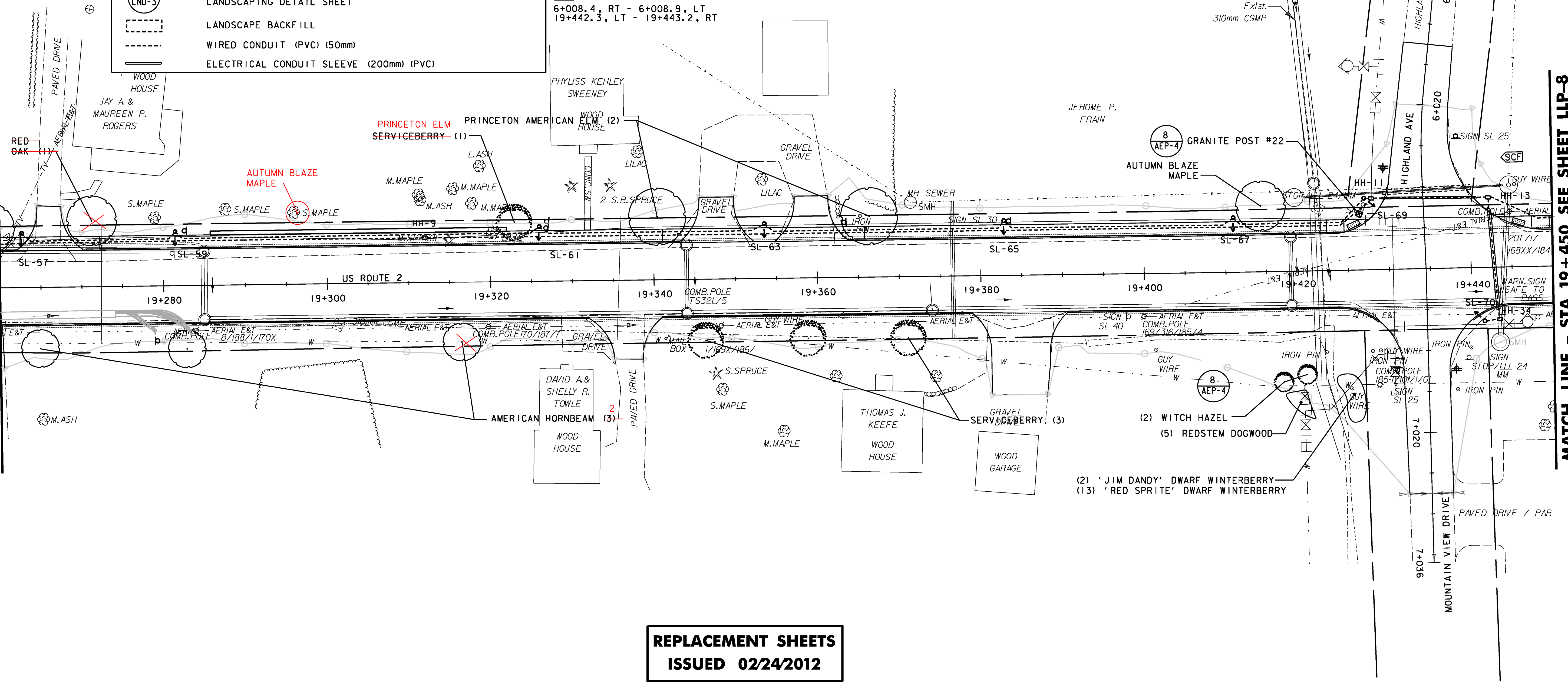

**REPLACEMENT SHEETS
ISSUED 02/24/2012**

DATUM	
VERTICAL	NAVD88
HORIZONTAL	NAD83(92)

- NOTES:
- ALL TREES ARE TO BE STAKED AND PLANTED SO TRUNK IS A MINIMUM OF 1M FROM EDGE OF ALL SIDEWALKS AND FROM SUBBASE FOR FUTURE SIDEWALK (EAST OF STA 2+220 ON RTE 2) - SEE CROSS SECTIONS.
 - FINAL PLANTING LOCATION ARE TO BE APPROVED BY VTRANS PRIOR TO PLACEMENT OF LANDSCAPE BACKFILL AND INSTALLATION OF ALL TREES AND SHRUBS.

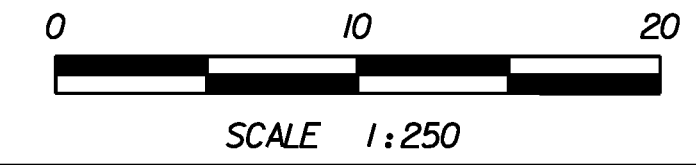

PROJECT NAME:	DANVILLE	PLLOT DATE:	2/24/2012
PROJECT NUMBER:	F EGC 028-3(32)	DRAWN BY:	STANTEC
FILE NAME:	...PlotFiles\083 1107.prf	CHECKED BY:	STANTEC
DESIGN SUPERVISOR:	GARY SANTY	SHEET	183 OF 306
DESIGNED BY:	STANTEC	LANDSCAPE & LIGHTING PLAN LLP-7	

STA 19+260 TO 19+450