

646.416 DURABLE 100 MM YELLOW LINE,
RECESSED POLYUREA
646.610 TEMPORARY 100 MM YELLOW LINE
STA. 19+760.0 TO 19+835.8, C (DOUBLE)
STA. 19+851.9 TO 19+910.0, C (DOUBLE)
STA. 19+851.9 TO 19+910.0, RT (DOUBLE)
646.456 DURABLE 200 MM YELLOW LINE,
RECESSED POLYUREA
646.650 TEMPORARY 200 MM YELLOW LINE
STA. 19+851.9 TO 19+910.0 RT. (DIAGONAL)

675.50 REMOVING SIGNS
AS SHOWN - I

646.406 DURABLE 100 MM WHITE LINE,
RECESSED POLYUREA
646.600 TEMPORARY 100 MM WHITE LINE
STA. 19+760.0 TO 19+910.0, LT
STA. 19+760.0 TO 19+910.0, RT
STA. 19+760.0 TO 19+835.8, RT

TEMPORARY & POLYUREA LETTER OR SYMBOL
STA. 19+773.6, RT - LEFT TURN ARROW
STA. 19+788.1, RT - "ONLY"
STA. 19+802.8, RT - LEFT TURN ARROW
STA. 19+817.9, RT - "ONLY"
STA. 19+833.7, RT - LEFT TURN ARROW

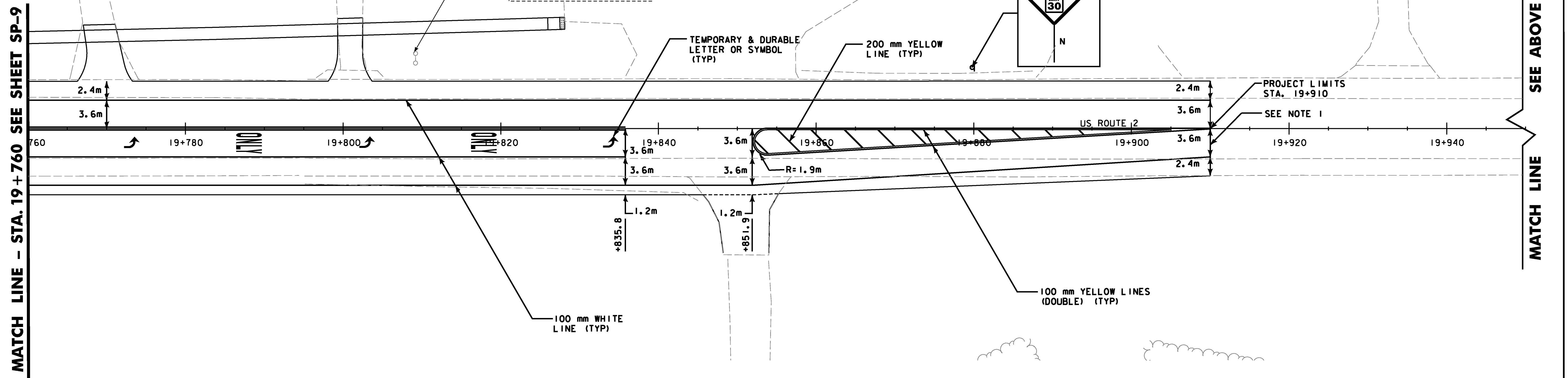
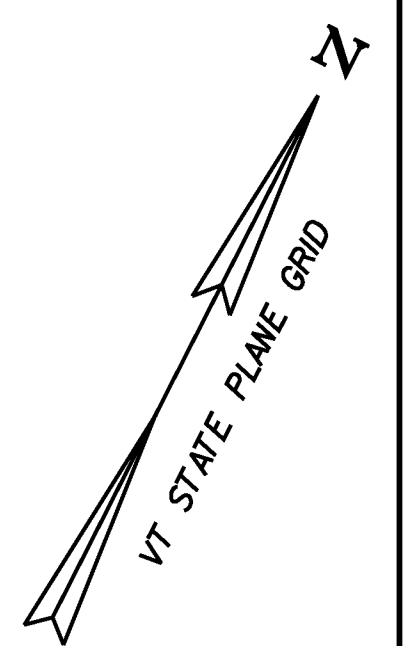
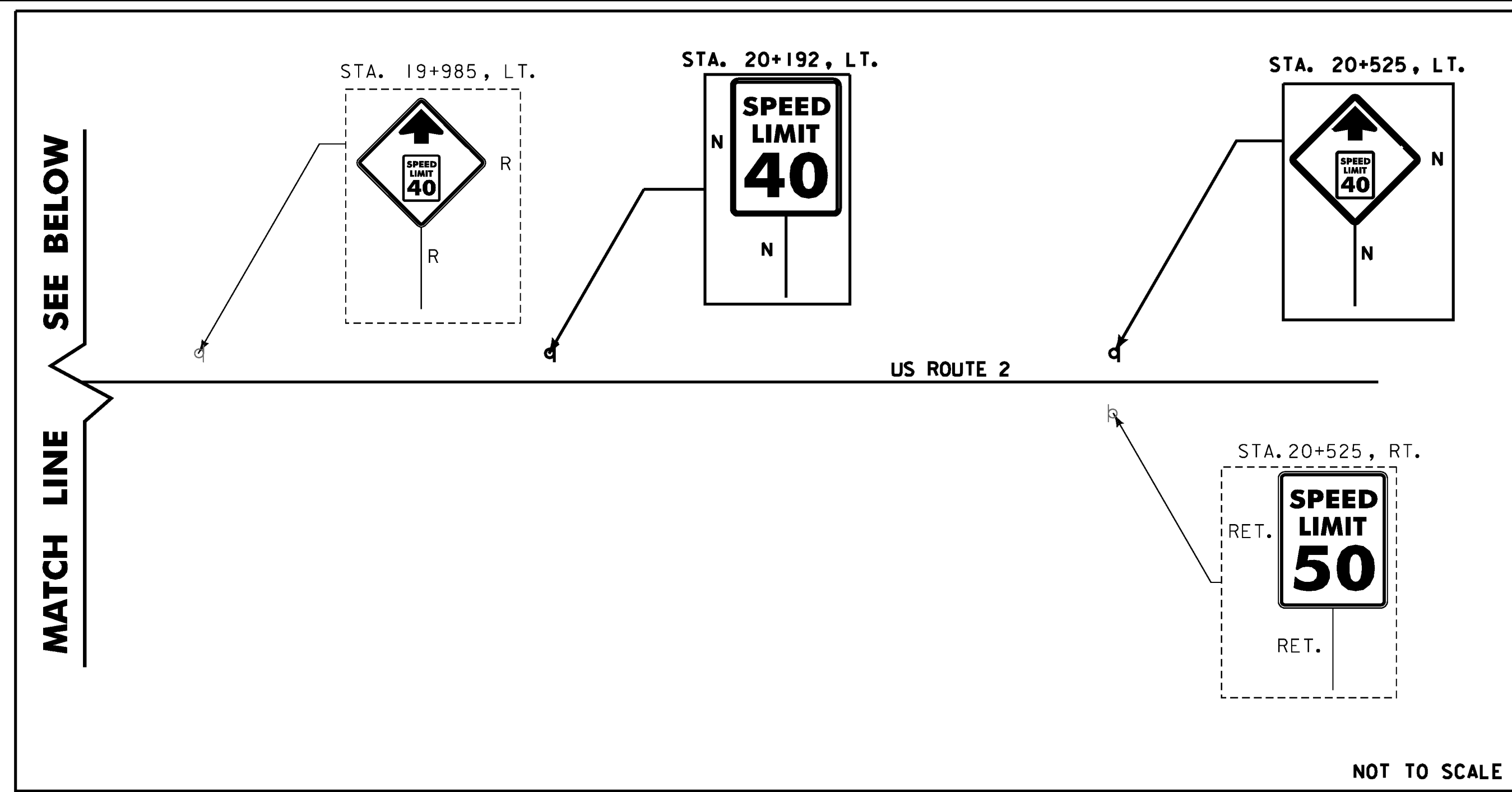
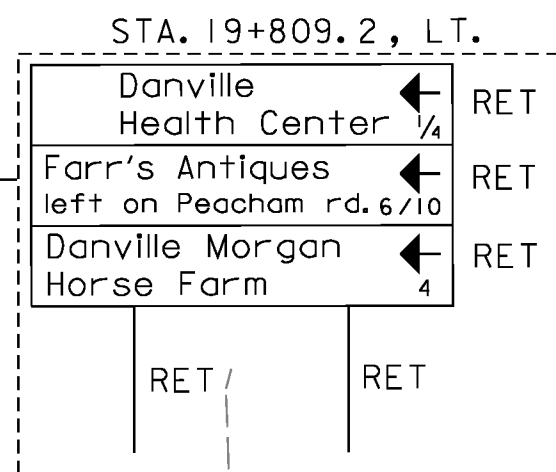

MATCH LINE - STA. 19+760 SEE SHEET SP-9

MATCH LINE SEE ABOVE

NOTES:
1. MATCH EXISTING STRIPING CONFIGURATION.
2. SEE SHEET SP-1 FOR LEGEND.

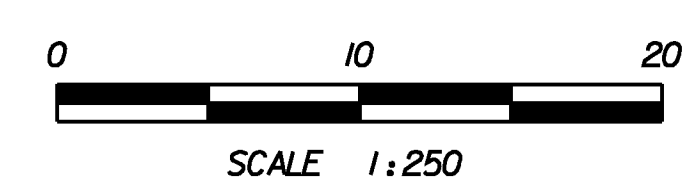

PROJECT NAME: DANVILLE	PLOT DATE: 1/18/2011
PROJECT NUMBER: F EGC 028-3(32)	DRAWN BY: STANTEC
FILE NAME: ...Highway\PlotFiles\Illps10.ptf	CHECKED BY: STANTEC
DESIGN SUPERVISOR: GARY SANTY	
DESIGNED BY: STANTEC	
SIGNING & PAVEMENT PLAN SHEET SP-10 SHEET 155 OF 306	