

646.406 DURABLE 100 MM WHITE LINE, RECESSED POLYUREA
 646.600 TEMPORARY 100 MM WHITE LINE
 STA. 18+770.0 TO 18+902.6, LT
 STA. 18+911.2 TO 18+925.8, LT
 STA. 18+928.2 TO 18+930.0, LT
 STA. 18+770.0 TO 18+925.8, RT
 STA. 18+928.2 TO 18+930.0, RT

646.81 PAINTED CURB

STA. 18+919.5 TO 18+925.8 (AROUND ISLAND)
 STA. 18+928.2 TO 18+930.0 (AROUND ISLAND)

646.700 TEMPORARY CROSSWALK MARKING
 646.507 DURABLE CROSSWALK MARKING, RECESSED TYPE 1 TAPE

STA. 18+927.0
 (FOR DETAIL SEE SHEET SGD-1)

646.456 DURABLE 200 MM YELLOW LINE, RECESSED POLYUREA
 646.650 TEMPORARY 200 MM YELLOW LINE

STA. 18+911.8 TO 18+920.0 (DIAGONALS)

646.416 DURABLE 100 MM YELLOW LINE, RECESSED POLYUREA
 646.610 TEMPORARY 100 MM YELLOW LINE

STA. 18+770.0 TO 18+900.0, C (DOUBLE)
 STA. 01+020.0 TO 01+075.0, C (DOUBLE)
 STA. 01+013.3 TO 01+020.0, RT (DOUBLE)
 STA. 18+911.8 TO 18+920.0, LT (DOUBLE)
 STA. 18+911.8 TO 18+920.0, RT (DOUBLE)
 STA. 18+920.0 TO 18+925.8, LT (SINGLE)
 STA. 18+920.0 TO 18+925.8, RT (SINGLE)
 STA. 18+928.2 TO 18+930.0, LT (SINGLE)
 STA. 18+928.2 TO 18+930.0, RT (SINGLE)

646.486 DURABLE 600 MM STOP BAR, RECESSED POLYUREA
 646.680 TEMPORARY 600 MM STOP BAR

STA. 01+013.6 (WALDEN HILL RD.)

675.60 ERECTING SALVAGED SIGNS AS SHOWN - 2

675.50 REMOVING SIGNS AS SHOWN - 15

646.494 DURABLE LETTER OR SYMBOL, POLYUREA
 646.690 TEMPORARY LETTER OR SYMBOL

STA. 1+032.8, RT.



MATCH LINE - STA. 18+770 SEE SHEET SP-2

MATCH LINE - STA. 18+930 SEE SHEET SP-4

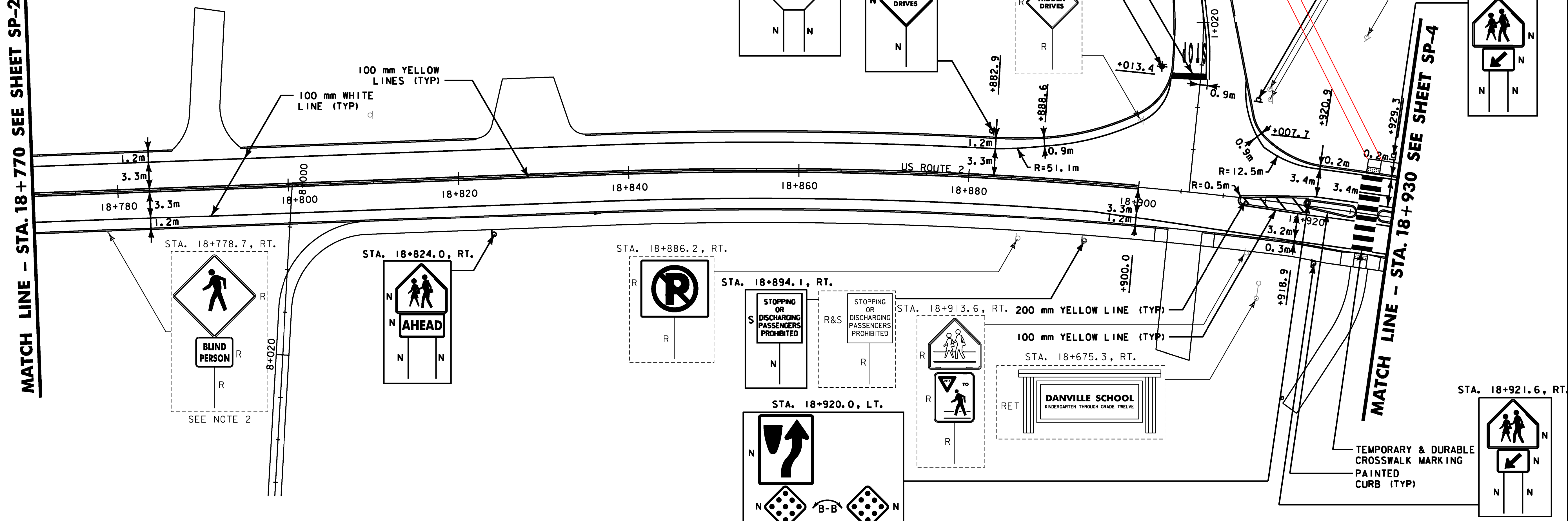

NOTES:

1. MATCH EXISTING STRIPING CONFIGURATION.
2. SIGNS SHALL BE RETURNED TO THE TOWN OF DANVILLE.
3. SEE SHEET SP-1 FOR LEGEND.

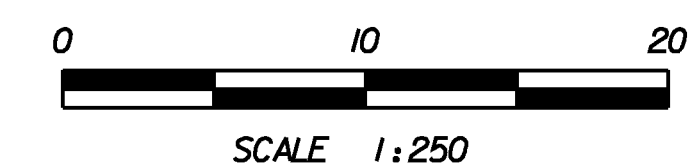

PROJECT NAME:	DANVILLE
PROJECT NUMBER:	F EGC 028-3(32)
FILE NAME:	...Highway\PlotFiles\03 ps03.ptf
DESIGN SUPERVISOR:	GARY SANTY
DESIGNED BY:	STANTEC
PLOT DATE:	1/18/2011
DRAWN BY:	STANTEC
CHECKED BY:	STANTEC
SIGNING & PAVEMENT PLAN SHEET SP-3 SHEET 147 OF 306	

1/18/2011 05:54:02 PM V:\1855\active\18550033_1082\Highway\PlotFiles\03 ps03.ptf