

AREA NUMBER	651.15 - SEED 651.25 - HAY MULCH	651.15 - SEED 653.20 - TEMPORARY EROSION MATTING
	AREAS (SM)	AREAS (SM)
1	97.2	
2		405.9
3		299.3
4	770.2	
5		757.9
6	53.9	
7	503.1	

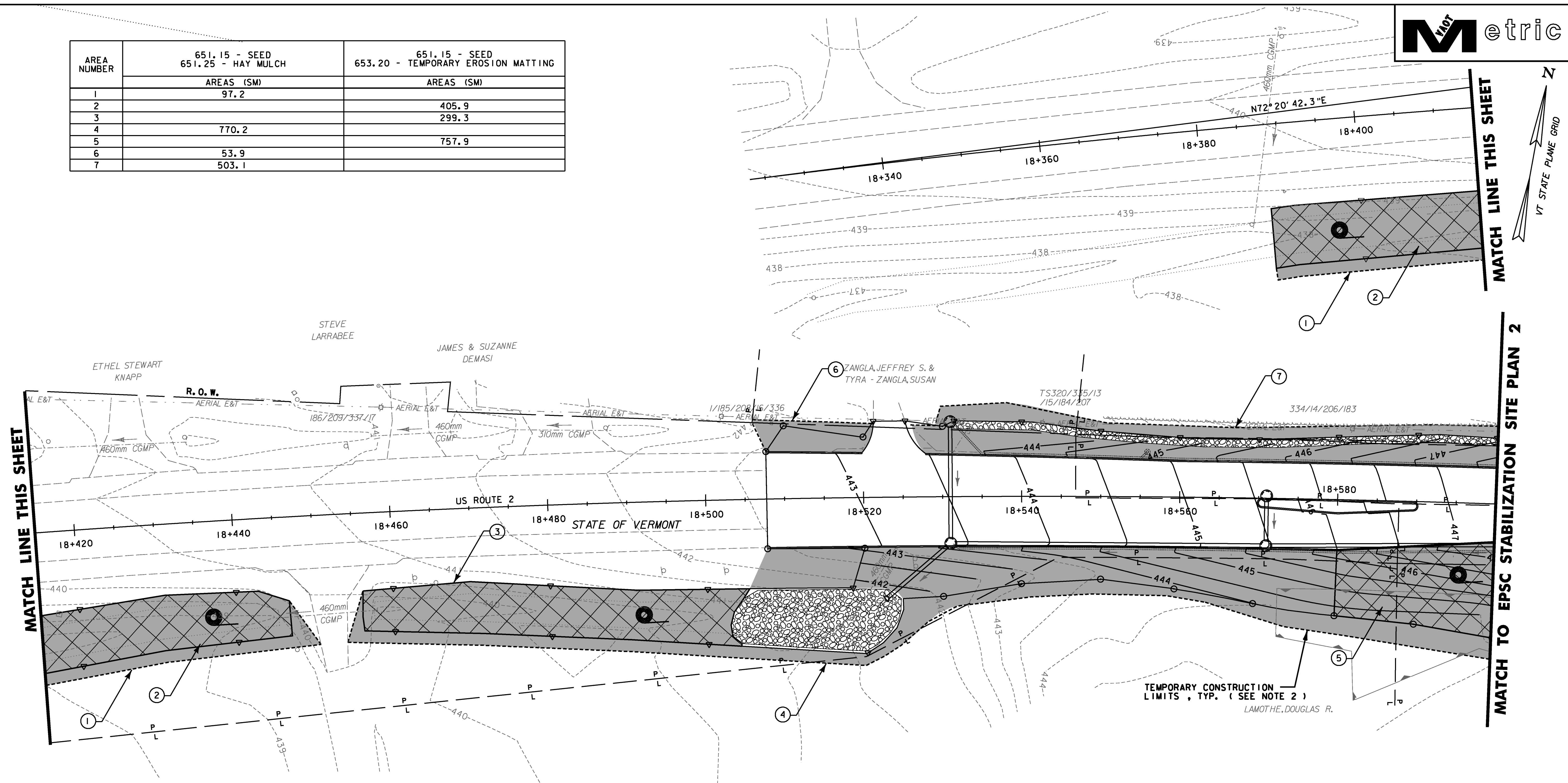

MATCH LINE THIS SHEET

MATCH LINE THIS SHEET

MATCH TO EPSC STABILIZATION SITE PLAN 2

EPSC STABILIZATION PLAN EROSION CONTROL LEGEND	
	RIGHT OF WAY
	PROPERTY LINE
	DISTURBED AREAS REQUIRING RE-VEGETATION
	TEMPORARY CONSTRUCTION LIMITS
	LIMITS OF SOIL DISTURBANCE
	FINISHED CONTOURS
	ROLLED EROSION CONTROL PRODUCT (RECP) EROSION MATTING FOR SIDE SLOPES AND DITCHES
	STONE OUTLET & DITCH PROTECTION
	CLASS III WETLAND BOUNDARY

- STABILIZATION NOTES:**
- SEE EPSC NARRATIVE SHEETS FOR ADDITIONAL REQUIREMENTS.
 - THE TEMPORARY CONSTRUCTION LIMIT IS THE AREA WITHIN THE PROJECT DEMARCATION FENCE AS SHOWN ON THE EPSC CONSTRUCTION SITE PLAN.

DATUM
 VERTICAL NAVD88
 HORIZONTAL NAD83(92)

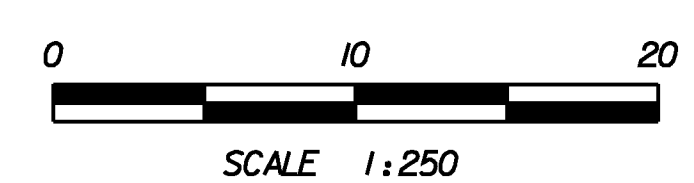

PROJECT NAME: DANVILLE	PLOT DATE: 1/18/2011
PROJECT NUMBER: F EGC 028-3(32)	DRAWN BY: STANTEC
FILE NAME: ...\\plotfiles\EPSC EST-01.prf	CHECKED BY: STANTEC
DESIGN SUPERVISOR: GARY SANTY	SHEET 129 OF 306
DESIGNED BY: STANTEC	
EPSC STABILIZATION PLAN EST-1	

STA 18+507.730 TO 18+600

1/18/2011 10:52:31 PM v:\1953\active\1953\0033_0192\highway\plotfiles\EPSC EST-01.prf