

AREA NUMBER	651.17 - SEED, WINTER RYE 651.25 - HAY MULCH	651.17 - SEED, WINTER RYE 653.20 - TEMPORARY EROSION MATTING
	AREAS (SM)	AREAS (SM)
1		405.9
2		299.3
3	366.5	
4	412.9	
5		757.9

649.51 - GEOTEXTILE FOR SILT FENCE

STA. 18+573.1 TO 18+600.0, RT
STA. 18+503.9 TO 18+514.4, RT

653.25 - TEMPORARY STONE CHECK DAM, TYPE I

STA. 18+531.5 TO 18+600.0, LT

653.35 - VEHICLE TRACKING PAD

STA. 18+512.1, LT

653.40 - INLET PROTECTION DEVICE, TYPE I

STA. 18+531.1, LT (FILTER FABRIC)

653.41 - INLET PROTECTION DEVICE, TYPE II

STA. 18+531.1, RT (FILTER FIBER)

STA. 18+570.8, LT (FILTER FIBER)

STA. 18+571.0, RT (FILTER FIBER)

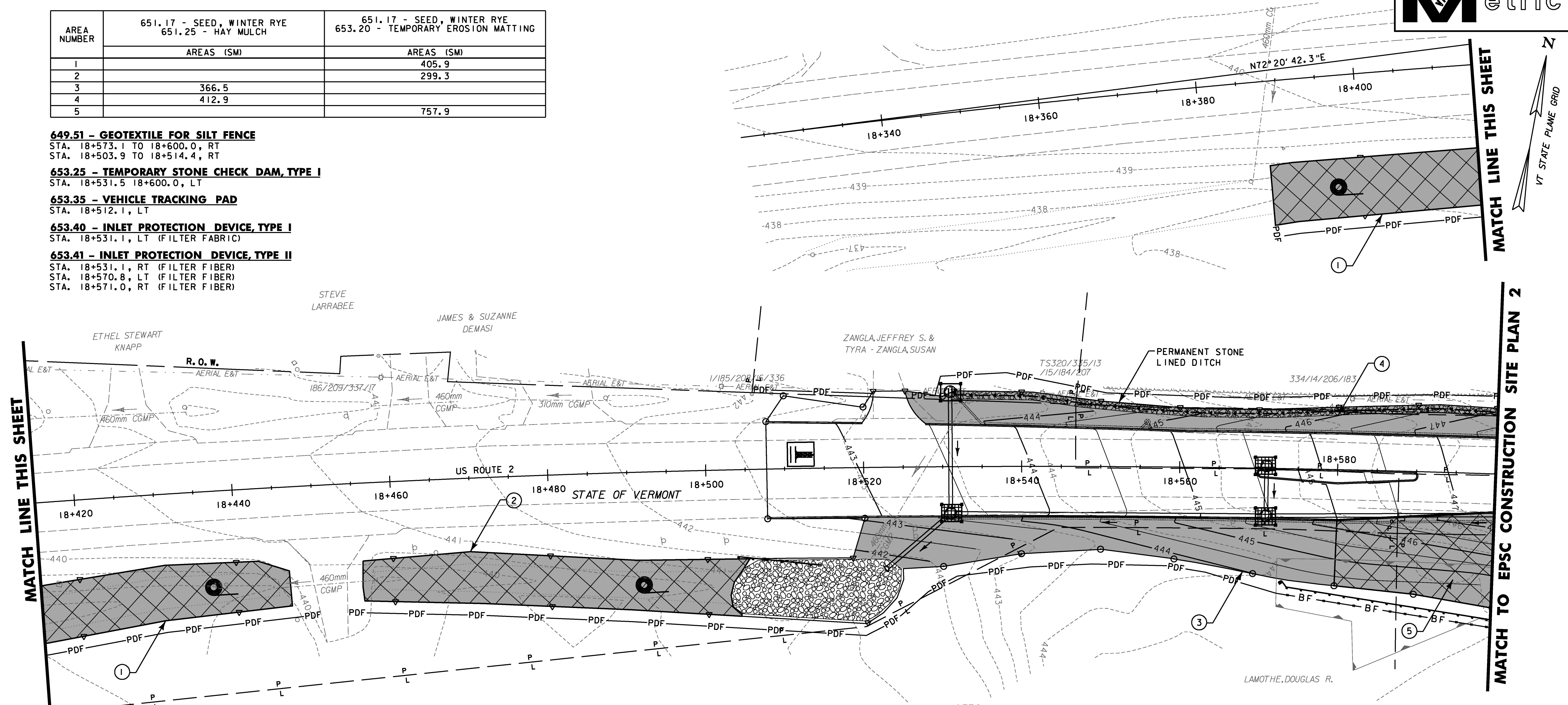

MATCH LINE THIS SHEET

MATCH LINE THIS SHEET

MATCH TO EPSC CONSTRUCTION SITE PLAN 2

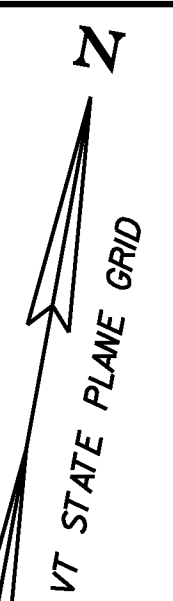

EPSC CONSTRUCTION PLAN EROSION CONTROL LEGEND

	PROJECT DEMARCATION FENCE
	BARRIER FENCE
	RIGHT OF WAY
	PROPERTY LINE
	LIMITS OF SOIL DISTURBANCE
	TEMPORARY SEEDING & MULCHING
	SILT FENCE
	FINISHED CONTOURS
	STABILIZED CONSTRUCTION ENTRANCE
	TEMPORARY CHECK DAMS

EPSC CONSTRUCTION PLAN LEGEND CONTINUED

	INLET PROTECTION-FILTER FABRIC (PAID AS ITEM 653.40)
	INLET PROTECTION-FILTER FIBER (PAID AS ITEM 653.41)
	ROLLED EROSION CONTROL PRODUCT (RECP) EROSION MATTING FOR SIDE SLOPES AND DITCHES
	STONE OUTLET PROTECTION
	CLASS III WETLAND BOUNDARY
	WATERSHED BOUNDARY
	SEDIMENT BASIN
	FILTER BAG

- NOTES:**
1. THESE PLANS SHOW A CONCEPTUAL EROSION CONTROL PLAN, THE CONTRACTOR MUST SUBMIT A TEMPORARY EROSION CONTROL PLAN FOR APPROVAL.
 2. TEMPORARY EROSION CONTROL MEASURES ARE CONCEPTUALLY SHOWN. THE CONTRACTOR MAY RELOCATE TEMPORARY MEASURES TO IMPROVE EROSION CONTROL WITH APPROVAL OF THE RESIDENT ENGINEER AND ON SITE COORDINATOR. SILT FENCE SHALL NOT BE INSTALLED ACROSS CONTOURS.
 3. THE CONTRACTOR SHALL USE OTHER TEMPORARY EROSION CONTROL MEASURES AS NECESSITATED BY THE SEQUENCE OF CONSTRUCTION OR AS DIRECTED BY THE RESIDENT ENGINEER AND ON SITE COORDINATOR.
 4. REFER TO TEMPORARY EROSION CONTROL DETAIL SHEETS FOR ADDITIONAL DETAILS.
 5. CONCURRENT EARTH DISTURBANCE SHALL BE LIMITED TO 2 HECTARE (5 ACRES) AT ANY ONE TIME.
 6. SEE EPSC NARRATIVE SHEET FOR TIME LIMITS ON DISTURBANCE, WINTER EPSC, INSPECTION AND STAGING/BORROW/WASTE AREA REQUIREMENTS.
 7. SEEDING AND EROSION MATTING AREAS CONTINUE TO NEXT SHEET WHERE AREAS ARE BROKEN BY MATCH LINES.

DATUM

VERTICAL	NAVD88
HORIZONTAL	NAD83(92)

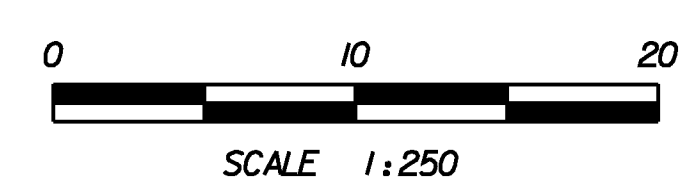

STA 18+507.730 TO 18+600

PROJECT NAME:	DANVILLE	PLOT DATE:	1/18/2011
PROJECT NUMBER:	F EGC 028-3(32)	DESIGN SUPERVISOR:	GARY SANTY
FILE NAME:	...\\plotfiles\EPSC ECN-01.pxf	DESIGNED BY:	STANTEC
		CHECKED BY:	STANTEC
		EPSC CONSTRUCTION PLAN ECN-1	SHEET 118 OF 306

1/18/2011 11:52:06 PM v:\1953\active\19530033_0192\highway\plotfiles\EPSC ECN-01.pxf