

SOIL CLASSIFICATION A
VERSHIRE-LOMBARD COMPLEX
 8-15% SLOPES, ROCKY
 "K" FACTOR = 0.37
 CLASSIFIED HIGHLY ERODIBLE

SOIL CLASSIFICATION B
PEACHAM MUCK
 0-3% SLOPES
 "K" FACTOR = 0.37 (ASSUMED)
 CLASSIFIED HIGHLY ERODIBLE

SOIL CLASSIFICATION A
VERSHIRE-LOMBARD COMPLEX
 8-15% SLOPES, ROCKY
 "K" FACTOR = 0.37
 CLASSIFIED HIGHLY ERODIBLE

MATCH TO EPSC PRE-CONSTRUCTION SITE PLAN 5

MATCH TO EPSC PRE-CONSTRUCTION SITE PLAN 8

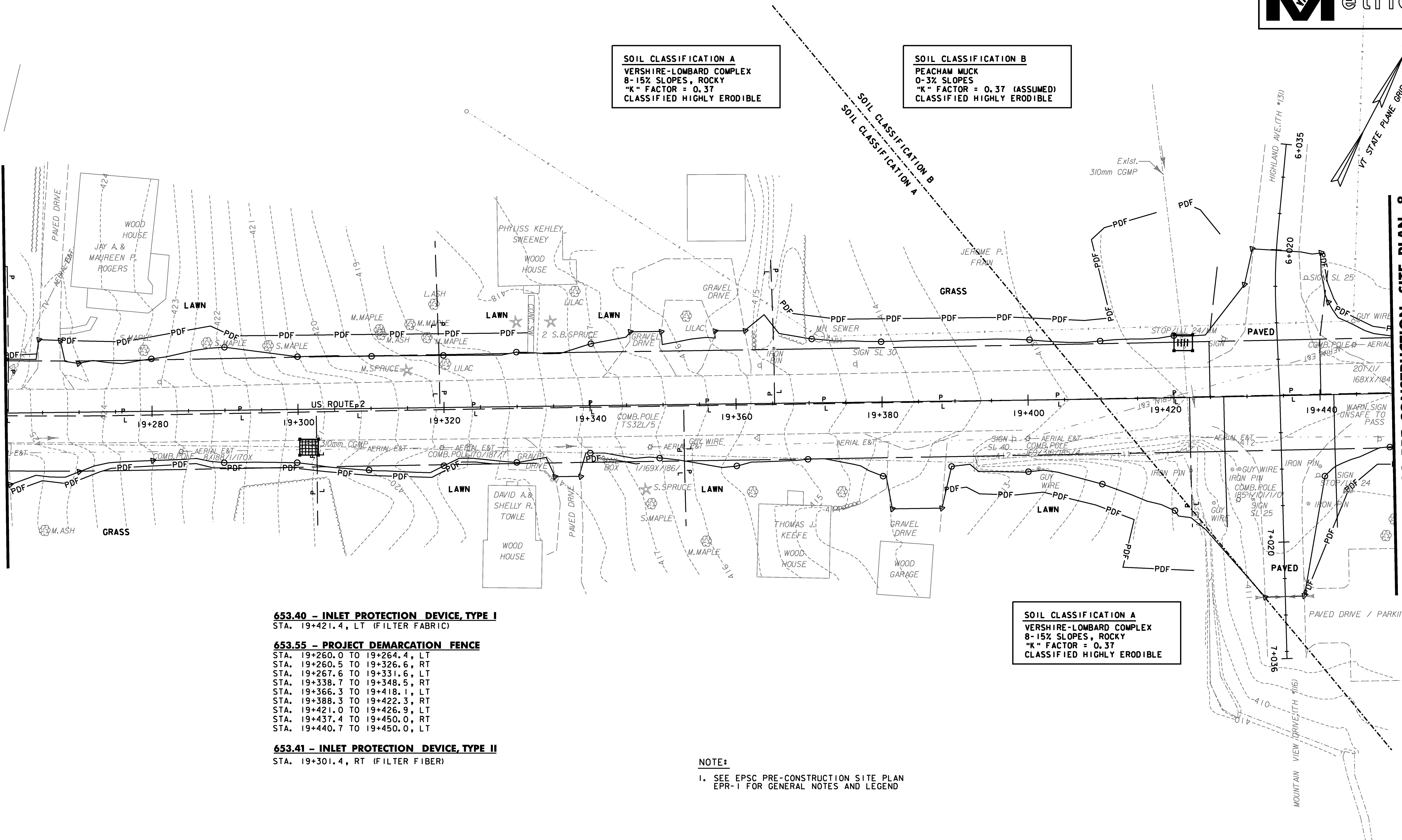

- 653.40 - INLET PROTECTION DEVICE, TYPE I**
 STA. 19+421.4, LT (FILTER FABRIC)
- 653.55 - PROJECT DEMARCATION FENCE**
 STA. 19+260.0 TO 19+264.4, LT
 STA. 19+260.5 TO 19+326.6, RT
 STA. 19+267.6 TO 19+331.6, LT
 STA. 19+338.7 TO 19+348.5, RT
 STA. 19+366.3 TO 19+418.1, LT
 STA. 19+388.3 TO 19+422.3, RT
 STA. 19+421.0 TO 19+426.9, LT
 STA. 19+437.4 TO 19+450.0, RT
 STA. 19+440.7 TO 19+450.0, LT
- 653.41 - INLET PROTECTION DEVICE, TYPE II**
 STA. 19+301.4, RT (FILTER FIBER)

NOTE:
 1. SEE EPSC PRE-CONSTRUCTION SITE PLAN
 EPR-1 FOR GENERAL NOTES AND LEGEND

DATUM
 VERTICAL NAVD88
 HORIZONTAL NAD83(92)

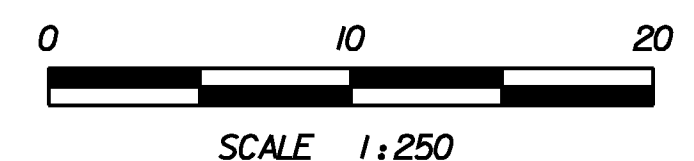

PROJECT NAME: DANVILLE
 PROJECT NUMBER: F EGC 028-3(32)
 FILE NAME: ...\\plotfiles\EPSC EPR-07.prf PLOT DATE: 1/18/2011
 DESIGN SUPERVISOR: GARY SANTY DRAWN BY: STANTEC
 DESIGNED BY: STANTEC CHECKED BY: STANTEC
EPSC PRE-CONSTRUCTION PLAN EPR-7 SHEET 113 OF 306

STA 19+260 TO 19+450

1/18/2011 10:51:58 PM v:\1953\active\19530033_0052\highway\plotfiles\EPSC EPR-07.prf