



DRAINAGE STRUCTURES

STRUCTURE NO.	CONSTRUCTION @ STATION	COMMENTS
CB314	19+781.0, RT	1.5m Ø PRCCB W/B GRATE
MH315	19+794.1, RT	1.5m Ø PRCDMH W/COVER
DMH311	19+835.0, RT.	POND OUTLET CONTROL STRUCTURE, SEE NOTE 1
CB300C	19+763.0, LT.	PRCCB W/A GRATE
CB300D	19+794.6, LT.	PRCCB W/A GRATE
CB300E	19+764.7, LT.	PRCCB W/A GRATE
CB300F	19+796.2, LT.	PRCCB W/A GRATE

STORMWATER MANAGEMENT

STRUCTURE #	LOCATION	COMMENTS
312	19+787-19+844, RT.	CONSTRUCT STORMWATER MANAGEMENT POND AND VEGETATED TREATMENT SWALE 2-A. SEE SWM PLANS.
317	19+858-19+979, RT.	CONSTRUCT VEGETATED TREATMENT SWALE 2-B. SEE SWM PLANS.

DRAINAGE NOTES

311 CONST. @ 19+835.0 TO 19+865.9 RT. EXTENDED DETENTION POND OUTLET STRUCTURE (ITEM 604.21) NEW 300mm x 9m DUCTILE IRON POND DRAIN WITH 300 mm GATE VALVE AND ELBOW NEW 200mm x 9m DUCTILE IRON WITH 2-200mm ELBOWS NEW 750mm x 32.0m PIPE OPTION 2 SEE SWM-2 FOR DETAILS. INSTALL END SECTION AT OUTLET

313 CONST. @ 19+846.0 TO 19+866.0 RT. NEW 900mm x 22.0m PIPE OPTION 2 CONST. STONE FILL TYPE II @ INLET AND OUTLET CONST. STRAIGHT CONC. HEADWALL @ INLET (REF D-33) INSTALL END SECTION AT OUTLET

314 CONST. @ 19+781.0 TO 19+794.0 RT. NEW 900mm x 68.9m PIPE OPTION 2

315 CONST. @ 19+794.0 TO 19+808.1 RT. NEW 900mm x 13.5m PIPE OPTION 2 INSTALL END SECTION AT OUTLET

316 CONST. @ 19+844.1 TO 19+858.0 RT. NEW 450mm x 13.2m PIPE OPTION 3 INSTALL END SECTIONS AT INLET AND OUTLET

300C CONST. @ 19+763.0 TO 19+794.6 LT. NEW 600mm x 30.4m PIPE OPTION 3

300D CONST. @ 19+764.7 TO 19+763.0 LT. NEW 300mm x 5.0m PIPE OPTION 3

300E CONST. @ 19+796.2 TO 19+794.6 LT. NEW 300mm x 5.0m PIPE OPTION 3

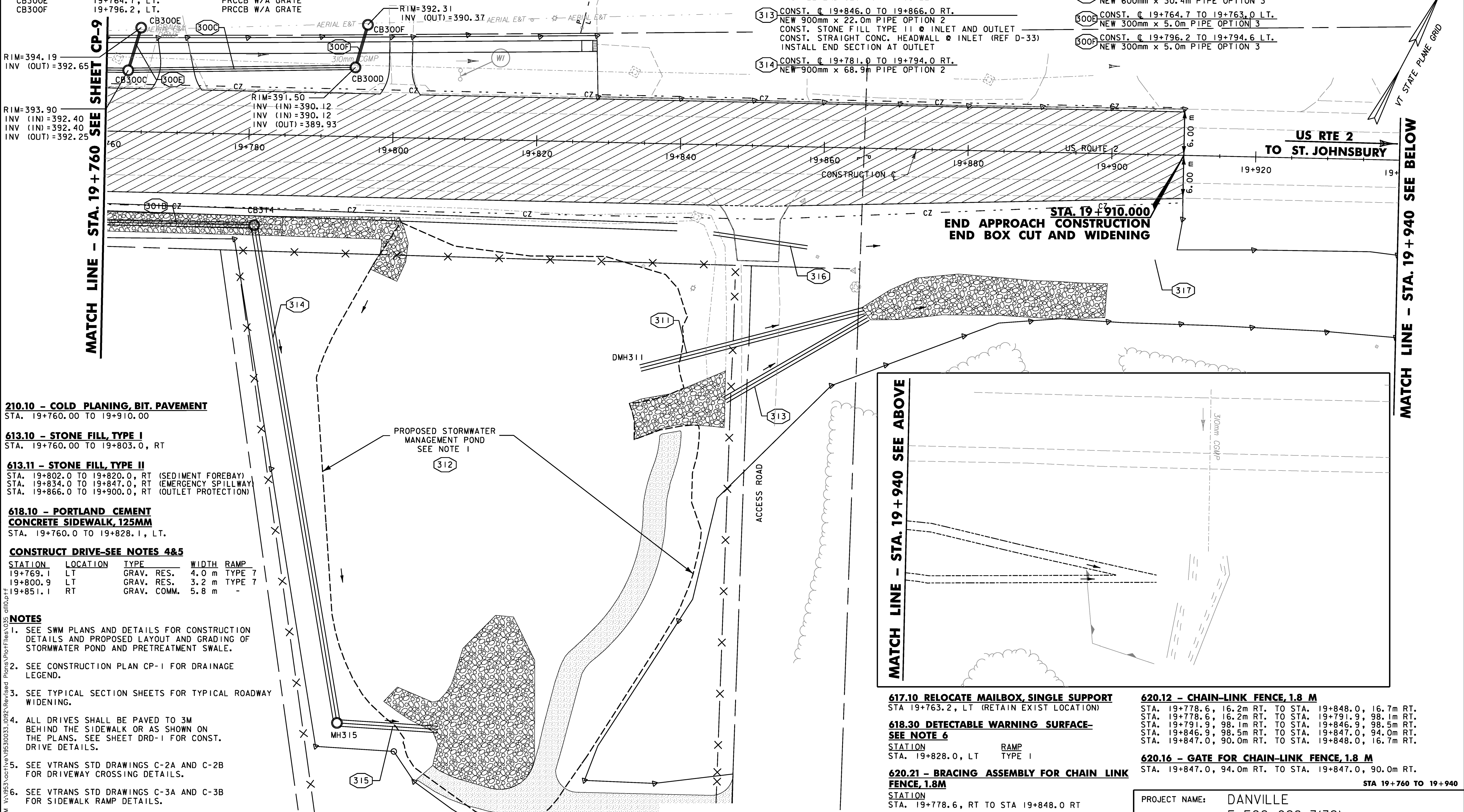

- 210.10 - COLD PLANING, BIT. PAVEMENT**
STA. 19+760.00 TO 19+910.00
- 613.10 - STONE FILL, TYPE I**
STA. 19+760.00 TO 19+803.0, RT
- 613.11 - STONE FILL, TYPE II**
STA. 19+802.0 TO 19+820.0, RT (SEDIMENT FOREBAY)
STA. 19+834.0 TO 19+847.0, RT (EMERGENCY SPILLWAY)
STA. 19+866.0 TO 19+900.0, RT (OUTLET PROTECTION)
- 618.10 - PORTLAND CEMENT CONCRETE SIDEWALK, 125MM**
STA. 19+760.0 TO 19+828.1, LT.
- CONSTRUCT DRIVE-SEE NOTES 4&5**
- | STATION | LOCATION | TYPE | WIDTH | RAMP |
|----------|----------|-------------|-------|--------|
| 19+769.1 | LT | GRAV. RES. | 4.0 m | TYPE 7 |
| 19+800.9 | LT | GRAV. RES. | 3.2 m | TYPE 7 |
| 19+851.1 | RT | GRAV. COMM. | 5.8 m | - |

- NOTES**
- SEE SWM PLANS AND DETAILS FOR CONSTRUCTION DETAILS AND PROPOSED LAYOUT AND GRADING OF STORMWATER POND AND PRETREATMENT SWALE.
 - SEE CONSTRUCTION PLAN CP-1 FOR DRAINAGE LEGEND.
 - SEE TYPICAL SECTION SHEETS FOR TYPICAL ROADWAY WIDENING.
 - ALL DRIVES SHALL BE PAVED TO 3M BEHIND THE SIDEWALK OR AS SHOWN ON THE PLANS. SEE SHEET DRD-1 FOR CONST. DRIVE DETAILS.
 - SEE VTRANS STD DRAWINGS C-2A AND C-2B FOR DRIVEWAY CROSSING DETAILS.
 - SEE VTRANS STD DRAWINGS C-3A AND C-3B FOR SIDEWALK RAMP DETAILS.

DATUM

VERTICAL	NAVD88
HORIZONTAL	NAD83(92)

REPLACEMENT SHEETS
ISSUED 10/05/11

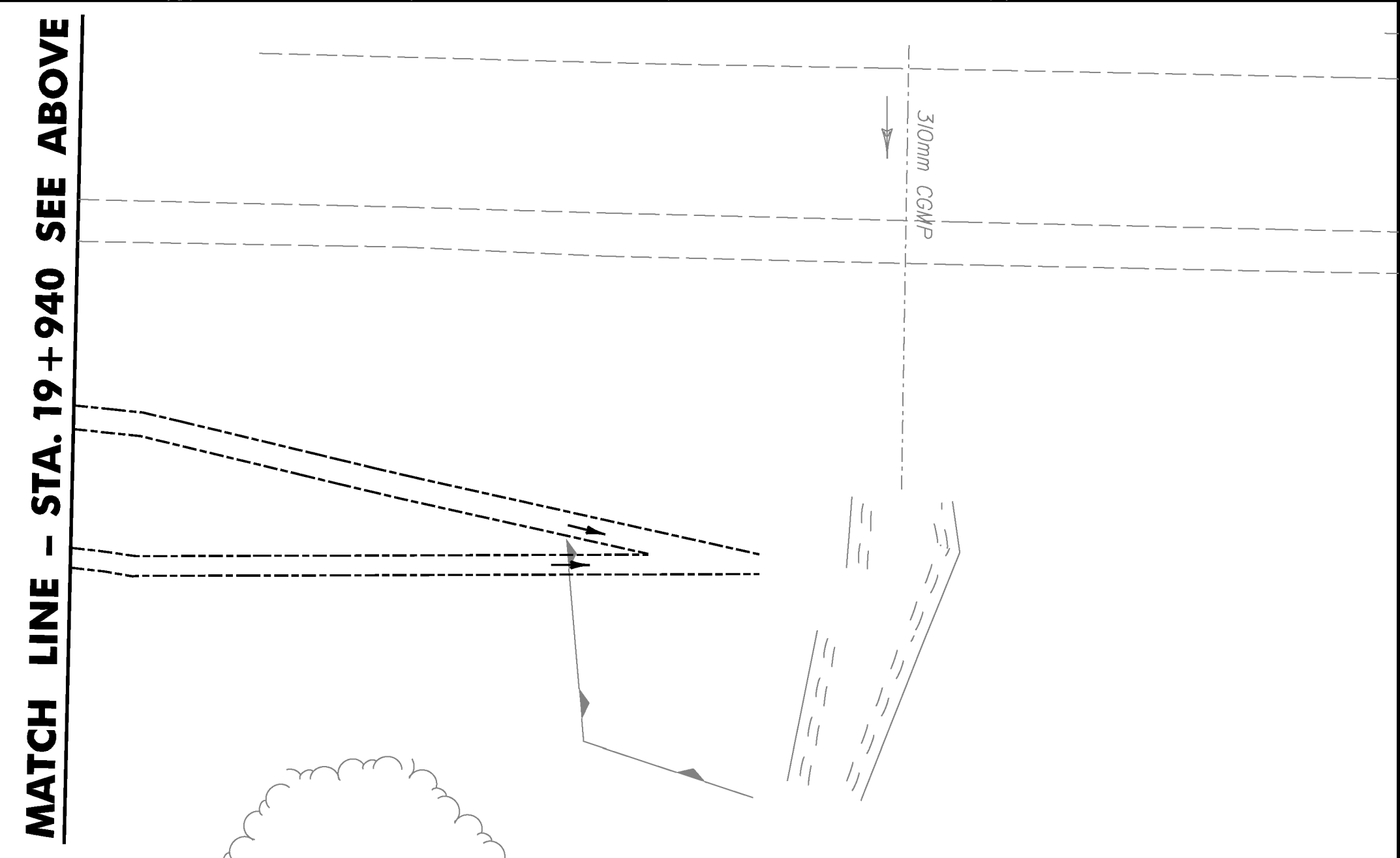

- 617.10 RELOCATE MAILBOX, SINGLE SUPPORT**
STA 19+763.2, LT (RETAIN EXIST LOCATION)
- 618.30 DETECTABLE WARNING SURFACE-SEE NOTE 6**
- | STATION | RAMP TYPE |
|--------------|-----------|
| 19+828.0, LT | TYPE I |
- 620.21 - BRACING ASSEMBLY FOR CHAIN LINK FENCE, 1.8M**
- | STATION | LOCATION |
|--------------|--------------------|
| 19+778.6, RT | TO STA 19+848.0 RT |
- NOTE: SEE SUBSECTION 620.04 FOR LOCATIONS
- 620.12 - CHAIN-LINK FENCE, 1.8 M**
- | STATION | LOCATION |
|---------------------|-----------------------------|
| 19+778.6, 16.2m RT. | TO STA. 19+848.0, 16.7m RT. |
| 19+778.6, 16.2m RT. | TO STA. 19+791.9, 98.1m RT. |
| 19+791.9, 98.1m RT. | TO STA. 19+846.9, 98.5m RT. |
| 19+846.9, 98.5m RT. | TO STA. 19+847.0, 94.0m RT. |
| 19+847.0, 90.0m RT. | TO STA. 19+848.0, 16.7m RT. |
- 620.16 - GATE FOR CHAIN-LINK FENCE, 1.8 M**
- | STATION | LOCATION |
|---------------------|-----------------------------|
| 19+847.0, 94.0m RT. | TO STA. 19+847.0, 90.0m RT. |

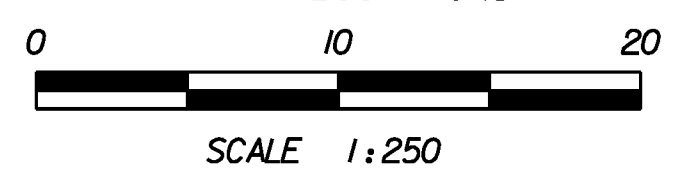

PROJECT NAME: DANVILLE
PROJECT NUMBER: F EGC 028-3(32)

FILE NAME: ...PlotFiles\035 all0.pptf
DESIGN SUPERVISOR: GARY SANTY
DESIGNED BY: STANTEC
CONSTRUCTION PLAN CP-10

PLOT DATE: 10/4/2011
DRAWN BY: STANTEC
CHECKED BY: STANTEC
SHEET 72 OF 306

10/4/2011 14:27 PM V:\B3\cc\Hve\9530033_0052\Reviewed Plans\PlotFiles\035 all0.pptf