

616.21 - VERTICAL GRANITE CURB
 STA. 19+260.0 TO 19+262.1, LT
 STA. 19+260.2 TO 19+332.0, RT
 STA. 19+270.1 TO 19+343.2, LT
 STA. 19+341.0 TO 19+379.0, RT
 STA. 19+363.7 TO 19+424.5, LT
 STA. 19+390.6 TO 19+428.6, RT
 STA. 19+440.1 TO 19+450.0, RT
 STA. 19+447.5 TO 19+450.0, LT

618.10 - PORTLAND CEMENT CONCRETE SIDEWALK, 125MM
 STA. 19+260.0 TO 19+343.2, LT
 STA. 19+331.5 TO 19+332.3, LT, INDIV. WALK
 STA. 19+352.2 TO 19+354.9, LT
 STA. 19+363.7 TO 19+427.7, LT
 STA. 19+443.3 TO 19+450.0, LT

618.30 - DETECTABLE WARNING SURFACES - SEE NOTE 6
 STATION RAMP
 STA. 19+425.7, LT TYPE I
 STA. 19+445.9, LT TYPE I

900.675 SPECIAL PROVISION (PRECAST CONCRETE GRAVITY RETAINING WALL) SEE NOTE 4
 STA. 19+290.8 TO 19+320.2, 6.2m LT
617.10 RELOCATE MAIL BOX SINGLE SUPPORT
 STA. 19+342.0, RT.

613.11 - STONE FILL, TYPE II - SEE NOTE 3
 STA. 19+421.5, RT

CONSTRUCT DRIVE-SEE NOTES 2 & 5

STATION	LOCATION	TYPE	WIDTH	RAMP
19+266.1	LT	BIT. RES.	3.0 m	-
19+336.6	RT	BIT. RES.	4.2 m	TYPE 2
19+347.4	LT	GRAV.COM.	4.3 m	TYPE 2, -
19+359.3	LT	GRAV.COM.	4.1 m	TYPE 2
19+384.8	RT	GRAV.RES.	7.2 m	-

NOTE:

- SEE CONSTRUCTION PLAN CP-1 FOR DRAINAGE LEGEND.
- ALL DRIVES SHALL BE PAVED TO 3M BEHIND THE SIDEWALK OR AS SHOWN ON THE PLANS. SEE SHEET DRD-1 FOR CONST. DRIVE DETAILS.
- SEE DRAINAGE DETAIL SHEET DD-1 FOR STORM DRAIN OUTLET PROTECTION DETAIL AND DIMENSIONS.
- SEE STRUCTURAL DETAILS SD-1 SHEET FOR PRECAST CONCRETE GRAVITY RETAINING WALL DETAILS.
- SEE VTRANS STD DRAWINGS C-2A AND C-2B FOR DRIVEWAY CROSSING DETAILS.
- SEE VTRANS STD DRAWINGS C-3A AND C-3B FOR SIDEWALK RAMP DETAILS.
- AN ESTIMATED QUANTITY FOR ADJUSTING ELEVATION OF DRAINAGE CATCH BASINS AND MANHOLES HAS BEEN INCLUDED. THIS PAY ITEM SHALL ONLY BE USED FOR CB'S & MH'S INSTALLED IN AREAS THAT ARE TEMPORARILY PAVED TO MAINTAIN VEHICULAR TRAFFIC. ADJUSTMENT OF CB'S & MH'S IN LAWN AREAS OR OTHER AREAS THAT ARE OUTSIDE OF VEHICULAR TRAFFIC WILL BE PAID INCIDENTAL TO CATCH BASIN AND MANHOLE ITEMS.

**HIGHLAND AVE STA 6+027.500
 END APPROACH CONSTRUCTION**

**HIGHLAND AVE STA 6+019.500
 BEGIN APPROACH CONSTRUCTION**

LOW POINT
 STA=6+013.21
 ELEV=412.08
**US. RTE 2 STA 19+434.495 =
 HIGHLAND AVE STA 6+000.000**

MATCH LINE - STA. 19+260 SEE SHEET CP-5

MATCH LINE - STA. 19+450 SEE SHEET CP-8

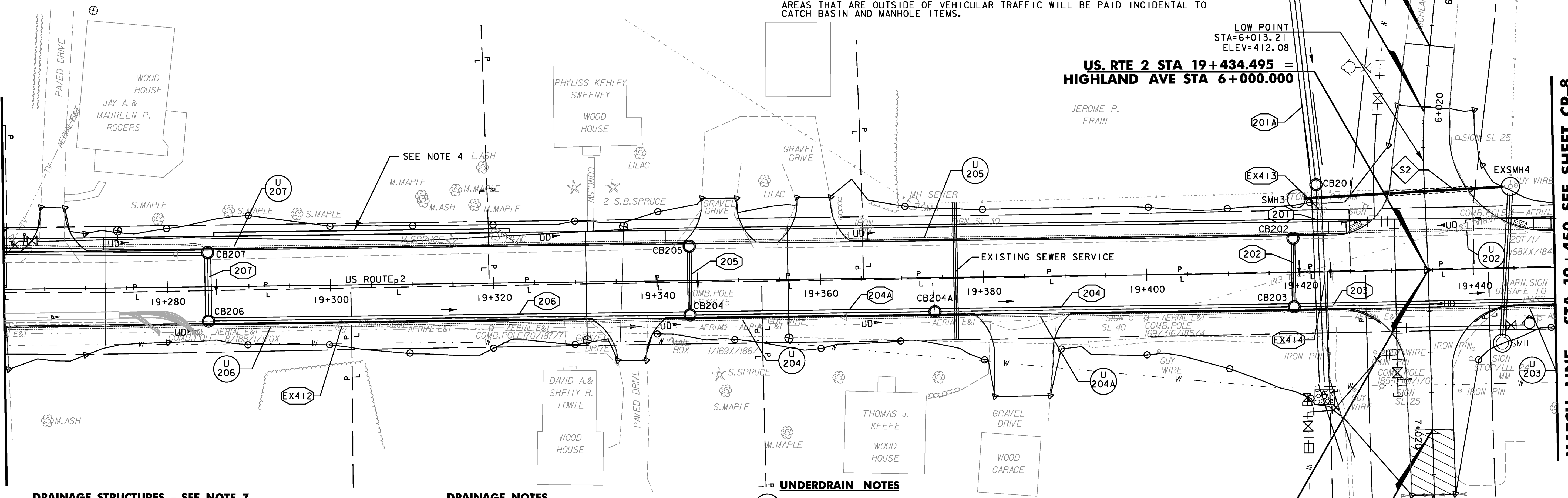

DRAINAGE STRUCTURES - SEE NOTE 7

STRUCTURE NO.	CONSTRUCTION @ STATION	COMMENTS
CB201	19+421.5, LT	1.8 ID PRCCB W/E GRATE
CB202	19+418.0, LT	PRCCB W/E GRATE
CB203	19+418.0, RT	1.5 ID PRCCB W/E GRATE
CB204	19+344.0, RT	1.5 ID PRCCB W/E GRATE
CB204A	19+374.0, RT	1.5 ID PRCCB W/E GRATE
CB205	19+344.0, LT	PRCCB W/E GRATE
CB206	19+285.0, RT	1.5 ID PRCCB W/E GRATE
CB207	19+285.0, LT	1.5 ID PRCCB W/E GRATE
SMH3	19+418.5, LT	NEW SEWER MH
EXSMH4	19+444.8, LT	INVERT IN = 410.78 (MATCH EXISTING INVERT ELEVATION) INVERT OUT = 409.44 REMOVE OUTSIDE DROP INVERT IN = 409.31

SEWER NOTES

S2 CONST. @ 19+418.5 LT. TO 19+444.8 LT.
 NEW 200mm x 26.0m PVC SEWER @ 0.50% W/ 600mm SLEEVE
 INVERT IN = 409.44
 INVERT OUT = 409.31

DRAINAGE NOTES

- 201 CONST. @ 19+421.5 LT. TO RT.
NEW 1200mm x 23.6m PIPE OPTION 4
CONST. 1.5m WIDE x 10m OUTLET DITCH
CONST. STONE FILL, TYPE II AT OUTLET, SEE NOTE 3
INSTALL END SECTION
- 201A CONST. @ 19+421.5 LT.
NEW 1200mm x 31.8m PIPE OPTION 4
REPLACE EXISTING 600mm PIPE AND HEADWALL
- 202 CONST. @ 19+418.0 LT. TO RT.
NEW 450mm x 7.2m PIPE OPTION 2
- 203 CONST. @ 19+418.0 RT. TO 19+463.0 RT.
NEW 750mm x 43.8m PIPE OPTION 3
- 204 CONST. @ 19+374.0 RT. TO 19+418.0 RT.
NEW 750mm x 42.8m PIPE OPTION 2
- 204A CONST. @ 19+344.0 RT. TO 19+374.0 RT.
NEW 750mm x 28.8m PIPE OPTION 2
- 205 CONST. @ 19+344.0 LT. TO RT.
NEW 450mm x 7.2m PIPE OPTION 2
- 206 CONST. @ 19+285.0 TO 19+344.0 RT.
NEW 750mm x 57.8m PIPE OPTION 2
- 207 CONST. @ 19+285.0 LT. TO RT.
NEW 750mm x 7.2m PIPE OPTION 2
- EX412 CONST. @ 19+301.3 RT. TO 19+392.4 RT.
REMOVE EXISTING 310 CGMP & INLET STRUCTURE
- EX413 CONST. @ 19+421.4 LT.
REMOVE INLET STRUCTURE & EXISTING 310 CGMP TO 22m LEFT
- EX414 CONST. @ 19+421.4 LT.
REMOVE EXISTING 600 RCP

UNDERDRAIN NOTES

- U 206 CONST. @ 19+285.0 TO 19+344.0 RT.
NEW 150mm x 59.0m UND. W/URBAN
FLUSHING BASIN IN STRUCTURE #206
- U 207 CONST. @ 19+285.0 TO 19+344.0 LT.
NEW 150mm x 59.0m UND. W/URBAN
FLUSHING BASIN IN STRUCTURE #207
TIE IN 102mm RETAINING WALL
DRAINAGE PIPE TO UNDERDRAIN
- U 204 CONST. @ 19+344.0 TO 19+374.0 RT.
NEW 150mm x 30.0m UND. W/URBAN
FLUSHING BASIN IN STRUCTURE #204
- U 205 CONST. @ 19+344.0 TO 19+418.0 LT.
NEW 150mm x 74.0m UND. W/URBAN
FLUSHING BASIN IN STRUCTURE #205
- U 203 CONST. @ 19+418.0 TO 19+463.0 RT.
NEW 150mm x 45.0m UND. W/URBAN
FLUSHING BASIN IN STRUCTURE #203
- U 202 CONST. @ 19+418.0 TO 19+463.0 LT.
NEW 150mm x 45.0m UND. W/URBAN
FLUSHING BASIN IN STRUCTURE #202
- U 204A CONST. @ 19+374.0 TO 19+418.0 RT.
NEW 150mm x 44.0m UND. W/URBAN
FLUSHING BASIN IN STRUCTURE #204A

**US. RTE 2 STA 19+434.495 =
 MOUNTAIN VIEW DRIVE STA 6+999.932**

**MOUNTAIN VIEW DRIVE STA 7+019.500
 BEGIN APPROACH CONSTRUCTION**

**MOUNTAIN VIEW DRIVE STA 7+027.500
 END APPROACH CONSTRUCTION**

**REPLACEMENT SHEETS
 ISSUED 02/24/2012**

DATUM

VERTICAL	NAVD88
HORIZONTAL	NAD83(92)

**210.10 - COLD PLANING,
 BITUMINOUS PAVEMENT**
 STA. 7+019.50 TO 7+027.50

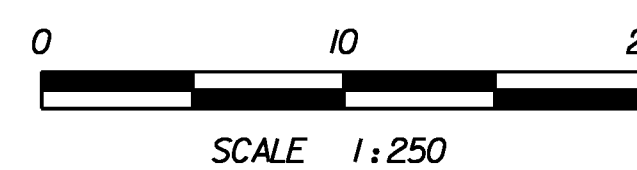

PROJECT NAME: DANVILLE
 PROJECT NUMBER: F EGC 028-3(32)
 FILE NAME: ...PlotFiles\032 all07.prf
 DESIGN SUPERVISOR: GARY SANTY
 DESIGNED BY: STANTEC
 CONSTRUCTION PLAN CP-7

STA 19+260 TO 19+450

PLAT DATE: 2/24/2012
 DRAWN BY: STANTEC
 CHECKED BY: STANTEC
 SHEET 69 OF 306