

616.21 - VERTICAL GRANITE CURB
 STA. 18+930.0 TO 18+956.0, LT
 STA. 18+930.0 TO 18+960.5, RT
 STA. 18+930.0 TO 18+934.5, LT & RT., ISLAND
 STA. 18+960.8 TO 18+990.9, LT
 STA. 18+963.3 TO 18+979.0, RT
 STA. 18+982.5 TO 19+003.4, RT
 STA. 18+998.5 TO 19+052.3, LT
 STA. 19+010.6 TO 19+015.5, RT
 STA. 19+019.1 TO 19+026.9, RT
 STA. 19+034.1 TO 19+042.5, RT
 STA. 19+054.5 TO 19+060.4, RT
 STA. 19+059.5 TO 19+070.0, LT
 STA. 19+067.2 TO 19+068.9, RT P. LOT
 STA. 19+067.6 TO 19+070.0, RT
 STA. 19+069.3 TO 19+070.0, RT P. LOT

618.10 - PORTLAND CEMENT CONCRETE SIDEWALK, 125MM
 STA. 18+930.0 TO 18+990.9, LT
 STA. 18+930.0 TO 19+015.3, RT
 STA. 18+964.8 TO 18+965.7, LT, INDIV. WALK
 STA. 18+998.5 TO 19+052.3, LT
 STA. 19+019.1 TO 19+026.9, RT
 STA. 19+034.1 TO 19+042.4, RT
 STA. 19+054.4 TO 19+060.4, RT
 STA. 19+059.5 TO 19+070.0, RT
 STA. 19+067.3 TO 19+070.0, RT

618.11 - PORTLAND CEMENT CONCRETE SIDEWALK, 200MM
 STA. 18+990.9 TO 18+998.5, LT
 STA. 19+015.3 TO 19+019.1, RT
 STA. 19+026.9 TO 19+034.1, RT
 STA. 19+042.7 TO 19+054.4, RT
 STA. 19+052.3 TO 19+059.5, LT
 STA. 19+060.4 TO 19+067.3, RT

617.10 RELOCATE MAIL BOX, SINGLE SUPPORT
 STA. 19+014.0, RT.

620.50 REMOVING AND RESETTING FENCE
 STA. 18+943.6 TO 18+956.5 RT (RESET TO ORIGINAL LOCATION)

900.645 - SPECIAL PROVISION (REMOVE AND SALVAGE WOODEN RETAINING WALL)
 STA. 18+958.78 TO 18+959.20, RT 2.0m WIDE

900.645 - SPECIAL PROVISION (REMOVE AND SALVAGE CONCRETE WHEEL STOPS)
 STA. 19+030.0 TO 19+050.0 LT

900.675 - SPECIAL PROVISION (STAMPED CONCRETE ISLAND, 125mm)
 STA. 18+930.0 TO 18+934.5, LT & RT

CONSTRUCT DRIVE - SEE NOTES 2&3

STATION	LOCATION	TYPE	WIDTH	RAMP
18+958.4	LT	GRAV. RES.	4.9 m	TYPE 2
18+961.8	RT	BIT. RES.	2.7 m	TYPE 2
18+980.8	RT	BIT. RES.	3.6 m	TYPE 2
18+994.7	LT	GRAV. COM.	7.6 m	TYPE 2
19+007.0	RT	GRAV. RES.	7.2 m	TYPE 7
19+017.3	RT	BIT. COM.	3.6 m	TYPE 7
19+030.5	RT	BIT. COM.	12.0 m	TYPE 7
19+048.4	RT	BIT. COM.	7.2 m	TYPE 7
19+055.8	LT	GRAV. COM.	7.2 m	TYPE 2
19+063.8	RT	BIT. COM.	6.9 m	TYPE 2

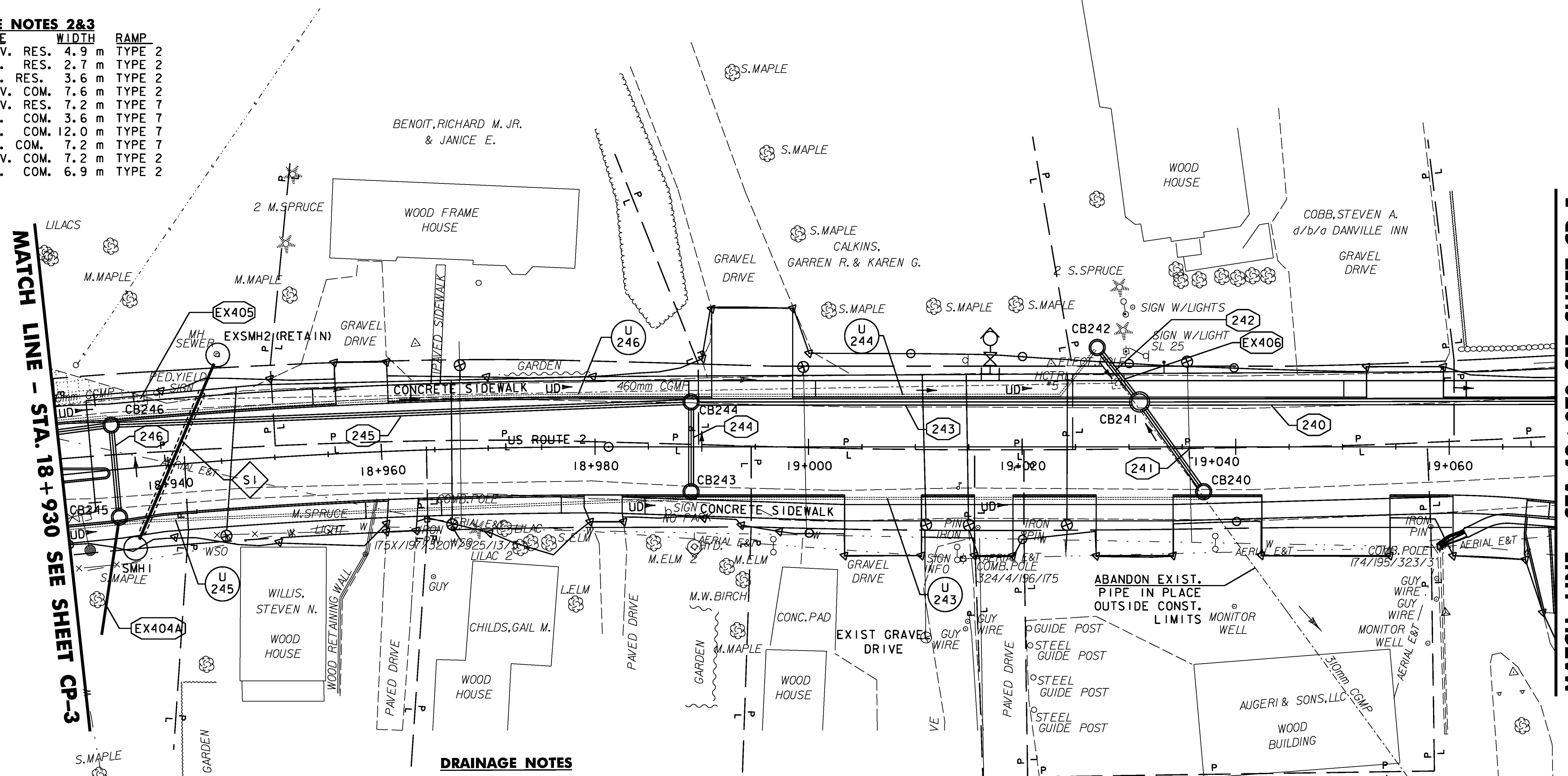

DRAINAGE STRUCTURES - SEE NOTE 5

STRUCTURE NO.	CONSTRUCTION @ STATION	COMMENTS
CB240	19+037.0, RT.	PRCCB W/E GRATE, NO SUMP
CB241	19+031.0, LT.	1.8M PRCCB W/E GRATE, 6" SUMP
CB242	19+027.0, LT.	PRCCB W/D GRATE, NO SUMP
CB243	18+989.0, RT.	PRCCB W/E GRATE, NO SUMP
CB244	18+989.0, LT.	PRCCB W/E GRATE, 6" SUMP
CB245	18+935.0, RT.	PRCCB W/E GRATE, NO SUMP
CB246	18+935.0, LT.	PRCCB W/E GRATE, 6" SUMP
SMH1	18+936.3, RT.	NEW SEWER MANHOLE PER D-22 W/ OUTSIDE DROP, RIM = 441.200 INVERT @ DROP = 437.753 INVERT @ CLEANOUT = 440.097

SEWER NOTES

S1 CONST. @ 18+936.3 RT. TO 18+945.4 LT. NEW 200mm x 17.9m PVC SEWER @ 0.40% W/ 450mm SLEEVE INVERT IN = 437.677 INVERT OUT = 437.605 (MATCH EXISTING INVERT ELEVATION AT EXSMH2)

- DRAINAGE NOTES**
- 240 CONST. @ 19+031.0 TO 19+085.0 LT. NEW 600mm x 48.7m PIPE OPTION 1
 - 241 CONST. @ 19+031.0 LT. TO 19+037.0 RT. NEW 450mm x 7.4m PIPE OPTION 2
 - 242 CONST. @ 19+027.0 TO 19+031.0 LT. NEW 450mm x 8.3m PIPE OPTION 3
 - 243 CONST. @ 18+989.0 TO 19+031.0 LT. NEW 600mm x 44.8m PIPE OPTION 1
 - 244 CONST. @ 18+989.0 RT. TO LT. NEW 450mm x 7.2m PIPE OPTION 2
 - 245 CONST. @ 18+935.0 TO 18+989.0 LT. NEW 450mm x 53.2m PIPE OPTION 1
 - 246 CONST. @ 18+935.0 RT. TO LT. NEW 450mm x 7.5m PIPE OPTION 2
 - EX404A CONST. @ 18+935, RT. TIE EXISTING 150mm PVC ROOF DRAIN INTO CB245 (CONTRACTOR TO VERIFY DRAIN LOCATION AND INVERT ELEVATION)
 - EX405 CONST. @ 18+937.9 TO 19+029.0 LT. REMOVE EXISTING 460 mm CGMP & INLET STRUCTURE
 - EX406 CONST. @ 19+029.0 LT. TO 19+039.0 RT. REMOVE EXISTING 310 mm CGMP & INLET STRUCTURE

- UNDERDRAIN NOTES**
- U 245 CONST. @ 18+935.0 TO 18+989.0 RT. NEW 150mm x 53.6m UND. W/URBAN FLUSHING BASIN IN STRUCTURE #245
 - U 246 CONST. @ 18+935.0 TO 18+989.0 LT. NEW 150mm x 54.3m UND. W/URBAN FLUSHING BASIN IN STRUCTURE #246, CONST. PIPE @ -0.50% GRADE @ 18+984.5 - 18+989.0 LT
 - U 244 CONST. @ 18+989.0 TO 19+035.0 LT. NEW 150mm x 45.6m UND. W/URBAN FLUSHING BASIN IN STRUCTURE #244
 - U 243 CONST. @ 18+989.0 TO 19+037.0 RT. NEW 150mm x 48.0m UND. W/URBAN FLUSHING BASIN IN STRUCTURE #243, CONST. PIPE @ -0.50% GRADE @ 19+031.5 - 19+037.0 RT
- NO UNDERDRAIN CONSTRUCTED BETWEEN CB241 AND 240B AND CB240 AND CB240A DUE TO CONTAMINATED SOILS.

- NOTES:**
- SEE CONSTRUCTION PLAN CP-1 FOR DRAINAGE LEGEND.
 - ALL DRIVES SHALL BE PAVED TO 3M BEHIND THE SIDEWALK, OR AS SHOWN ON THE PLANS. SEE SHEET DRD-1 FOR CONST. DRIVE DETAILS.
 - SEE VTRANS STD DRAWINGS C-2A AND C-2B FOR DRIVEWAY CROSSING DETAILS.
 - SEE VTRANS STD DRAWINGS C-3A AND C-3B FOR SIDEWALK RAMP DETAILS.
 - AN ESTIMATED QUANTITY FOR ADJUSTING ELEVATION OF DRAINAGE CATCH BASINS AND MANHOLES HAS BEEN INCLUDED. THIS PAY ITEM SHALL ONLY BE USED FOR CB'S & MH'S INSTALLED IN AREAS THAT ARE TEMPORARILY PAVED TO MAINTAIN VEHICULAR TRAFFIC. ADJUSTMENT OF CB'S & MH'S IN LAWN AREAS OR OTHER AREAS THAT ARE OUTSIDE OF VEHICULAR TRAFFIC WILL BE PAID INCIDENTAL TO CATCH BASIN AND MANHOLE ITEMS.

**REPLACEMENT SHEETS
ISSUED 02/24/2012**

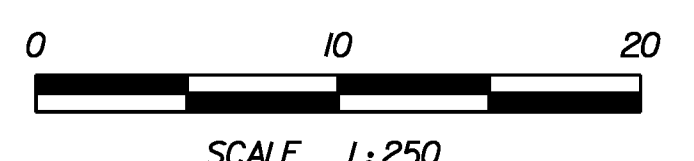

PROJECT NAME: DANVILLE	PROJECT NUMBER: F EGC 028-3(32)
FILE NAME: ...PlotFiles\028 all04.pft	PLLOT DATE: 2/24/2012
DESIGN SUPERVISOR: GARY SANTY	DRAWN BY: STANTEC
DESIGNED BY: STANTEC	CHECKED BY: STANTEC
CONSTRUCTION PLAN CP-4	SHEET 65 OF 306

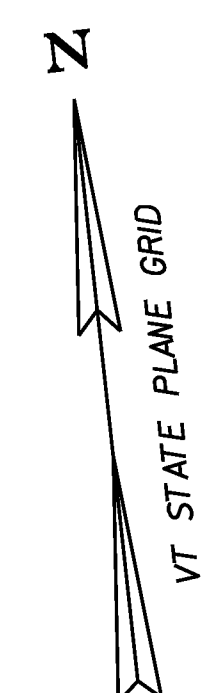

MATCH LINE - STA. 18+930 SEE SHEET CP-3

MATCH LINE - STA. 19+070 SEE SHEET CP-5

STA 18+930 TO 19+070

2/24/2012 4:30:08 PM V:\953\ccr\Five\9530033_0092\Revised Plans\PlotFiles\028 all04.pft