

**616.21 - VERTICAL GRANITE CURB**  
 STA. 18+600.0 TO 18+646.2, LT  
 STA. 18+600.0 TO 18+653.4, RT  
 STA. 18+653.3 TO 18+758.1, LT  
 STA. 18+667.8 TO 18+770.0, RT  
 STA. 18+768.5 TO 18+770.0, LT

**617.10 RELOCATE MAIL BOX, SINGLE SUPPORT**  
 STA. 18+653.0, RT (RETAIN EXIST LOCATION)  
 STA. 18+758.0, LT.

**629.29 RELOCATE HYDRANT**  
 STA. 18+705.8, RT. (ADJUST ELEVATION ONLY)

STATION	LOCATION	TYPE	WIDTH
18+648.4	LT	BIT. RES.	6.2 m
18+660.5	RT	GRAV. COM.	10.0 m
18+762.4	LT	CONC. & GRAV. COM.	5.0 m

**613.10 - STONE FILL, TYPE I**  
 STA. 18+600.0 TO 18+625.0, LT

**629.20 ADJUST ELEVATION OF VALVE BOX**  
 STA. 18+617.9, RT.

MATCH LINE - STA. 18 + 600 SEE SHEET CP-1

MATCH LINE - STA. 18 + 770 SEE SHEET CP-3

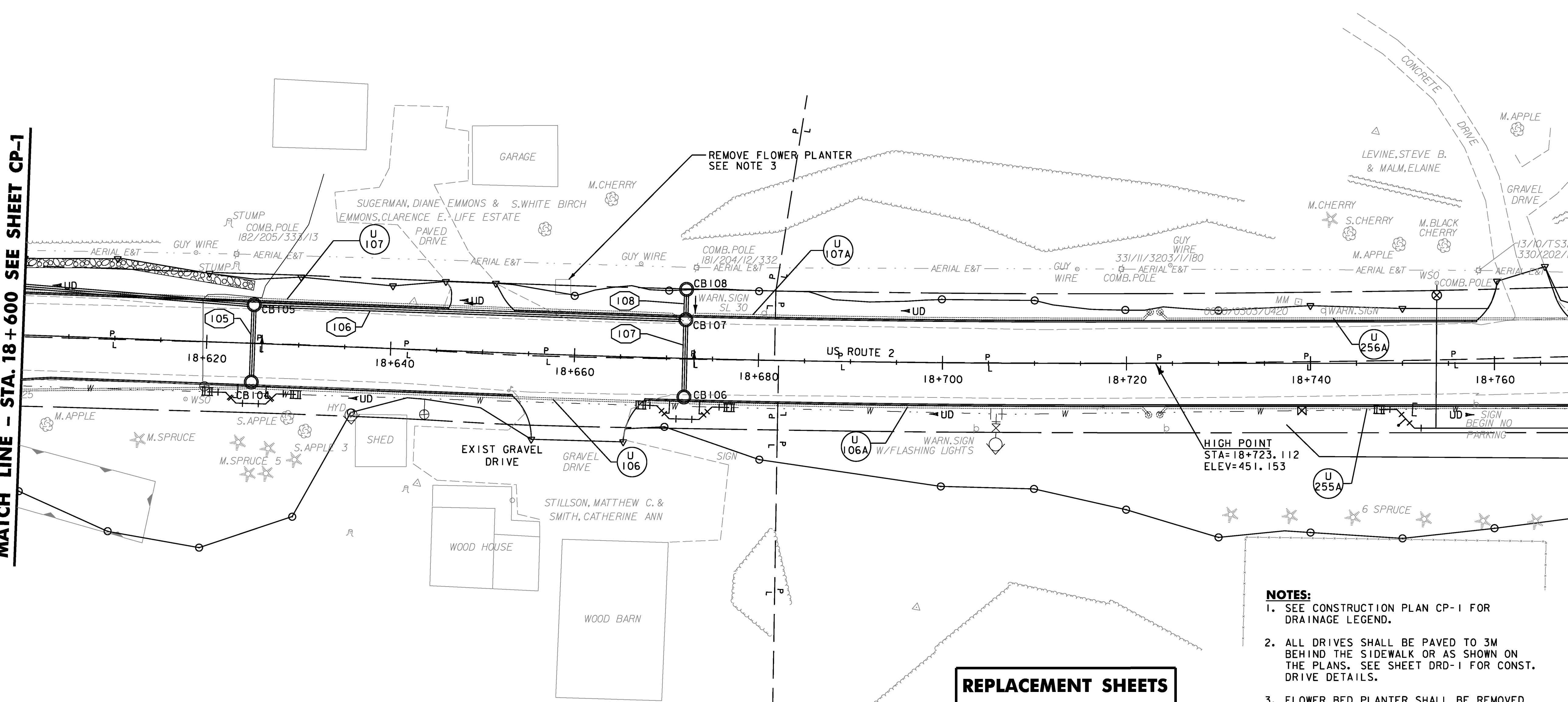

**REPLACEMENT SHEETS  
 ISSUED 10/05/11**

- NOTES:**
- SEE CONSTRUCTION PLAN CP-1 FOR DRAINAGE LEGEND.
  - ALL DRIVES SHALL BE PAVED TO 3M BEHIND THE SIDEWALK OR AS SHOWN ON THE PLANS. SEE SHEET DRD-1 FOR CONST. DRIVE DETAILS.
  - FLOWER BED PLANTER SHALL BE REMOVED AND EITHER RETURNED TO THE PROPERTY OWNER, DISPOSED OF OR AS DIRECTED BY THE RESIDENT ENGINEER. COST FOR THIS WORK SHALL BE INCIDENTAL TO ALL OTHER CONTRACT ITEMS.
  - AN ESTIMATED QUANTITY FOR ADJUSTING ELEVATION OF DRAINAGE CATCH BASINS AND MANHOLES HAS BEEN INCLUDED. THIS PAY ITEM SHALL ONLY BE USED FOR CB'S & MH'S INSTALLED IN AREAS THAT ARE TEMPORARILY PAVED TO MAINTAIN VEHICULAR TRAFFIC. ADJUSTMENT OF CB'S & MH'S IN LAWN AREAS OR OTHER AREAS THAT ARE OUTSIDE OF VEHICULAR TRAFFIC WILL BE PAID INCIDENTAL TO CATCH BASIN AND MANHOLE ITEMS.

**DRAINAGE STRUCTURES - SEE NOTE 4**

STRUCTURE NO.	CONSTRUCTION @ STATION	COMMENTS
CB104	18+625.0, RT	PRCCB W/E GRATE*
CB105	18+625.0, LT	PRCCB W/E GRATE*
CB106	18+672.0, RT	PRCCB W/D GRATE*
CB107	18+672.0, LT	PRCCB W/D GRATE*
CB108	18+672.0, LT	PRCCB W/E GRATE*

**DRAINAGE NOTES**

U 105	CONST. @ 18+625 RT. TO LT. NEW 450 mm x 7.2m PIPE OPTION 2
U 106	CONST. @ 18+625.0 TO 18+672.0 LT. NEW 450 mm x 45.9m PIPE OPTION 3
U 107	CONST. @ 18+672.0 RT. TO LT. NEW 450 mm x 7.2m PIPE OPTION 2
U 108	CONST. @ 18+672.0 LT. NEW 450 mm x 2.1m PIPE OPTION 3

**UNDERDRAIN NOTES**

U 106	CONST. @ 18+625.0 TO 18+672.0 RT. NEW 150 mm x 47.1m UND. W/ URBAN FLUSHING BASIN IN STRUCTURE #106
U 107	CONST. @ 18+625.0 TO 18+672.0 LT. NEW 150 mm x 47.1m UND. W/ URBAN FLUSHING BASIN IN STRUCTURE #107
U 106A	CONST. @ 18+672.0 TO 18+722.3 RT. NEW 150 mm x 50.6m UND. W/ RURAL FLUSHING BASIN @ 18+722.3 RT
U 107A	CONST. @ 18+672.0 TO 18+722.5 LT. NEW 150 mm x 50.6m UND. W/ RURAL FLUSHING BASIN @ 18+722.5 LT

**UNDERDRAIN NOTES**

U 255A	CONST. @ 18+723.7 TO 18+786.0 RT. NEW 150 mm x 62.6m UND. W/ RURAL FLUSHING BASIN @ 18+723.0 RT
U 256A	CONST. @ 18+723.7 TO 18+786.0 LT. NEW 150 mm x 62.6m UND. W/ RURAL FLUSHING BASIN @ 18+723.0 LT.

**DATUM**

VERTICAL	NAVD88
HORIZONTAL	NAD83(92)

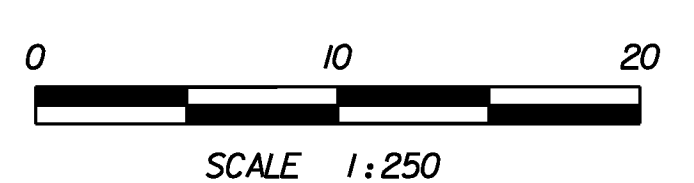

PROJECT NAME:	DANVILLE	PROJECT NUMBER:	F EGC 028-3(32)
FILE NAME:	...PlotFiles\026 all02.ptf	DESIGN SUPERVISOR:	GARY SANTY
		DESIGNED BY:	STANTEC
		CONSTRUCTION PLAN CP-2	
		DRAWN BY:	STANTEC
		CHECKED BY:	STANTEC
		SHEET	63 OF 306

10/14/2011 14:28:18 PM V:\953\cvt\Five\95303033\_0092\Revised Plans\PlotFiles\026 all02.prf