

LEGEND	
	PROPOSED DRAINAGE PIPE
	PROPOSED PRECAST REINFORCED CONCRETE CATCH BASIN WITH CAST IRON GRATE (PRCCB W/E)
	RURAL FLUSH BASIN
	PROPOSED UNDERDRAIN
	STONE FILL
	DRAINAGE NOTE
	UNDERDRAIN NOTE
	CONSTRUCTION APPROACH
	EXCAVATION OF SURFACES AND PAVEMENTS

210.10 - COLD PLANING, BIT. PAVEMENT
STA. 18+507.73 TO 18+553.73

616.20 - GRANITE SLOPE EDGING
STA. 18+569.8 TO 18+590.2 RT (EAST GATEWAY ISLAND)

616.21 - VERTICAL GRANITE CURB
STA. 18+507.73 TO 18+520.0, LT
STA. 18+507.73 TO 18+600.0, RT
STA. 18+527.9 TO 18+600.0, LT

CONSTRUCT DRIVE
STATION LOCATION TYPE WIDTH
18+523.7 LT GRAV. RES. 3.6 m

613.10 - STONE FILL, TYPE I
STA. 18+531.0 TO 18+600.0, LT
STA. 18+502.8 TO 18+524.6, RT

SWALE 1 CENTERLINE LAYOUT TABLE		
STATION	OFFSET	ELEVATION
18+400	14.3 RT	438.1
18+420	13.7 RT	438.4
18+440	12.8 RT	438.9
18+460	12.4 RT	439.5
18+480	13.5 RT	440.0
18+500	14.8 RT	440.5
18+520	13.8 RT	441.2

617.10 RELOCATE MAIL BOX, SINGLE SUPPORT
STA. 18+520.0, LT

STORMWATER MANAGEMENT

STRUCTURE #	LOCATION	COMMENTS
101A	18+390-18+520	REMOVE EXIST. STONE FILL AND CONST. VEGETATED TREATMENT SWALE 1 WITH PRETREATMENT. MATCH EXIST. GRADE SEE STORMWATER MANAGEMENT DETAILS SWM 3 FOR CONSTRUCTION DETAILS.

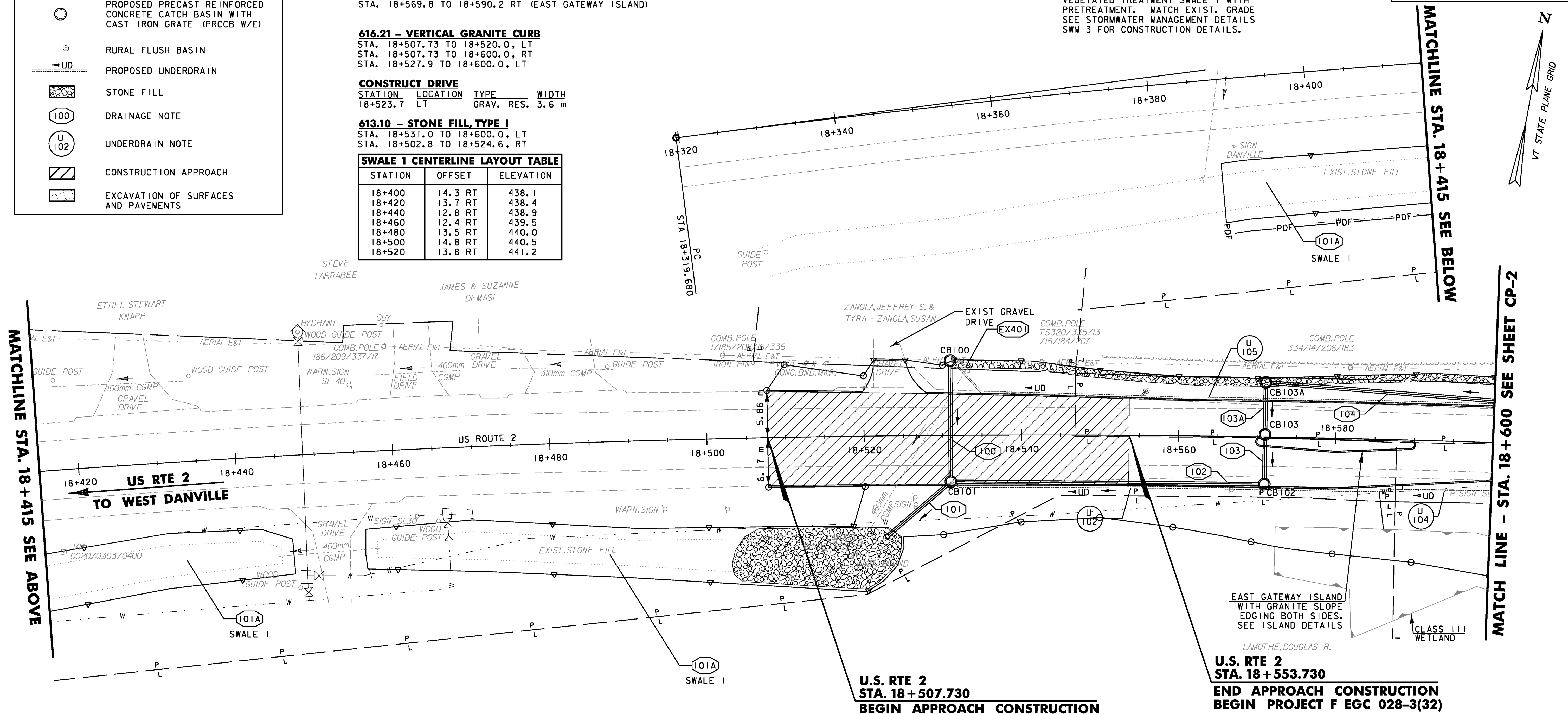

DRAINAGE STRUCTURES - SEE NOTE 6

STRUCTURE NO.	CONSTRUCTION @ STATION	COMMENTS
CB100	18+531.0, LT	PRCCB W/E GRATE*
CB101	18+531.0, RT	PRCCB W/E GRATE
CB102	18+571.0, RT	PRCCB W/E GRATE
CB103	18+571.0, LT	PRCCB W/E GRATE
CB103A	18+571.0, LT	PRCCB W/E GRATE

* ALL STRUCTURES ARE 1.2M PRECAST REINFORCED CONCRETE CATCH BASINS EXCEPT WHERE NOTED OTHERWISE (TYP. ALL SHEETS).

DRAINAGE NOTES

- 100 CONST. @ 18+531.0 LT. TO RT. NEW 450 mm x 14.2m PIPE OPTION 2
- 101 CONST. @ 18+523.0 TO 18+531.0 RT. NEW 450 mm x 9.9 m PIPE OPTION 3
- 102 CONST. @ 18+531.0 TO 18+571.0 RT. NEW 450 mm x 38.7m PIPE OPTION 3
- 103 CONST. @ 18+571.0 LT. TO RT. NEW 450 mm x 5.1m PIPE OPTION 2
- 104 CONST. @ 18+571.0 TO 18+625.0 LT. NEW 450 mm x 53.0m PIPE OPTION 3
- Ex40) CONST. @ 18+520.0 RT. TO 18+533.0 LT. REMOVE EXISTING 460mm CGMP & INLET STRUCTURE

UNDERDRAIN NOTES

- U102 CONST. @ 18+531.0 TO 18+571.0 RT. NEW 150 mm x 39.0m UND. W/URBAN FLUSHING BASIN IN STRUCTURE #102
- U104 CONST. @ 18+571.0 TO 18+625.0 RT. NEW 150 mm x 54.0m UND. W/URBAN FLUSHING BASIN IN STRUCTURE #104
- U105 CONST. @ 18+531.0 TO 18+625.0 LT. NEW 150 mm x 94.0m UND. W/URBAN FLUSHING BASIN IN STRUCTURE #105 W/RURAL FLUSHING BASIN @ 18+556.0 LT.

- NOTES**
- ALL EXISTING STORM DRAINAGE PIPES AND STRUCTURES LOCATED COMPLETELY WITHIN THE PROPOSED ROADWAY ARE TO BE REMOVED OR ABANDONED AS DIRECTED BY THE ENGINEER. COST FOR REMOVAL OF EXISTING PIPES SHALL BE PAID AS 204.20 (TRENCH EXCAVATION OF EARTH). ABANDONED PIPES SHALL BE PAID AS SPECIAL PROVISION 900.608 (CONTROLLED DENSITY (FLOWABLE) FILL).
 - CONST. LIMITS REFLECT CUT SLOPE ROUNDING IN ACCORDANCE WITH STATE STANDARDS.
 - ALL DRIVES SHALL BE PAVED TO 3M BEHIND THE SIDEWALK, OR AS SHOWN ON THE PLANS SEE SHEET DRD-1 FOR CONST. DRIVE DETAILS.
 - SEE DRAINAGE DETAIL SHEET DD-1 FOR STORMDRAIN OUTLET PROTECTION DETAIL AND DIMENSIONS.
 - CLEAR ZONE FOR CURBED ROADWAY IS 450MM. CLEAR ZONE LINE IS NOT SHOWN IN CURBED AREAS FOR CLARITY.
 - AN ESTIMATED QUANTITY FOR ADJUSTING ELEVATION OF DRAINAGE CATCH BASINS AND MANHOLES HAS BEEN INCLUDED. THIS PAY ITEM SHALL ONLY BE USED FOR CB'S & MH'S INSTALLED IN AREAS THAT ARE TEMPORARILY PAVED TO MAINTAIN VEHICULAR TRAFFIC. ADJUSTMENT OF CB'S & MH'S IN LAWN AREAS OR OTHER AREAS THAT ARE OUTSIDE OF VEHICULAR TRAFFIC WILL BE PAID INCIDENTAL TO CATCH BASIN AND MANHOLE ITEMS.

DATUM

VERTICAL	NAVD88
HORIZONTAL	NAD83(92)

**REPLACEMENT SHEETS
ISSUED 1005/11**



PROJECT NAME:	DANVILLE	STA 18+507.730 TO 18+600
PROJECT NUMBER:	F EGC 028-3(32)	
FILE NAME:	...PlotFiles\025 all01.prf	PLOT DATE: 10/4/2011
DESIGN SUPERVISOR:	GARY SANTY	DRAWN BY: STANTEC
DESIGNED BY:	STANTEC	CHECKED BY: STANTEC
CONSTRUCTION PLAN CP-1		SHEET 62 OF 306

10/4/2011 14:28 PM V:\953\ccr\Five\9530033_0052\Revised Plans\PlotFiles\025 all01.prf