

MATCH LINE - STA. 18+930 SEE SHEET ALC-3

MATCH LINE - STA. 19+100 SEE SHEET ALC-5

**CURBLINE CURVE DATA**

CURBLINE CURVE #1 DATA  
 R = 100.150  
 L = 9.605  
 DELTA = 5°29'41.2" Right  
 T = 4.806  
 E = 0.115

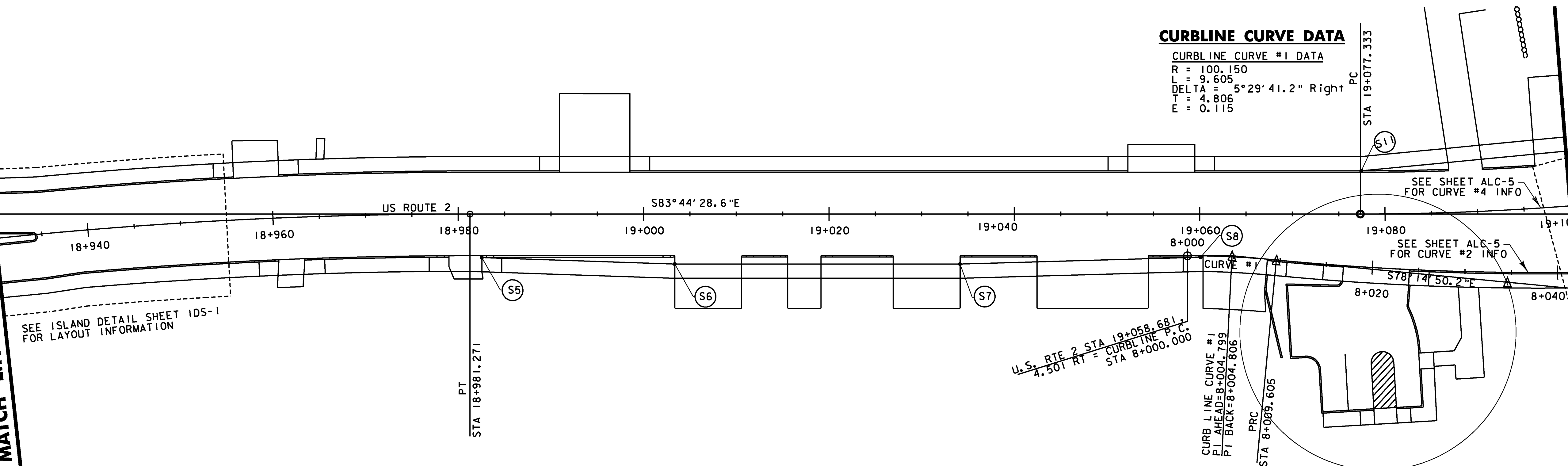

SEE ISLAND DETAIL SHEET IDS-1 FOR LAYOUT INFORMATION

SEE SHEET ALC-5 FOR CURVE #4 INFO

SEE SHEET ALC-5 FOR CURVE #2 INFO

U.S. RTE 2 STA 19+058.681  
 4.501 RT = CURBLINE P.C.  
 STA 8+000.000

CURBLINE CURVE #1  
 P.L. HEAD=8+004.799  
 P.T. BACK=8+004.806  
 STA 8+000.000

SEE BLOW-UP DETAIL ON THIS SHEET

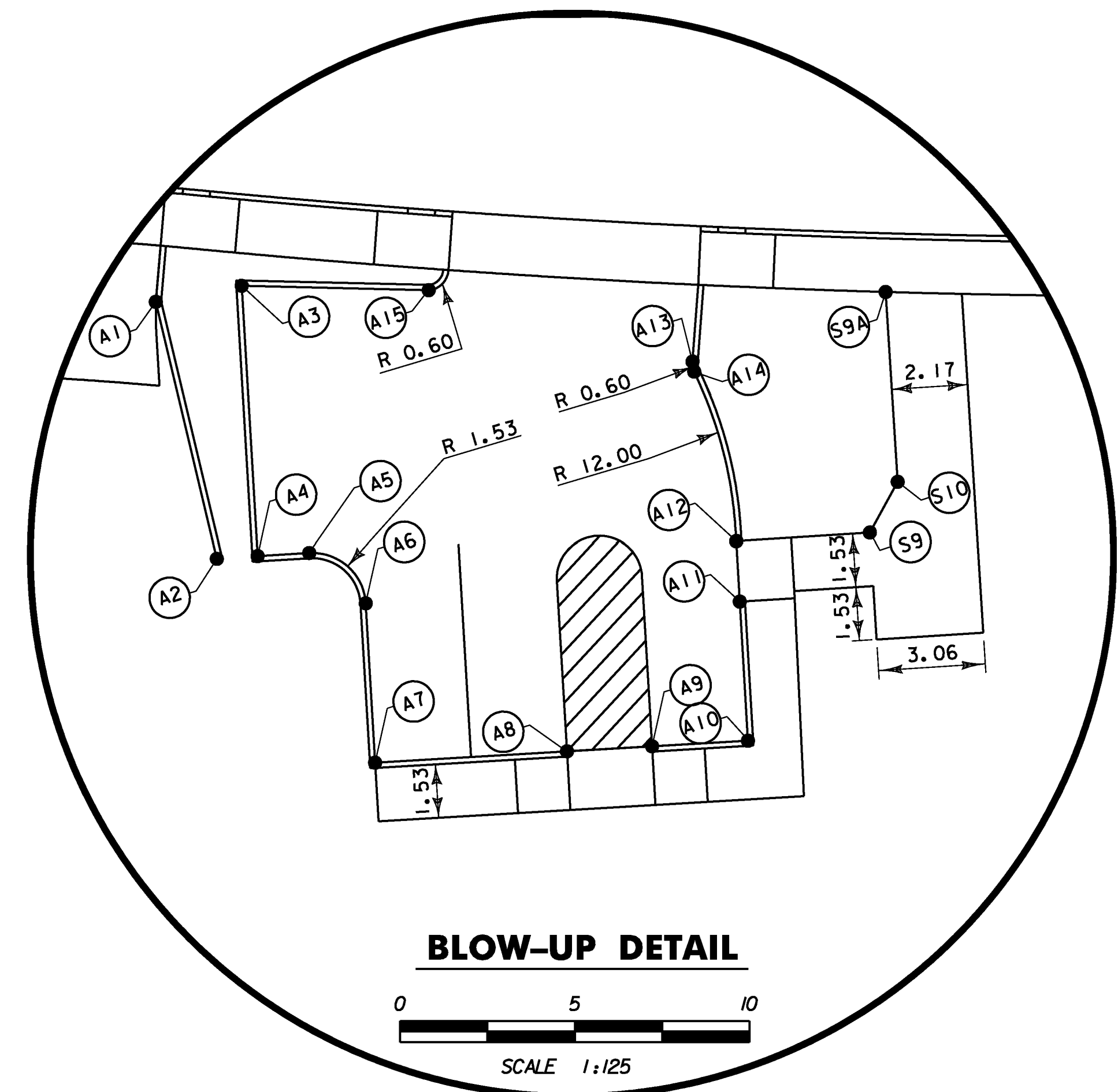

**BLOW-UP DETAIL**

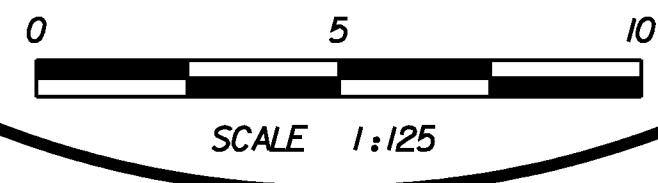

**CURBLINE LAYOUT POINTS (TIE TO CONSTRUCTION Q)**

POINT	STATION	OFFSET
A1	19+067.02	8.16 RT
A2	19+068.77	15.50 RT
A3	19+069.48	7.70 RT
A4	19+069.94	15.42 RT
A5	19+071.41	15.33 RT
A6	19+073.03	16.77 RT
A7	19+073.30	21.33 RT
A8	19+078.69	21.01 RT
A9	19+080.96	20.89 RT
A10	19+083.53	20.77 RT
A11	19+083.39	16.79 RT
A12	19+083.33	15.06 RT
A13	19+082.22	9.91 RT
A14	19+082.26	10.20 RT
A15	19+074.83	7.82 RT

**SIDEWALK LAYOUT POINTS (TIE TO CONSTRUCTION Q)**

POINT	STATION	OFFSET	COMMENTS
S5	18+982.55	4.70 RT	BEGIN SIDEWALK TAPER
S6	19+003.37	5.40 RT	END SIDEWALK TAPER
S7	19+034.14	5.40 RT	BEGIN SIDEWALK TAPER
S8	19+060.11	4.66 RT	END SIDEWALK TAPER
S9	19+086.97	14.92 RT	
S9A	19+087.63	8.06 RT	
S10	19+087.77	13.50 RT	
S11	19+077.44	4.66 LT	

**DATUM**

VERTICAL	NAVD88
HORIZONTAL	NAD83(92)

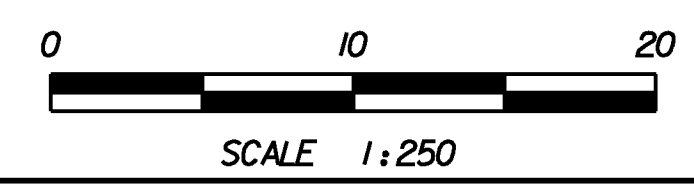

STA 18+930 TO 19+100

PROJECT NAME:	DANVILLE
PROJECT NUMBER:	F EGC 028-3(32)
FILE NAME:	...highway\plotfiles\alc-04.ptf
DESIGN SUPERVISOR:	GARY SANTY
DESIGNED BY:	STANTEC
ALIGNMENT/CURBLINE PLAN	ALC-4
PLOT DATE:	1/18/2011
DRAWN BY:	STANTEC
CHECKED BY:	STANTEC
SHEET	52 OF 306

1/18/2011 11:50:08 PM v:\1953\active\1953\0033\_0092\highway\plotfiles\alc-04.ptf