

**SIDEWALK LAYOUT POINTS  
(TIE TO CONSTRUCTION CL)**

POINT	STATION	OFFSET
S1	18+809.04	6.18 RT
S2	18+799.85	14.54 RT
S3	18+925.98	8.26 RT
S4	18+924.64	14.14 RT

**DRIVE LAYOUT POINTS  
(TIE TO CONSTRUCTION CL)**

POINT	STATION	OFFSET
D17	18+786.54	4.50 LT
D18	18+788.73	8.78 LT
D19	18+792.34	9.82 LT
D20	18+794.52	4.50 LT
D21	18+822.25	4.50 LT
D22	18+524.17	6.08 LT
D23	18+833.27	6.01 LT
D24	18+835.27	4.50 LT
D25	1+041.89	3.30 RT
D26	1+040.04	5.52 RT
D27	1+031.67	4.38 RT
D28	1+030.04	3.30 RT

**CURVE DATA**

US ROUTE 2 CURVE # 3 DATA	WALDEN HILL CURVE DATA
$\Delta = 16^{\circ}36'50.9''$ RT	$\Delta = 42^{\circ}30'51.6''$ RT
R = 498.964	R = 60.000
T = 72.854	T = 23.341
L = 144.685	L = 44.521
E = 5.291	E = 4.380
BANK = NC	BANK = NC

MATCH LINE - STA. 18 + 770 SEE SHEET ALC-2

MATCH LINE - STA. 18 + 930 SEE SHEET ALC-4

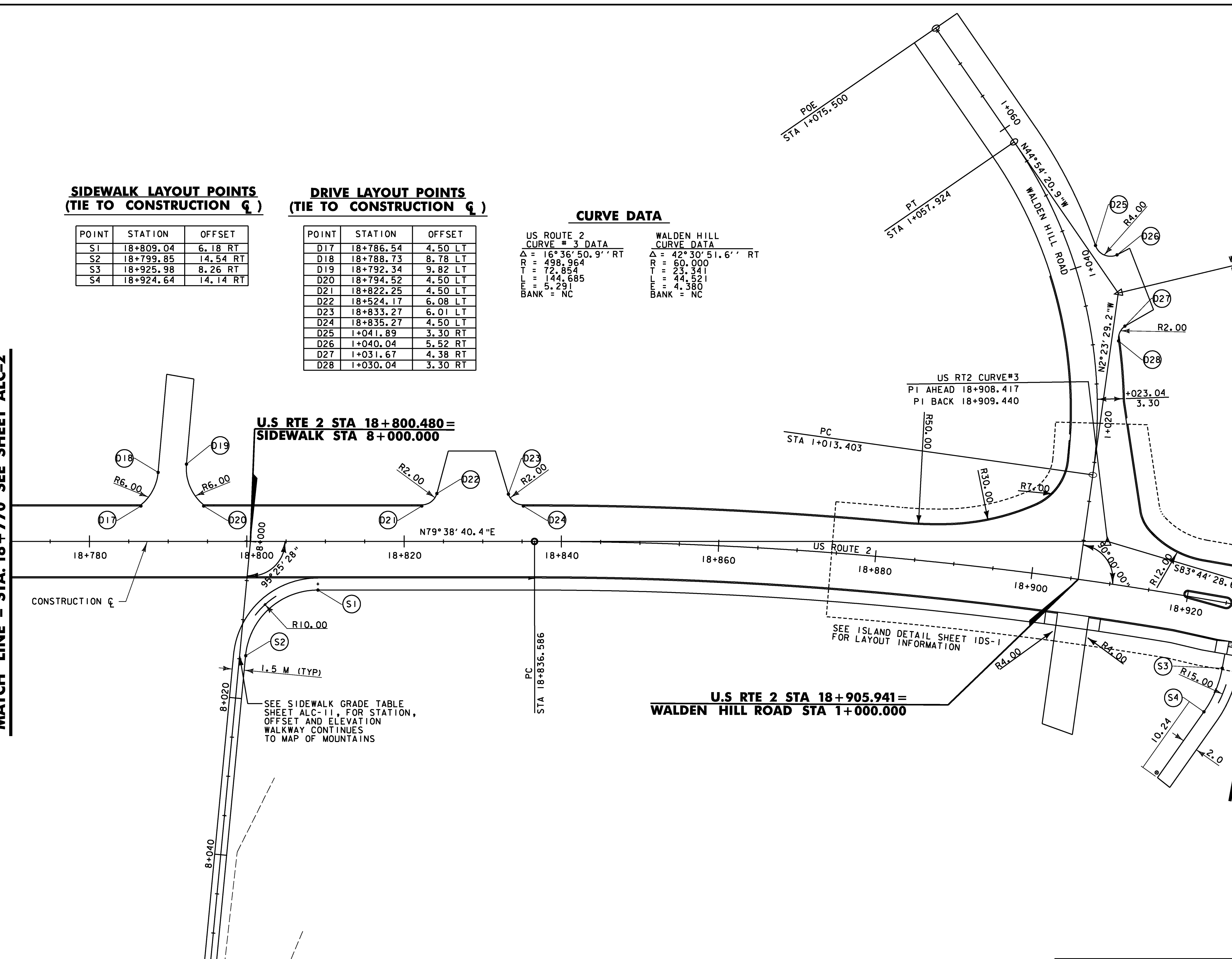

**DATUM**

VERTICAL	NAVD88
HORIZONTAL	NAD83(92)

**MATCH TO ALIGNMENT/CURLINE PLAN 11**

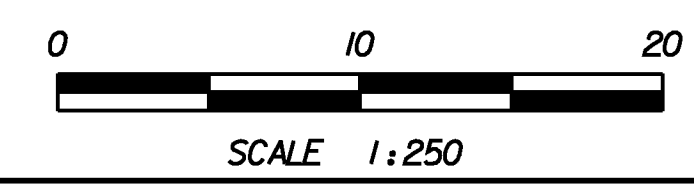

PROJECT NAME:	DANVILLE
PROJECT NUMBER:	F EGC 028-3(32)
FILE NAME:	...highway\plotfiles\alc-03.prf
DESIGN SUPERVISOR:	GARY SANTY
DESIGNED BY:	STANTEC
ALIGNMENT/CURLINE PLAN	ALC-3
PLOT DATE:	1/18/2011
DRAWN BY:	STANTEC
CHECKED BY:	STANTEC
SHEET	51 OF 306

STA 18+770 TO 18+930

1/18/2011 11:50:06 PM v:\1953\active\1953\0033\_0092\highway\plotfiles\alc-03.prf