

FOR EROSION CONTROL NOTES AND DETAILS SEE ROW SHEET 40 OF 107

FOR DRAINAGE NOTES AND DETAILS SEE ROW SHEET 29 OF 107

FOR LANDSCAPING NOTES AND DETAILS SEE ROW SHEET 51 OF 107

FOR CONSTRUCTION NOTES AND DETAILS SEE ROW SHEET 28 OF 107

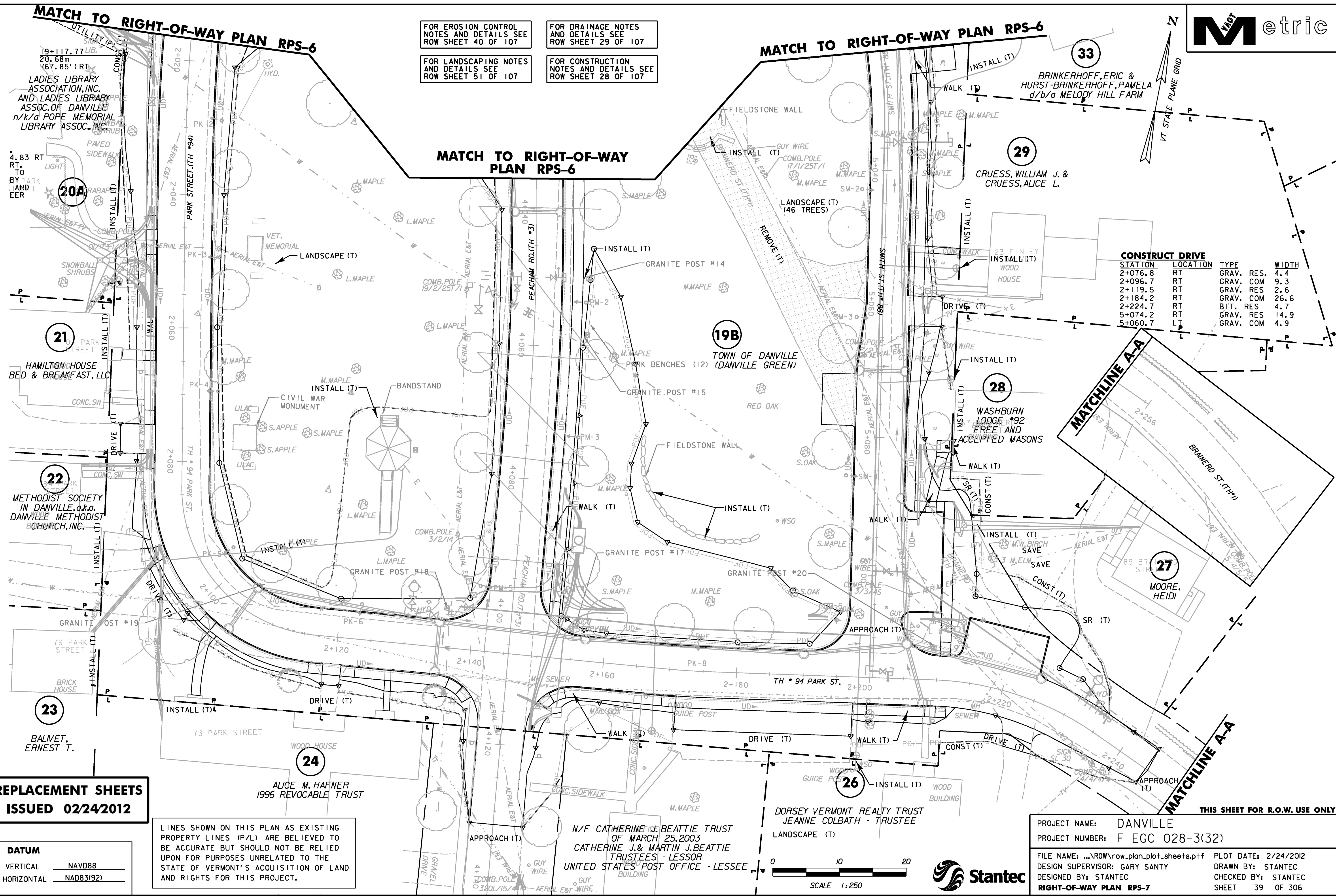

CONSTRUCT DRIVE

STATION	LOCATION	TYPE	RES.	WIDTH
2+076.8	RT	GRAV.	RES.	4.4
2+096.7	RT	GRAV.	COM	9.3
2+119.5	RT	GRAV.	RES	2.6
2+184.2	RT	GRAV.	COM	26.6
2+224.7	RT	BIT.	RES	4.7
5+074.2	RT	GRAV.	RES	14.9
5+060.7	LT	GRAV.	COM	4.9

**REPLACEMENT SHEETS
ISSUED 02/24/2012**

DATUM

VERTICAL	NAVD88
HORIZONTAL	NAD83(92)

LINES SHOWN ON THIS PLAN AS EXISTING PROPERTY LINES (P/L) ARE BELIEVED TO BE ACCURATE BUT SHOULD NOT BE RELIED UPON FOR PURPOSES UNRELATED TO THE STATE OF VERMONT'S ACQUISITION OF LAND AND RIGHTS FOR THIS PROJECT.

N/F CATHERINE J. BEATTIE TRUST OF MARCH 25, 2003
CATHERINE J. & MARTIN J. BEATTIE TRUSTEES - LESSOR
UNITED STATES POST OFFICE - LESSEE

DORSEY VERMONT REALTY TRUST
JEANNE COLBATH - TRUSTEE
LANDSCAPE (T)

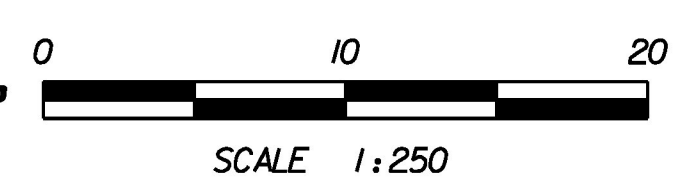

THIS SHEET FOR R.O.W. USE ONLY

PROJECT NAME: DANVILLE
PROJECT NUMBER: F EGC 028-3(32)

FILE NAME: ...ROW\row_plan_plot_sheets.pptf PLOT DATE: 2/24/2012
DESIGN SUPERVISOR: GARY SANTY DRAWN BY: STANTEC
DESIGNED BY: STANTEC CHECKED BY: STANTEC
RIGHT-OF-WAY PLAN RPS-7 SHEET 39 OF 306

2/24/2012 4:04:41 PM V:\1953\active\19530033_0092\Highway\PlotFiles\ROW\row_plan_plot_sheets.pptf