

STATION	LOCATION	TYPE	WIDTH
18+958.4	LT	GRAV. RES.	4.9
18+961.8	RT	BIT. RES.	2.7
18+980.8	RT	BIT. RES.	3.6
18+994.7	LT	GRAV. COM.	7.6
19+007.0	RT	GRAV. RES.	7.2
19+017.3	RT	BIT. COM.	3.6
19+028.1	RT	BIT. COM.	12.0
19+050.9	RT	GRAV. COM.	7.2
19+055.8	LT	GRAV. COM.	7.2
19+063.8	RT	BIT. COM.	6.9

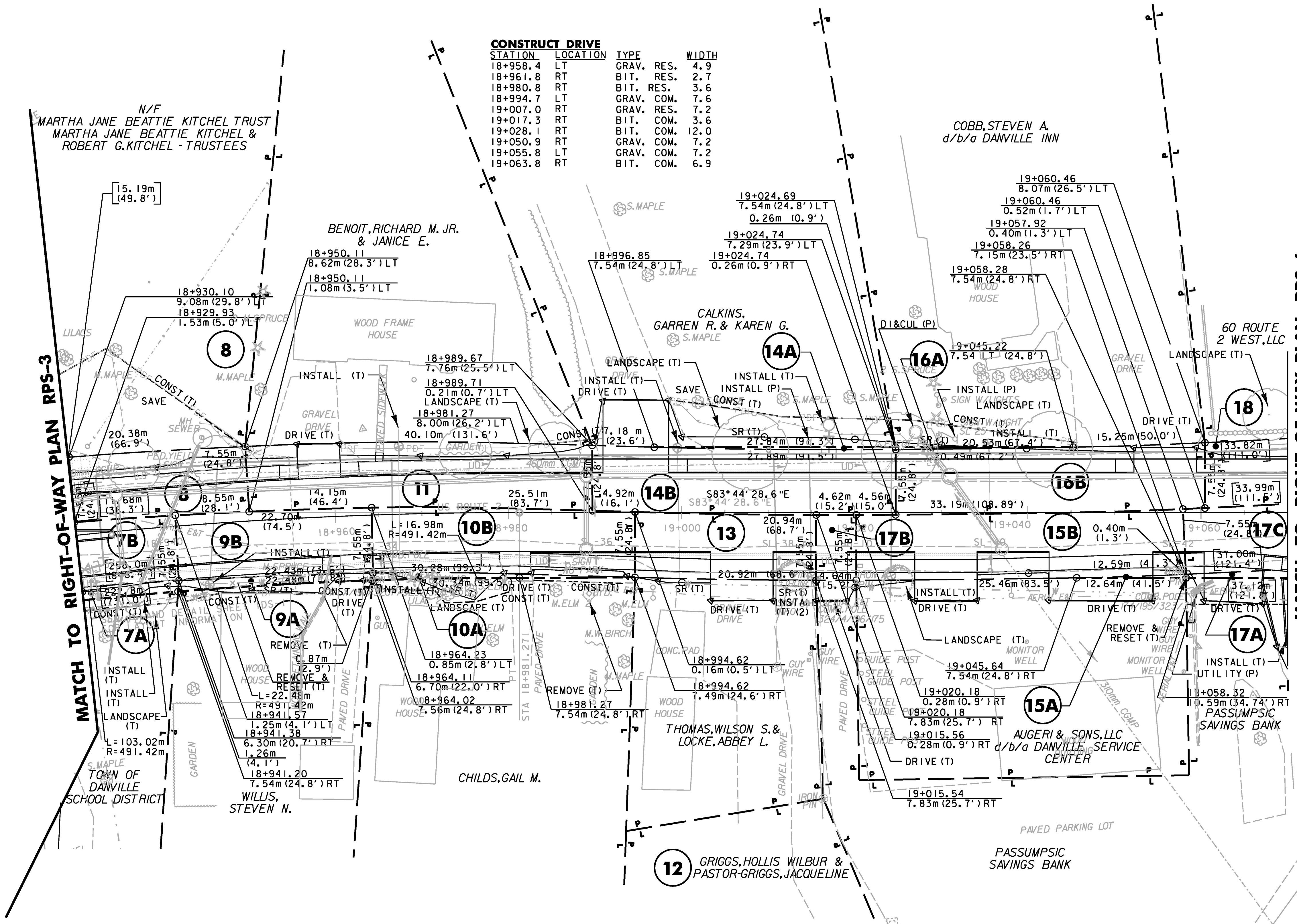

MATCH TO RIGHT-OF-WAY PLAN RPS-3

MATCH TO RIGHT-OF-WAY PLAN RPS-6

LINES SHOWN ON THIS PLAN AS EXISTING PROPERTY LINES (P/L) ARE BELIEVED TO BE ACCURATE BUT SHOULD NOT BE RELIED UPON FOR PURPOSES UNRELATED TO THE STATE OF VERMONT'S ACQUISITION OF LAND AND RIGHTS FOR THIS PROJECT.

**REPLACEMENT SHEETS
ISSUED 02/24/2012**

DATUM
VERTICAL NAVD88
HORIZONTAL NAD83(92)

FOR EROSION CONTROL NOTES AND DETAILS SEE ROW SHEET 38 OF 107

FOR LANDSCAPING NOTES AND DETAILS SEE ROW SHEET 49 OF 107

FOR DRAINAGE NOTES AND DETAILS SEE ROW SHEET 26 OF 107

FOR CONSTRUCTION NOTES AND DETAILS SEE ROW SHEET 26 OF 107

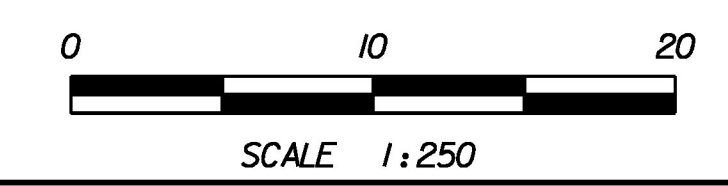

THIS SHEET FOR R.O.W. USE ONLY

PROJECT NAME: DANVILLE
PROJECT NUMBER: F EGC 028-3(32)

FILE NAME: ...ROW\row_plan_plot_sheets.pptf PLOT DATE: 2/24/2012
DESIGN SUPERVISOR: GARY SANTY DRAWN BY: STANTEC
DESIGNED BY: STANTEC CHECKED BY: STANTEC
RIGHT-OF-WAY PLAN RPS-5 SHEET 37 OF 306

2/24/2012 4:04:38 PM V:\1953\active\19530033_0092\Highway\1953\row\row_plan_plot_sheets.pptf