

MATCH TO RIGHT-OF-WAY PLAN RPS-3

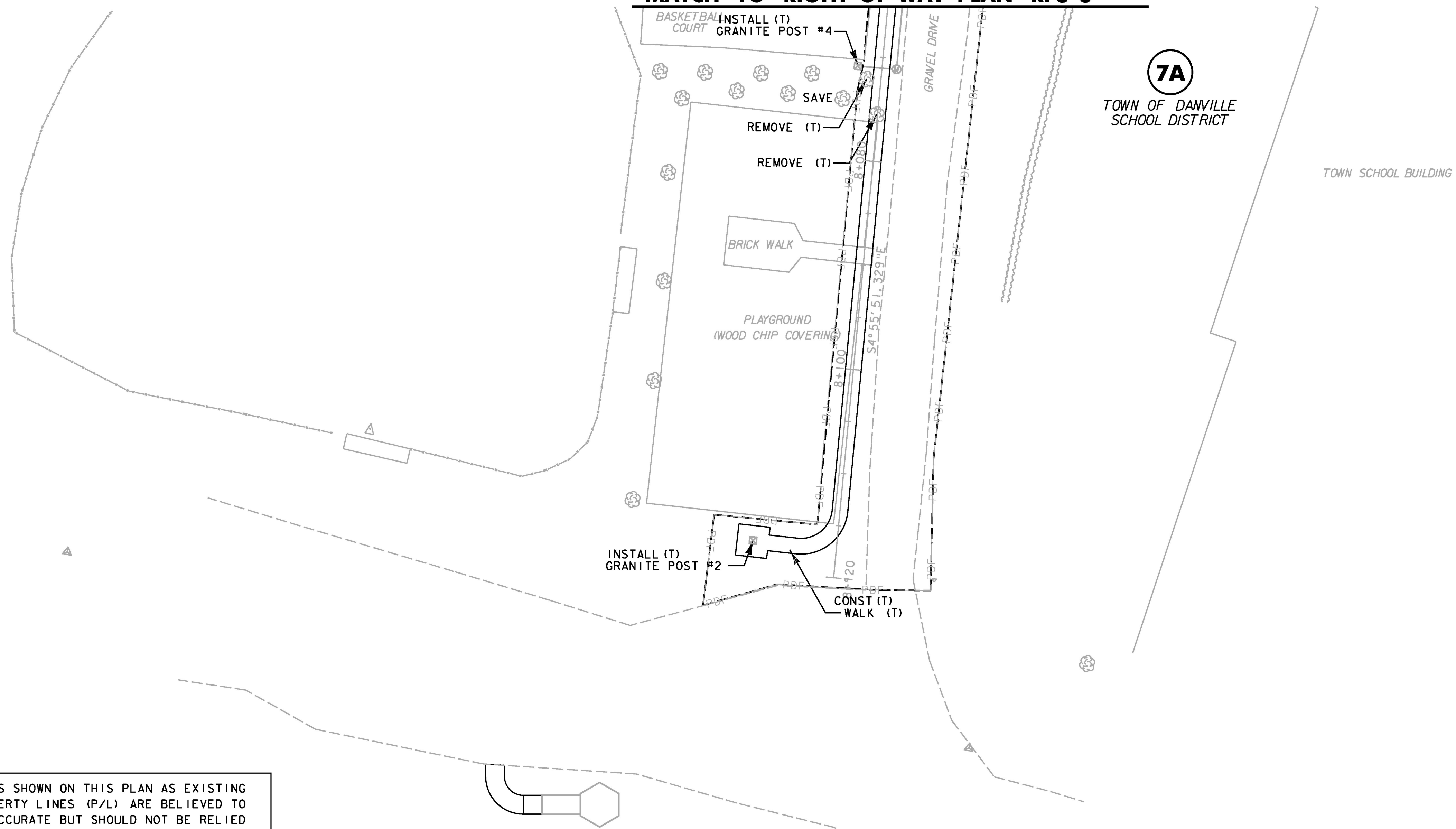

LINES SHOWN ON THIS PLAN AS EXISTING PROPERTY LINES (P/L) ARE BELIEVED TO BE ACCURATE BUT SHOULD NOT BE RELIED UPON FOR PURPOSES UNRELATED TO THE STATE OF VERMONT'S ACQUISITION OF LAND AND RIGHTS FOR THIS PROJECT.

DATUM	
VERTICAL	NAVD88
HORIZONTAL	NAD83(92)

FOR EROSION CONTROL NOTES AND DETAILS SEE ROW SHEET 45 OF 107

FOR LANDSCAPING NOTES AND DETAILS SEE ROW SHEET 56 OF 107

**REPLACEMENT SHEETS
ISSUED 02/24/2012**

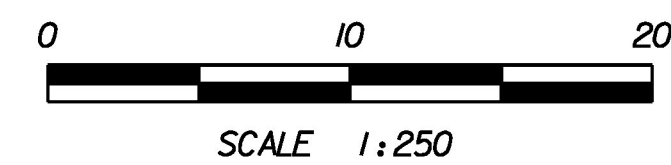

THIS SHEET FOR R.O.W. USE ONLY

PROJECT NAME: DANVILLE
PROJECT NUMBER: F EGC 028-3(32)

FILE NAME: ...\\ROW\row_plan_plot_sheets.ptf	PLOT DATE: 2/24/2012
DESIGN SUPERVISOR: GARY SANTY	DRAWN BY: STANTEC
DESIGNED BY: STANTEC	CHECKED BY: STANTEC
RIGHT-OF-WAY PLAN RPS-4	SHEET 36 OF 306

