

- NOTES:
1. Geopier Rammed Aggregate Pier drawings based on Approximate Limits of Special Provision (Impact Displacement Pier) provided in the contract drawings, sheet 87 of 144, prepared by the Vermont Agency of Transportation, and dated March 16, 2010.
 2. For subsurface exploration logs and locations, see design submittal booklet.
 3. See sheet GEO-2.0 for construction notes, specifications, and details.
 4. See design submittal booklet for Rammed Aggregate Pier shaft lengths.
 5. All existing and proposed utilities within and adjacent to the proposed Limits of Impact Displacement Piers shall be verified by the General Contractor and coordinated with the Geopier Foundation Installer before Rammed Aggregate Pier installation shall proceed.
 6. A copy of this drawing is available on request for use in determining coordinate locations of individual piers that can be used with electronic survey equipment to stake out pier locations in the field. Questions that may pertain to discrepancies between coordinate locations of individual piers and the pier locations referenced to the overall Approximate Limits of Special Provision (Impact Displacement Piers) must be discussed and clarified with the VAOT. However, should a discrepancy of 2 inches or less be found, the pier may be staked out at the coordinate location shown.

(#) Indicates Impact Rammed Aggregate Pier element location and designation.

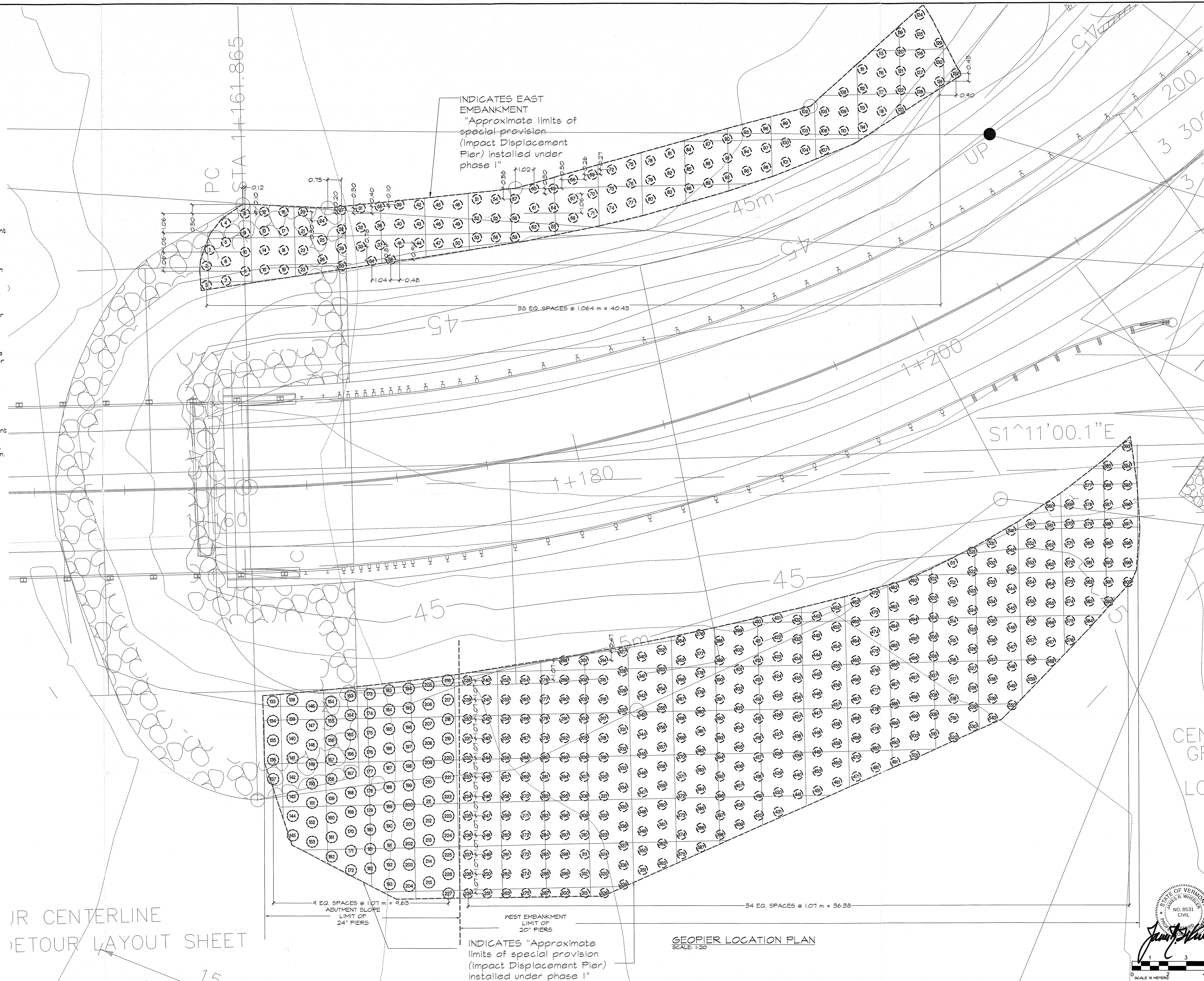

IR CENTERLINE
ETOUR LAYOUT SHEET

GEOPIER LOCATION PLAN
SCALE: 1:20



DESIGN/BUILD GEOTECHNICAL
12 Mount Royal Ave., Ste. 208
Warborough, MA 01752
Tel: 508-481-3849
Fax: 508-460-1114
"DELIVERING THE GEOPIER FOUNDATION SYSTEM"

"Geopier" is the registered trademark of The Geopier Foundation Company, Inc. This drawing contains information proprietary to The Geopier Foundation Company, Inc. and its licensors, and is being furnished for the use of A.E. St. George Contractor, Inc. only in connection with this project. The information contained herein is the property of The Geopier Foundation Company, Inc. and is protected under U.S. Patent Nos. 5248992 and other patents pending.

SCALE	DATE	SHEET	PLAN NO.
1:20	5/21/10	1 OF 2	
DRAWN BY	CHKD BY	APPR BY	DISK REF NO.
MH	CD	JK	

INSTALLER:
 HELICAL DRILLING, INC.
659 GRANITE STREET
BRAintree, MA 0284
TEL: (781) 848-2110

GEOPIER LOCATION PLAN
Cornwall BRS 0172 (6)
VT Route 125 Bridge No. 6
Cornwall, VT
SHEET NO. GNE-00231
GEO-1.0