

**SPECIAL PROVISION
(SETTLEMENT PLATFORM, TYPE I)**

- 3+091.13 - 4.63m LT - IEA.
- 3+092.65 - 4.61m RT - IEA.
- 3+111.20 - 5.56m RT - IEA.
- 3+111.50 - 6.69m LT - IEA.
- 3+172.10 - 7.18m LT - IEA.
- 3+172.10 - 17.64m LT - IEA.
- 3+172.10 - 4.98m RT - IEA.
- 3+190.63 - 5.06m RT - IEA.
- 3+192.33 - 4.74m LT - IEA.
- 3+195.26 - 17.99m LT - IEA.

**SPECIAL PROVISION
(PIEZOMETER - VIBRATING WIRE)**

- 3+094.36 - 1.98m RT - 2 EA. (TIP ELEV. APPROX. 39m AND 44m)
- 3+109.00 - 6.53m LT - IEA. (TIP ELEV. APPROX. 40m)
- 3+175.50 - 7.26m LT - IEA. (TIP ELEV. APPROX. 37.5m)
- 3+193.60 - 4.91m RT - 2 EA. (TIP ELEV. APPROX. 36.5m AND 41.5m)

**SPECIAL PROVISION
(INCLINOMETER)**

- 3+172.10 - 11.60m RT - IEA. (TIP ELEV. APPROX. 23m)
- 3+192.78 - 9.80m RT - IEA. (TIP ELEV. APPROX. 22m)

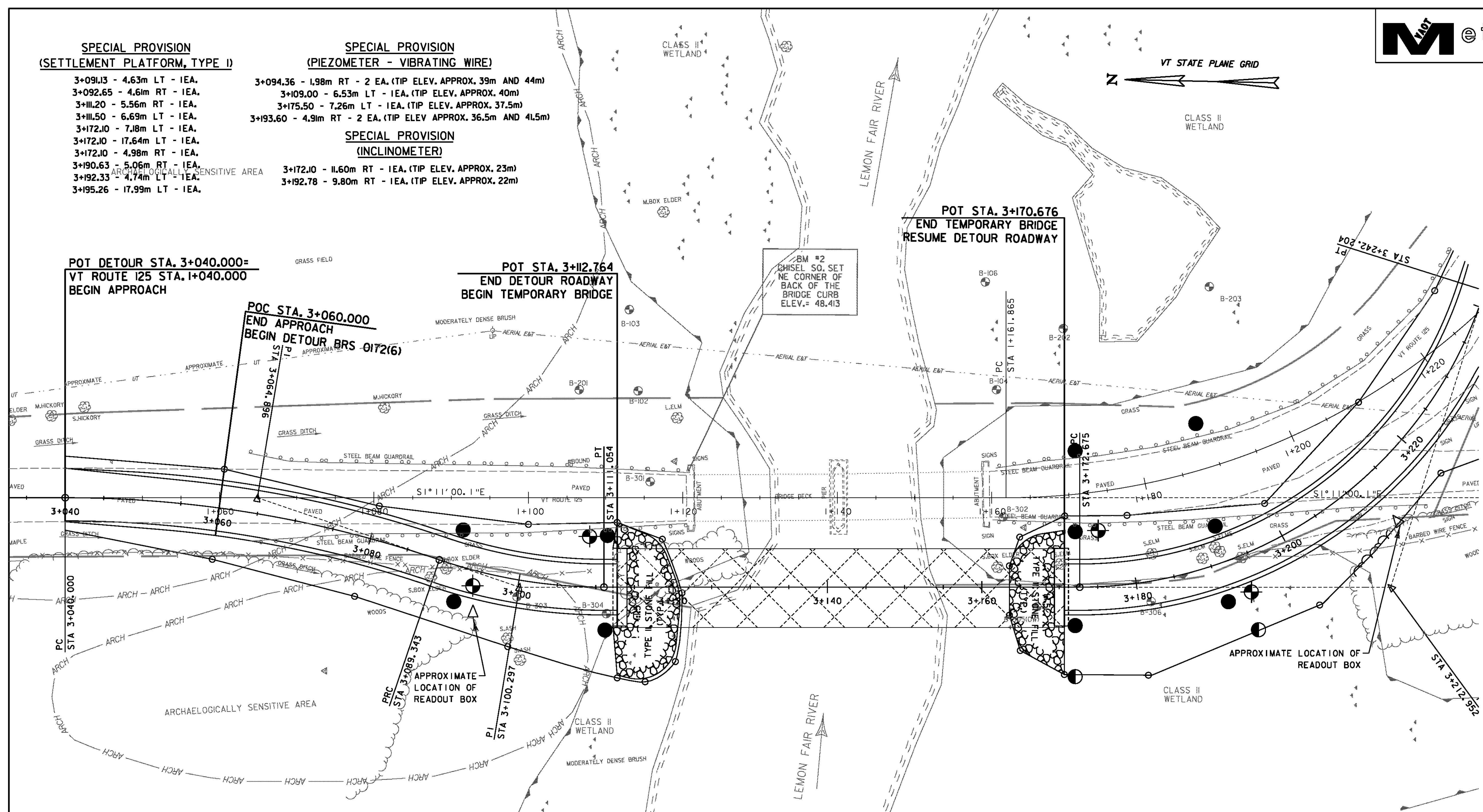

NOTES:

- 1.) THE ACTUAL PERFORMANCE OF THE EMBANKMENT IN TERMS OF STABILITY AND SETTLEMENT IS A FUNCTION OF THE IN-SITU SOIL PROPERTIES, THE INCREASE IN STRENGTH AFTER SOIL IMPROVEMENT TECHNIQUES HAVE BEEN IMPLEMENTED, AND THE RATE OF EMBANKMENT CONSTRUCTION. THEREFORE THE CONTRACTOR SHOULD BE PREPARED TO COORDINATE THE RATE AND LOCATIONS OF EMBANKMENT FILL PLACEMENT WITH THE ENGINEER BASED ON THE INFORMATION OBTAINED FROM THE GEOTECHNICAL INSTRUMENTATION MONITORING AND EVALUATION OF THE CONDITIONS.
- 2.) VIBRATING WIRE PIEZOMETERS SHALL BE INSTALLED AND MONITORED DAILY FOR A MINIMUM OF ONE WEEK BEFORE THE INSTALLATION OF IMPACT DISPLACEMENT PIERS AND/OR PREFABRICATED VERTICAL WICK DRAINS IN ORDER TO OBTAIN PRECONSTRUCTION BASELINE INFORMATION. PLEASE NOTE THE VIBRATING WIRE PIEZOMETERS LOCATED IN THE MAINLINE EMBANKMENT LIMITS MAY NEED TO BE INSTALLED AFTER THE DETOUR EMBANKMENT HAS BEEN CONSTRUCTED.
- 3.) THE CONTRACTOR IS REQUIRED TO SUBMIT AN INSTRUMENTATION INSTALLATION SCHEDULE IN ACCORDANCE WITH THE SPECIAL PROVISIONS.

ANTICIPATED SETTLEMENT		
LOCATION	ESTIMATED POST CONSTRUCTION CONSOLIDATION SETTLEMENT	ESTIMATED TIME TO REACH 90% CONSOLIDATION
NORTH MAINLINE EMBANKMENT	130MM	90 DAYS
NORTH DETOUR EMBANKMENT	200MM	90 DAYS
SOUTH MAINLINE EMBANKMENT	325MM	100 DAYS
SOUTH DETOUR EMBANKMENT	76MM	30 DAYS



LEGEND

- APPROXIMATE LOCATION OF SPECIAL PROVISION (SETTLEMENT PLATFORM, TYPE I)
- APPROXIMATE LOCATION OF SPECIAL PROVISION (INCLINOMETER)
- APPROXIMATE LOCATION OF SPECIAL PROVISION (PIEZOMETER, VIBRATING WIRE)

DATUM	
VERTICAL	NAVD 88
HORIZONTAL	NAD 83(92)

PROJECT: CORNWALL	PROJECT NO.: BRS 0172(6)
DESIGN FILE NAME: z85e042geobdr.dgn	PLOT DATE: 2/12/2010
IPARM FILE NAME:	SURVEY DATE: 1996&1999
SURVEYED BY: VTRANS & VT SURVEY	DRAWN BY: ERIK ATKINS
SQUAD LEADER: MARTHA EVANS-MONGEON	SHEET: 91 OF 144

INSTRUMENTATION INSTALLATION LAYOUT SHEET