

**APPROXIMATE LIMITS OF SPECIAL PROVISION
(IMPACT DISPLACEMENT PIER)**
 3+164 RT ~ 3+214 RT - 527 S.M.
 3+161LT ~ 3+228.5 LT - 148 S.M.
 SEE SHEET 84 AND SPECIAL PROVISIONS



ARCHAEOLOGICALLY SENSITIVE AREA

POT DETOUR STA. 3+040.000=
VT ROUTE 125 STA. 1+040.000
BEGIN APPROACH

POC STA. 3+060.000
END APPROACH
BEGIN DETOUR BRS 0172(6)

POT STA. 3+112.764
END DETOUR ROADWAY
BEGIN TEMPORARY BRIDGE

POT STA. 3+170.676
END TEMPORARY BRIDGE
RESUME DETOUR ROADWAY

APPROXIMATE LIMITS OF SPECIAL PROVISION (IMPACT DISPLACEMENT PIER) INSTALLED UNDER PHASE I

**PHASE 1
SPECIAL PROVISION (IMPACT DISPLACEMENT PIER)
INSTALLATION LAYOUT SHEET**

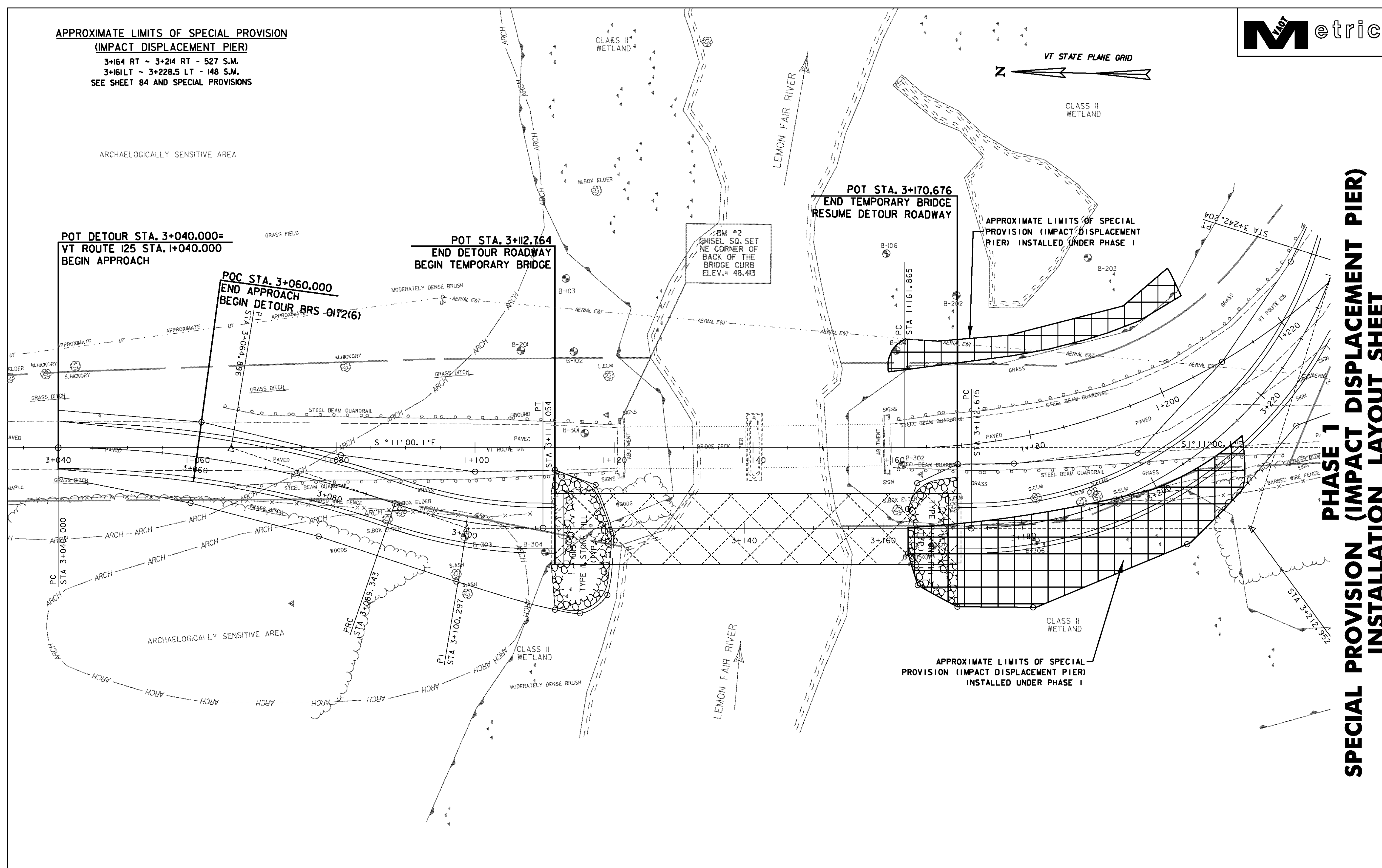

BM #2
 CHISEL SQ. SET
 NE CORNER OF
 BACK OF THE
 BRIDGE CURB
 ELEV.= 48.413

APPROXIMATE LIMITS OF SPECIAL PROVISION (IMPACT DISPLACEMENT PIER) INSTALLED UNDER PHASE I



LEGEND

APPROXIMATE LIMITS OF SPECIAL PROVISION (IMPACT DISPLACEMENT PIER)

DATUM	
VERTICAL	NAVD 88
HORIZONTAL	NAD 83(92)

PROJECT: CORNWALL	PROJECT NO.: BRS 0172(6)
DESIGN FILE NAME: z85e042geobdr.dgn	PLOT DATE: 3/16/2010
IPARM FILE NAME:	SURVEY DATE: 1996&1999
SURVEYED BY: VTRANS & VT SURVEY	DRAWN BY: ERIK ATKINS
SQUAD LEADER: MARTHA EVANS-MONGEON	SHEET: 87 OF 144