

**GEOTEXTILE FOR SILT FENCE**

1+050 LT ~ 1+086 LT  
1+064 RT ~ 1+082 RT

**GEOTEXTILE FOR SILT FENCE,  
WOVEN WIRE REINFORCED**

1+086 LT ~ 1+100 LT  
1+082 RT ~ 1+100 RT

**SEED**

1+040 LT ~ 1+100 LT  
1+040 RT ~ 1+100 RT

**SEED, WINTER RYE**

1+040 LT ~ 1+100 LT  
1+040 RT ~ 1+100 RT

**HAY MULCH**

1+040 LT ~ 1+100 LT  
1+040 RT ~ 1+100 RT

**TEMPORARY EROSION MATTING**

1+070 RT ~ 1+100 RT - SLOPE STABILIZATION  
1+080 LT ~ 1+100 LT - SLOPE STABILIZATION

**TEMPORARY STONE CHECK DAM, TYPE I**

1+040 LT  
1+042.5 RT

**BARRIER FENCE**

1+040 LT ~ 1+100 LT  
1+040 RT ~ 1+100 RT

**SPECIAL PROVISION**

**(PERMANENT STONE CHECK DAM, TYPE I)**

1+092 LT  
1+074 RT

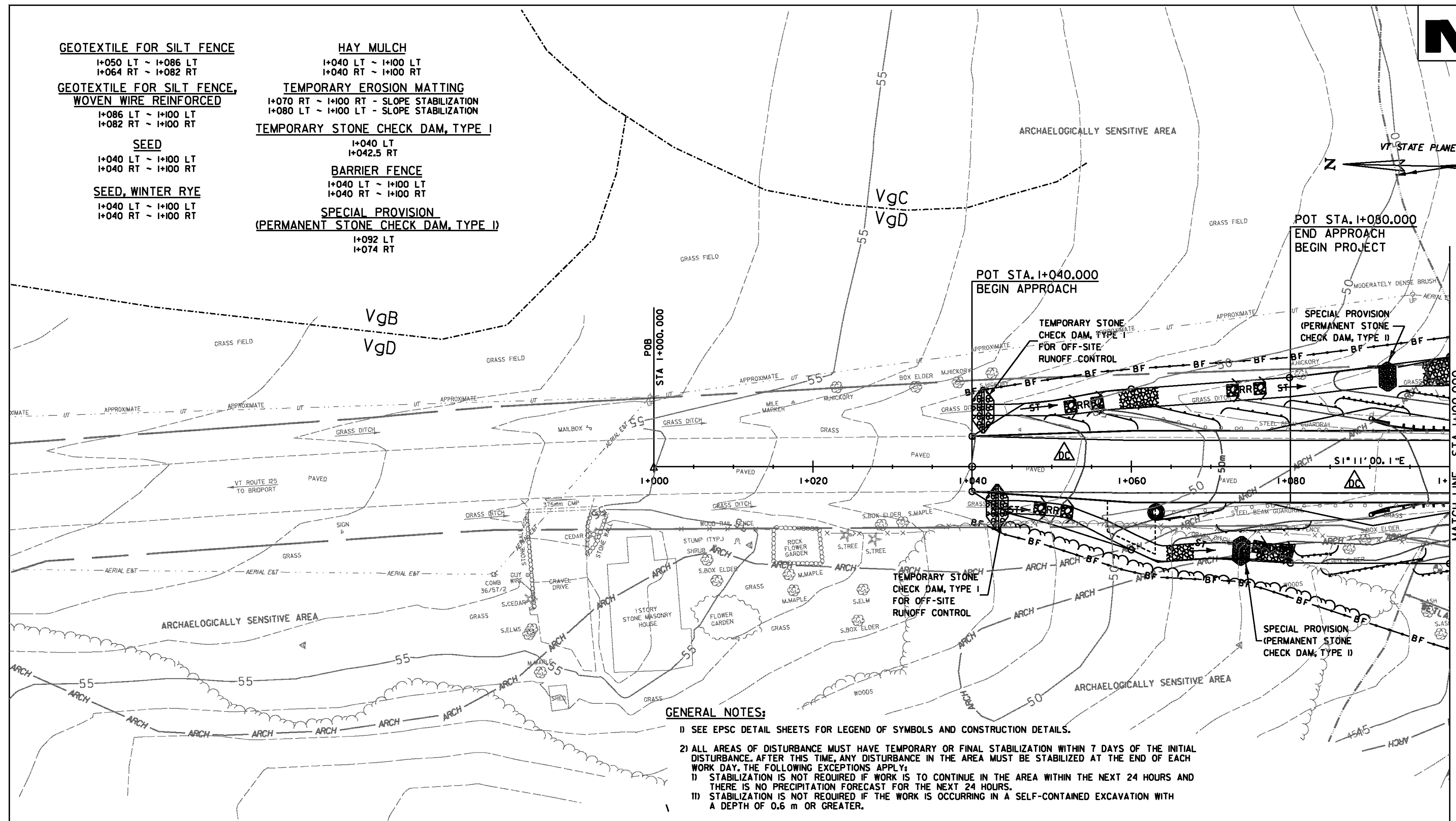

**GENERAL NOTES:**

- 1) SEE EPSC DETAIL SHEETS FOR LEGEND OF SYMBOLS AND CONSTRUCTION DETAILS.
- 2) ALL AREAS OF DISTURBANCE MUST HAVE TEMPORARY OR FINAL STABILIZATION WITHIN 7 DAYS OF THE INITIAL DISTURBANCE. AFTER THIS TIME, ANY DISTURBANCE IN THE AREA MUST BE STABILIZED AT THE END OF EACH WORK DAY. THE FOLLOWING EXCEPTIONS APPLY:
  - 1) STABILIZATION IS NOT REQUIRED IF WORK IS TO CONTINUE IN THE AREA WITHIN THE NEXT 24 HOURS AND THERE IS NO PRECIPITATION FORECAST FOR THE NEXT 24 HOURS.
  - 2) STABILIZATION IS NOT REQUIRED IF THE WORK IS OCCURRING IN A SELF-CONTAINED EXCAVATION WITH A DEPTH OF 0.6 m OR GREATER.
- 3) THE CONTRACTOR SHALL LIMIT CONCURRENT EARTH DISTURBANCE TO 0.81 HECTARES (2 ACRES) OR LESS AT ANY ONE TIME.
- 4) THE CONTRACTOR SHALL MINIMIZE ANY SOIL DISTURBANCES BETWEEN OCTOBER 15TH THROUGH APRIL 15TH. TO ASSURE A VIGOROUS CATCH OF VEGETATIVE COVER, SEEDING AND MULCHING SHALL BE COMPLETED BY SEPTEMBER 15TH TO THE EXTENT POSSIBLE, OR AS DIRECTED BY THE ENGINEER.
- 5) THE ON-SITE PLAN COORDINATOR SHALL INSPECT ALL EROSION AND SEDIMENT CONTROL STRUCTURES AND MEASURES AT LEAST ONCE EVERY SEVEN (7) CALENDAR DAYS AND AS SOON AS POSSIBLE BUT NOT MORE THEN 24 HOURS AFTER ANY STORM EVENT. INSPECTION FREQUENCY MAY BE REDUCED TO LESS THAN ONE (1) PER MONTH IF THE ENTIRE SITE IS TEMPORARILY STABILIZED.
- 6) THE CONTRACTOR SHALL IMMEDIATELY ROUGHEN ALL DISTURBED SOIL SURFACES TO THE SATISFACTION OF THE ENGINEER BY THE USE OF TRACK DRIVEN BULLDOZERS, SHEEPSFOOT ROLLERS OR OTHER APPROVED METHODS.
- 7) THE CONTRACTOR SHALL APPLY DUST CONTROL MEASURES OVER EXPOSED SURFACES NOT INTENDED TO BE VEGETATED.
- 8) FILTER BAGS OR ENGINEER APPROVED EQUAL METHOD SHALL BE REQUIRED FOR ALL DEWATERING OPERATIONS. THEIR PLACEMENT, MAINTENANCE AND USE SHALL BE IN ACCORDANCE WITH THE STANDARD SPECIFICATIONS AND AS DIRECTED BY THE ENGINEER.
- 9) THE CONTRACTOR SHALL INSTALL PERMANENT EROSION CONTROL MEASURES (I.E. CHECKDAMS, EROSION MATTING, STONE OUTLET PROTECTION, STONE FILL FOR SLOPES AND DITCHES) IMMEDIATELY UPON COMPLETION OF GRADING.
- 10) THE CONTRACTOR MAY USE THE PERMANENT GRASS LINED DITCHES TEMPORARILY FOR FLOW PROTECTION. HOWEVER, THE GRASS WATERWAYS SHALL BE CLEANED AND RE-BUILT TO THE FINAL DITCH CONDITIONS BEFORE THE COMPLETION OF THE PROJECT.
- 11) THE LOCATIONS OF VEHICLE TRACKING PADS ARE SUGGESTED ONLY. THE CONTRACTOR SHALL DETERMINE ACTUAL LOCATION OF VEHICLE TRACKING PADS NEEDED TO PERFORM THE WORK.



DATUM  
VERTICAL NAVD 88  
HORIZONTAL NAD 83(92)

**ON-SITE PLAN COORDINATOR**

NAME	TITLE	PHONE

PROJECT: <b>CORNWALL</b>	PROJECT NO.: <b>BRS 0172(6)</b>
DESIGN FILE NAME: z85e042erosbdr.dgn	PLOT DATE: 2/11/2010
IPARM FILE NAME:	SURVEY DATE: 1996&1999
SURVEYED BY: VTRANS & VT SURVEY	DRAWN BY: ERIK ATKINS
SQUAD LEADER: MARTHA EVANS-MONGEON	SHEET: 45 OF 144
EPSC CONSTRUCTION CONDITIONS SHEET 1	