

Temporary Detour Profile

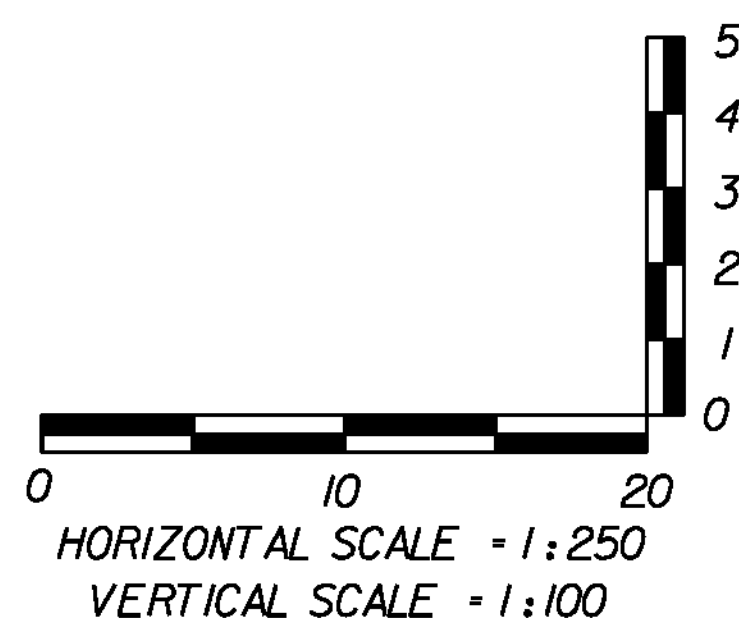
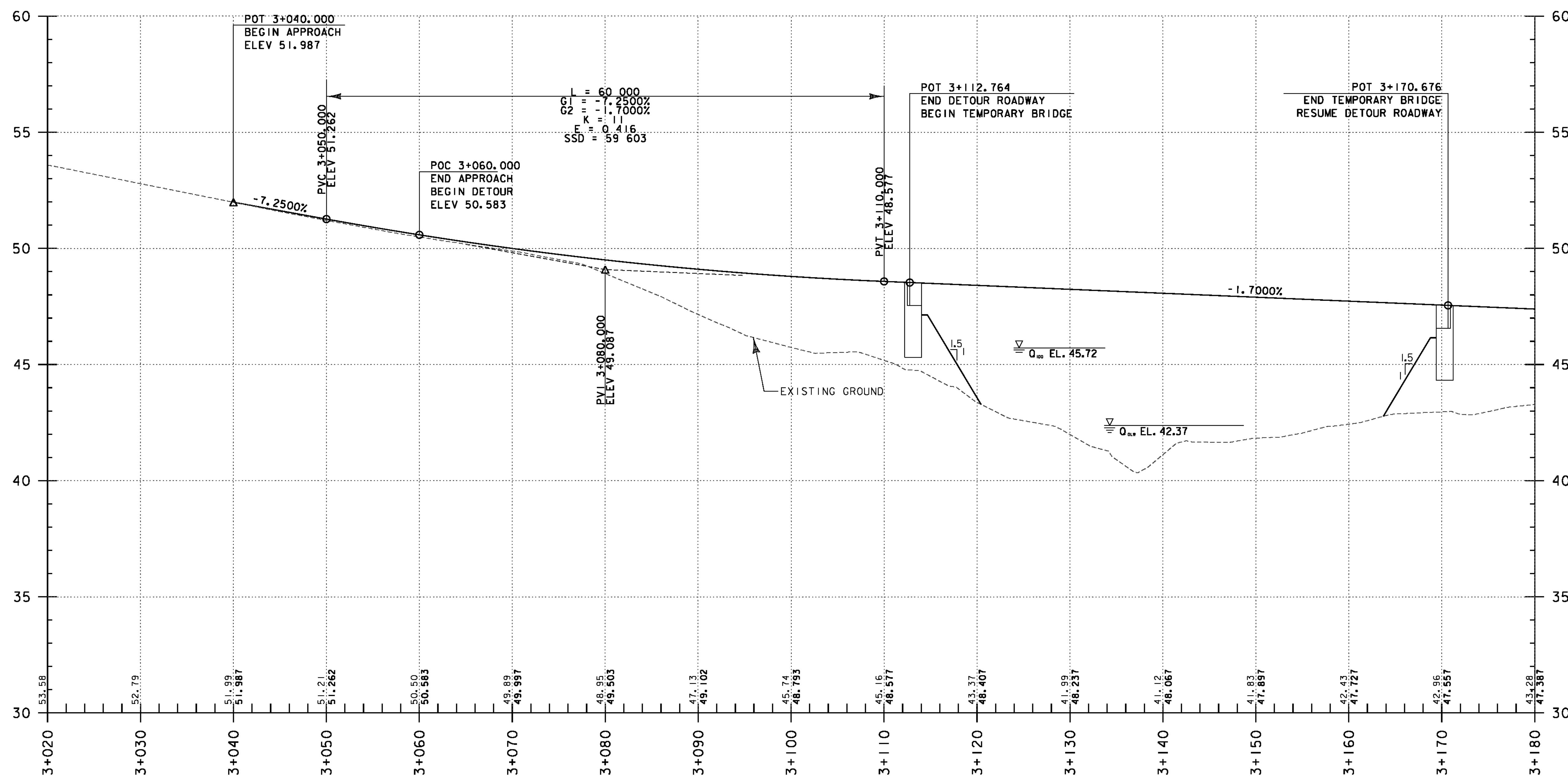

NOTE:
THE TEMPORARY DETOUR PROFILE SHOWN IS A SUGGESTED PROFILE FOR BIDDING PURPOSES. THE CONTRACTOR IS REQUIRED TO SUBMIT A DESIGN FOR THE TEMPORARY DETOUR APPROACHES AND BRIDGE TO VTRANS FOR APPROVAL IN ACCORDANCE WITH THE STANDARD SPECIFICATIONS.

DATUM	
VERTICAL	NAVD 88
HORIZONTAL	NAD 83(92)

THE GRADES SHOWN TO THE NEAREST HUNDREDTH ARE THE ORIGINAL GROUND ELEVATIONS ALONG THE PROPOSED ALIGNMENT. THE GRADES SHOWN TO THE NEAREST THOUSANDTH ARE THE PROPOSED PROFILE GRADES FOR THE NEW ALIGNMENT.

PROJECT: CORNWALL	PROJECT NO. : BRS 0172(6)
DESIGN FILE NAME: z85e042xs5.dgn	PLOT DATE: 2/5/2010
IPARM FILE NAME:	SURVEY DATE: 1996&1999
SURVEYED BY: VTRANS & VT SURVEY	DRAWN BY: ERIK ATKINS
SQUAD LEADER: MARTHA EVANS-MONGEON	SHEET: 33 OF 144
TEMPORARY DETOUR PROFILE SHEET 1	