

TEMPORARY TRAFFIC BARRIER
STA 10+275.00 RT - 10+295.00 LT

SPECIAL PROVISION (TEMPORARY STEEL SHEET PILING)
STA 10+275.00 - 10+285.00 RT

REMOVAL OF EXISTING PAVEMENT MARKINGS
STA 10+275.00 - 10+320.00

TEMPORARY 100 mm WHITE LINE
STA 10+275.00 - 10+340.00 (2)

TEMPORARY 100 mm YELLOW LINE
STA 10+275.00 - 10+340.00 (DBL)

NOTES:

1. THE EXISTING CENTERLINE OF ROAD SHALL BE SHIFTED TO THE RIGHT STARTING AT STATION 10+020. THE ALIGNMENT SHALL FOLLOW THE RADII SHOWN ABOVE AND MOVE OUT APPROXIMATELY 2.4 M AT STATION 10+070 TO ALLOW ENOUGH ROOM FOR CONSTRUCTION OF THE NEW WEST BOUND LANE.
2. THE CENTERLINE SHALL THEN TRANSITION INWARD TO 1.0 M RIGHT OF THE EXISTING CENTERLINE BY STATION 10+105.
3. THE CENTERLINE SHALL REMAIN AT 1.0 M RIGHT FROM STATION 10+105 TO 10+245 AND TRANSITION BACK TO ITS EXISTING LOCATION FROM STATION 10+245 TO 10+320.

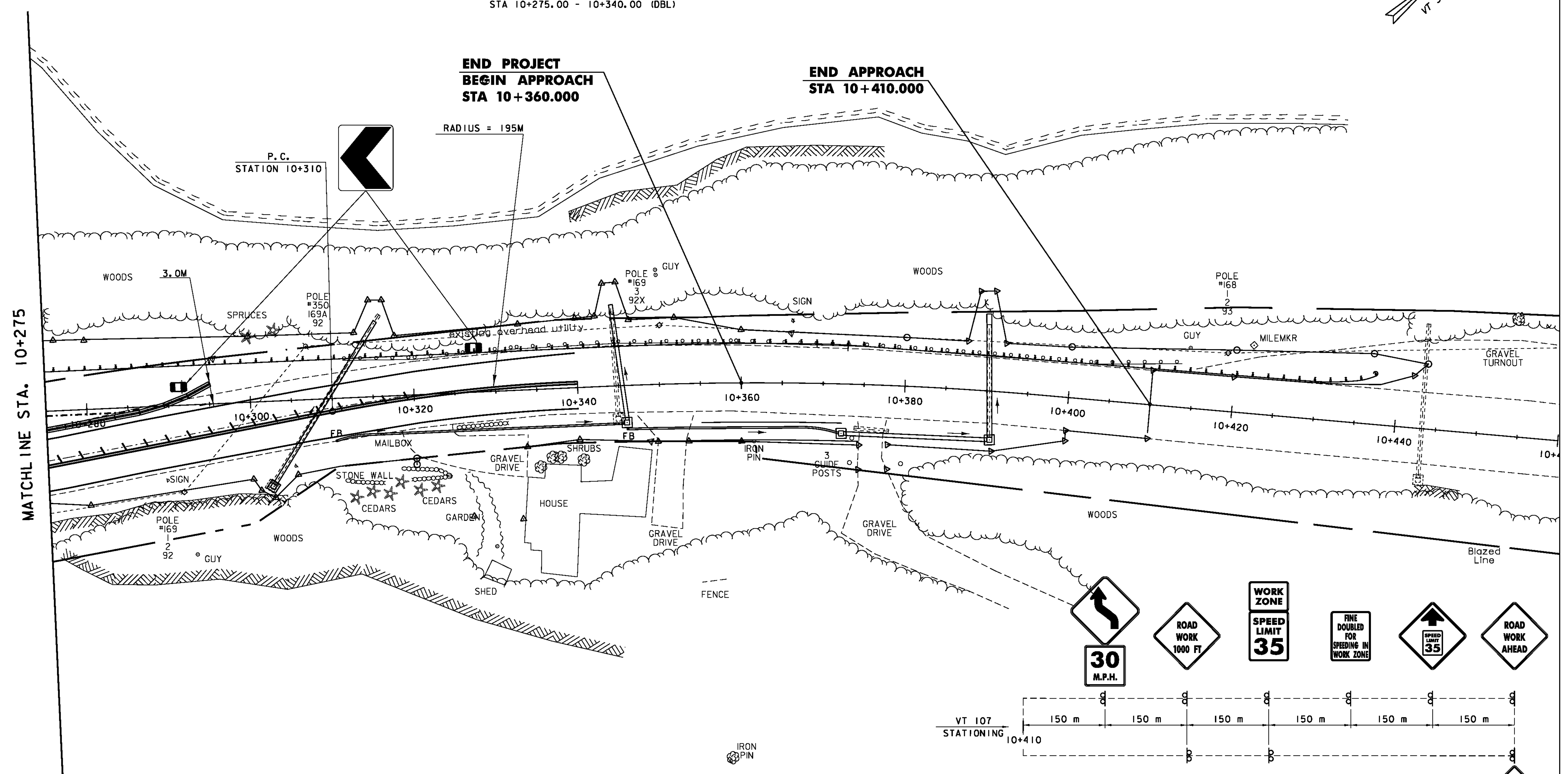

**END PROJECT
BEGIN APPROACH
STA 10+360.000**

**END APPROACH
STA 10+410.000**

MATCHLINE STA. 10+275

SIGNS TO BE LOCATED AS PER STANDARDS E-100 & E-107

LEGEND	
	- SIGN POSTS
	- TYPE III BARRICADES (MOD.)
	- TEMP. TRAFFIC BARRIER
	- RETROREFLECTORIZED BARREL
	- TEMPORARY STEEL SHEET PILING
	- PAVEMENT MARKING REMOVAL

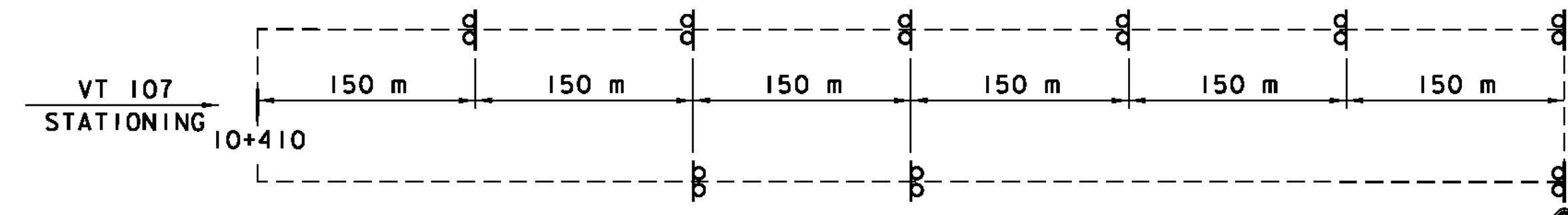
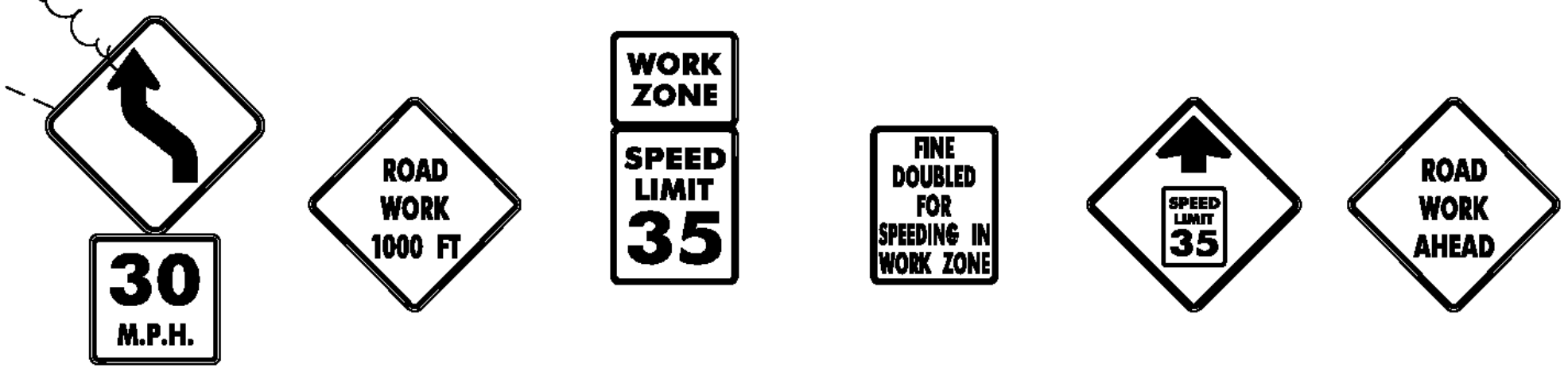

PHASE A TRAFFIC CONTROL LAYOUT 4



APPROACH SIGN PACKAGE

N. T. S.

PROJECT NAME: STOCKBRIDGE	PLOT DATE: 08-APR-2010
PROJECT NUMBER: BRF 022-1(20)	DRAWN BY: H. I. SALLS
FILE NAME: /85e039/de039bdr.dgn	CHECKED BY: R.S. Young
PROJECT LEADER: C. P. WILLIAMS	TRAFFIC CONTROL
DESIGNED BY: H. I. SALLS	SHEET 29 OF 139