

WHITE RIVER

Disconnection Area  
per Stormwater Permit #4233-1NDS  
10+275 - 10+330 Lt.

HD SteelBeam Guardrail, Galvanized  
10+275.00 ~ 10+426.00 Lt.

Manufactured Terminal Section, Flared  
10+426.00 ~ 10+437.40 Lt.

Cast in Place Concrete Curb, Type B  
10+310.00 - 10+327.76 Rt.  
10+333.76 - 10+347.25 Rt.

Construct Drives  
10+330.00 Rt. - Gravel Drive w/2.0M Paved Apron, 6.0M Wide (See Chart Below)  
10+352.00 Rt. - 2.0M Paved Apron, 5.0M wide  
10+376.00 Rt. - 5.0M Gravel Drive, 3.5M Wide w/1.0M Paved Apron, 5.0M Wide

Removal and Disposal of Guardrail  
10+311.44 - 10+413.47 Lt.

Relocate Mailbox, Single Support  
10+317.25 Rt.

Removal of Stone Wall  
(Included under  
Item 203.50 "Common Excavation")  
10+325 - 10+332 Rt.

Bituminous Concrete Gutter  
10+353.30 - 10+374.25 Rt. 2.2M Wide

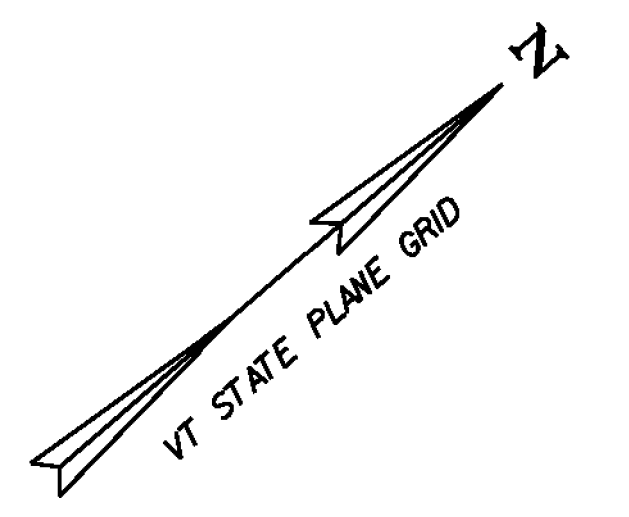

Benchmark #5  
Spike in Ash Tree  
Elev. 208.282

**END PROJECT  
BEGIN APPROACH  
STA 10+360.000**

**END APPROACH  
STA 10+410.000**

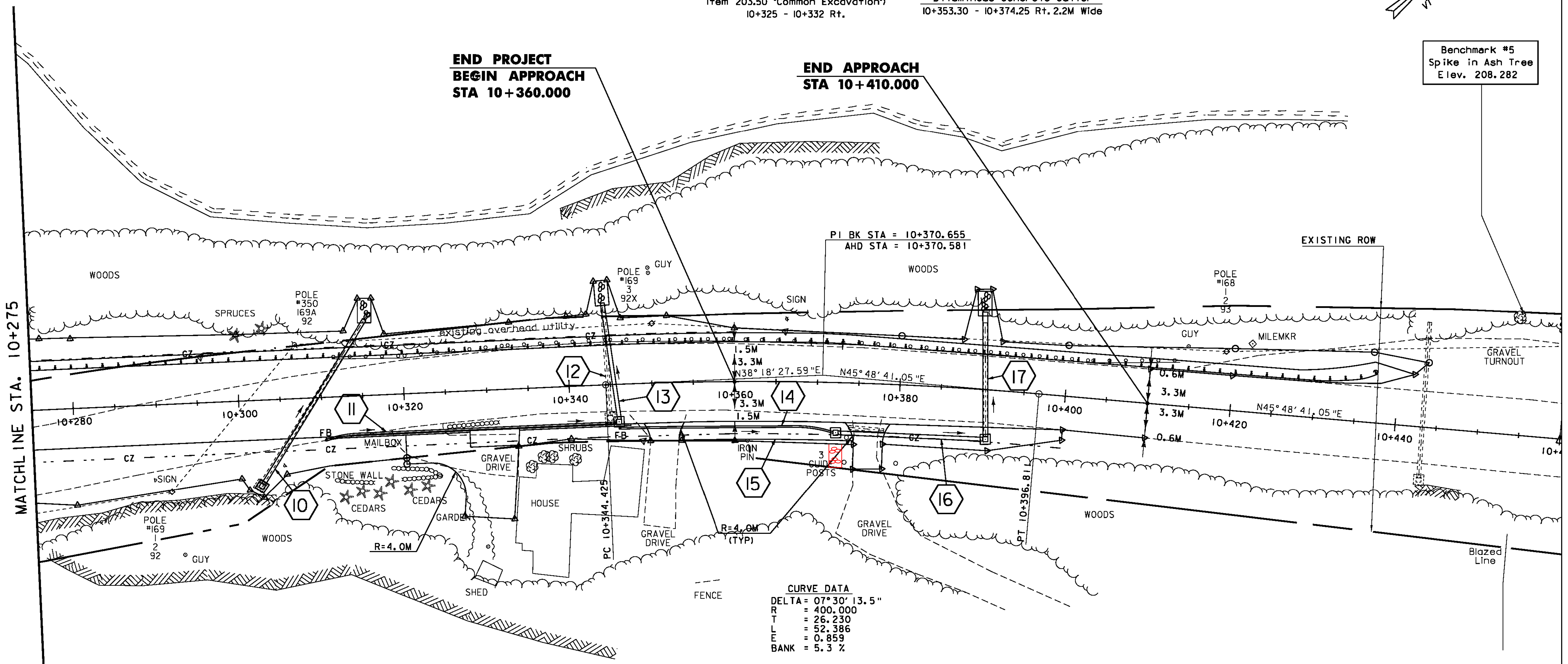

**CURVE DATA**  
DELTA = 07° 30' 13.5"  
R = 400.000  
T = 26.230  
L = 52.386  
E = 0.859  
BANK = 5.3 %

MATCHLINE STA. 10+275

SEE DRAINAGE DETAIL SHEET  
FOR DRAINAGE FLAG DESCRIPTIONS

\*Drive @ STA 10+330.00 Rt

POINT	STA	OFFSET.
1	10+320.00	4.99 Rt
2	10+320.00	8.49 Rt
3	10+326.72	15.13 Rt
4	10+332.69	15.73 Rt
5	10+333.58	6.80 Rt
6	10+333.76	4.80 Rt
7	10+327.76	4.80 Rt
8	10+327.76	6.80 Rt

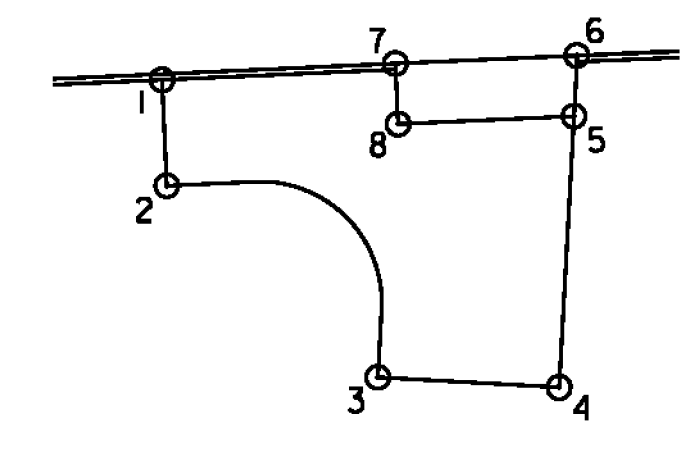

# LAYOUT 4

PROJECT NAME: STOCKBRIDGE  
PROJECT NUMBER: BRF 022-1(20)  
FILE NAME: 85e039/de039bdr.dgn  
PLOT DATE: 08-APR-2010  
PROJECT LEADER: C. P. WILLIAMS  
DRAWN BY: H. I. SALLS  
DESIGNED BY: R. S. YOUNG  
CHECKED BY: R.S. Young  
LAYOUT 4  
SHEET 18 OF 139