

# HVCTRL #1

V.T.G.S. SURVEY DISK STAMPED

\* GODDARD \*  
 N = 140062.8520  
 E = 482218.6380  
 EL. = 240.600

GENERAL LOCATION, STOCKBRIDGE, VT. OWNERSHIP, EDITH GODDARD, 2678 VT RTE 107, STOCKBRIDGE, VT.05772. TO REACH FROM THE INTERSECTION OF VT ROUTES 100 AND 107 GO EAST ALONG VT ROUTE 107 FOR 2.7 MI (4.3 KM) TO THE INTERSECTION OF BLACKMER BOULEVARD LEFT AND A GRAVEL DRIVE RIGHT. TURN RIGHT AND GO SOUTHEAST ALONG THE GRAVEL DRIVE FOR ABOUT 75 M (246.1 FT) TO THE SITE OF THE MARK ON THE RIGHT IN THE FRONT LAWN OF THE GODDARD RESIDENCE. THE MARK IS SET FLUSH WITH GROUND SURFACE IN THE TOP OF A ROCK OUTCROP OF WHICH 0.2 M (0.7 FT) IS EXPOSED. IT IS 30.2 M (99.1 FT) WEST SOUTHWEST OF AND ABOUT 3.5 M (11.5 FT) HIGHER THAN THE CENTERLINE OF THE GRAVEL DRIVE, 19.4 M (63.6 FT) NORTHWEST OF THE NORTH CORNER OF THE HOUSE, 28.2 M (92.5 FT) NORTH OF THE WEST CORNER OF THE ADDITION ON THE HOUSE, 8.2 M (26.9 FT) SOUTHWEST OF A FLAG POLE, AND 25.2 M (82.7 FT) HEAST OF POLE NO 1C/79-1.

# HVCTRL #2

V.T.G.S. SURVEY DISK STAMPED

\* GODDARD AZ MK \*  
 N = 140489.2110  
 E = 482565.4360  
 EL. = 225.690

GENERAL LOCATION, STOCKBRIDGE, VT. OWNERSHIP, ELOISE THOMPSON, 3080 VT ROUTE 107, STOCKBRIDGE, VT.05772. TO REACH FROM THE INTERSECTION OF VT ROUTES 100 AND 107 GO EAST ALONG VT ROUTE 107 FOR 3.0 MI (4.8 KM) TO THE SITE OF THE MARK ON THE LEFT IN A LAWN. IT IS JUST EAST OF THE STOCKBRIDGE CENTRAL SCHOOL. THE MARK IS SET FLUSH WITH GROUND SURFACE IN THE TOP OF A 30 CM DIAMETER CONCRETE MONUMENT POURED 1.2 M (3.9 FT) DEEP. IT IS 17.6 M (57.7 FT) NORTH OF AND ABOUT 0.5 M (1.6 FT) LOWER THAN THE NORTH EDGE OF PAVEMENT OF VT ROUTE 107, 43.9 M (144.0 FT) NORTHEAST OF POLE NO 177/3/85, 21.0 M (68.9 FT) SOUTHWEST OF THE SOUTHWEST CORNER OF A FOUR BAY GARAGE, AND 17.6 M (57.7 FT) NORTH NORTHWEST OF POLE NO 1761/2 /85X AND A FIBERGLASS WITNESS POST.



GPS CONTROL POINTS

\* DESCRIPTION PROVIDED BY VERMONT AGENCY OF TRANSPORTATION GEODETIC SURVEY UNIT.

TRAVERSE TIES

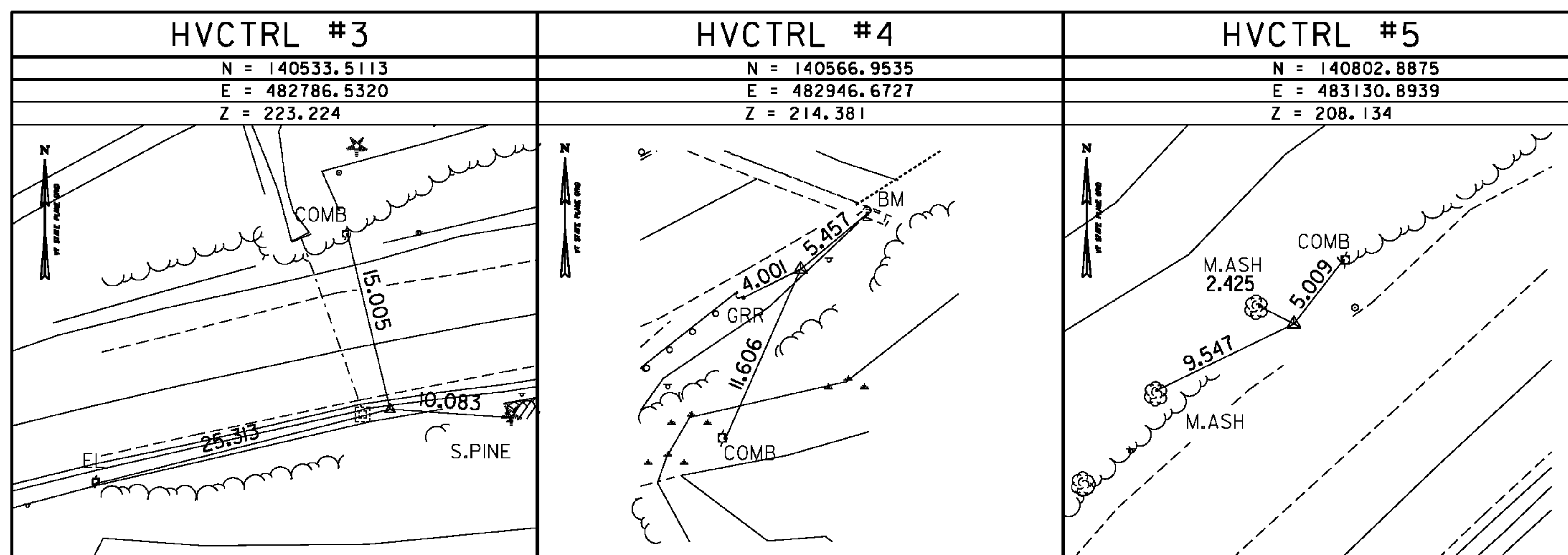

\* MAIN TRAVERSE COMPLETED JAN. 10, 2000. SURVEYED BY L.ORVIS, G.WILSON & J.HULETT

ALIGNMENT DATA

Horizontal Alignment Name: stony final

	STATION	NORTHING	EASTING
POB	20+000.000	140569.9810	482908.6790
PC	20+008.073	140562.5936	482911.9349
PI	20+018.681	140552.8870	482916.2130
Radius:	40.000		
Delta:	29°42'17.17" Left		
Degree of Curvature (Arc):	43°39'34.10"		
Length:	20.738		
Tangent:	10.608		
Chord:	20.506		
Middle Ordinate:	1.336		
External:	1.383		
PT	20+028.811	140546.5758	482924.7389
PC	20+040.741	140539.4781	482934.3273
PI	20+050.830	140533.4750	482942.4370
Radius:	75.000		
Delta:	15°19'26.68" Right		
Degree of Curvature (Arc):	23°17'06.19"		
Length:	20.059		
Tangent:	10.090		
Chord:	19.999		
Middle Ordinate:	0.670		
External:	0.676		
PT	20+060.800	140525.5421	482948.6719
POE	20+112.805	140484.6540	482980.8080

ALIGNMENT DATA

Horizontal Alignment Name: vt107 prop

	STATION	NORTHING	EASTING
POB	9+790.000	140466.6084	482569.1820
PC	9+792.500	140467.7035	482571.4302
PI	9+895.481	140512.8133	482664.0057
Radius:	836.196		
Delta:	14°02'30.22" Right		
Degree of Curvature (Arc):	2°05'18.53"		
Length:	204.930		
Tangent:	102.981		
Chord:	204.418		
Middle Ordinate:	6.270		
External:	6.317		
PT	9+997.430	140534.1137	482764.7598
PC	10+094.338	140554.1578	482859.5715
PI	10+184.726	140572.8535	482948.0052
Radius:	250.000		
Delta:	39°45'18.79" Left		
Degree of Curvature (Arc):	6°59'07.86"		
Length:	173.465		
Tangent:	90.388		
Chord:	170.006		
Middle Ordinate:	14.895		
External:	15.838		
PT	10+267.802	140643.7806	483004.0354
PC	10+344.425	140703.9062	483051.5328
PI	10+370.656	140724.4891	483067.7926

Radius:	400.000		
Delta:	7°30'13.46" Right		
Degree of Curvature (Arc):	4°21'57.41"		
Length:	52.386		
Tangent:	26.230		
Chord:	52.349		
Middle Ordinate:	0.857		
External:	0.859		
PT	10+396.811	140742.7723	483086.6012
POE	10+460.000	140786.8163	483131.9107

Horizontal Alignment Name: Channel

	STATION	NORTHING	EASTING
POB	30+417.944	140563.2530	483038.9110
POE	30+551.083	140638.0030	482928.7370

Horizontal Alignment Name: drive2

	STATION	NORTHING	EASTING
POB	0+000.000	140637.7900	482999.0380
PC	0+007.884	140632.7776	483005.1231
PC	0+007.884	140632.7776	483005.1231
PI	0+014.384	140628.6450	483010.1400
Radius:	6.500		
Delta:	89°59'55.02" Right		
Degree of Curvature (Arc):	268°40'25.21"		
Length:	10.210		
Tangent:	6.500		
Chord:	9.192		
Middle Ordinate:	1.904		
External:	2.692		
PT	0+018.094	140623.6280	483006.0075
PC	0+025.920	140617.5870	483001.0317
PI	0+030.214	140614.2730	482998.3020
Radius:	6.500		
Delta:	66°53'32.64" Left		
Degree of Curvature (Arc):	268°40'25.21"		
Length:	7.589		
Tangent:	4.293		
Chord:	7.165		
Middle Ordinate:	1.076		
External:	1.290		
PT	0+033.509	140610.4617	483000.2788
POE	0+040.164	140604.5540	483003.3430

DATUM	
VERTICAL	NAVD 88
HORIZONTAL	NAD 83/96
ADJUSTMENT	none

\*Alignment Data Current as of 11/19/09

PROJECT NAME: Stockbridge  
 PROJECT NUMBER: BRF 022-1(20)

FILE NAME: 85e039/survey/x85e039t1.dgn PLOT DATE: 08-APR-2010  
 PROJECT LEADER: Chris Williams DRAWN BY: R. Bullock  
 DESIGNED BY: CHECKED BY:  
 Tie Sheet SHEET 13 OF 139